



Stages™

33" undermount single-bowl kitchen sink

K-3760

Features

- 36" minimum base cabinet width
- Single bowl with side platform
- Versatile design allows the side platform to be installed on right or left
- Includes a dishwasher-safe utensil tray
- Includes a versatile flip tray that works as a cutting board or large tray for food prep and cleaning
- Includes six microwave and dishwasher-safe prep bowls to maintain an organized cooking station
- Includes a large American walnut hardwood cutting board that provides a durable work surface that is beautiful, portable, and easy to clean
- Includes a stainless steel accessory storage rack to maintain a clutter-free sink area when accessories are not in use
- Includes a sink rack to help protect the sink basin from daily wear
- Works with all standard countertop thicknesses. Pairs best with 30 mm countertop thickness if a flush surface between counter and cutting board is desired
- 9-1/2" (241 mm) depth provides generous workspace
- Includes installation hardware
- Sink drain with strainer sold separately



Codes/Standards

ASME A112.19.3/CSA B45.4
IAPMO Certification

KOHLER® Stainless Steel Sinks Lifetime Limited Warranty

See website for detailed warranty information.

Material

- Handcrafted from 16-gauge stainless steel
- Premium 16-gauge stainless steel

Installation

- Undermount

Recommended Products/Accessories

K-8801 Sink drain and strainer with tailpiece
K-8799 Sink drain and strainer basket
K-23726 Drain treatment
K-23729 Stainless steel cleaner

Optional Products/Accessories

K-11352 Disposal Flange with Stopper

Included Components

K-6230 Utensil Tray
K-6231 Flip Tray
K-6232 Cutting Board
K-6234 Sink Rack
K-6235 Prep Bowls
K-6236 Accessory Storage Rack
91915 Hardware Kit

1-800-4KOHLER (1-800-456-4537)

Kohler Co. reserves the right to make revisions without notice to product specifications.

For the most current Specification Sheet, go to www.kohler.com USA or www.kohler.ca Canada

3-13-2024 20:34 - US

THE BOLD LOOK
OF **KOHLER**®

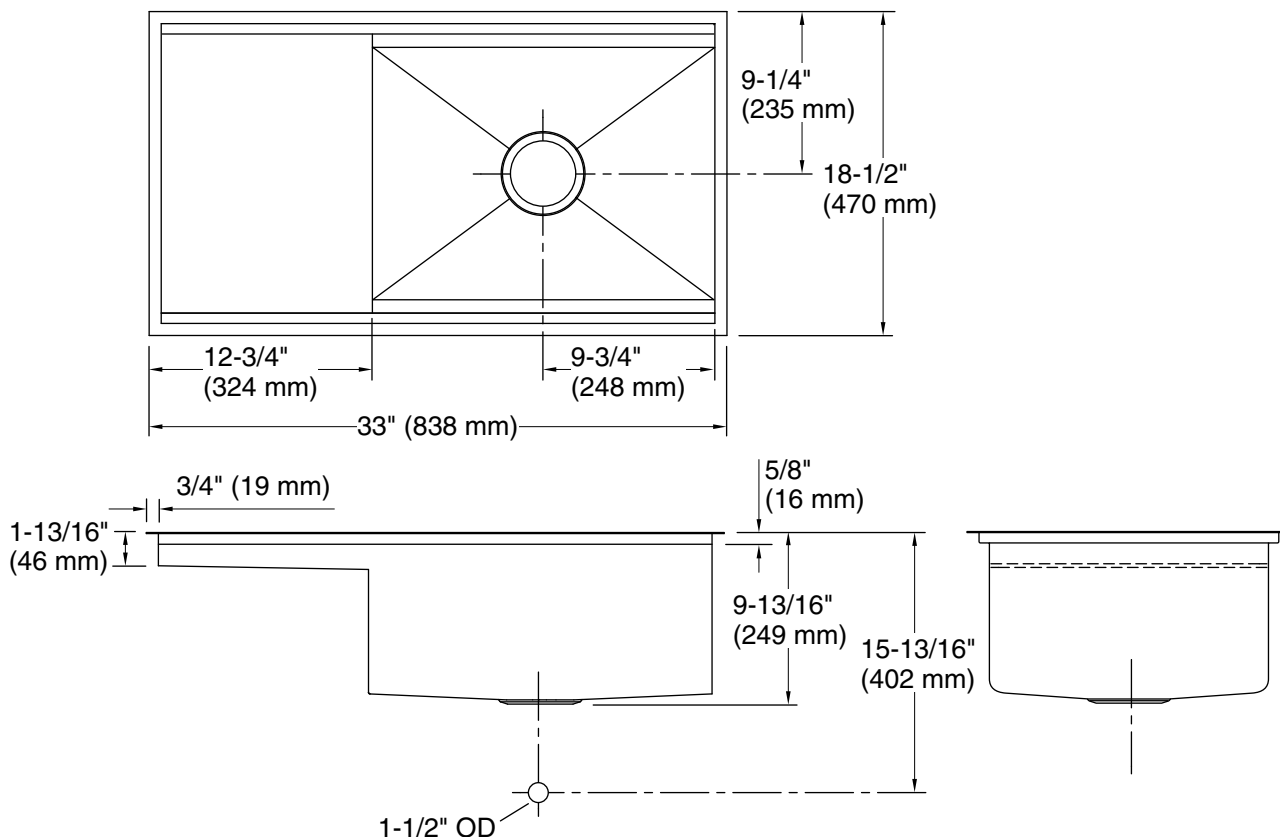

Technical Information

All product dimensions are nominal.

Bowl configuration: Off-set Large/small

Min. base cabinet width: 36" (914 mm)

width:

Bowl area: Length: 31-1/2" (800 mm)
Width: 17" (432 mm)
Bowl depth: 9-1/2" (241 mm)
Water depth: 9-1/2" (241 mm)

Drain hole: 3-5/8" (92 mm)

Template: 1109793-7, required, included

Notes

Install this product according to the installation instructions.