

CUSTOMER SERVICE

Guarantee

Your product has the benefit of our manufacturer's 1 year guarantee which starts from date of purchase.

Within the guarantee period we will resolve defects in materials or workmanship, free of charge, by replacing parts or product as we may choose.

This guarantee is in addition to your statutory rights and is subject to the following conditions :

- The product must be installed and maintained in accordance with the instructions given in this user guide.
- Replacement under this guarantee does not extend the original expiry date. The guarantee on any replacement parts or product ends at the original expiry date.

The guarantee does not cover:

- Non product faults (such as damage or performance issues arising from incorrect installation, improper use, inappropriate cleaning, lack of maintenance, build up of limescale, frost damage, corrosion, system debris or blocked filters) or where no fault has been found with the product.
- Accidental or wilful damage.
- Compensation for loss of use of the product or consequential loss of any kind.
- Damage or defects caused if the product is repaired or modified by persons not authorised by us or our appointed representative.

What to do if something goes wrong

If your product does not function correctly when you first use it, check that it is installed and commissioned in accordance with the instructions in this manual.

If this does not resolve the issue, contact us for help and advice.

Helpdesk Service

Our Customer Services Team is comprehensively trained and can offer help and advice, spare parts and accessories.

We will need you to have your model name, model number and date of purchase.

Please provide your model name and date of purchase.

Mira Showers Website (www.mirashowers.co.uk)

From our website you can download additional user guides, diagnose faults, purchase our full range of accessories and popular spares and refer to our FAQ's.

Spares and Accessories

We hold the largest stocks of genuine Mira spares and accessories.

Contact us for a price or visit our website to purchase items from our accessory range and popular spares.

To Contact Us:

UK

Telephone: 0844 571 5000

Fax: 01242 282595

Email – Visit www.mirashowers.co.uk/contactus

By Post: Mira Customer Services Dept, Cromwell Road, Cheltenham, Gloucestershire GL52 5EP

Eire Only

Telephone: 01 531 9337

E-mail – CustomerServiceEire@mirashowers.com

MIRA AGILE & ADEPT ERD SHOWER FITTINGS

Introduction

Thank you for purchasing a quality Mira product. To enjoy the full potential of your new product, please take time to read this guide thoroughly, having done so, keep it handy for future reference.

Mira shower fittings are designed to give a satisfactory shower over a range of pressures. These fittings are suitable for pressures between 0.1 and 5.0 bar.

General

1. Make sure that the shower fittings are installed by a competent installer.
2. Installations must comply with Water Regulations (Bye-Laws, Scotland), and any other Local Regulations and Building Regulations in force at the time of installation.
3. Before installation carefully inspect the new fixture for any signs of damage.
4. The shower fittings should be positioned at a convenient height for all the family. Position the fittings to spray across rather than towards the opening of the cubicle and also away from the shower control. Avoid layouts where the shower hose will be sharply kinked. This may reduce the life of the hose.
5. A hose retaining ring is supplied to prevent the handset from dropping below the spill over level of the bath or shower, which could lead to contamination from back-siphonage. The supplied hose retaining ring should meet the great majority of user requirements for shower installations with flexible outlet fittings. However, there will be occasions when the hose retaining ring will not provide a suitable solution. In these instances an **outlet** double check valve, e.g. the Mira DCV-H, **must** be fitted. The inclusion of the Mira DCV-H will increase the required supply pressure typically by 0.1 bar.

mira
SHOWERS

6. **Do not** fit any form of flow control in the outlet pipe work if the shower fittings are installed in conjunction with a product that requires the fittings to act as a vent (e.g. an electric shower).
7. Special consideration should be given to the fixing arrangements when installing onto a dry lined, stud partition, shower cubicle or laminated panel wall structures. Installers may wish to obtain alternative proprietary cavity fixings, or choose other options, however, these methods of fixing are beyond the scope of this guide.

Cleaning

Many household cleaners contain abrasives and chemical substances, and should not be used for cleaning plated or plastic fittings.

These finishes should be cleaned with a mild washing up detergent or soap solution, and then wiped dry using a soft cloth.

Use your thumb or a soft cloth to wipe any limescale from the soft nozzles and the front surface of the handset spray plate.

Spare Parts

Spare part numbers are indicated in bold and are available from authorised stockists or merchants (locations on request) or direct from Mira Customer Services, our contact details can be found on the back cover of this guide.

Mira is a registered trade mark of
Kohler Mira Limited.

The company reserves the right to alter
product specifications without notice.



© Kohler Mira Limited, May 2015

Diverter Wall Fixing 1736.733

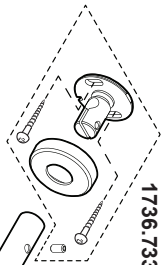

1. With the thread facing down push the diverter outlet into the end of the Agile mixer valve or Adept outlet.
2. Tighten the outer grub screw until it bottoms out (2.5 mm hexagonal key), then tighten a further 1/2 turn to secure the diverter to the mixer valve / outlet.

Diverter Outlet Installation

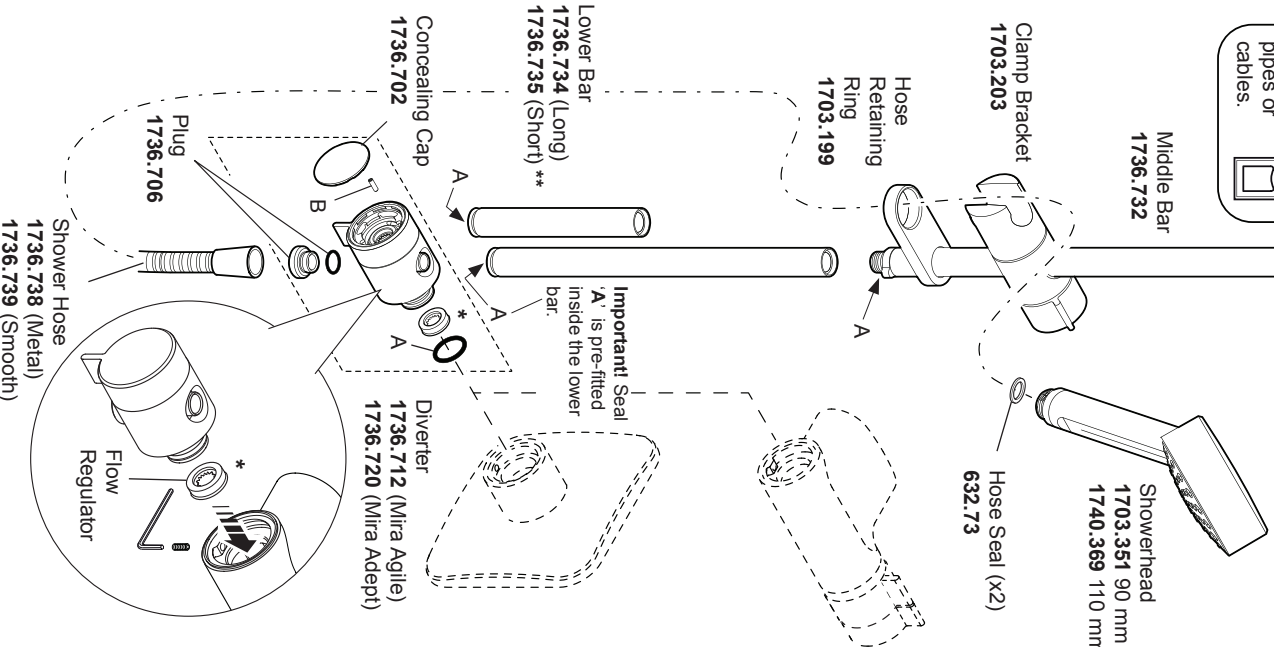
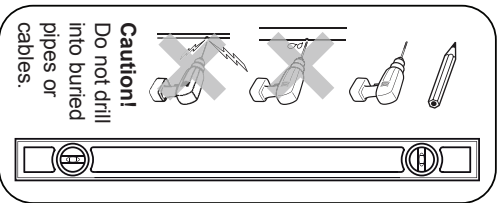
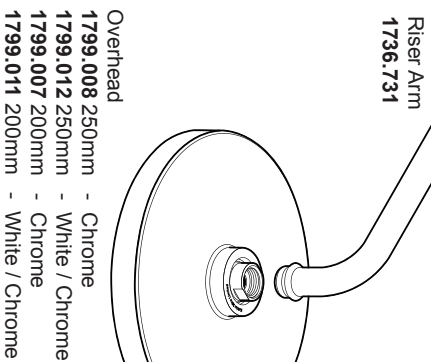

Riser Bar Installation

1. Slide the Hose Retaining Ring and the Clamp Bracket onto the middle bar, and then screw the middle and lower bar sections together.
2. Screw the Riser Arm to the middle and lower bar section.
3. Push the riser bar into the top of the diverter. **Note!** The riser bar must be located correctly, push down firmly to seat it.
4. Insert the Wall Fixing Bracket into the riser arm mounting boss, then swivel the bar if necessary to reposition the wall fixing bracket against the wall.
5. Mark the holes for the wall fixing bracket. **Note!** Use a spirit level to ensure the bar is vertical.
6. Remove the wall fixing bracket from the mounting boss then remove the riser bar from the diverter.
7. Drill two holes to suit the wall fixings, ensuring that the diverter is protected from debris. Fix the bracket to the wall. **Note!** The grub screw mounting hole must be positioned at the top.
8. Refit the riser bar into the diverter and then put the concealing cover onto the riser arm mounting boss.
9. Push the riser arm mounting boss onto the wall fixing bracket.
10. Fit and tighten the grub screw (2.5 mm hexagonal key) into the hole on top of the mounting boss then push the concealing cover over the wall fixing bracket.
11. Remove the Concealing Cap from the end of the diverter then tighten the grub screw (1.5 mm hexagonal key) positioned inside the diverter to secure the riser bar.
12. Refit the concealing cap.
13. Screw the fixed shower head onto the riser rail.
14. Fit the shower hose onto the diverter thread.
15. Push the shower hose through the retaining ring and screw it to the Showerhead.
16. Place the Showerhead into the clamp bracket, adjusting the angle and height to the users preference.
17. Restore the water supply and check for leaks.

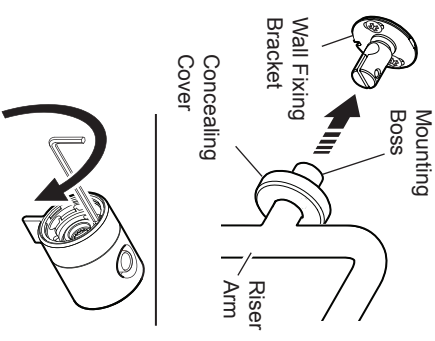

Diverter Control

Turning clockwise from the 6 o'clock position for Agile and anticlockwise for Adept models in 90° increments:

- Showerhead
- Overhead and Showerhead
- Overhead

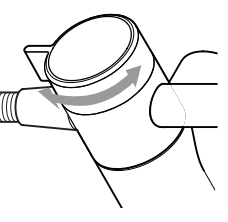

1736.740 Seal Pack - Components Identified 'A'
1736.707 Screw Pack - Components Identified 'B'

Note! * A 12 L/min flow regulator is fitted inside the diverter, for low pressure installations this should be removed.
** A short bar can be ordered if the ceiling height is not sufficient for the the standard bar length