

BEFORE YOU BEGIN

- Please read the following instructions carefully and familiarize yourself with the required tools, materials, and installation sequences. Follow the section that pertain to your particular installation. This will help you avoid costly mistakes. In addition to proper installation, please also read all operating and safety instructions.
- All information in the instructions is based upon the latest product information available at the time of publication. Kohler China reserves the right to make changes in product characteristics, packaging, or availability at any time without notice.
- These instructions contain important care, cleaning, and warranty information - please leave instructions for the consumer.
- We appreciate your commitment to Kohler quality. Please take a few minutes to review this manual before installation. If you encounter any installation or performance problems, please don't hesitate to contact us. Thanks again for choosing Kohler Company.
- Pre-arrange enough space for toilet installation. Make sure it will not affect the opening and closing of the door.
- Confirm the rough in 305mm, it need reach to 292~350mm, otherwise it may affect installation.
- Confirm the distance the water outlet connector away from the finished wall: upper the surface of finished wall by 3mm and lower the surface of finished wall by 5mm, otherwise it may affect installation.
- Recommend using the main inlet hose at least DN15mm to make sure the following request of water supply conditions.
- Measure water conditions before buying the product, there are two measure ways as following.

Note 1: If combined with other faucets in the bathroom, make sure the water condition meets minimum requirement.

2: Use the hose and Tee valve of this toilet.

3: Make sure meet the following water supply condition request before installation.

Simple way to measure water volume:

Prepare a bucket. Fully turn on the tee valve. Firstly flush three times and test. Fill the bucket with water into the bucket for 10 seconds. The minimum water volume is advised to be above 5.7L.

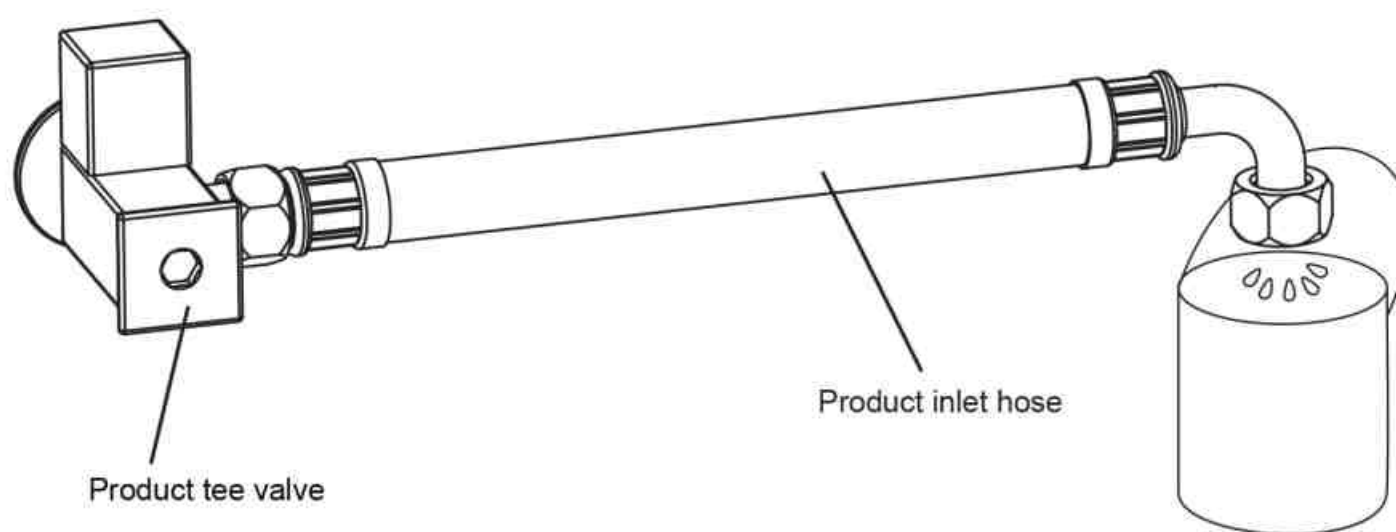

Fig.#1

TOOLS AND MATERIALS REQUIRED (Not supplied)

- | | |
|---------------------------|-----------------------------------|
| • 254mm adjustable wrench | • Assorted screwdrivers |
| • Tape measure | • Screw (match with 10mm anchors) |
| • Masking tape | • Expansion Bolt Kits |
| • Knife | |

Simple way to measure water volume 2:

Attention: must use dedicated water supply capacity testing device. After the ball valve is opened, firstly flush three times and test.

The minimum dynamic pressure for the testing device is advised to be above 0.046Mpa(6.7 psi).

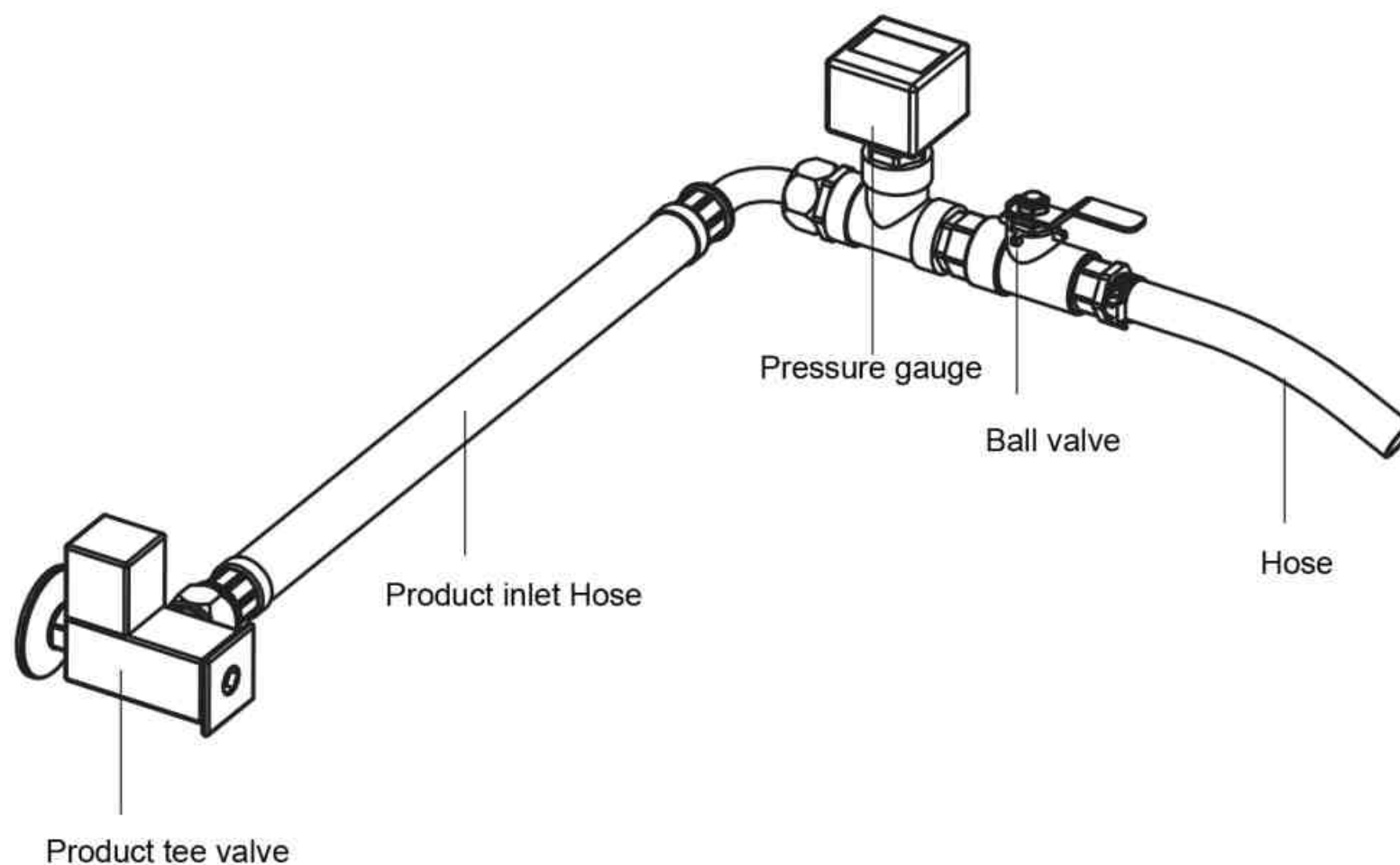





Fig.#2

ORDERING INFORMATION

VEIL Intelligent Toilet.....	K-5401T
Includes Remote Controller Assy	1106433

NOTES

-  **DANGER:** Risk of electric shock. Disconnect power before using.
-  **WARNING:** Risk of electric shock. Connect only to circuits protected by Ground-Fault Circuit-Interrupters (GFCI's) or Earth-Leakage Circuit-Breakers (ELCB's).
-  **CAUTION:** Risk of hazardous gases. If a new toilet is not installed immediately, temporarily place a rag in the floor flange opening.

NOTICE: Follow all local plumbing and electrical codes.

NOTICE: Receptacles installed in bathrooms to be located at least 1 meter from a bathtub or shower if practical.

- Observe all local plumbing and building codes.
- Carefully inspect the new toilet for damage.
- Water and electrical supplies may be wall mounted.
- There is a wiring schematic on the inside of the of the junction box cover.

-  **WARNING:** Risk of electric shock for hardwire installations/through-floor electrical supply: Connect only to properly-grounded, dedicated 220V/220V-240V~, 10A, 50Hz/60Hz circuit protected by a Class A Ground-Fault Circuit-Interrupter (GFCI) or Earth- Leakage Circuit-Breaker (ELCB).

-  **WARNING:** Must use 10A receptacle.

Measurements

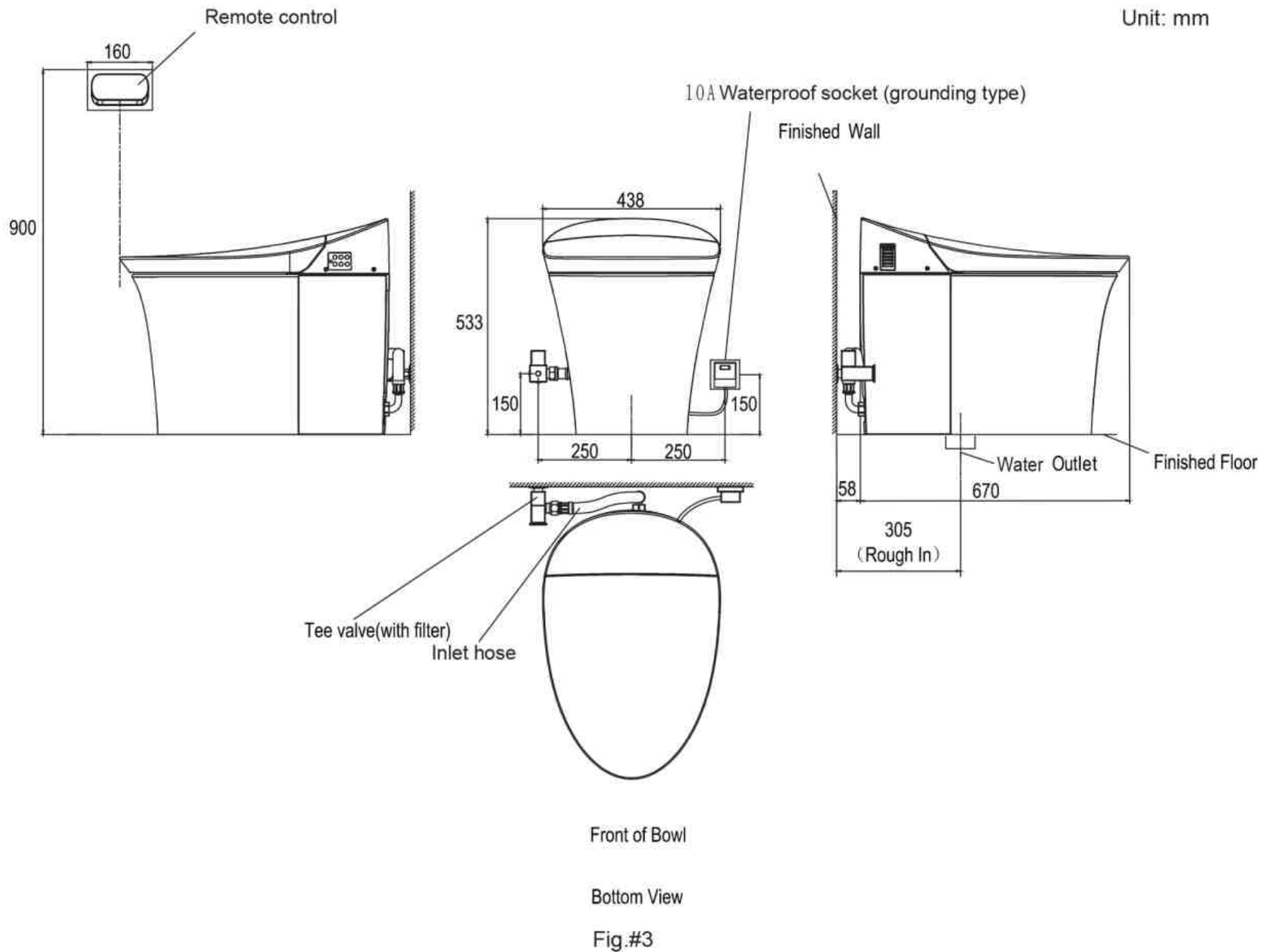

Kohler reserves the right to change marked dimensions without prior notice.

SPECIFICATIONS

Flushing Volume	3L/4.8L
Minimum Distance from Hole to Wall	305mm
Lowest Supply Condition (Recommend)	0.1Mpa(Dynamic Pressure), above 21L/min (Flow Rate)
Highest Supply Condition	0.74Mpa (Static Pressure)
Electrical Power	220V /220V-240V ~, 50/60Hz 960W/1000W
Power Cord Length	About 1.3m
Outline Dimension of Product	670mm x 438mm x 533mm
Product Weight	About 46kg
Operation Environment	1-40 °C

NOTE: See "Homeowner's Guide" for detailed specifications of the bidet seat.

Overall Sketch

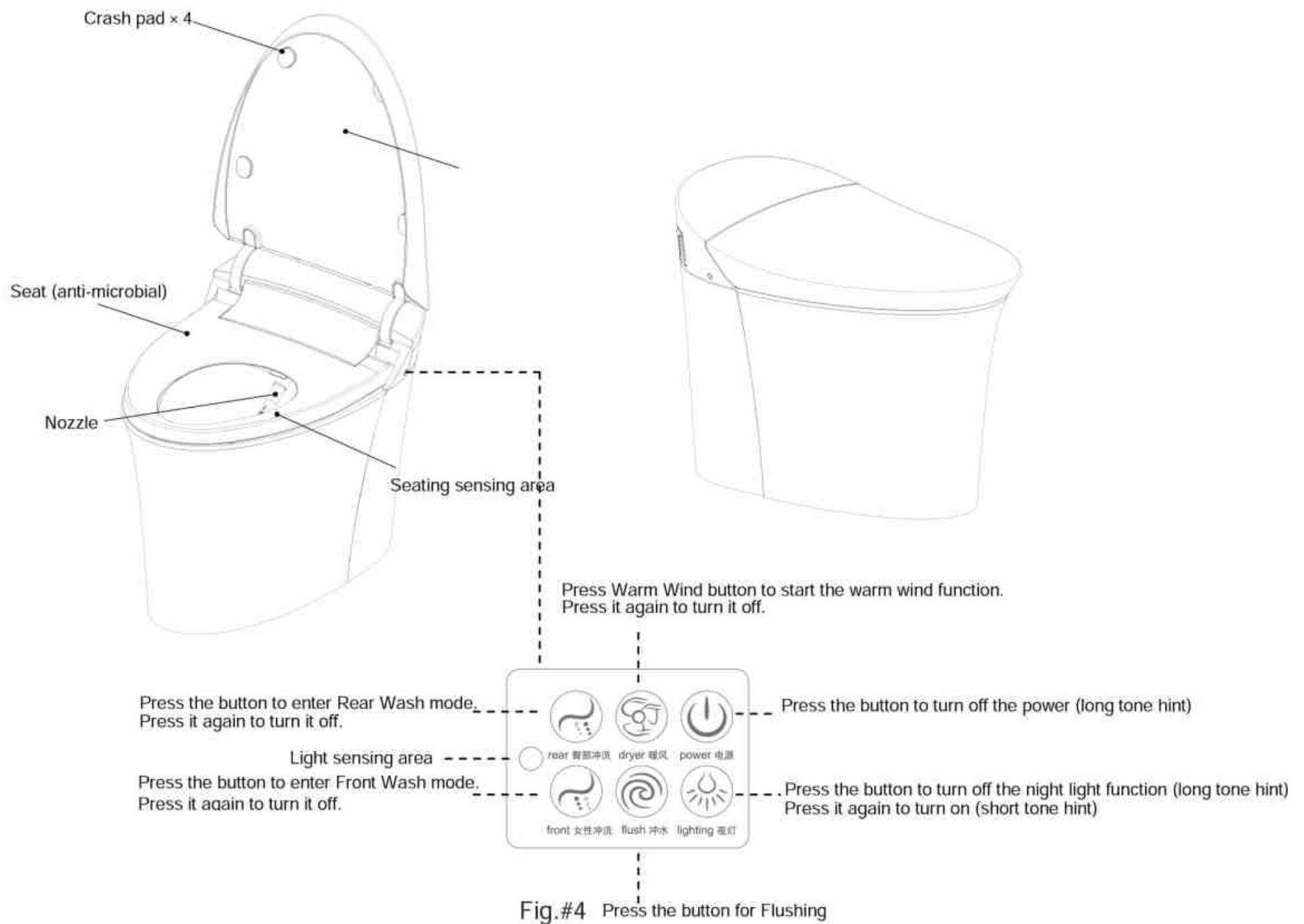

PREPARATIONS BEFORE INSTALLATION

- A. Hold the rim of the vitreous shell and take out the toilet.

WARNING: Risk of personal injury and product damage! Please do not hold the rim of the bidet seat when lifting the toilet. As the toilet is heavy, please seek help if necessary.

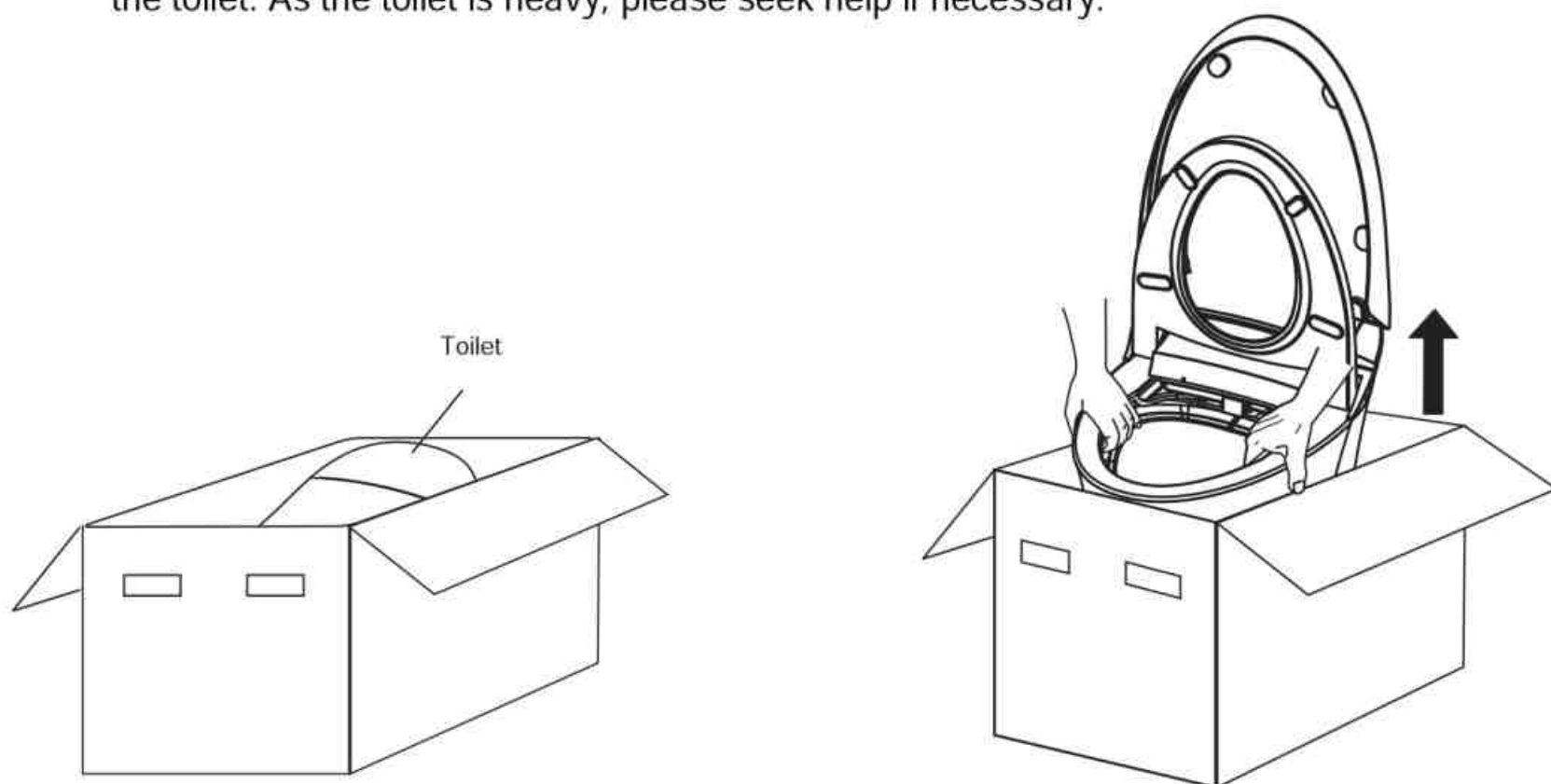

B. Place an 800mmX800mm cushion on the floor, take out the toilet from the carton then put the toilet on it

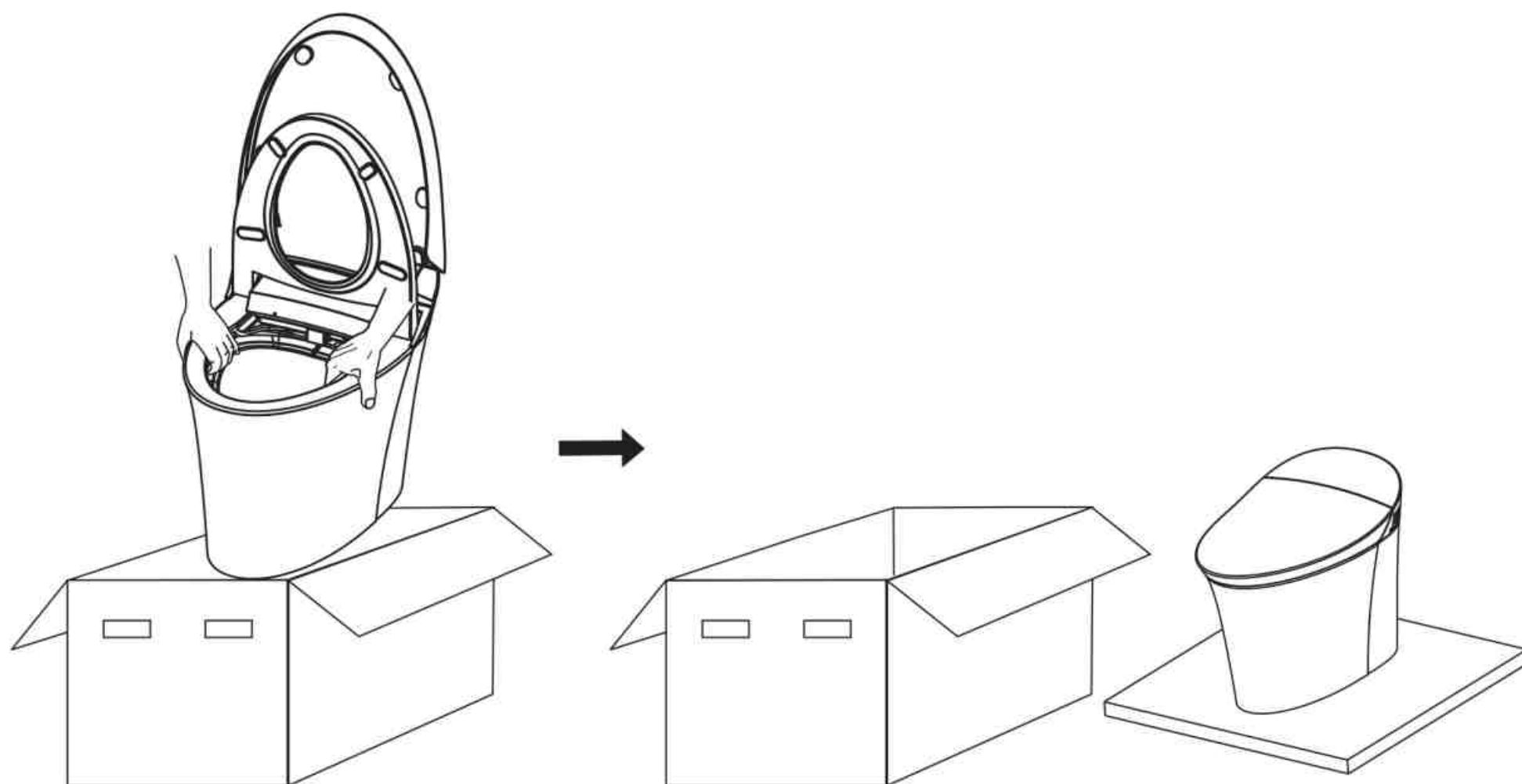

Fig.#6

INSTALLATION

A. To Remove Existing Toilet

Turn off the water supply. Flush the toilet, and use a sponge to remove the remaining water from the tank and bowl. Disconnect the supply shut-off valve (if present), and remove the old tank and bowl.

Remove old gasket from the floor and closet flange with a putty knife. Remove old T-bolts and

NOTICE: if a new toilet is not installed immediately, temporarily stuff a rag in the closet flange.

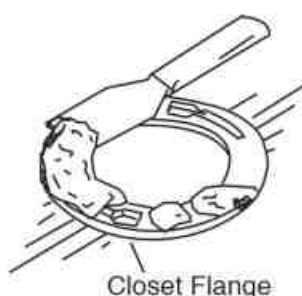

Fig.#7

B. Roughing-In



DANGER: Risk of electric shock. Disconnect power before servicing.

NOTE: This product is designed to work with wall mounted electrical and water supplies as shown in the mounting dimensions.



WARNING: Risk of electric shock. Connect only to circuits protected by Ground-Fault Circuit-Interrupters (GFCI's) or Earth-Leakage Circuit-Breakers (ELCB's).



Keep bath and shower away from electrical parts (such as remote controller, receptacle, etc).

When the electrical supply is mounted on the wall, a GFCI or ELCB protected and water proof receptacle is required.

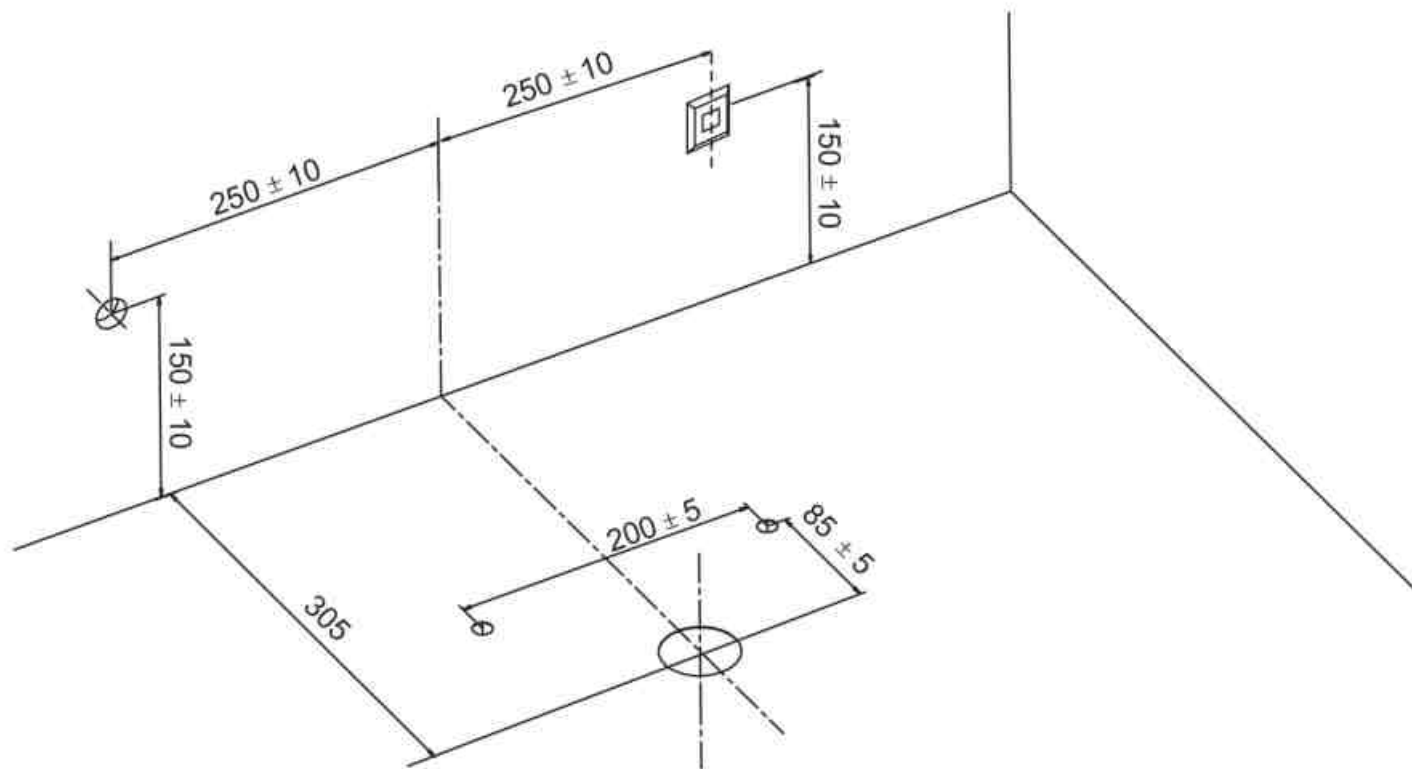

Fig.#8

- C. 1. Confirm the drain hole center and mark down the “+” centerline perpendicular to the finished wall.
 2. Confirm the toilet drain hole center and mark down the centerline on Front, back, left and right outside of toilet.
 3. Make sure the toilet side mark symbol is align to the drain hole centerline on the finished floor.

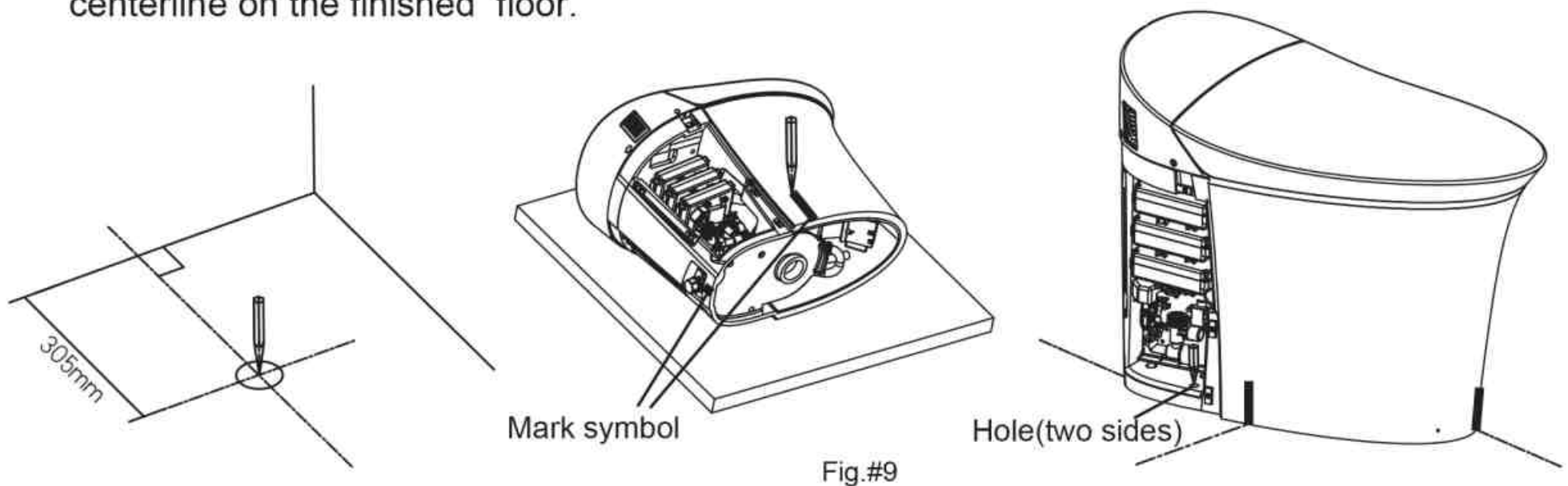

Fig.#9

- D. Drill two holes and insert two anchors and bolts.

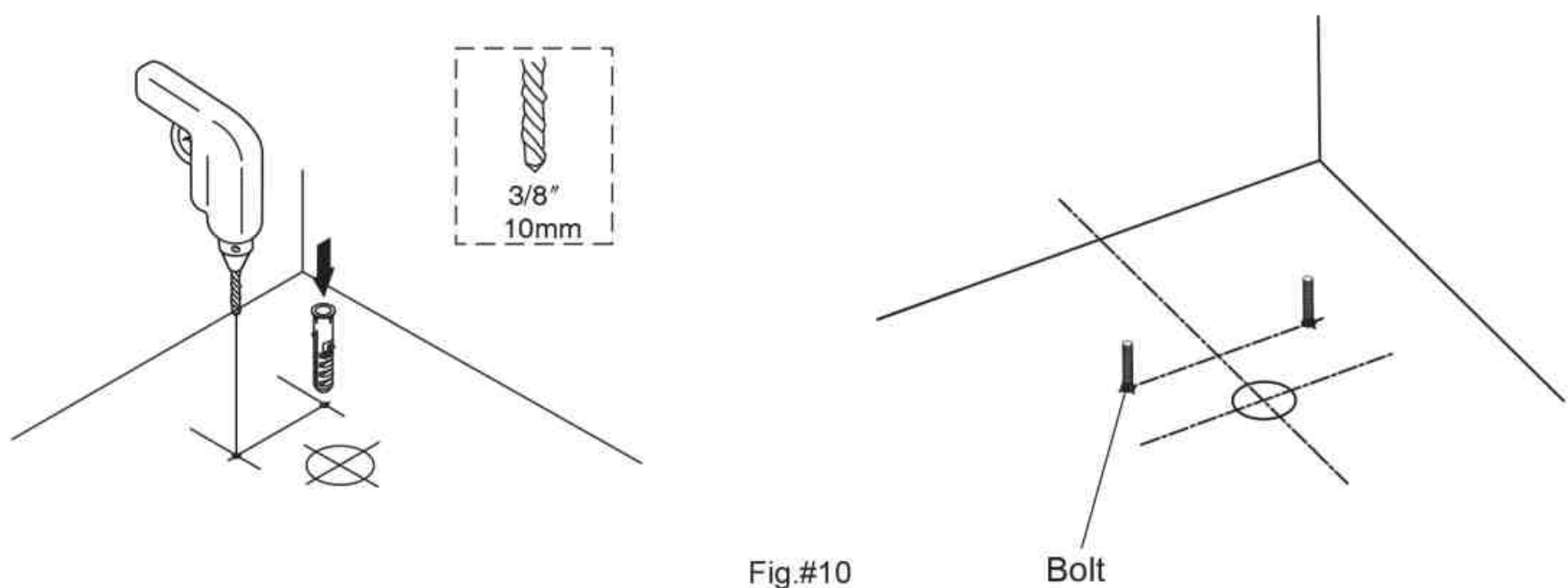





Fig.#10

Bolt

E. Install the Electrical Service and Water Supply.

-  **DANGER:** Risk of electric shock. Disconnect power before servicing.
-  **DANGER:** Risk of electrical shock. For plug-in installations/wall-mounted electrical supply: connect only to a properly-grounded, grounding-type receptacle protected by a Ground-Fault Circuit-Interrupter (GFCI). Do not remove the grounding pin or use a grounding adapter.
-  **DANGER:** Risk of electrical shock. For hardwire installations/through-floor electrical supply: Connect only to a properly-grounded, dedicated 220V/220V-240V~, 10A, 50Hz/60Hz circuit protected by a Class A Ground-Fault Circuit-Interrupter (GFCI) or Earth-leakage Circuit-Breaker (ELCB).

NOTE: This product is designed for installation with the electrical supply attached to the wall. Both types are illustrated. Refer to the dimensional information for your chosen installation.

Follow the dimensional information exactly when installing the hardwire electrical supply.

F. Install the Flange

Coated Silica gel on the opposite side of flange

Position the flange align the drain hole, and press it onto the finished floor .

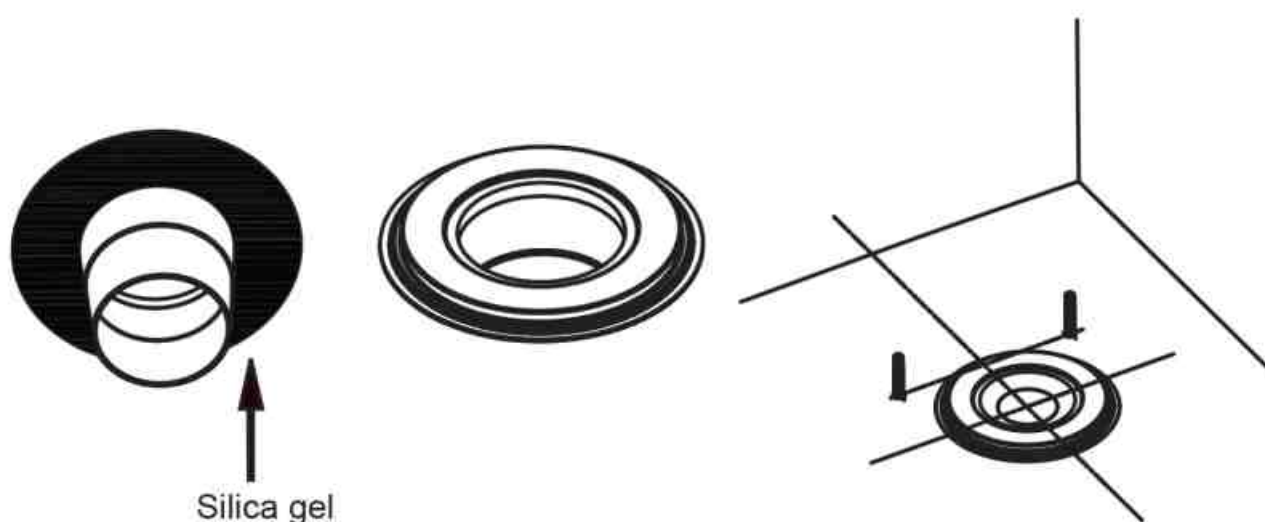

Fig.#11

G. Remove side plates

Unscrew the nut cap on the tee joint.

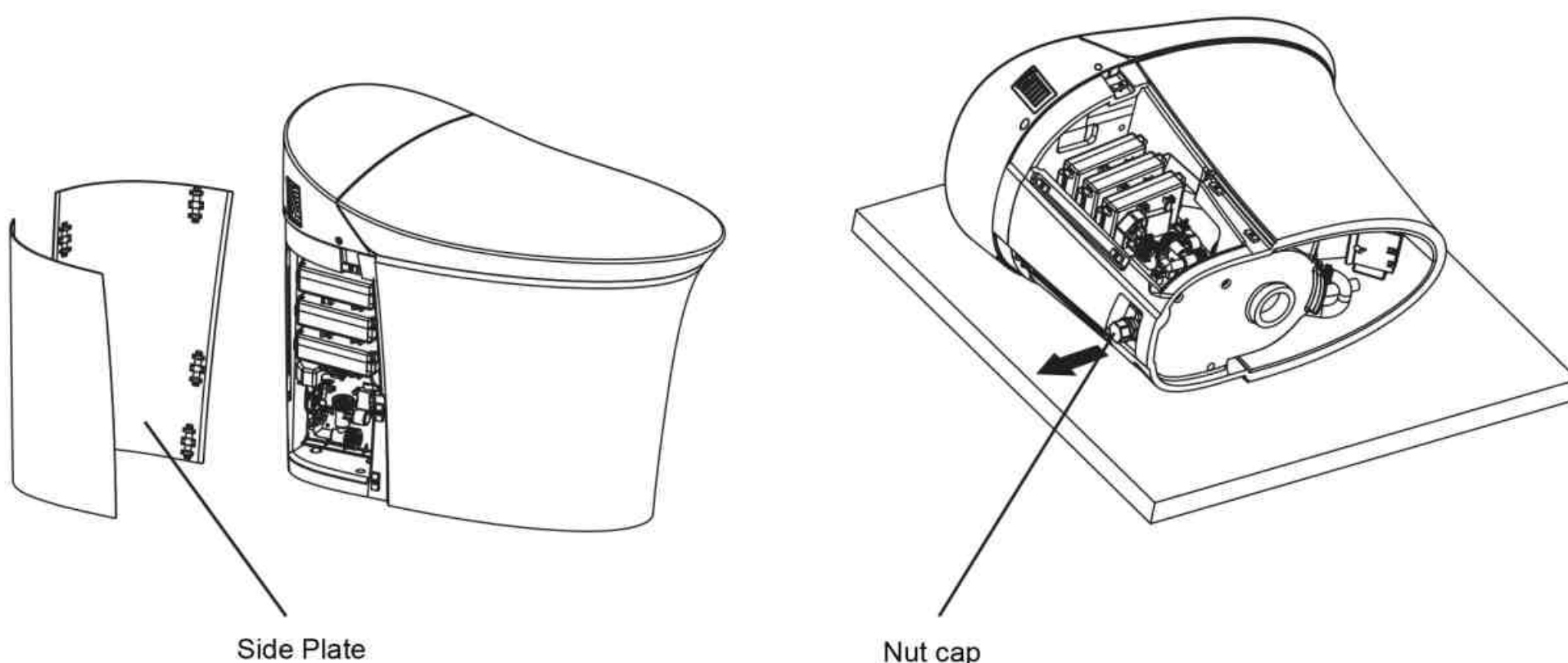

Fig.#12

H. Fix Wax Seal

Place the wax ring on the waste outlet.

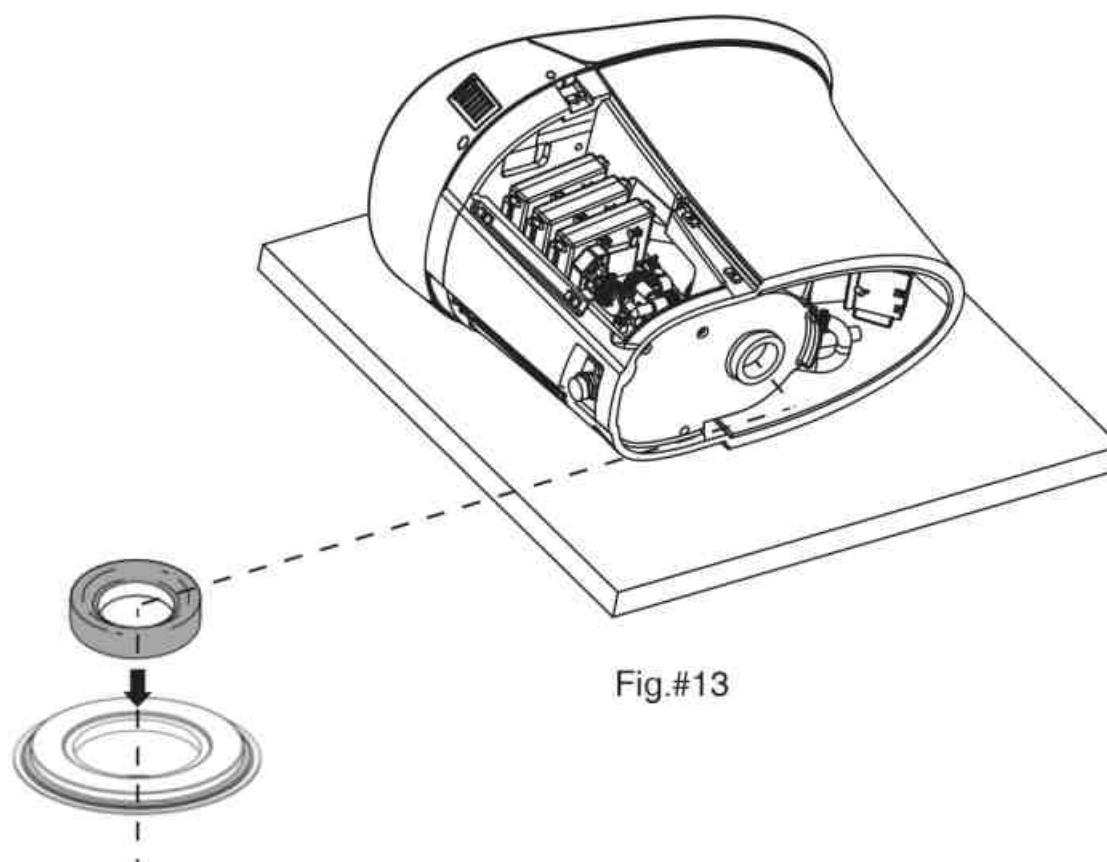



Fig.#13

I. Install the Vitreous Shell

 **WARNING:** Risk of personal injury. The vitreous shell weighs 35 kg. Use proper lifting technique when handling the vitreous shell.

 **CAUTION:** Risk of product damage. Do not set the shell down hard. Gently lift and move the shell if it is not placed correctly. If handled harshly, the shell may chip or break.

Carefully pick up the vitreous shell.

Make sure the trap way sits fully in the outlet gasket. If the vitreous shell does not sit evenly on the floor, then the trap way will not be properly aligned.

Make all adjustments gently reference the toilet side mark symbol and the drain hole centerline on the finished floor until the trapway is properly seated.

Use nut and washer to fasten the bolts and fix up the toilet.

 **CAUTION:** Risk of product damage . Do not move the toilet after the trap way is properly seated to avoid the wax seal invalidated, Change the wax seal if it is needed to move.

 **WARNING:** Risk of personal injury or product damage. Overtightening may cause breakage or chipping.

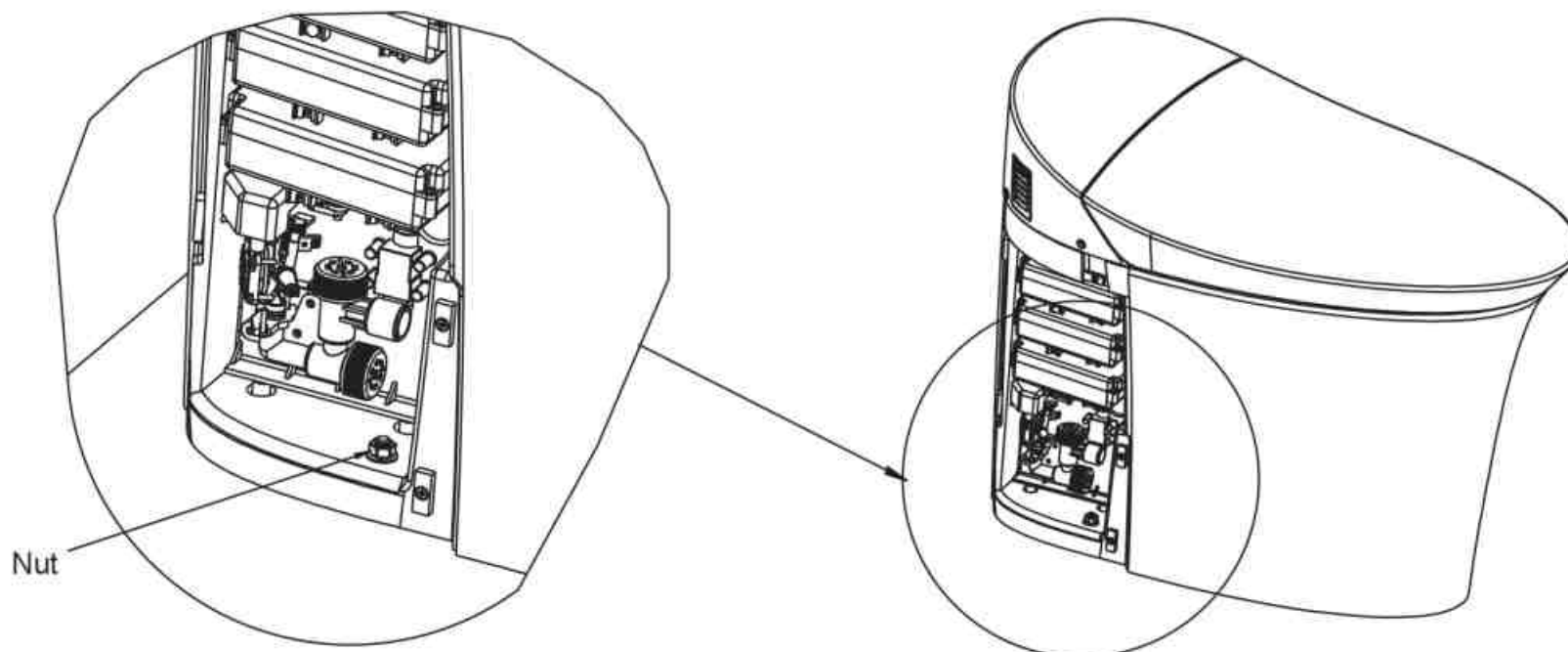

Fig.#14

J. Install Tee Valve.

IMPORTANT!

1. Dimensions in the pictures are for reference only.
2. Install Deco Cover.

Unit: mm

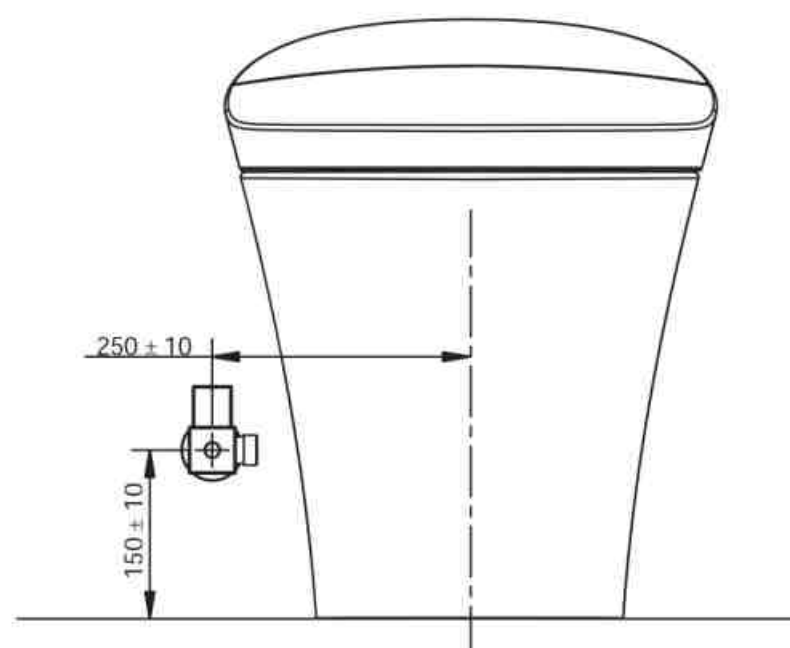
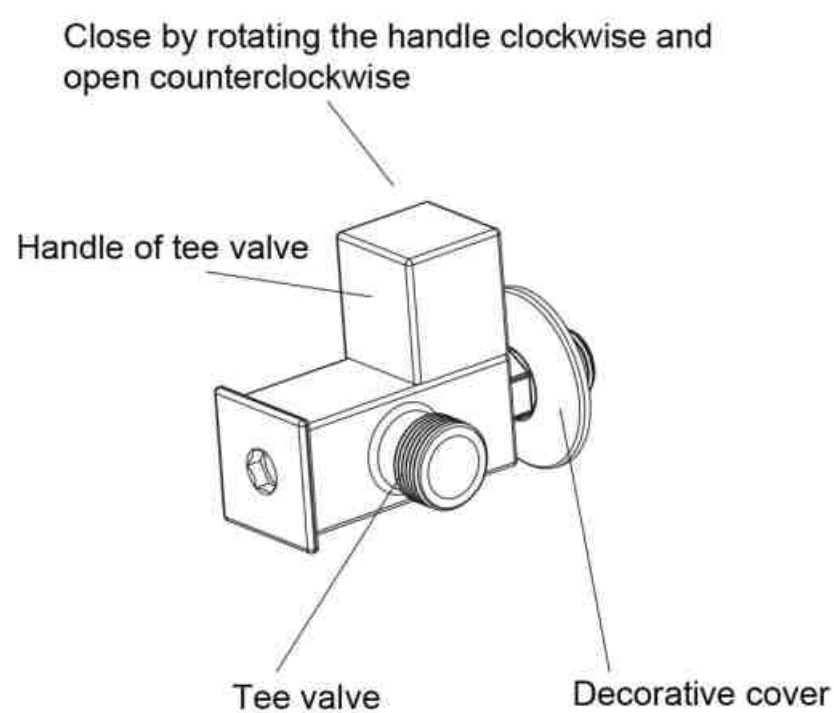

Fig.#15

K.Connect the Water

IMPORTANT!The supplied hose must be used for this installation.

1. Connect the water outlet.
2. Open the shut-off valve.

NOTE: Please do not reuse the old hose.

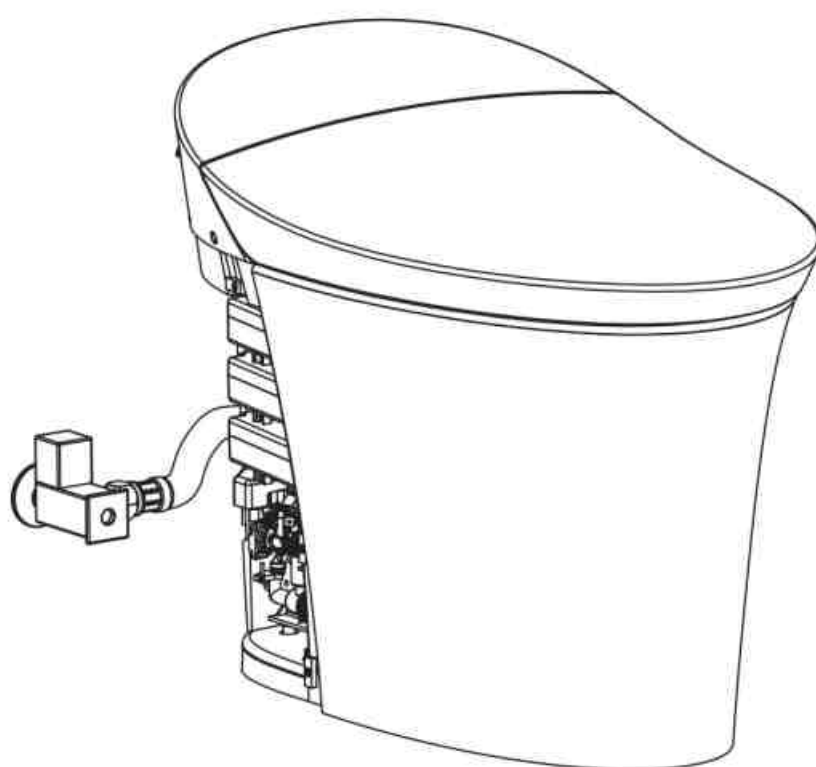

Fig.#16

- L. Test manual flush button. Press down left button for about 2 seconds, then press down right button for about 3 seconds and again press down left button for about 6 seconds to complete water flushing.

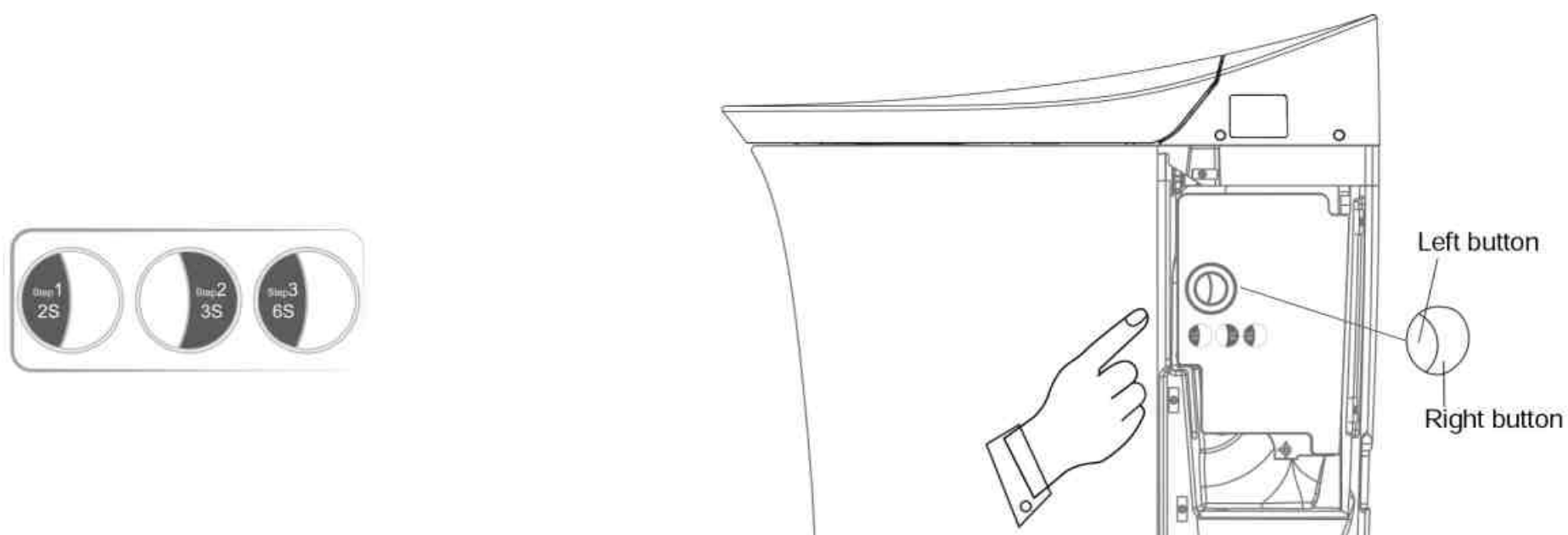

Fig.#17

- M. Finish installation by fixing the side plates. Caulk along the toilet bottom (except for the side plates.)

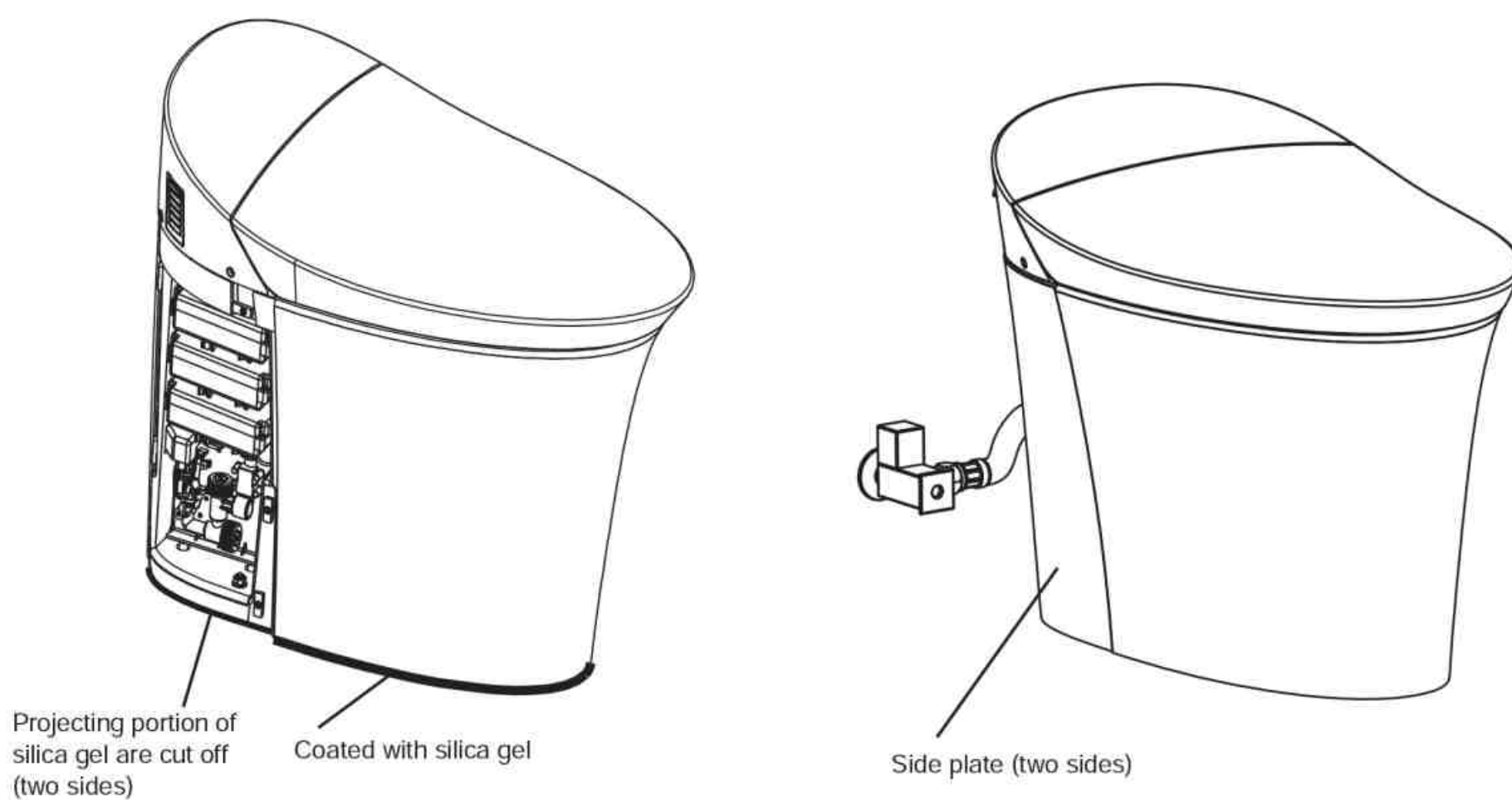

Fig.#18

INSTALLATION OF REMOTE CONTROLLER HOLDER

NOTE: If the installation wall is made of special material (such as wood board, density board and etc.), suitable fixing methods shall be adopted.

NOTE: The place to install the remote control where it will not easily be splashed by water.

Choose a mounting location for the remote holder that is easily accessible while sitting on the seat.

Drill two holes with depth larger than 45mm on the wall by drill with a diameter of 6mm in accordance with the position of screw holes on the remote control holder. Install the expansion tube into the holes.

Place the installation holder on the fixing hole.

Peel off the release paper of the double-sided tape at the back of holder.

Fix the holder with screws and install it.

Install the screw so it is covered.

Place the remote controller on the holder.



Fig.#19

Installation Steps:

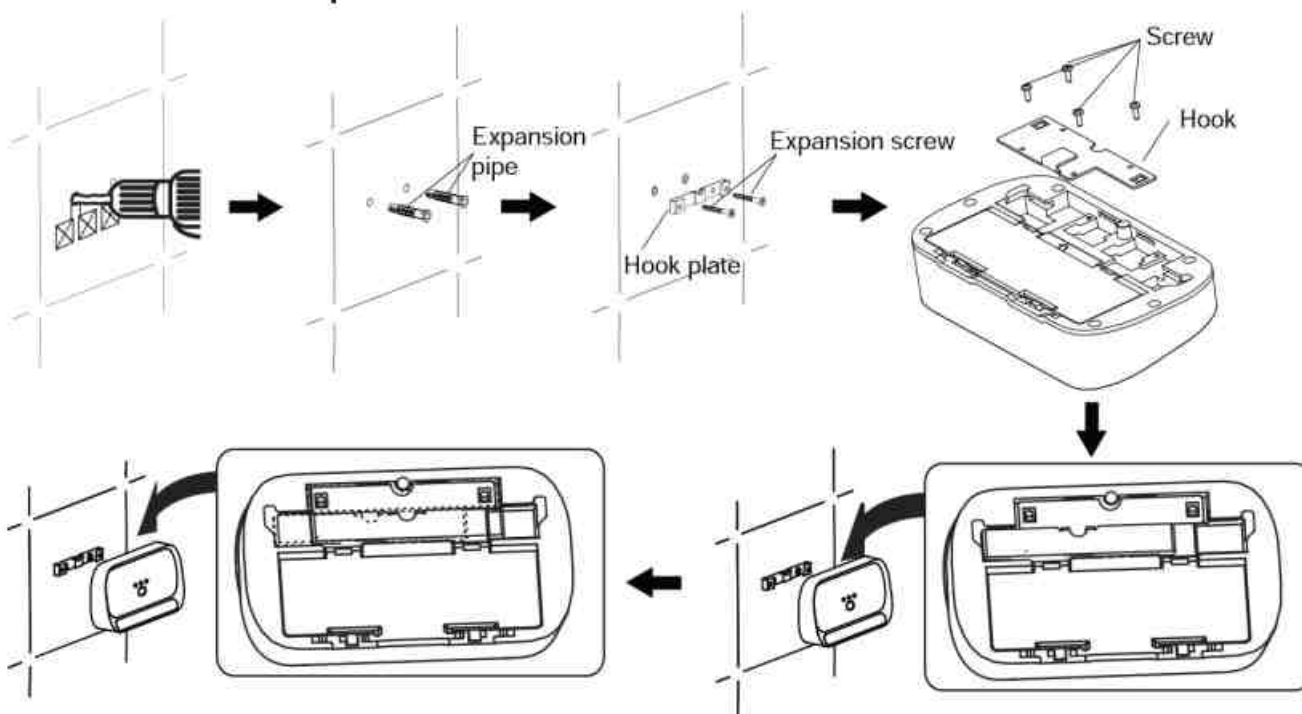
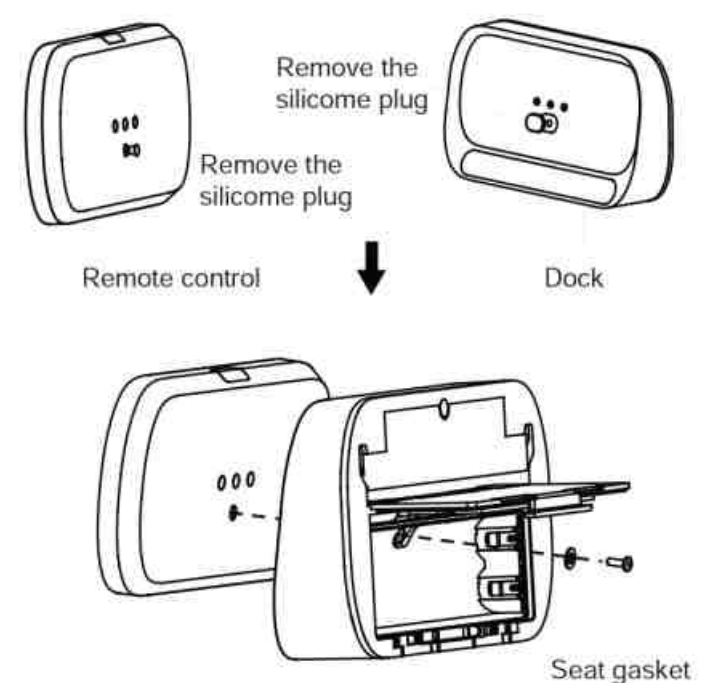

Fig.#20

Public Anti-theft Installation



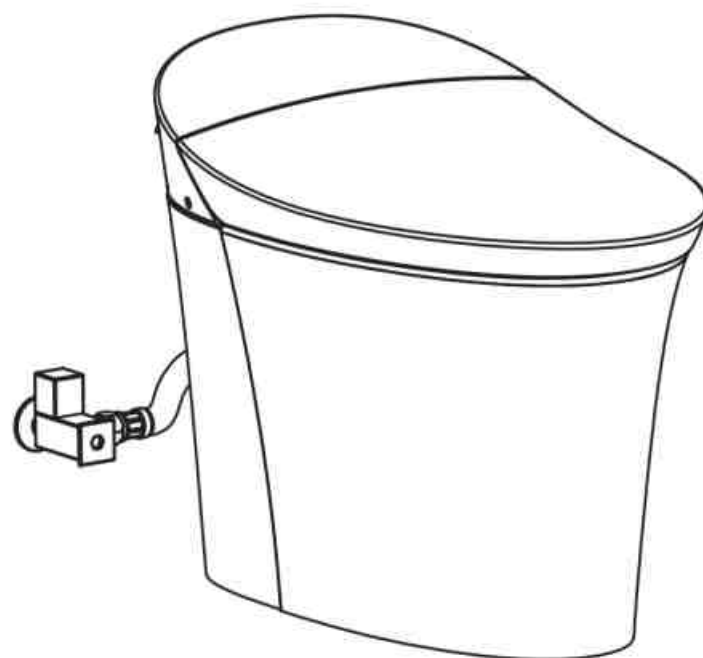

Fig.#21

Confirm that the battery has been correctly installed in the "remote controller".

Confirm that there is no obstacle in front of the product.

Wait for the host to finish the self-checking. During that time, it is normal to hear rotating sound of the motor and bicker. Self-checking completed when the light light flashes.

When it is used for the first time, product will be in default stage:

Front Wash:

- Water Temperature: mid
- Pressure: mid
- Position: Level 3

Rear Wash:

- Water Temperature: mid
- Pressure: mid
- Position: Level 3

Seat Temperature: mid

Wind Temperature: mid

Night Light: On

Energy Saving Mode: 6H

Function of Auto Lid-Turning: On

Function of Auto Flushing: On

Trouble shooting

This guide of trouble shooting is for general help only. Authorised representatives or qualified electricians of Kohler Company shall be able to solve all electrical failures. If you want to know about the service of warranty, please contact local dealers or wholesalers.

Troubles	Possible reasons	Suggestions and measures
1. Toilet not work	<ul style="list-style-type: none"> A. Power failure B. Plug not connected or no power to socket C. The leakage circuit breaker at cable plug is not reset D. Product is at standby mode 	<ul style="list-style-type: none"> A. Wait until the power is restored B. Insert the plug or detect the power socket C. Press Reset button on the plug D. Press Power button at the side. Wake up the product
2. Toilet not flushing	<ul style="list-style-type: none"> A. Water failure B. Tee valve for water supply is closed C. Power failure D. Product is at standby mode E. Wash mode is in progress F. Auto-flushing is deactivated 	<ul style="list-style-type: none"> A. Wait until the water supply is restored B. Open the tee valve for water supply C. Wait until the power is restored or check "manual flushing" to have manual flushing or by use of basin D. Press Power button at the side. Wake up the product E. Do it after the operation at wash mode is completed F. Refer to "Guide on setting of remote controller"
3. Toilet is not clean after flushing	<ul style="list-style-type: none"> A. Filter screen is blocked B. Water pressure is insufficient 	<ul style="list-style-type: none"> A. Refer to "Washing of filter screen" B. Check if all tee valves are opened. If not, please open C. Check if the inlet hoses are bent over much. In that case, adjust the hoses.
4. Wash mode is abnormal	<ul style="list-style-type: none"> A. Water failure B. Tee valve for water supply is closed or not opened completely C. Product is at standby mode D. Not yet seated or current sitting posture unable to be sensed by the seat E. Filter screen is blocked F. Water pressure is insufficient G. The toilet is in the process of flushing 	<ul style="list-style-type: none"> A. Wait until the water supply is restored B. Fully open the tee valve for water supply C. Press Power button at the side. Wake up the product D. Please be seated or adjust sitting posture E. Refer to "Washing of filter screen" F. Check if the inlet hoses are bent over much. In that case, adjust the hoses. G. Flush again after this flushing in progress
5. Flushing mode stops in the process of operation	<ul style="list-style-type: none"> A. Flushing mode stops automatically after continuous flushing for 5 minutes B. The seat is unable to sense human body 	<ul style="list-style-type: none"> A. If necessary, press again the Flushing button B. Change your sitting posture or be seated again
6. The wash mode may work even when people are not seated	<ul style="list-style-type: none"> A. The seat is covered by foreign matters or the seat is wet 	<ul style="list-style-type: none"> A. Remove the foreign matters or dry the seat
7. Dryer fan stops in the process of operation	<ul style="list-style-type: none"> A. The dryer fan stops automatically after continuous usage for 4 minutes B. The seat is unable to sense human body 	<ul style="list-style-type: none"> A. If necessary, press again the Dryer button B. Change your sitting posture or be seated again
8. Deodorization fan not work	<ul style="list-style-type: none"> A. The seat is unable to sense human body B. Stop button is pressed by mistake during operation C. Auto deodorization function is deactivated 	<ul style="list-style-type: none"> A. Change your sitting posture or be seated again B. If necessary, please leave the seat for 2S and the sit down again. C. Refer to "Guide on setting of remote controller"

9. Cover fails to be closed/opened	<p>A. The seat is covered by foreign matters or the seat is wet</p> <p>B. The toilet cover is interfered by people at the open/close process before</p>	<p>A. Remove the foreign matters or dry the seat</p> <p>B. Use the remote controller to open/close the toilet cover or do it manually until it works normally. The switch of covershall not be stopped during the open/close process</p>
10 Cover unable to be opened/closed automatically	<p>A. Users are not seated yet or leave the sensing area</p> <p>B. The function of "automatic cover-turning" of remote controller is deactivated</p> <p>C. The toilet is in the process of flushing</p>	<p>A. Please be seated yet or leave the sensing area</p> <p>B. Refer to "Guide on setting of remote controller"</p> <p>C. Wait until the flushing of toilet is completed</p>
11 Night light out of work	<p>A. The night function is turned off</p> <p>B. The indoor light is too bright</p>	<p>A. Check the section of night light at "auxiliary keyboard function" to activate the night function</p> <p>B. The night function is turned off</p>
12. UV sterilization function not work	<p>A. Human body is sensed by seat. Or the upper cover is opened.</p> <p>B. The seat is covered by foreign matters or the seat is wet</p>	<p>A. Please activate the function of UV sterilization again after leaving</p> <p>B. Remove the foreign matters or dry the seat</p>
13 Remote failure fails to display	<p>A. Out of battery</p> <p>B. Battery polarities are mounted reversely</p> <p>C. The remote controller is not woken up</p>	<p>A. Replace by new battery</p> <p>B. Reinstall properly</p> <p>C. Touch the screen of remote controller Sit near to the toilet or be seated Press Wake up key of remote controller</p>
14. Remote controller fails to control the toilet	<p>A. Lower battery</p> <p>B. The remote controller is too far from the toilet</p> <p>C. The toilet is not yet powered on</p> <p>D. The toilet itself is at standby mode</p> <p>E. The toilet is not connected to the remote controller</p>	<p>A. Replace battery by referring to the section of "Usage and replacement of battery for remote controller"</p> <p>B. Check the section of "Communication between remote controller and this machine", and get close to the toilet</p> <p>C. Power on the toilet body</p> <p>D. Press Power button at the side. Wake up the product</p> <p>E. Check the section of "Communication between remote controller and this machine", and connect the toilet and the remote controller</p>

If this toilet is to be repaired and maintained, firstly you have to:

Disconnect the plug of toilet.

If necessary, turn off the water valve.

IMPORTANT CONSUMER INFORMATION

CONSUMER RESPONSIBILITIES

If you live in a hard water area, make certain that the holes in the toilet rim are kept clean to ensure proper bowl flushing. Toilet bowl cleaners should be used at least once a week. Use a long-handled brush to clean the rim holes, and to clean as far into the trap as possible to prevent mineral deposits from forming.

Most toilet bowl cleaners are not harmful to the vitreous china or the surface of the toilet bowl. Please follow the bowl cleaner manufacturer's instructions carefully.

Do not use abrasive cleaners or solvents.



WARNING: Risk of property or product damage.

Kohler Company shall not be responsible or liable for any damage to these fittings caused by the use of cleaners containing chlorine (calcium hypochlorite).



CAUTION: Do not use any cement while installing the toilet. Heat expansion of the toilet may damage the feet of the toilet. Kohler will not be responsible for any damage because of cement use.



WARNING: Risk of product damage.

Do not throw into the toilet what that will cause the toilet to block such as newspapers and sanitary towel. Do not bump the vitreous china with great force as it will cause damage and leaking.

Do not use the product in the water below 1°C.

NOTE: Refer to "Homeowner's Guide" for the cleaning and maintenance of bidet seat.

NOTE: Flush the water supply pipes thoroughly to remove debris. Product is designed for tap water or potable water.