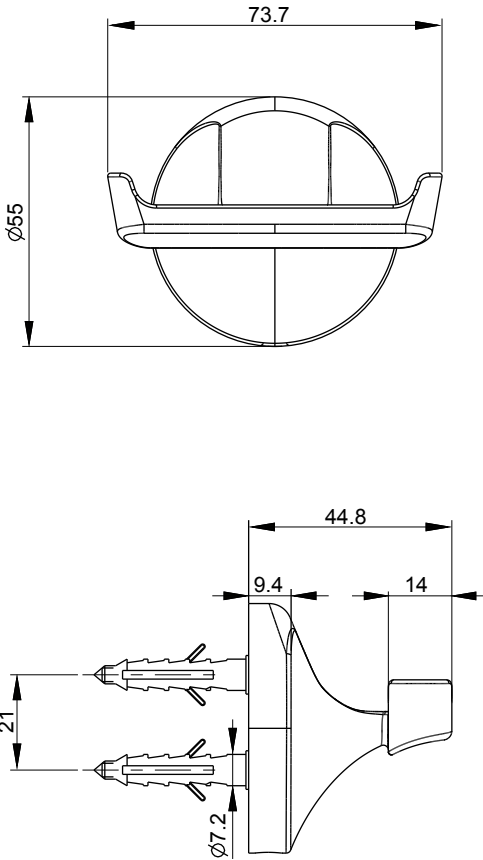

15247 DOUBLE ROBE HOOK
<div>BEFORE YOU BEGIN</div> <div>All information is based on the latest product information available at the time of publication. Kohler Co. reserves the right to make changes in product characteristics, packaging, or availability at any time without notice. Please leave these instructions for the consumer. They contain important information.</div> <div><div>NOTE:</div><div>These products should be located and mounted to a wall. While it is possible to mount them to any surface, a stud or concrete mounted product will yield the best results.</div></div> <div><div>DANGER: ( Risk of personal injury)</div><div>These products are not designed or intended for use as a grab bar or support bar. Do not install any of these products in any area where they are likely to be used inadvertently as a grab bar or support bar.</div></div>
<div>ROUGH-IN DIMENSIONS</div> <div><p>The technical drawing shows two views of the 15247 Double Robe Hook. The top view is a front elevation showing a semi-circular hook with a horizontal bar across its center. Dimensions include a width of 73.7 and a height of Ø55. The bottom view is a side elevation showing the hook's profile and mounting details. Dimensions include a total width of 44.8, a mounting hole offset of 9.4, a mounting hole diameter of Ø7.2, a mounting hole spacing of 21, and a mounting hole depth of 14.</p></div> <div>15247</div>

INSTALLATION

How To Install The Robe Hook

Select a location on the vertical wall.

Mark a center point location on the wall. Ensure two straight edges of bracket(1) are parallel and vertical. Orienting horizontal hole of the bracket up and vertical hole down. Mark anchor(2) hole locations as shown.

Drill holes in the finished wall as required.

Press the anchors(2) into the holes. Orienting the straight edges of the bracket(1) vertically, keeping the horizontal hole of the bracket up and the vertical hole down, secure the bracket with self-tapping screws(3).

Keeping screw hole of double hook(4) downward, aligning bulges of the bracket with slots of the double hook, slide the double hook onto the bracket. Tighten setscrew(5) to secure the double hook with hex wrench(6).

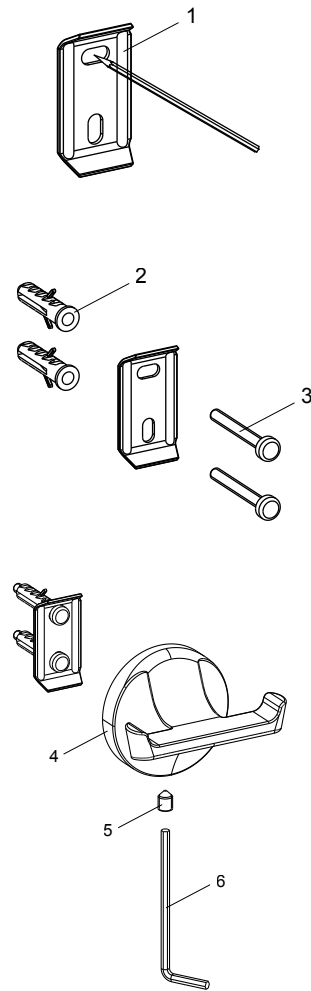

INSTALLATION CHECKOUT

Ensure that all connections are tightened.

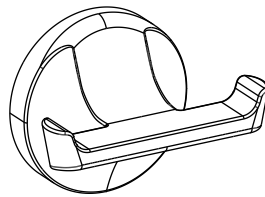

CLEANING INSTRUCTIONS

All Finishes: Clean the finish with mild soap and warm water. Wipe entire surface completely dry with a clean soft cloth. Many cleaners may contain chemicals, such as ammonia, chlorine, toilet cleaner etc. Which could adversely affect the finish and are not recommended for cleaning.

Do not use abrasive cleaners or solvents on Kohler faucets and fittings.

KOHLER®

ACCESSORY SERVICE PARTS

OLIA

Double Robe Hook

15247 DOUBLE ROBE HOOK

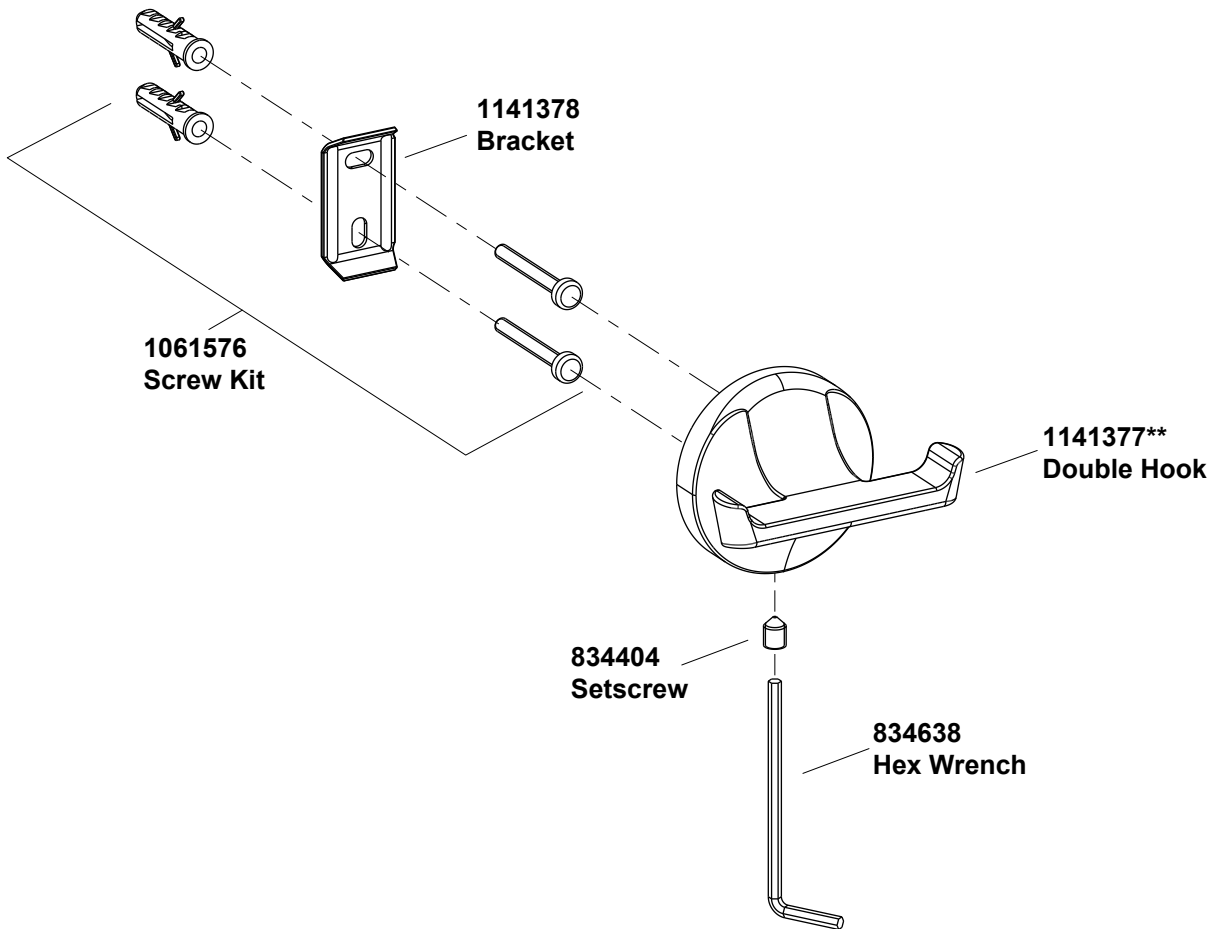

\*\*Color code must be specified when ordering