

BEFORE YOU BEGIN

安装之前

A. Introduction

- Please read these instructions carefully to familiarize yourself with the required tools, materials, and installation sequences. Follow the sections that pertain to your particular installation. This will help you avoid costly mistakes. In addition to proper installation, read all operating and safety instructions.
- All information is based on the latest product information available at the time of publication. Kohler Co. reserves the right to make changes in product characteristics, packaging, or availability at any time without notice.
- These instructions contain important care, cleaning, and warranty information-**please leave these instructions for the consumer.**
- This product complies with GB 24977-2010.
- This product complies with QB/T 2664-2004.

B. Installer Hazard Notification



CAUTION!! Risk of personal injury.

Cast iron baths are extremely heavy, and need at least 5 persons for help. When installing these products, please wear appropriate safety equipment for the risk of clipping your fingers.

A. 引言

- 请仔细阅读此说明书以熟悉所需要的工具、材料及安装顺序。遵循适合您的特定安装要求的各项内容，避免昂贵的损失。除了要正确安装外，还应阅读操作及安全说明。
- 所有的资料是按最新出版的产品资料编写而成。科勒公司保留任何时候无须通知即可改变产品特性、包装或产品可供类型的权利。
- 安装说明包括重要的安装、清洁及保养方面的内容，请把这些资料交给用户阅读。
- 本产品符合GB 24977-2010。
- 本产品符合QB/T 2664-2004。

B. 安装人员危险警告



小心!! 避免人员受伤。

铸铁浴缸非常重，需要至少5人协助完成。在安装时，有夹手风险，一定要穿戴合适的安全装备。

PRODUCT REQUIREMENTS

产品要求

A. Summary Of Key Requirements

- Observe all local plumbing and building codes.
- Provide properly-dimensioned space.
- Make sure the subfloor provides adequate support for the bathtub.
- Install the bathtub on a level finished floor.



CAUTION: Risk of product or property damage. Do not support the bath by the rim.

A. 关键要求的总结

- 遵守当地所有给排水和建筑规定。
- 提供适当的空间以安装浴缸。
- 确保安装地面为浴缸提供足够的支撑。
- 在水平地面上安装浴缸。



小心：存在产品或财产受损的危险。不要用浴缸边缘支撑浴缸。

B. Product Inspection

- Unpack and inspect bath and components for damage. Return the bath and components to the carton until installation.
- If you observe any damage, do not install the bath or the accessory. Report the specific problem to your dealer.

B. 产品检查

- 打开浴缸和配件包装并检查其是否损坏。将浴缸和配件放回包装，直至开始安装。
- 如果观察到任何损坏，请勿安装浴缸和配件。将问题告知经销商。

INSTALLATION REQUIREMENTS

安装要求

A. Tools And Materials Required (Not Supplied)

- Safety glasses
- Tape measure
- Pencil
- Level
- Blade screwdriver
- Phillips screwdriver
- Pliers
- Sealant
- Square
- Knife
- Conventional woodworking tools and materials
- Drop cloth 2 × 4's or 2 × 6's
- Water-resistant wall material
- Metal shims
- Adjustable wrench
- Hex wrench
- Rags

A. 所需工具及材料(不随货供应)

- 防护眼镜
- 卷尺
- 铅笔
- 水平尺
- 一字螺丝刀
- 十字螺丝刀
- 老虎钳
- 密封胶
- 直尺
- 美工刀
- 木工常用工具和材料
- 罩单 2x4英尺或2x6英尺
- 防水墙面材料
- 金属薄垫片
- 活动扳手
- 六角扳手
- 抹布

B. Clearance Requirements

Check the rough-in and bathroom dimensions to ensure adequate space for the bathtub installation.

B. 预留尺寸

检查产品尺寸及浴室尺寸，确保有充分的空间安装浴缸。

SITE REQUIREMENTS

安装现场要求

A. Old Bath Removal (if necessary)

A. 拆除旧浴缸(如有必要)

B. Preparation

- Determine the location of the bath.
- Make sure that the subfloor is level, and provides adequate support for the bath.

B. 独立浴缸安装准备

- 确定浴缸的安装位置。
- 确保地面水平，且能完全支撑浴缸。

IMPORTANT! To ensure a successful installation, install the bath on a level finished floor.

重要！ 为确保安装成功，请将浴缸安装在水平地面上。

C. Plumbing Preparation

Install the plumbing according to rough-in. Check the plumbing for leaks.

C. 管道的准备

将管道按安装尺寸安置。检查管道是否漏水。

INSTALL THE FREESTANDING BATH

安装独立式浴缸

1. Assemble the Claw Feet

- Thread a locknut most of the way onto a leveling bolt so the star washer faces away from the bolt head.
- Thread the leveling bolt into the bottom of a claw foot so the bolt head protrudes about 3/4" (19mm) from the bottom of the claw foot.
- Thread a setscrew into the foot several turns.

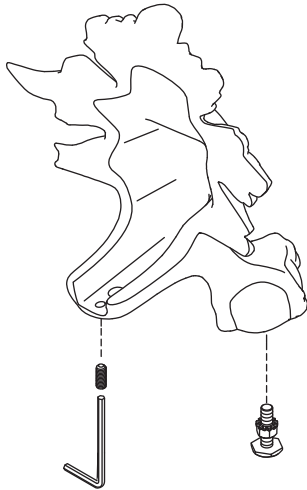

1. 组装铸铁脚

- 将锁紧螺母拧入调平螺栓中，并使星形垫圈背向螺栓头方向。
- 将调平螺栓拧入铸铁脚底部，使螺栓头突出铸铁脚底部约3/4" (19mm)。
- 将定位螺丝拧入铸铁脚几圈。

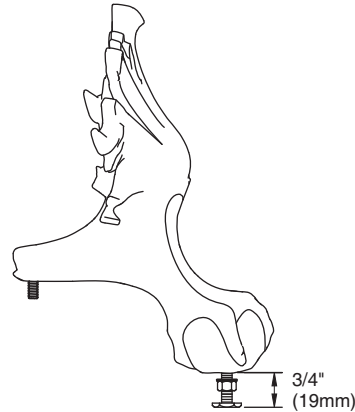

2. Prepare the Bath - Claw Feet

- With help, lift and position one end of the bath on blocks so the end of the bath is about 8" (203mm) above the finished floor.

IMPORTANT! Each claw foot is marked to identify its correct location on the bath. Refer to the illustration above.

- Position the claw foot over the lug in the correct corresponding corner of the bath.
- Thread the bolt and washer into the lug several turns. Do not tighten the bolt at this time.
- Use your hand to press the claw foot flush against the bath surface. Use a 3/16" hex wrench to turn in the setscrew until the claw foot holds flush against the bath wall by itself.
- If the claw foot does not hold itself flush against the bath wall, loosen the bolt and washer slightly, and continue turning in the setscrew.
- Repeat the foot adjustment steps until the claw foot holds itself flush against the bath wall.
- Once the foot holds itself flush against the bath wall, securely wrench-tighten the bolt.
- Repeat this procedure for the other claw foot, carefully moving the blocks to raise the other end of the bath.
- With help, carefully remove the blocks.

2. 准备浴缸-铸铁脚

- 在协助下，将浴缸的一端抬起并放置在垫块上，使浴缸的一端距离地面约8" (203mm)。

重要！ 每个铸铁脚都有标记，以确定其在浴缸上的正确位置。参考下面的插图。

- 将铸铁脚放置在正确对应的浴缸凸耳上。
- 将螺栓和垫片旋入凸耳几圈。此时不要拧紧螺栓。
- 用手将铸铁脚按在浴缸表面。使用一个3/16"的六角扳手拧紧定位螺丝，直到铸铁脚贴紧浴缸壁。
- 如果铸铁脚不能与浴缸壁贴合，稍微松掉螺栓和垫片，然后继续调节定位螺丝。
- 重复铸铁脚调节步骤，直至铸铁脚与浴缸壁贴合。
- 一旦脚与浴缸壁贴合，拧紧螺栓。
- 对于其他铸铁脚重复此过程，请小心地移动垫块升高浴缸另一端。
- 在协助下，小心地移除垫块。

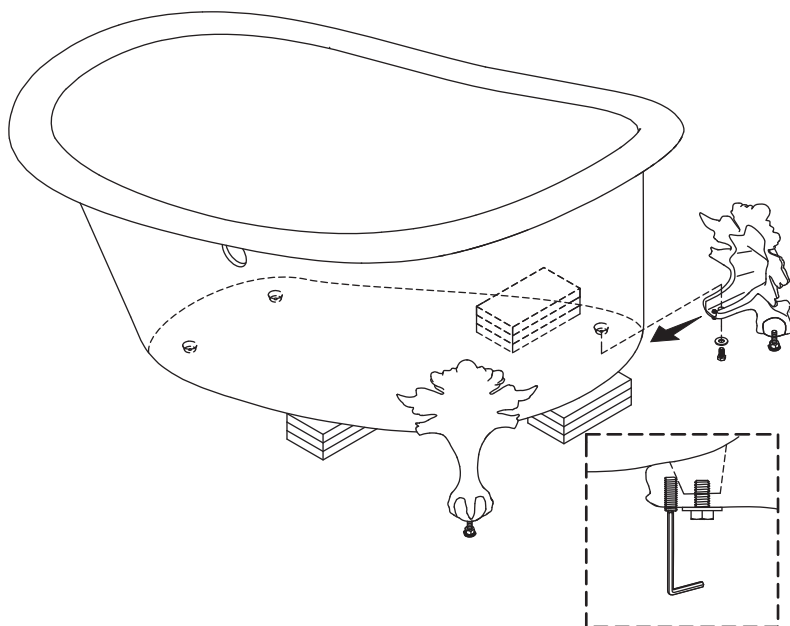
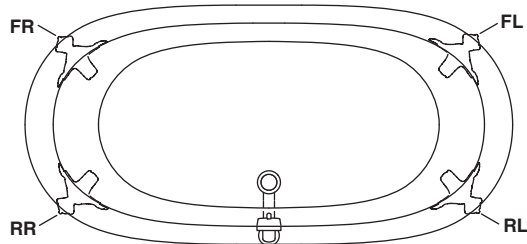

3. Install the Bath - Claw Feet

IMPORTANT! Do not damage the feet by dragging or sliding the bath across the floor.

- Install the drain according to the installation instructions included with the drain.

IMPORTANT! Get sufficient help to lift this bath into place.

- With help, carefully lift the bath into position over the drain and water supply locations.
- Use a 6" (183mm) level to check for level across the width and length of the bath rim.
- Turn one or more levelers in or out slightly as needed to adjust the bath for level, and to eliminate any gaps between the feet and the floor.
- Turn the locknuts up against the bottom of the claw feet, and securely wrench-tighten.

3. 安装浴缸-铸铁脚

重要！ 不要在地面上拖曳或滑动浴缸，以免损坏铸铁脚。

- 按照排水附带的安装说明书安装排水。

重要！ 在足够的帮助下将浴缸抬到合适的位置。

- 在协助下，小心地将浴缸抬到排水和进水口位置。
- 使用一个6" (183mm) 水平仪沿浴缸边缘宽度和长度方向检查浴缸水平度。
- 视乎需要，旋转一个或多个调平螺栓调节浴缸水平度，并消除脚和地面之间的间隙。
- 将防松螺母旋到铸铁脚底部并拧紧。

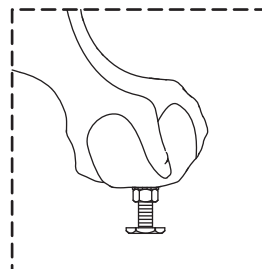
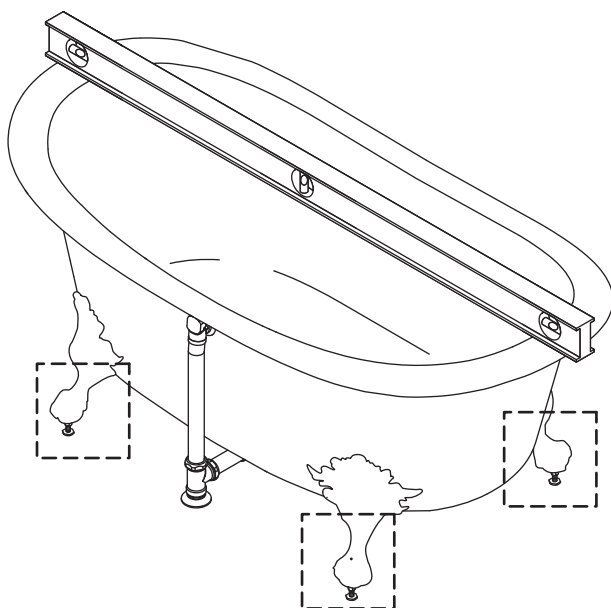

INSTALL THE PLUMBING

1. Install the plumbing
 - Refer to the installation instructions of K-7159T.
2. Open the hot and cold water supplies and check all connections for leaks.
3. Run water into the bath and check the drain connections for leaks.

安装管道

1. 安装卫生管道
 - 参照K-7159T排水安装说明书。
2. 开启冷热水水管，然后检查所有连接是否渗漏。
3. 浴缸中放水，检查落水连接是否渗漏。

COMPLETE THE INSTALLATION

Cast Iron Surfaces

When cleaning up after installation, do not use abrasive cleaners, as they may scratch and dull the bath surface. Use warm water and a liquid, non-abrasive detergent to clean the surface.

 **CAUTION:** Do not allow cleaners containing petroleum distillates to remain in contact with the surfacer long periods of time.

Remove stubborn stains, paint, or tar with turpentine or paint thinner.

Remove plaster by scraping with a wood edge. Do not use metal scrapers, wire brushes, or other metal tools. You can use a powder-type detergent on a damp cloth to provide mild abrasive action to any residual plaster.

完成安装

铸铁表面

在安装完成后进行清理时，请勿使用磨损性的清洁用具，以免擦伤浴缸表面，使其失去光泽。使用温水和非磨损性的液体清洁剂，清洗浴缸表面。

 **小心：**请不要让含有汽油溶解物的清洁剂和浴缸长时间接触。

使用松节油或涂料稀释剂去除顽固的污渍、油漆或沥青。

滞留水泥可用薄木刀刮掉。请不要使用金属刮刀，钢丝刷，或其它金属工具，对残留的灰泥，可用湿布粘些洗衣粉，以提供轻微的研磨作用。

IMPORTANT CONSUMER INFORMATION

The Safeguard slip resistant surface on this bathtub meets or exceeds the requirements of ASME/ANSI for A112.19.1M slip resistance.

DANGER!! Improper maintenance or cleansers may permanently remove the slip resistant surface on Kohler bathtubs.

NOTICE: All housekeeping and maintenance employees must be trained in the proper cleaning of Kohler bathtubs. Post a copy of this notice in a readily-visible location.

DO NOT use steel wool, wire brushes, metal scrapers or abrasive sponge pads to clean a Kohler bath tub.

DO NOT use buffing machines on the slip resistant surface.

DO NOT use high alkaline or strong acid cleansers.

DO NOT use abrasive cleansers.

- Use only non-abrasive cleansers and a soft nylon brush to clean the slip resistant surface.
- When using commercial cleansers, use cleansers with a pH of between three and eight.
- Follow cleanser manufacturer instructions very carefully.

重要的用户资料

浴缸的Safeguard防滑表面达到或超过ASME/ANSI A112.19.1M对防滑表面的要求。

危险！！ 不适当的维护或清洁剂的使用可导致科勒浴缸的防滑表面永久失去。

注意：所有的清洁和维修人员都应当进行正确清洗科勒浴缸的培训。请将此注意事项的复印件张贴在显著的位置。

请勿 使用钢丝绒，钢丝刷，金属刮刀或有磨损性的海绵垫清洗科勒浴缸。

请勿 在防滑表面上使用抛光仪器。

请勿 使用强碱或强酸性的清洁剂。

请勿 使用磨损性的清洁剂。

- 请使用没有磨损性的清洁剂和软尼龙刷清洗浴缸的防滑表面。
- 请使用pH值3和8之间的清洁剂(若要使用商业用清洁剂时)。
- 请仔细按照清洁剂生产厂家的说明书进行清洗。