

74053K-4 Tube Spout Kitchen Faucet
<div><div>BEFORE YOU BEGIN</div><div><p>All information is based on the latest product information available at the time of publication. Kohler Co. reserves the right to make changes in product characteristics, packaging, or availability at any time without notice.</p><p>Please leave these instructions for the consumer. They contain important information.</p><p>NOTE:</p><ol style="list-style-type: none">1. Inspect the supply pipes for damage and leakage. Replace and maintain as necessary2. Flush the water supply pipes thoroughly to remove any debris.3. If possible, install this faucet before installing sink.</div></div>
<div><div>HANDLE OPERATION</div><div><p>Open the handle gently. Turn clockwise for cold water, turn counter-clockwise for hot water.</p></div></div>
<div><div>ROUGH-IN DIMENSIONS</div><div><p>The technical drawing illustrates the rough-in dimensions for the Kohler Taut 74053K-4 Tube Spout Kitchen Faucet. It includes two views: a front view on the left and a side view on the right. The front view shows a curved spout with a 22° angle, a height of 232, a spout length of 182, and a total height of 323. The base has a diameter of Ø33~Ø36 and a maximum height of 40. The side view shows a handle height of 70, a base diameter of Ø45, a base height of 115, a spout height of 138, and a total height of 560. The faucet is shown with G3/8" and G1/2" connections.</p></div></div>

INSTALLATION

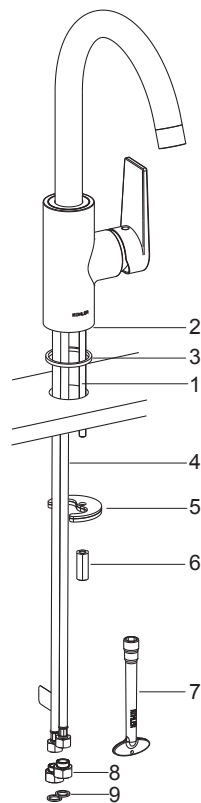

Install the mounting stud(1) into the faucet body base(2). Insert the washer(3) under the body assembly. Insert the flexible supply hoses(4) into the sink.

From underside of the sink, place the washers(5, rubber washer is on the top) and the nut(6) onto mounting stud. Position the faucet so that the handle is on the right side. Tighten the nut by tool(7) to secure the faucet.

Install the adapters(8) with washers(9) into the supplies if needed. Attach the hoses to water supplies. The hose with "COLD" label is for cold water.

INSTALLATION CHECKOUT

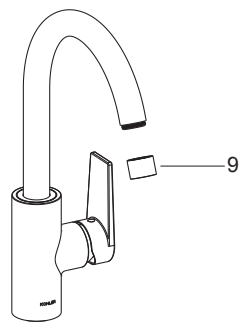

Ensure that all connections tightened and the handle is in the off position.

Open the drain. Turn on main water supply and check for leaks. Repair as required.

Remove the aerator(9). Turn the faucet handle on. Run hot and cold water through the spout for about one minute to remove any debris. Remove debris from the aerator. Shut off the faucet and reinstall the aerator.

CLEANING INSTRUCTIONS

All Finishes: Clean the finish with mild soap and warm water. Wipe entire surface completely dry with clean soft cloth. Many cleaners may contain chemicals, such as ammonia, chlorine, toilet cleaner etc, which could adversely affect the finish and are not recommended for cleaning.

Do not use abrasive cleaners or solvents on Kohler faucets and fittings.

"LEAD FREE" is marked on the back of the faucet signifying its compliance with the United States AB1953

74053K-4 Tube Spout Kitchen Faucet

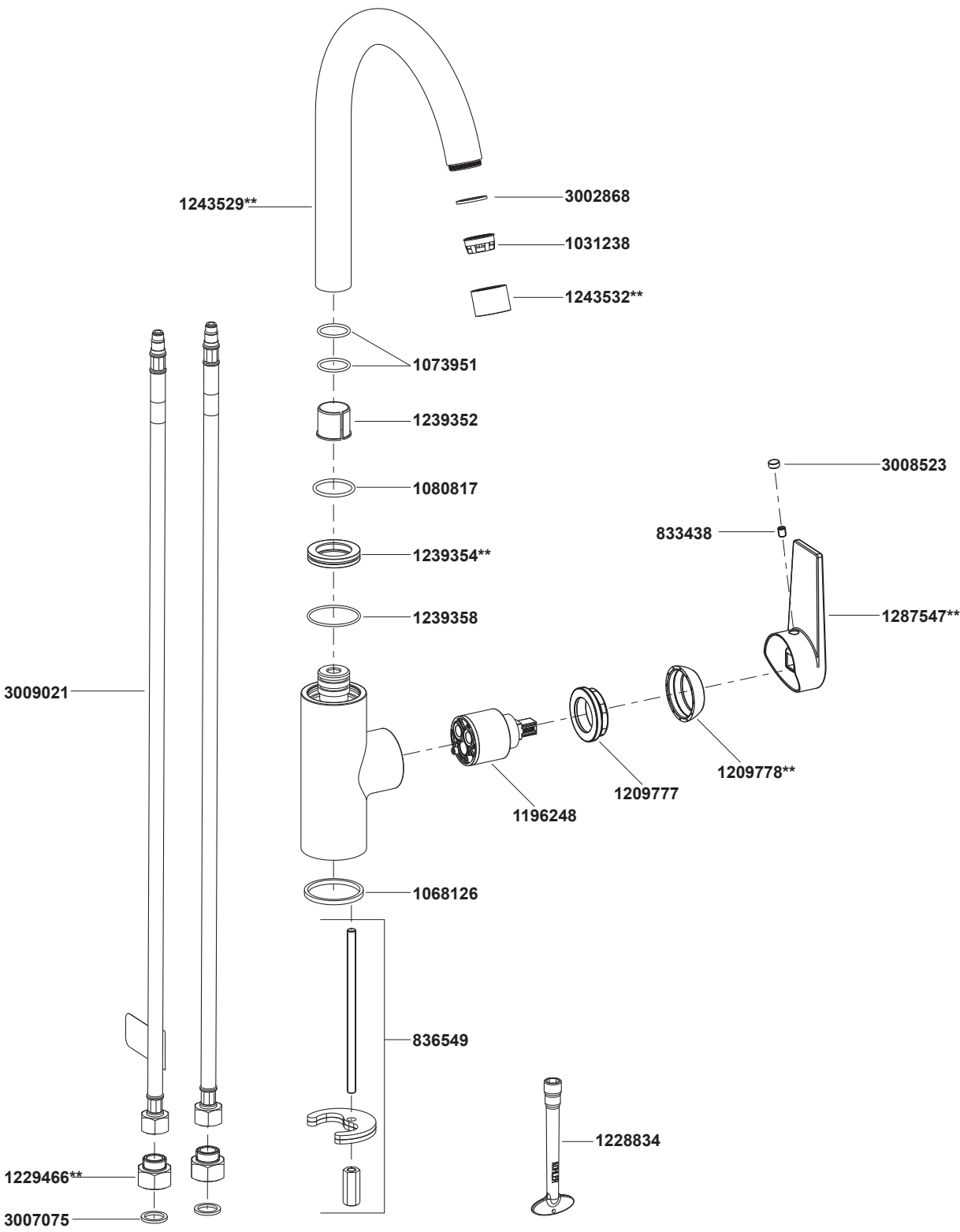

**Color code must be specified when ordering