

BEFORE YOU BEGIN

安装之前

- Read installation guide in illustration and word file carefully, and install the tank according to instructions in the guide to avoid product damage and installation inconvenience caused by inappropriate operation.
- All data contained is based upon the last product information available at the time of publication. Kohler Company reserves the right to implement changes of product characteristics, packaging and availability at any time without further notice.
- Do not apply erosive cleanser and solvent in the tank, which will damage tank spares and result in leakage in the tank. Kohler will not be responsible for any damage related to above mentioned cleanser or solvent.
- Do not apply spares that are not provided by Kohler, and please note that glass adhesive tape shall not be applied to the installation of Kohler spares. Kohler will not be responsible for any damage related to installation with spares not provided by Kohler.
- Water temperature: 1°C~45°C, environment temperature: 1°C~55°C.
- This product complies with GB26730-2011.
- 请仔细阅读图示说明及文字安装说明，按照说明书的步骤安装，以避免产品损坏或不良操作导致安装不便。
- 所有的资料是按出版时的最新产品资料编写的，本公司保留在任何时候不需通知便可更改产品的特征、包装或供应产品的权利。
- 请不要在水箱内使用具有腐蚀性的清洁剂或溶剂，否则会严重地损坏水箱配件，导致漏水。因使用上述清洁剂或溶剂而使水箱不能正常使用或出现其它连带性的损坏，本公司恕不负责。
- 请不要采用非本公司提供的零件，如玻璃胶等不能用于本公司配件的安装。因使用非本公司提供的零件安装而本公司产品导致的损坏，本公司恕不负责。
- 使用水温1°C~45°C，环境温度1°C~55°C。
- 本产品符合GB26730-2011。

Ordering Information

ODEON In-Wall Tank(Without Iron Rack)K-6286T
 RATIO In-Wall Tank Faceplate(Not Supplied)K-6283T
 BEVEL In-Wall Tank Faceplate(Not Supplied)K-8854T

订购信息

奥帝安入墙式隐藏水箱(不含固定支架).....K-6286T
 瑞舒隐藏水箱面板(可选配).....K-6283T
 贝芙隐藏式水箱面板(可选配).....K-8854T

Function Explanation

- Anti flow-backwards
- Adjustment of inlet water level
- Adjustment of flushing volume
- Single/double gear flushing
- Water usage of K-6286T: 3/6L
- Assemble, disassemble and maintenance can be done without tools

功能说明

- 防倒流功能
- 进水水位可调节功能
- 冲水水量可调节功能
- 双档冲水功能
- K-6286T水量: 3/6L
- 无需工具用手即可实现拆装维修

Design And Installation Concept Of In-wall Tank

隐藏水箱设计安装概念

- Installation of in-wall tank is much easier and nice-looking comparative to that of traditional tank. Meanwhile, the space layout will be more reasonable due to the application of in-wall tank pipes and connectors.
- The most remarkable advantage of in-wall tank is that the installation will never be limited to certain area, and can be installed wherever as you wish, which will make the bathroom layout more reasonable and nice-looking, and make good use of every inch of the bathroom space.
- 隐藏式水箱提供了简单快捷的安装方式，与传统的安装方式相比更完善、更美观。同时由于使用了隐藏式的管路布置，使空间布局更为合理。
- 使用隐藏式水箱的显著优点是不再限于某一固定的地方安装，可以灵活地设置，从而可以使整个浴室布局更为合理、更为美观，充分利用每一寸可用空间。

KOHLER CHINA INVESTMENT CO., LTD NO.158, JIANG CHANG SAN ROAD,
 JING'AN DISTRICT, SHANGHAI, PRC POST CODE: 200436
 科勒(中国)投资有限公司 上海市静安区江场三路158号 邮编: 200436

Advantages Of In-wall Tank

- Made of macromolecular materials that prevents corrosion and leaking.
- Adjustable dual flush design which conserves water.
- Sustainable to pressure of 400 kg.
- Will not affect the structure of the wall and provides excellent sound insulation.
- Easy installation and time efficient.
- Do not need to prepare any other spare parts.
- Easy maintenance and servicing.
- Clean, garbage free, and space saving.

隐藏式水箱的优点

- 抗冲击，耐腐蚀的高分子材质水箱，杜绝漏水的可能性。
- 可调双冲设计，有效节水功能。
- 可承受400公斤的压力。
- 不影响墙体结构，出色的隔音效果。
- 安装简便、快捷，省时省力。
- 无需准备其它的安装配件。
- 维护简易，无需改动墙体。
- 卫生清洁，无垃圾陈积，节省空间。

RECOMMENDES TOOLS AND MATERIALS

- Open end/adjustable wrenches
- Allen wrench
- Knife
- File
- Hacksaw
- Masonry
- Level
- Screw driver
- Insulation tape
- Tape measure
- Seal tape
- Bushing
- Lubricant

所需工具及材料

- 开口/活动扳手
- 内六角扳手
- 美工刀
- 锉刀
- 钢锯
- 冲击钻
- 水平尺
- 十字螺丝刀
- 绝缘胶布
- 卷尺
- 生料带
- 电工套管
- 润滑油

ROUGHING-IN

尺寸图

Reference Value
参考值

UNIT: mm
单位: 毫米

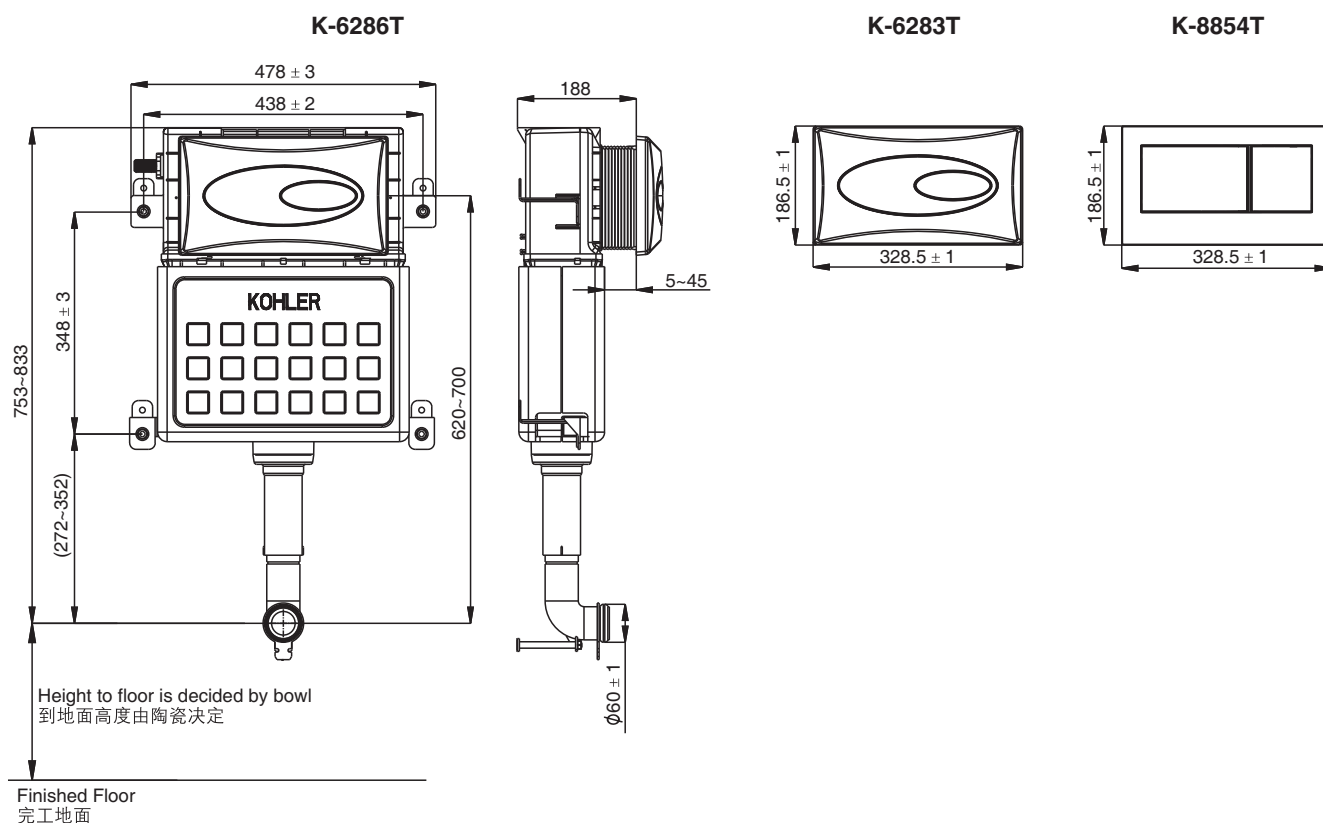

Kohler reserves the right to change marked dimensions without prior notice.
科勒公司保留随时变更图中标示尺寸的权利，无需另行通知。

INSTALLATION

安装

1. Make sure of h according to dimensions of bowl and then locate the installation hole of fixing bracket. Mark on the wall for appropriate position for fixing bracket, and drill four holes with diameter of 10mm and depth of 80mm with churn drilling as shown in illustration, and fill in the holes with bulge screw and tighten the screw to set the fixing bracket.

Note: 1. Ensure the fixing bracket to remain level.
2. Adjust the syphon 0~80mm short if necessary.

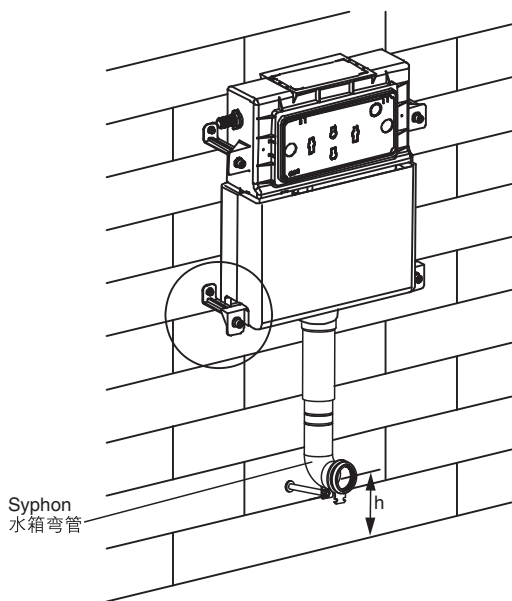

1. 如图首先根据座便器的尺寸确定高度 h ，进而确定固定托架的安装孔。在墙壁上把固定托架的安装孔作记号后，用冲击钻钻四个 $\varnothing 10\text{mm}$ 深80mm的小孔，然后装上膨胀螺丝，再把固定托架装在膨胀螺栓上拧紧螺母。

注：1. 固定托架要保持平衡。
2. 水箱弯管可根据需要调整0~80mm。

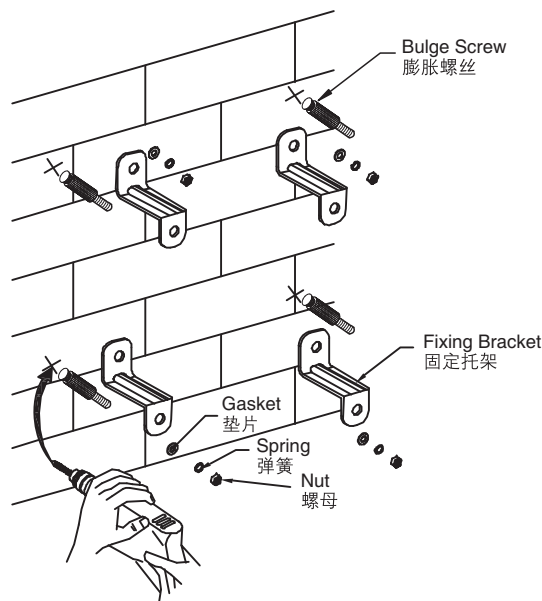

2. Put the tank onto the fixing bracket as shown in the right figure and adjust the tank to level. Then tighten screws with hex-head key. Note: it is a must to keep the tank level.

Connect the inlet hose with tank inlet pipe.

Note: 1. Ensure water tank internal valve is OFF.
2. Suggestion: connect a temporary rubber or plastic hose on valve, flush water supply pipeline. Ensure water is clean, no residual sand stone or fouling inside pipeline.

2. 如图把水箱放在固定托架上，用水平尺调整水箱平衡，再用六角匙将螺丝拧紧。注：水箱一定要保持平衡。

如图将自来水编织管装在水箱连接管上供水。

注：1. 确保水箱内部进水角阀为关闭状态。
2. 建议在连接供水时，在角阀上连接一个临时橡皮或塑料软管，冲洗供水管道，确保管路中的水干净，管道内无沙石、垢污等。

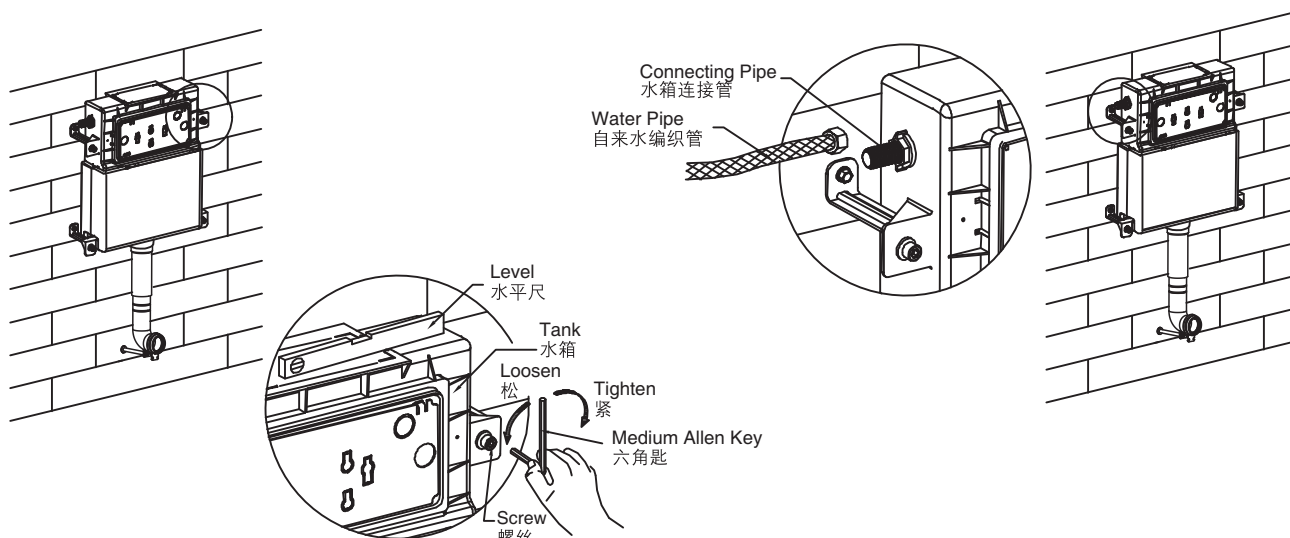

3. Install the mask in the block screen of the tank, and tighten the screw to fix mask to the tank.

3. 如图将方形罩装在水箱的挡盖里，再拧紧螺丝使方形罩紧固在水箱上。

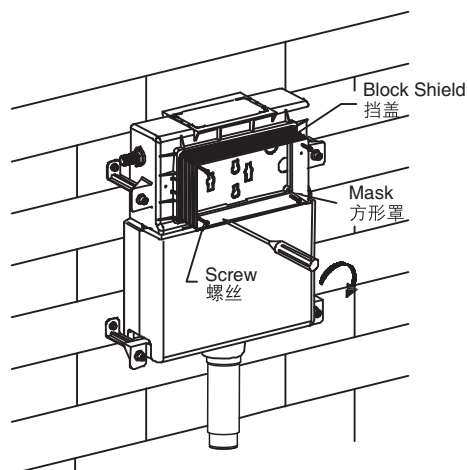

4. Insert the inlet pipe and drainage pipe into the bowl, and then adjust the syphon and drainage pipe to a proper position to be fixed into the bowl. Make sure of the positions of syphon and discharge elbow and then remove the bowl.

4. 如图将进水管和排污管装入座便器，然后调整水箱弯管及排污弯管到合适位置后装入座便器，以确定水箱弯管及排污弯管的位置，拆下座便器。

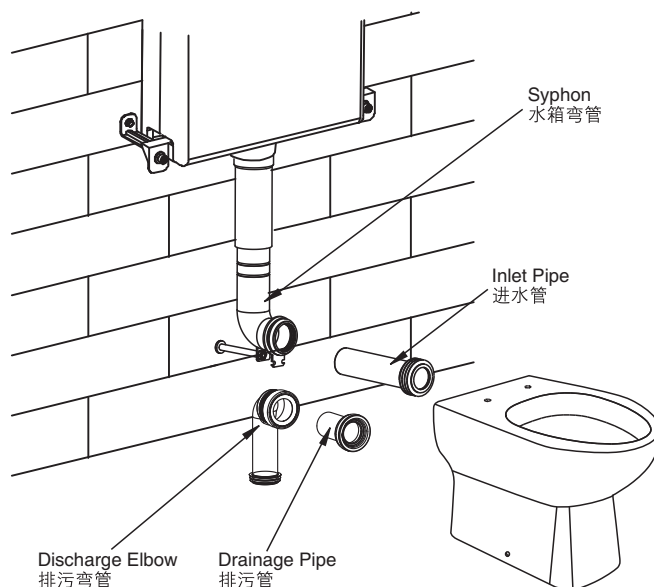

5. When finishing the brickwork, eliminate unwanted part of mask, drainage pipe and inlet pipe.

5. 如图砌完墙后，将方形罩及进水管和排污管多余的长度用水口刀锯掉。

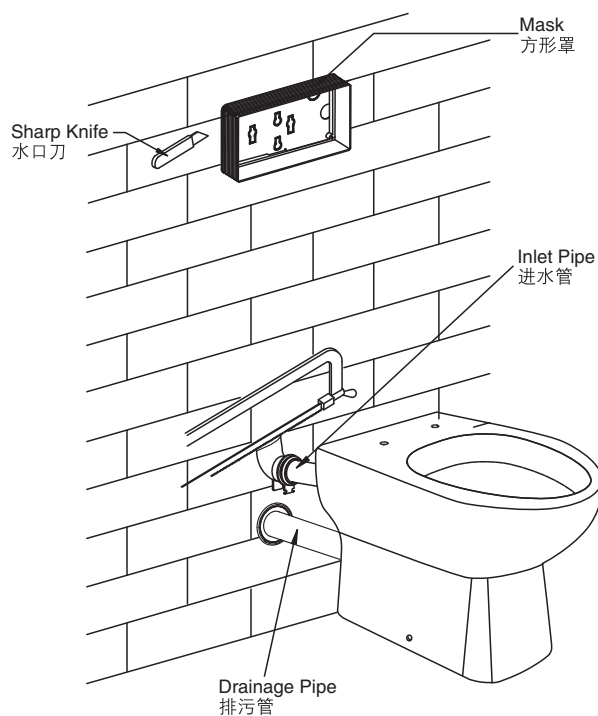

6. When fixing the adjustable board to block shield, the locknut should be put directly on positong of the sign of "OPEN".

Remark: Stir pole shall remain level.

6. 如图将调节板装上挡盖时，锁紧管要对准标识“OPEN”字样才装上。
注：挑杆要保持平衡，不能向后翘起。

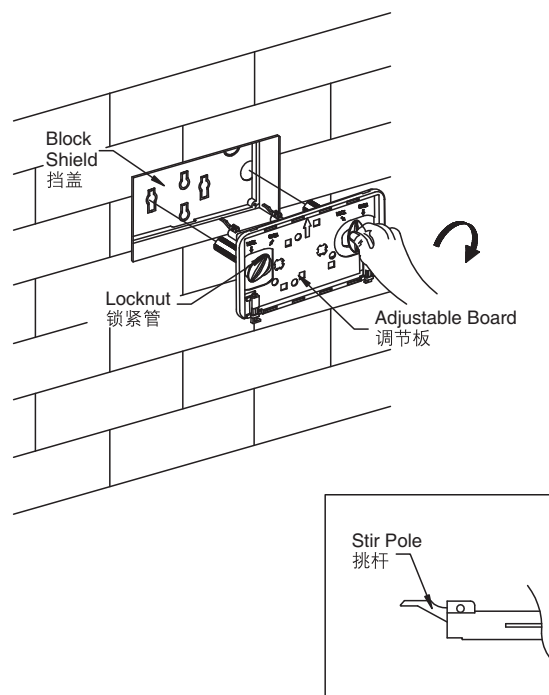

7. Fix the adjustable board on the wall by tightening the locknut as shown in the illustration. And the locknut should be directly put on the position of the sign of "LOCK". (Signs are marked on the adjustable board, please refer to the indications in installation)

7. 如图用手旋转锁紧管使调节板固定在墙壁上。锁紧管对准“LOCK”标识才固定好。（调节板已有标识，请安装时请按标识进行）

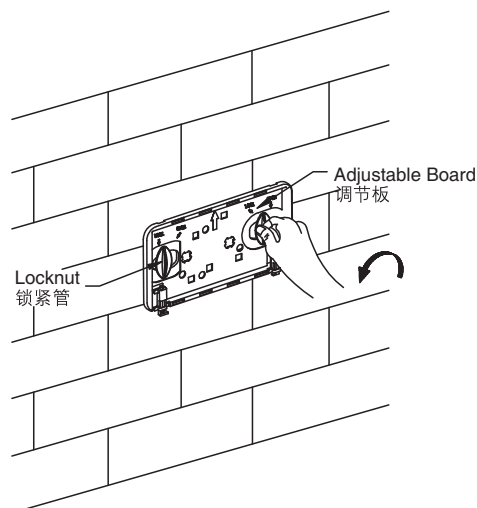

8. Install the faceplate as shown in the illustration. Put the lock on the faceplate directly on the reversed lock on adjustable board, then push the faceplate and lock it. The installation shall begin from bottom to top.

8. 如图安装面板。将面板扣位对准调节板的倒扣锁，然后用力向上推再向前扣紧。安装时要从下而上安装。

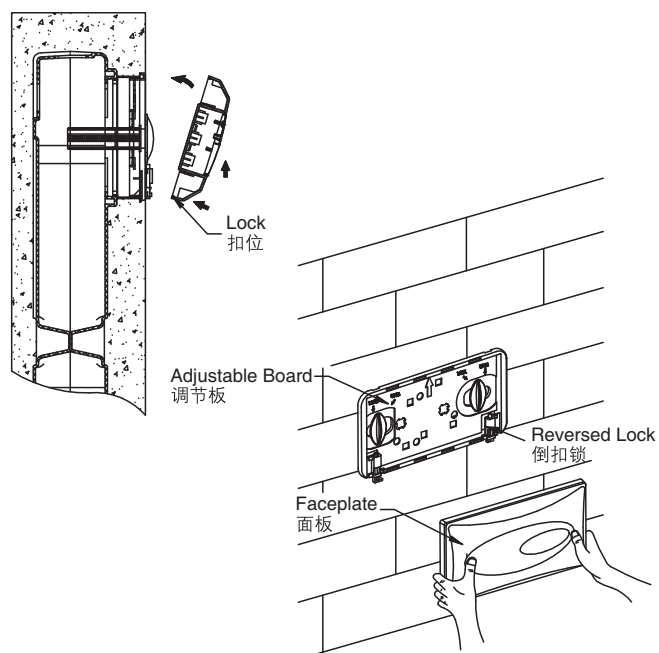

9. In-wall tank toilet is ready to be put into use.

9. 安装完毕可以使用。

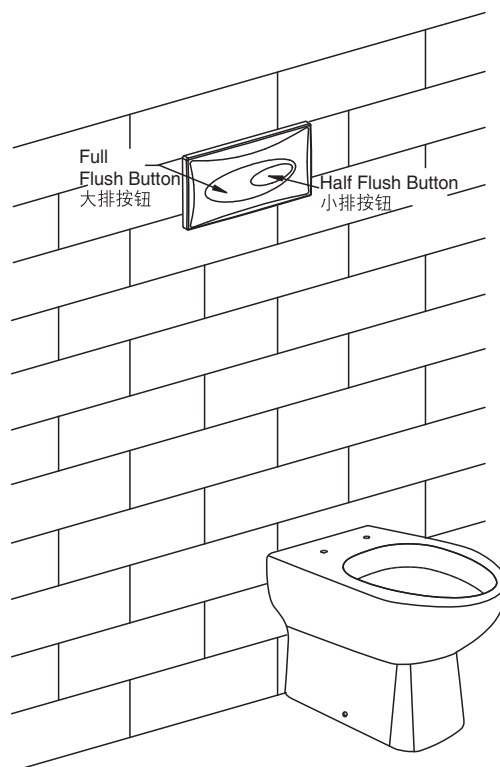

Finished Installation Illustration
安装完毕示图

MAINTENANCE AND CONTROL PROCEDURES 维护与调节程序

1. Hold the faceplate with both hands and push upward to take down the faceplate.

1. 如图拆卸面板时，用双手握住面板用力向上推就可以打开面板。

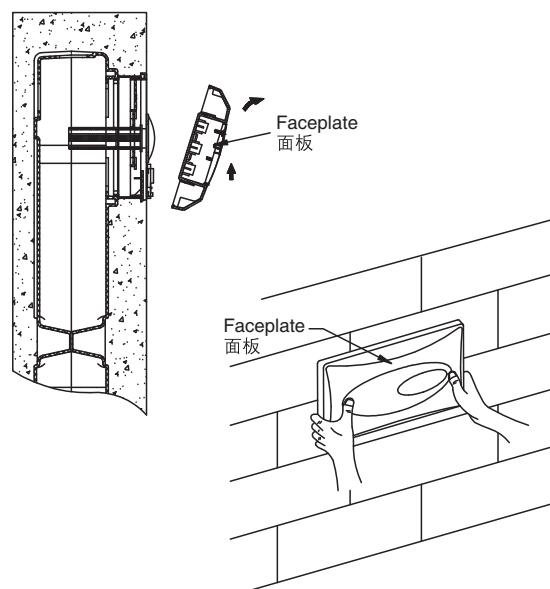

2. Tighten the locknut to the marked position of "OPEN" to take out the adjustable board.

2. 如图用手旋转锁紧管到“OPEN”标识位置上，调节板就可以取出。

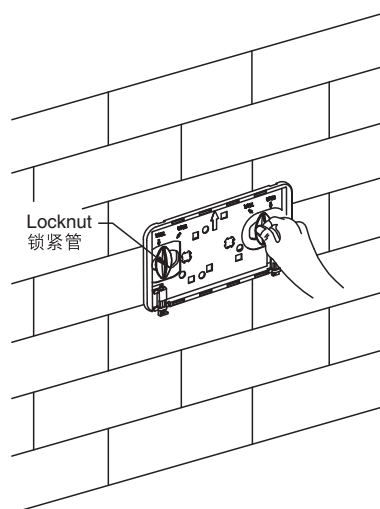

3. Pin the indentation on block screen with screwdriver to take out the block screen.

3. 如图用螺丝刀压在档盖的缺口上，取出档盖。

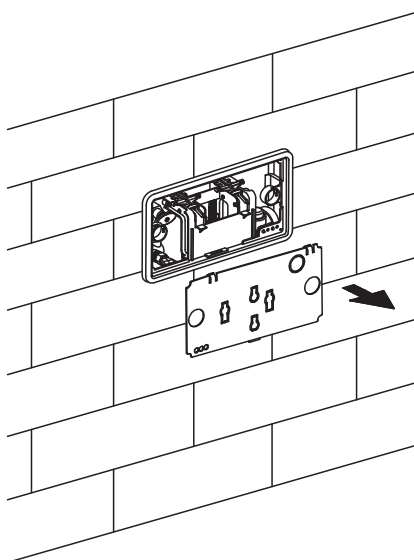
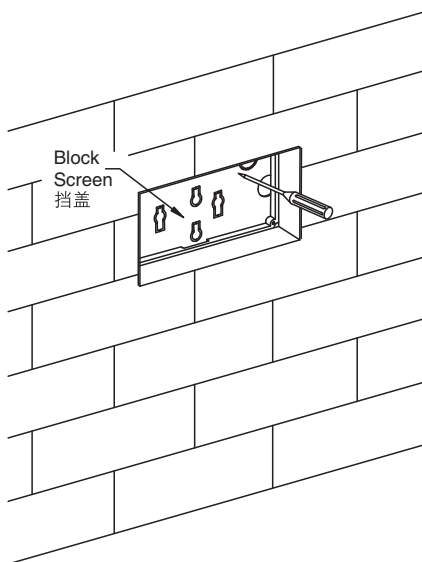

4. Wash Filtration Net

4. 清洗过滤器

Close corner valve first, then loosen and take out the tighten nut, and wash the waste on filtration net with clean water. Then reset the tighten nut to the original position.

如图所示首先将角阀开关关闭，将锁紧螺母旋松取出用清水清洗滤网泥沙。然后将锁紧螺母装回原位锁紧即可。

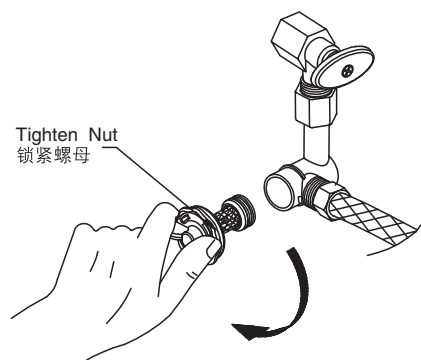
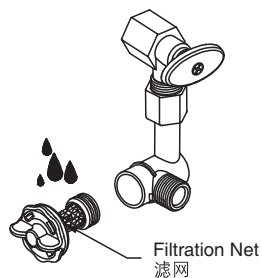
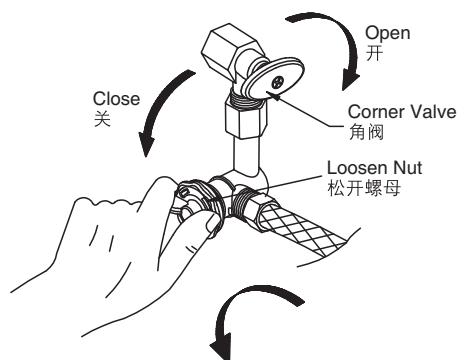

5. Adjust The Control Pole Of Drainage Valve

Pin the pole first to take out the control button as shown in the illustration. Then take out the fixing frame with both hands.

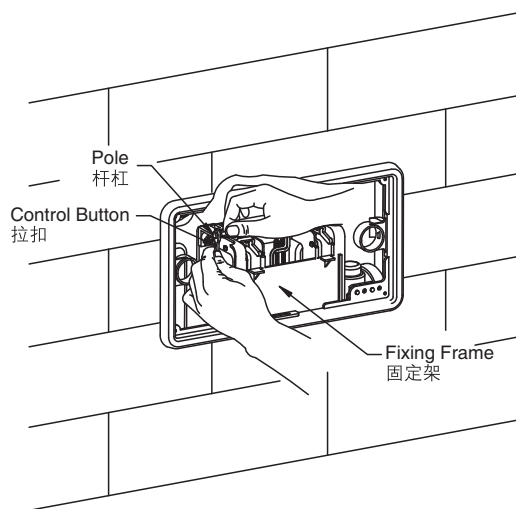

5. 排水阀的拉杆调校

如图所示首先将拉杆压紧，再把拉扣取出。然后用双手将固定架取出。

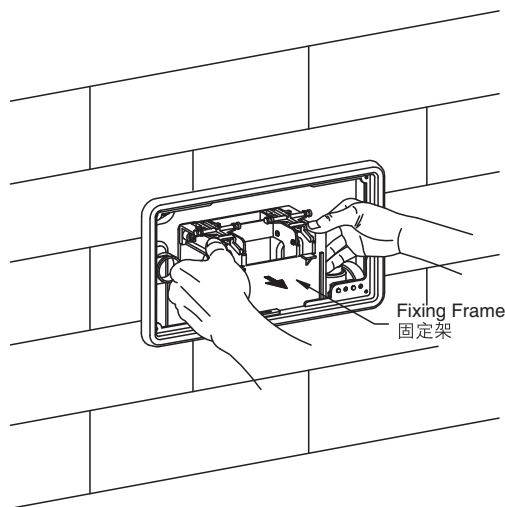

6. Pull out reversed lock on the fixing frame as shown in the illustration, and adjust the height of the control poles to ensure the leak-proof of drainage valve.

6. 如图所示将固定架的倒扣拨出，可调节拉杆升高或降低使排水阀达到滴水不漏状态。

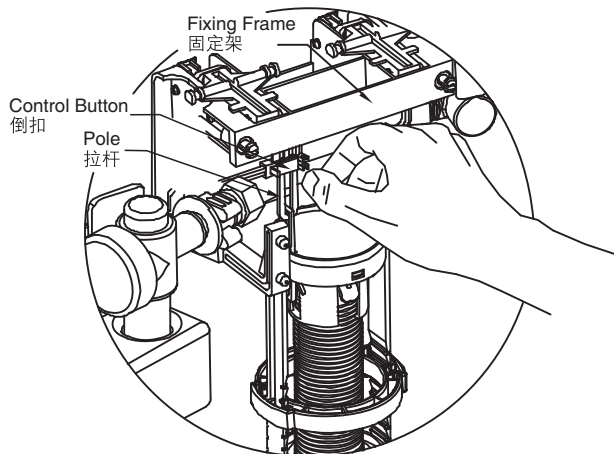
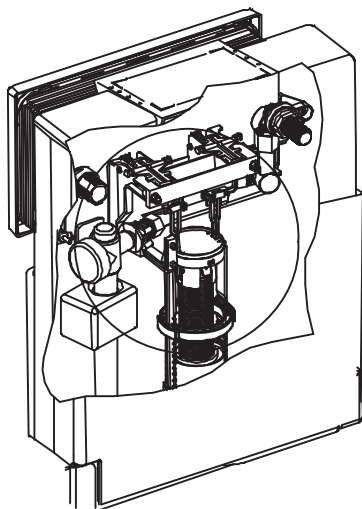

7. Adjust Drainage Valve

Drainage volume and overflow level of the tank can be adjusted by drainage valve: 1) Heavy drainage adjustment: Open adjustment switch to open the small hole. 2) Slight drainage adjustment: adjust the height of floating box and the water level of slight drainage will be at the bottom of the floating box.

7. 出水阀的调校

如图出水阀可调节水箱冲水量大小和水箱溢水高度: (1) 大冲水调节方法: 打开调节开关, 使小孔打开。(2) 小冲水调节方法: 调节浮筒高度, 小排水水位一般到浮筒底部。

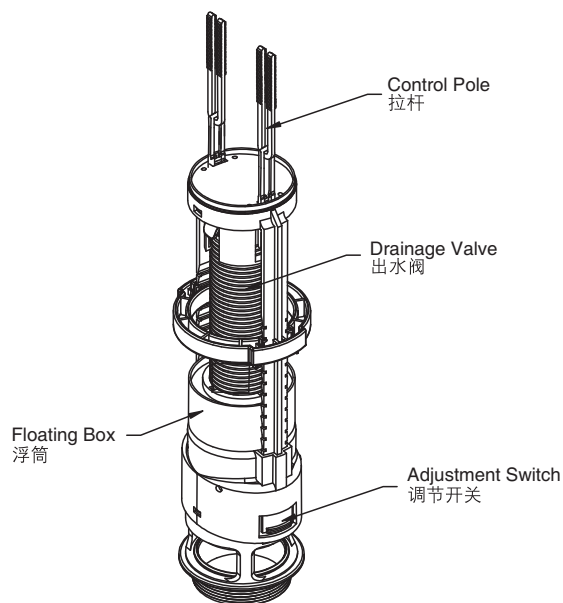

8. Adjust Inlet Valve

Hoist and reduce the water level in the tank by adjusting the control pole. Turn the control pole counterclockwise to lower down the floating box and reduce the water level of the tank. Turn the control pole clockwise to hoist the floating box and increase the water level in the tank.

8. 进水阀的调校

如图调校调节杆可以使水箱水位升高或降低。当逆时针旋转调节杆时, 浮盒下降, 水箱水位就低。顺时针旋转调节杆使浮盒上升, 水箱水位高。

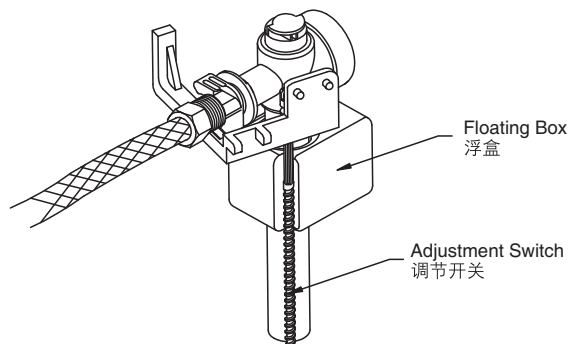

TROUBLE SHOOTING PROCEDURES 故障排除

Symptoms	Probable Causes	Recommended Action
No water fills in via inlet valve	The inlet valve is closed	Open inlet valve
	Floating box of inlet valve is blocked by tank wall	Adjust floating box to appropriate position
	Floating box of inlet valve is block by waste	Wash the floating box with clean water
No drainage when pressing the heavy and slight drainage button	Wrong installation of adjustable board	Reset
	Control pole is too long	Adjust the control pole to appropriate position
Too high or too low water level	Water level of the inlet valve is not appropriate	Readjust water level
Leak of the toilet and squat	Control pole is too short	Adjust the control pole to appropriate position
	Inappropriate adjustment of the overflow pipe	Adjust the overflow pipe to appropriate position

现象	原因	排除方法
进水阀不进水	进水角阀没有打开	把进水角阀打开
	进水阀的浮盒受水箱壁顶住	调整浮盒到合适位置
	进水阀的浮盒受杂物粘住	应用水清洗干净浮盒
按下大、小冲水按钮时不冲水	调节板安装错误	重新安装
	拉杆过长	调整拉杆到合适位置
水位太高或太低	进水阀水位没调整好	重新调整水位
蹲便器与座便器漏水	拉杆过短	调整拉杆到合适位置
	溢水管调节过低	调整溢水管到合适位置