

26250T-7X Intelligence Thermostatic Shower Column-Multifunction Head(Cloud Version)  
99879T-7 Intelligence Thermostatic Shower Column-Multifunction Head

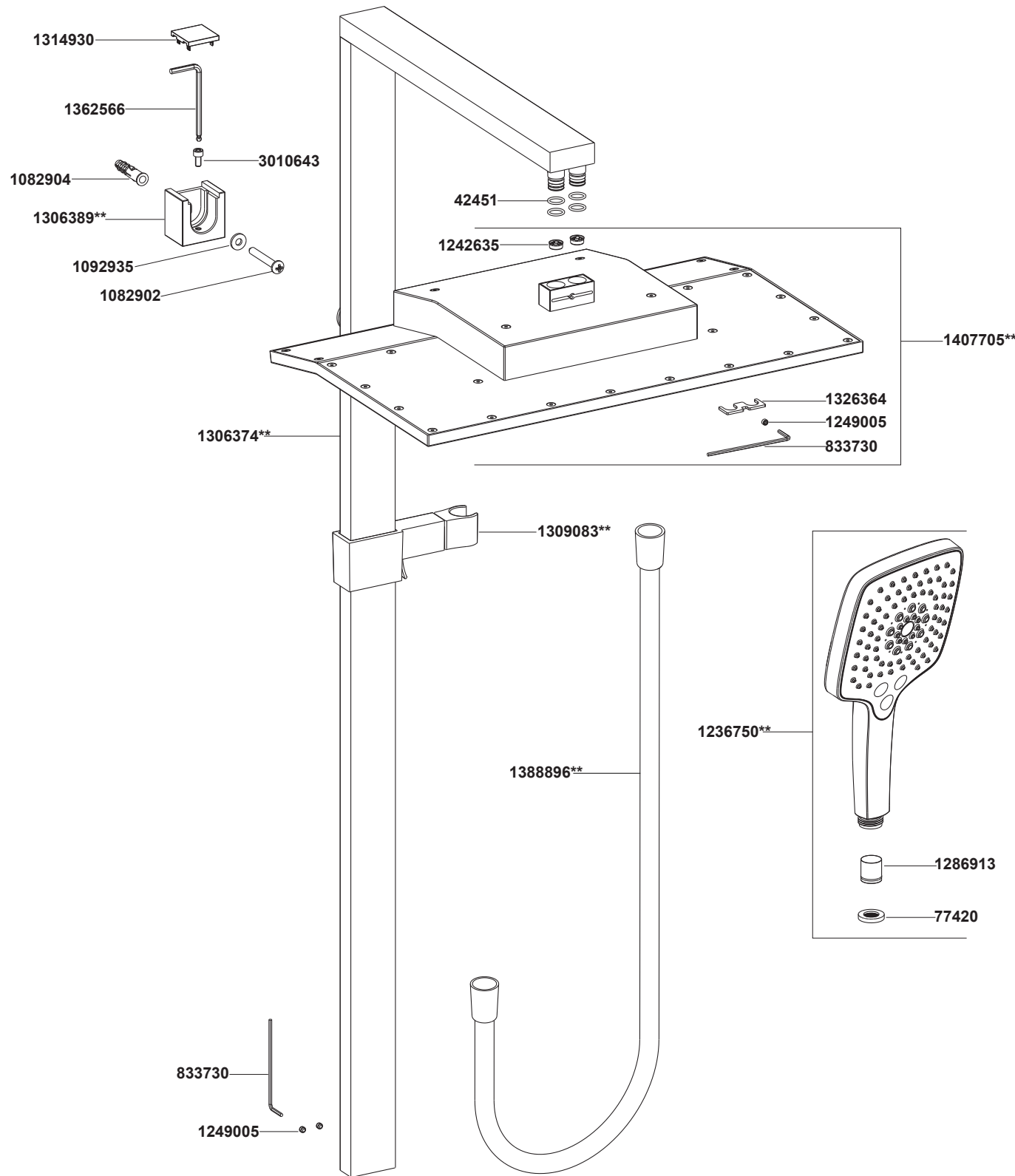

\*\*Color code must be specified when ordering.

26250T-7X Intelligence Thermostatic Shower Column-Multifunction Head(Cloud Version)  
99879T-7 Intelligence Thermostatic Shower Column-Multifunction Head

BEFORE YOU BEGIN

All information is based on the latest product information available at the time of publication. Kohler Co. reserves the right to make changes in product characteristics, packaging, or availability at any time without notice. Please leave these instructions for the consumer. They contain important information.

OPERATION CONDITION

1. Recommended supply pressures: 0.2MPa~0.4MPa(2bar~4bar) on hot and cold water. Low water pressure may affect shower experience.
2. Supply pressure greater than 0.5MPa(5bar): install a pressure reducer.
3. Hot water temperatures, minimum: 50°C, maximum: 80°C.
4. Recommended hot water temperature: 65°C(energy-saving).
5. Setting range, approximately: 20°C to 49°C.
6. Safety stop at: 37°C.
7. Maximum mixed water temperature: 49°C.
8. The highest environment temperature for handshower & showerhead is 60°C. Please keep handshower, showerhead and shower arm away from heater, or it may become damaged and cause injury to the user.

IMPORTANT INFORMATION

**Cloud Version** product complies with SRRC. It contains **CMIIT ID: 2018DP2230**.  
Your mobile device should have Bluetooth 4.0(or above) function, which can control “Beitou Intelligence Thermostatic Shower Column(**Cloud Version**)” via Bluetooth App.  
You need a wireless WiFi and Smart Gateway to control “Beitou Intelligence Thermostatic Shower Column(**Cloud Version**)” via Kohler Konnect App.  
These products are rated to IPX5.  
Other information, visit your product page at [www.kohler.com.cn](http://www.kohler.com.cn)

- NOTE!** Do not apply water pressure test on water supply pipes after completing the product installation.
- NOTE!** Lithium battery may be no electricity for the first time, charge it before use, and then install it according to the installation procedure.
- NOTE!** If the product is not used or used in low water pressure environment for a long time, it is necessary to charge the lithium battery at least once every six months to avoid over discharge to a low voltage condition.
- NOTE!** Do not charge it in the use of the product.

- WARNING! For Lithium battery.**
- ⚠ Do not use unqualified chargers.
  - ⚠ No short circuit, extrusion and collision.
  - ⚠ Do not expose battery to heat source or install in any location where the temperature may exceed 60°C. Keep away from moisture or corrosion.
  - ⚠ Battery electrodes must not be contacted with metal objects, resulting in short circuit.
  - ⚠ Do not use battery after immersion.

Scan QR Code to download App.  
Turn on Bluetooth for mobile  
device when pairing.  
(Only for Cloud Version)



Kohler Beitou Intelligence  
Shower System

ROUGH-IN DIMENSIONS

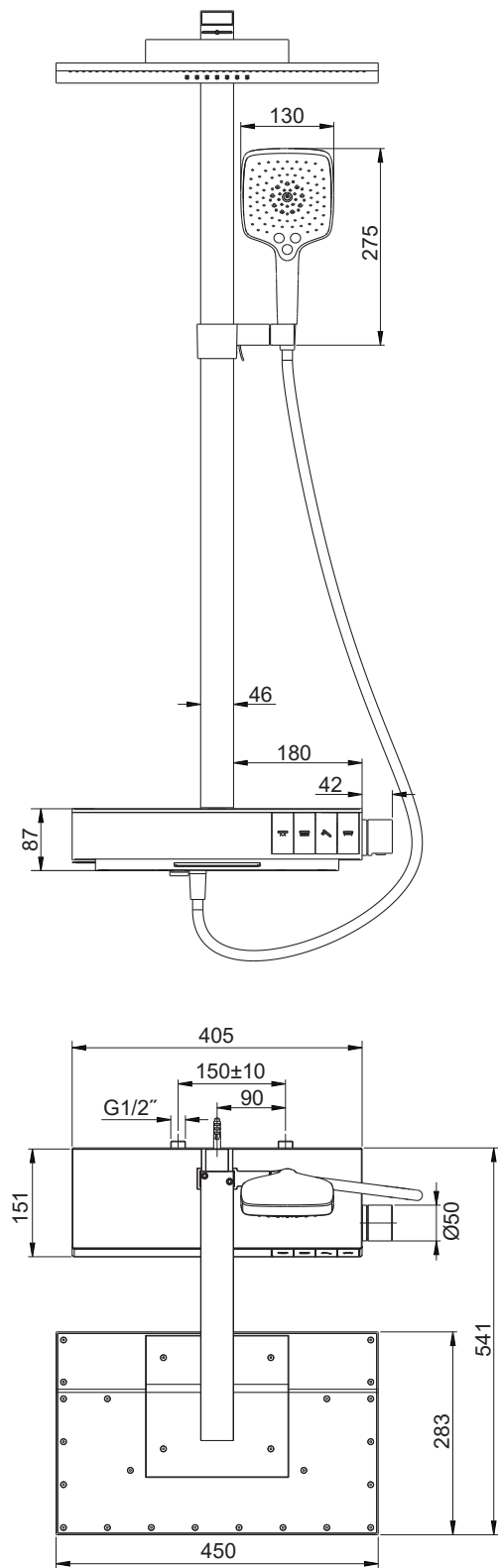
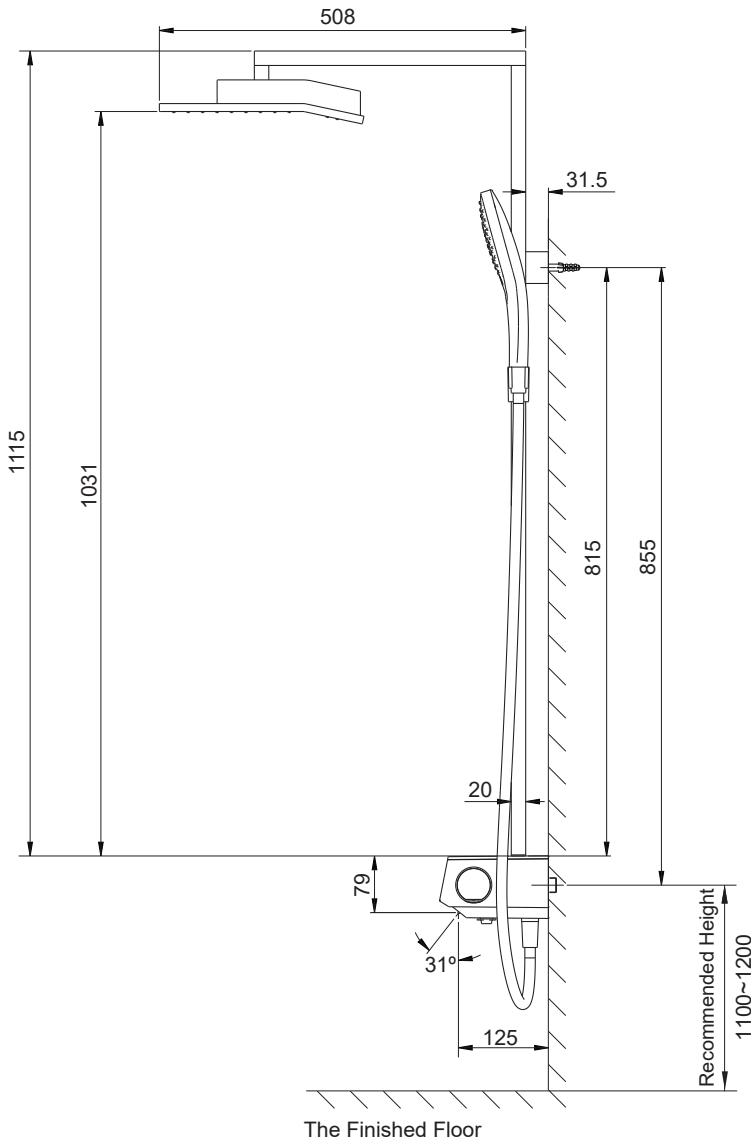

**KOHLER®**  
SERVICE PARTS

**BEITOU**

26250T-7X Intelligence Thermostatic Shower Column-Multifunction Head(Cloud Version)  
99879T-7 Intelligence Thermostatic Shower Column-Multifunction Head

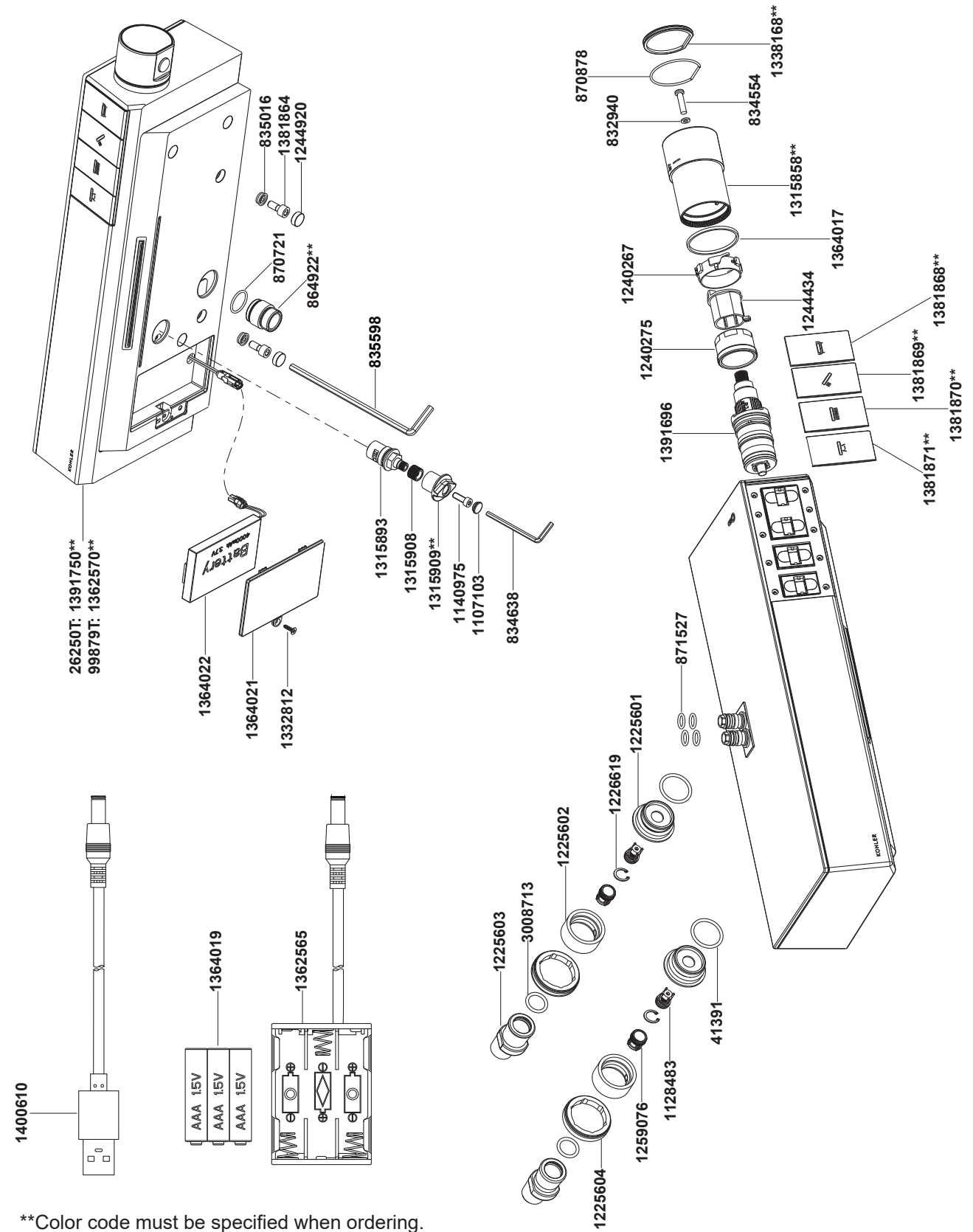

\*\*Color code must be specified when ordering.

Statistics of Contents of Toxic or Hazardous Substances or Elements

Part name	Toxic or Hazardous Substance or Elements					
	Lead (Pb)	Mercury (Hg)	Cadmium (Cd)	Hexavalent Chromium (Cr(VI))	Polybrominated biphenyls (PBB)	Polybrominated Diphenyl Ethers (PBDE)
Electronic PCBA kit	○	○	○	○	○	○
Column kit	×	○	○	×	○	○
Battery & cable kit	○	○	○	○	○	○
Generator kit	○	○	○	○	○	○
Electronic valve kit	○	○	○	○	○	○

○: Indicates that the substance in the material composition is below the high limits of the current requirements in GB/T 26572.  
×: Indicates that at least one of the homogeneous substance in the material composition is above the high limits of the current requirements in GB/T 26572.  
Note: the information provided is based on the supplier data and Kohler inspection results. The product is designed not to hurt the environment. Under current technology, all hazardous materials have been used in the smallest amounts possible. Kohler will strive to reduce the use of these hazardous materials used in this product.

 The product “service life for environment protection” is 10 years; Kohler Company will specify product service life based on product characteristics. The product “service life for environment protection” is only effective when the product is used as described in the product specification.

CLEANING INSTRUCTIONS

All Finishes: Clean the finish with mild soap and warm water. Wipe entire surface completely dry with clean soft cloth. Many cleaners may contain chemicals, such as ammonia, chlorine, toilet cleaner etc. which could adversely affect the finish and are not recommended for cleaning.

Do not use abrasive cleaners or solvents on Kohler faucets and fittings.

TOOLS AND MATERIALS (USER SUPPLIED)

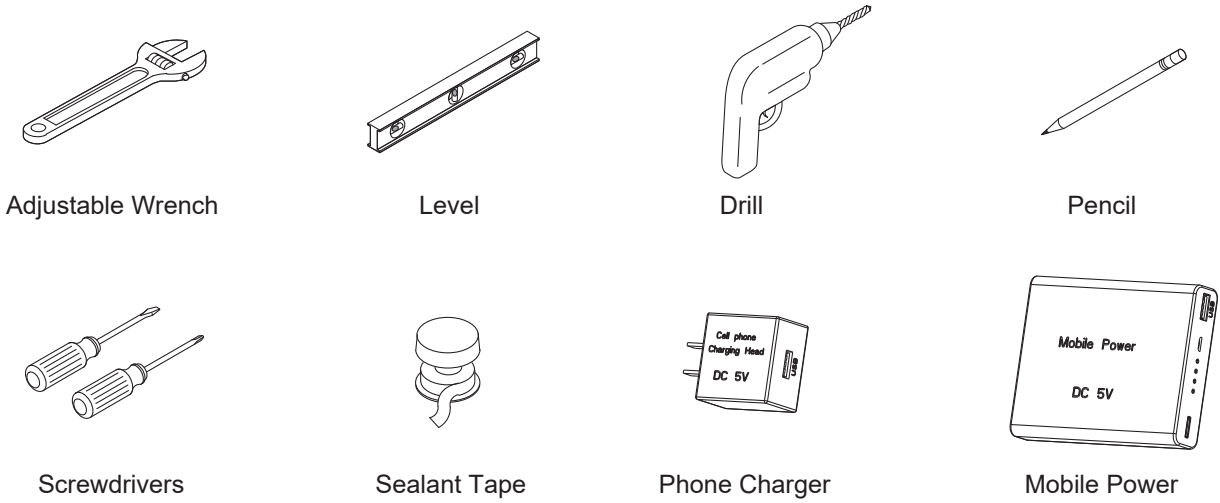

INSTALLATION

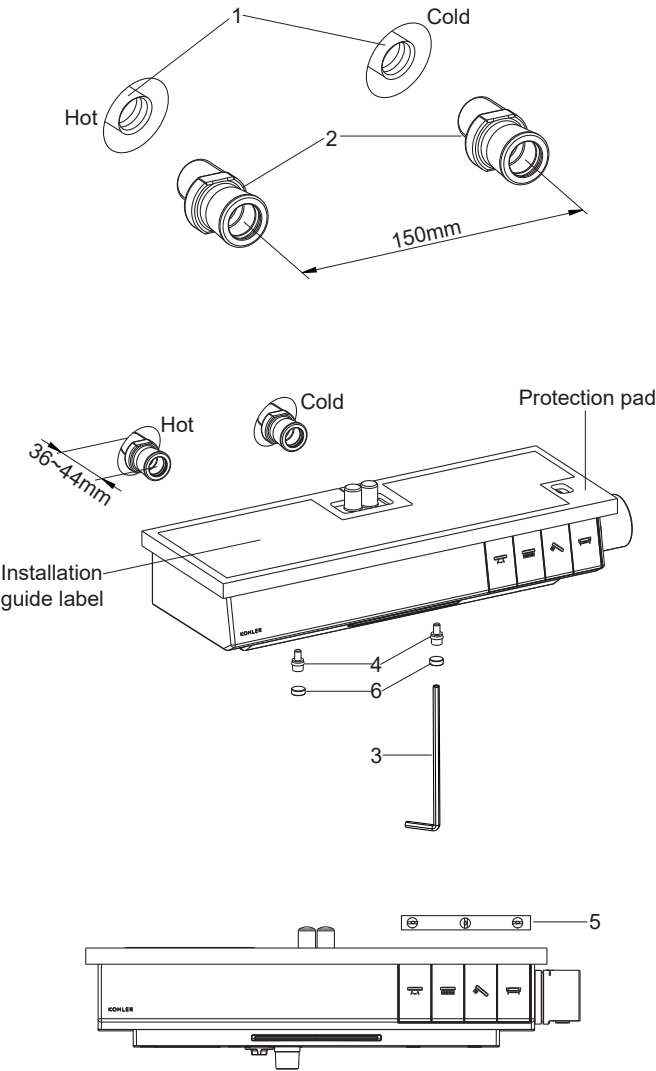

Install the Lithium Battery

Install the lithium battery according to the installation procedure in page 9.

**NOTE:** It will affect the product performance if the lithium battery is not installed.

Install the Body

To perform installation, installer must provide G1/2" female supply fittings(1), spaced 150mm apart, horizontally and vertically to the finished flat wall. Flush the water supply pipes thoroughly to remove any debris.

**NOTE:** Apply water pressure test on water supply pipes before installing the offset connectors(2).

Apply enough tape or suitable sealant on threads of offset connectors(2). Install two offset connectors into the hot and cold supply pipes.

Adjust the center-to-center distance between the connectors to 150mm horizontally. They should extend 36~44mm beyond the finished wall.

Adjust two screws(4) with 5mm hex wrench(3). Install the faucet body(including the protection pad) to the connectors until it is against the finished wall. Ensure the upper surface is horizontal with the level(5).

Tighten two screws with 5mm hex wrench. Press the plugs(6) into the faucet.

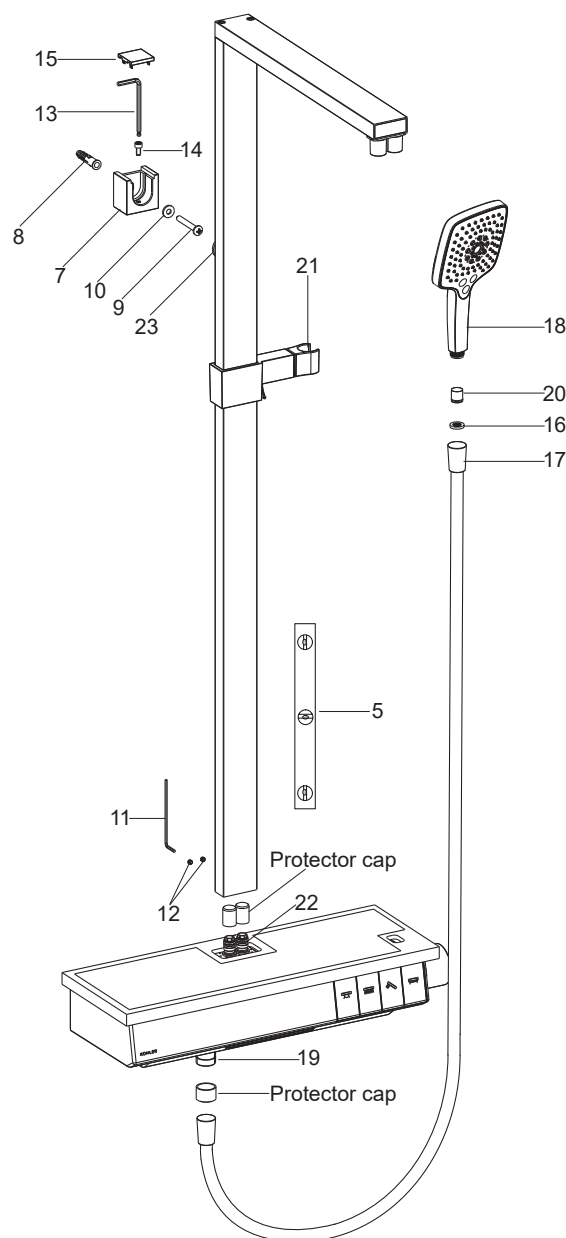

## Install the Shower Column and Handshower

**Rehearse the shower column kit installation for the base mounting location determination.**

1. Remove the protector cap from the connecting pipe(22). Insert the shower column onto the connecting pipe firmly to the end.
2. Put the mounting base(7) into the column insert(23) (Make sure the shower column is vertical. Check whether it is vertical with the level(5)). Mark the location of the mounting base with a pencil.
3. Uninstall the shower column. Mark the hole of the mounting base with a pencil.

### Install the mounting base.

1. Drill Ø10mm hole(The depth is not less than 45mm) on the mark.
2. Insert the anchor(8) into the hole. Tighten the screw(9) and washer(10) with a screwdriver in order to secure the mounting base.(NOTE: The notch on the base is upward).

### Install the shower column.

1. Slide the shower bracket(21) into the shower column. Install the shower column to the mounting base(7) and connecting pipe(22) firmly to the end.
2. Tighten two screws(12) with 2.5mm hex wrench(11).
3. Tighten the screw(14) with 4mm sphere hex wrench(13). Install the cap(15).

### Install the handshower.

1. Remove the protector cap from the connector(19). Put the screen washer(16) into the shower hose(17). Connect the connector(19) and handshower(18) with hose. **NOTE:** Do not over tighten.
2. Install the check valve(20) into the handshower if needed.
3. Hang the handshower on the shower bracket(21).

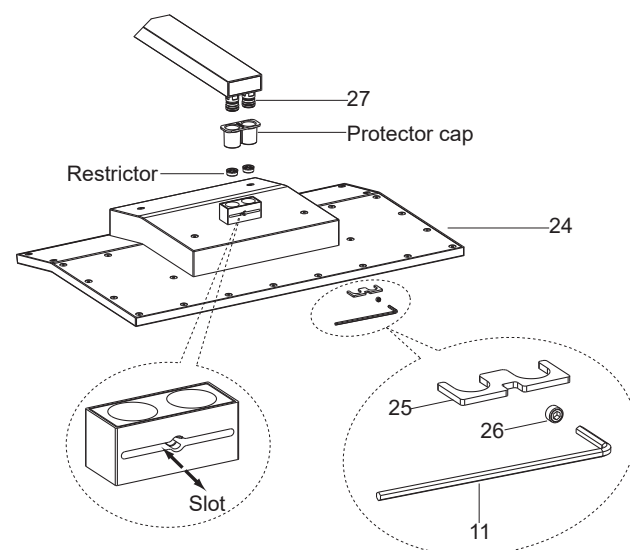

## Install the Showerhead

Before installation, install the restrictors if needed. Install the restrictors into the connectors on the showerhead(24).

Remove the protector cap from the tube kit outlet(27). **Insert the showerhead to the tube kit outlet as shown.**

Insert the pin(25) into the slot. Tighten the screw(26) with 2.5mm hex wrench(11).

**WARNING:** Ensure the screw is tightened firmly to avoid the product falling and personal injury.

## Troubleshooting Table

Symptoms	Probable Causes	Recommended Actions
1. Button LED is lit, water flows but the product can not be shut down.	A. Battery is not installed or connected. B. Battery is no electricity or damaged.	A. Install or reconnect battery. B. Charge the battery. If it could not be solved, replace it.
2. Button LED is not lit, and no water flows from product.	A. Battery is disconnected. B. Battery quantity is lower than 20% or battery is damaged. C. Button can not be pressed properly. D. Hardware circuit failure. E. If none of the recommended actions for above issues could correct the symptoms, the product is required servicing.	A. Reconnect battery. B1. Charge or replace battery. B2. If it could not be charged, use manual handle in the faucet bottom. Remove the label and rotate the manual handle counter-clockwise 90° to open handshower. C. Button is blocked or damaged, resulting in the Button not in place. Check whether there are some dirty materials inside button gap, if so, please clear it. D. Reconnect battery. E. Contact your Kohler Co. Authorized Service Representative.
3. System is standby, temperature LED blinks orange quickly.	A. Lack of water or water flow is too low. B. Generator is failure, disconnected or damaged. C. Electronic valve failure, unable to open.	A1. Check whether water supply pressure is properly. A2. Inlet filters and thermostatic cartridge are obstructed, clear and reinstall them. B. Contact your Kohler Co. Authorized Service Representative. C. Contact your Kohler Co. Authorized Service Representative.
4. System is standby, temperature LED blinks blue quickly.	A. The temperature sensor is disconnected or invalid, and the system fails to collect water temperature data, which prompts user that the temperature sensor is disconnected or invalid.	A. Contact your Kohler Co. Authorized Service Representative.
5. System is standby, temperature LED blinks red quickly.	A. Battery quantity is lower than 30%.	A. Charge battery according to the charging method.
6. Initial water supply, or resupply after water supply is cut off, and unconnected power, water flows automatically from product without any button operation.	A. The electronic valve of the corresponding outlet is open. B. The manual handle is not completely closed if water flows from handshower automatically.	A. Electricity(battery or external power) is required. Water will stop after electrified. B. Rotate the manual handle clockwise 90° to turn off the handshower.
7. In normal use, no response when pressing buttons.	A. System error.	A. Reconnect battery refer to the procedure of battery replacement.
8. Water runs properly, product is shut down automatically.	A. Battery quantity is lower than 20%.	A. Charge battery according to the charging method.
9. Water runs properly, temperature LED is not lit.	A. Temperature LED failure.	A. Contact your Kohler Co. Authorized Service Representative.
10. Water runs properly, one of the button LED is not lit.	A. Button LED failure.	A. Contact your Kohler Co. Authorized Service Representative.
11. No water flows from product, button LED is functioning properly.	A. Water supply is cut off. B. Electronic valve failure.	A. Check whether water supply pressure is properly. B. Contact your Kohler Co. Authorized Service Representative.



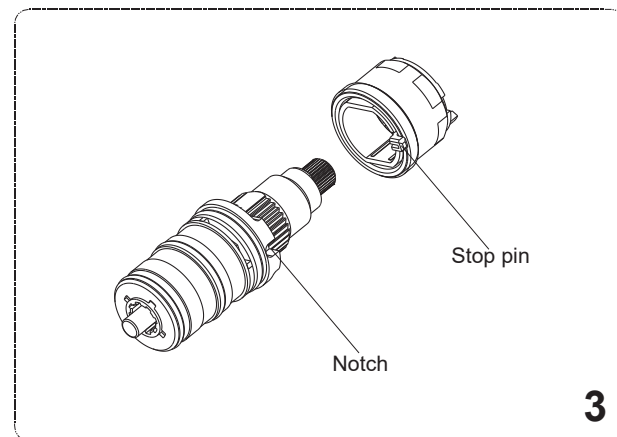

3. After cleaning, install the “stop assembly” back on the cartridge, adjust the stop pin into the notch.

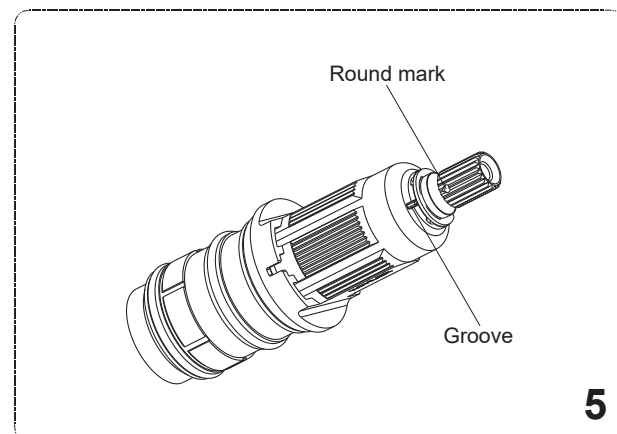

5. **NOTE:** Do not turn the cartridge when reinstalling it. If you turned it accidentally, you should adjust it and be sure that the round mark is correctly in line with the groove, or readjust as per the steps of verification and setting.

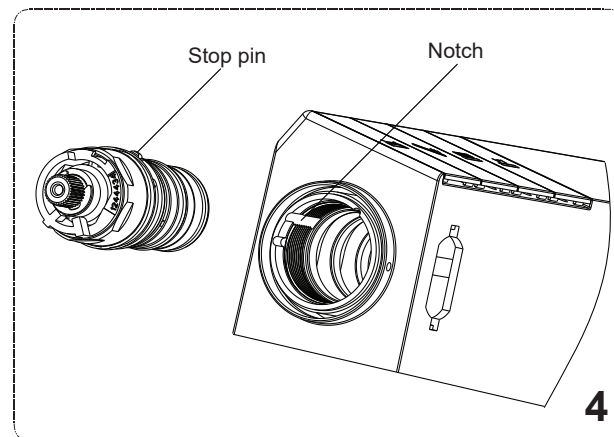

4. Install the assembly cartridge and stop in the body, adjust the stop pin into the notch.

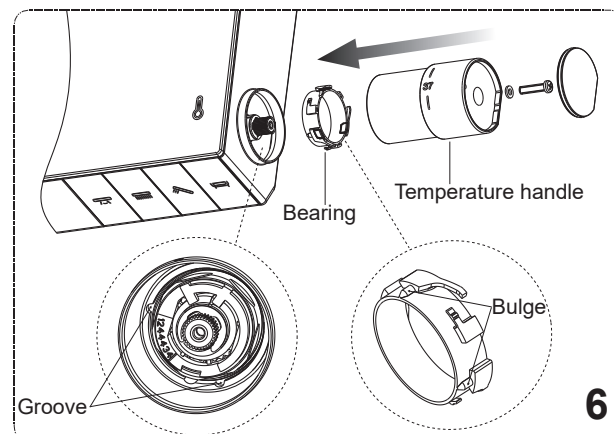

6. Install the bearing(without turning the spindle). Make sure the bulge of the bearing align with the groove of the body. Install the temperature handle. Make sure the number 37 on the temperature handle is upward vertically(After assembly, it could not be turned counter-clockwise if not pushing the button). Tighten the screw with washer. Install the handle plug.

## INSTALLATION CHECKOUT

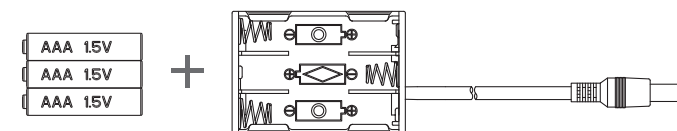

1. Connect dry battery.  
Open the dry battery box and put 3 pieces of dry batteries No. 7(AAA) into it.

Open the rubber plug in the faucet bottom. Supply power for the product by connecting the battery box and charging port as shown.

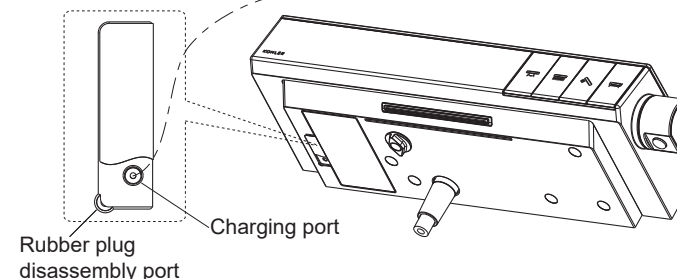

2. Ensure that all connections are tight, the function switch and manual handle are not open. Turn on the water supply. Run water through the valve. Check for leakage. Repair as needed.

3. Installation checkout  
Open the corresponding electronic valve according to the product operation instructions(page 6). Check whether all connections and water flow are well.

Shut off the faucet. Disconnect the charging cable. Press back the rubber plug.

### SPECIAL NOTES:

1) During checking, do not spray water to the dry battery box or charging port, otherwise it will cause short circuit.

2) Make sure all the electronic valves are closed before the power supply is shut off. The electronic valves can not be automatically closed if there is no electricity.

3) As shown, tear off the protection pad on the glass panel from its gap.

4) Please leave the electrostatic label(on the glass panel) with end user.

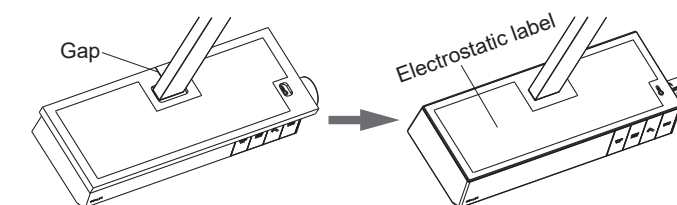

## Verification and Setting

Make sure the water feeds of the faucet have reached the highest temperature by running the water sufficiently. When the number 37 on the temperature handle is upward vertically, the temperature of the water should be within a range between 36°C and 38°C, as measured by a thermometer. If not, the installer can adjust the setting. Proceed with the setting as follows:

Remove the handle plug. Uninstall the screw with the screwdriver(Do not lose washer), remove the handle kit.

Under the normal condition of water flow, slowly turn the temperature selector(always in the same direction) from the cold water position until water temperature reaches 37°C. If the temperature goes over 37°C, go back to the “cold” setting and reset it. When the temperature is stable, do not turn the cartridge spindle. Install the temperature handle. Make sure the number 37 on the temperature handle is upward vertically(After assembly, it could not be turned counter-clockwise if not pushing the button).

Tighten the screw with washer. Install the handle plug.

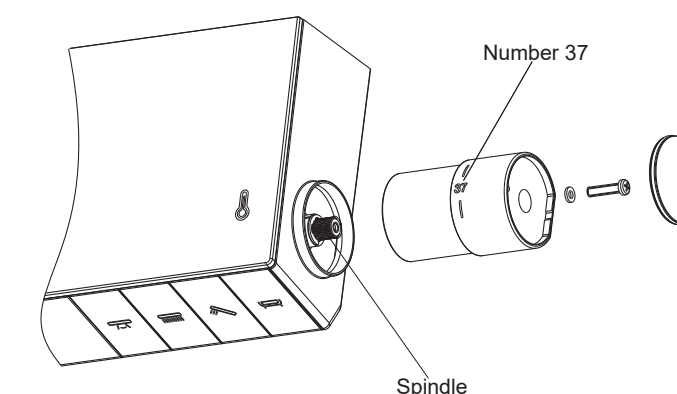

## OPERATION INSTRUCTIONS

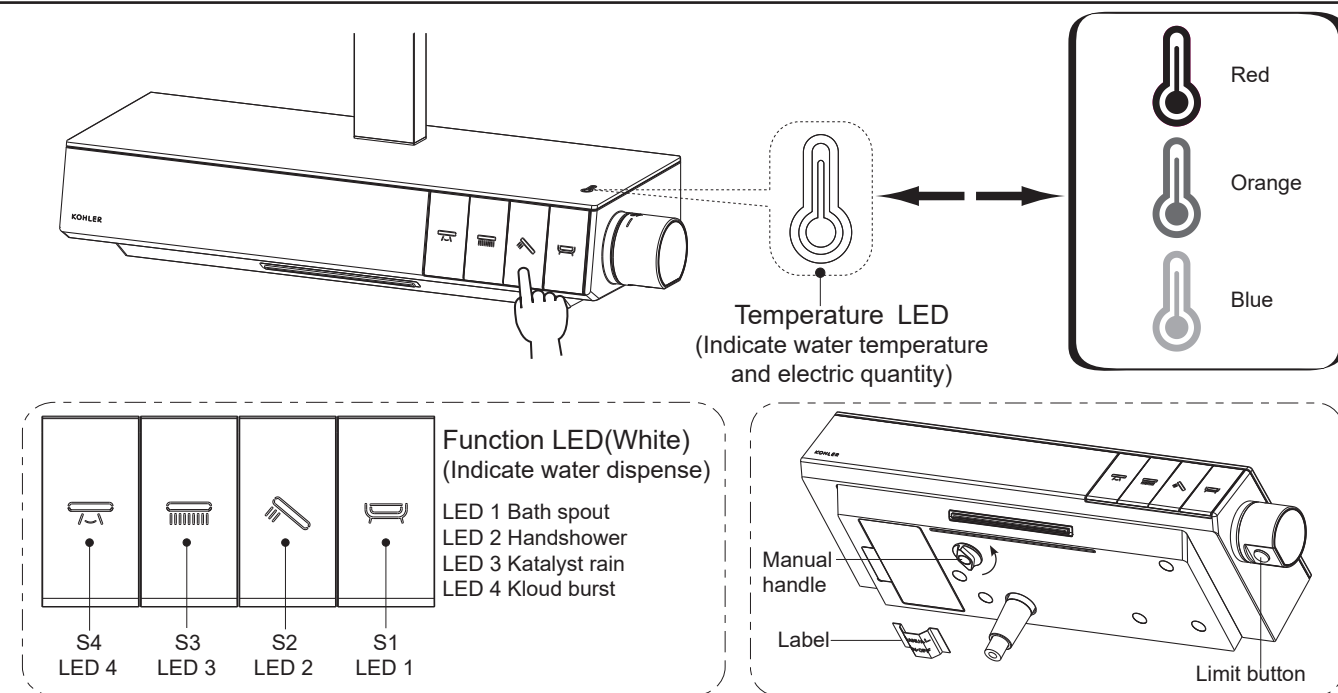

### Product State Instructions

**Working State**---Press any button to turn on corresponding function, the function LED and temperature LED will be turned on.

**Standby State**---The system is in standby state within 5 minutes after the product is turned off.

**Dormant State**---The system is dormant after turning off the product 5 minutes until next operation.

### Manual Operation Instructions

#### 1. Turn on

**Dormant State:** Press any button, after function LED blinks 3 times, function LED and temperature LED will be turned on while corresponding water will run.

**Standby State:** Press any button, function LED and temperature LED will be turned on while corresponding water will run.

#### 2. Change function

**Working State:** Press selected button, the selected water will run and the function LED will be turned on while the previous one will be turned off.

#### 3. Turn off

**Working State:** 1) Press the working button, corresponding water will be shut off while function LED and temperature LED will be turned off.

2) The product will be turned off automatically when there is no operation last for 1 hour.

#### 4. Manual handle operation

When function LED can not work, turn the manual handle(in the faucet bottom) counter-clockwise 90° for opening the handshower as shown and turn clockwise 90° for closing. Remove the label for the first time.

#### 5. Bluetooth pairing(Only for Cloud Version)

Press button S1 and S2 for Bluetooth pairing. How to pair and operate the Bluetooth App, please refer to operation instructions in page 7.

### LED State Instructions

#### 1. Turn on state

1) The temperature LED blinks slowly(bright for 2 seconds, dark for 3 seconds), which only indicates water temperature, not electric quantity. There are 3 kinds of water temperature indications: Blue(<36°C); Orange(36°C~42°C); Red(>42°C).  
2) Only one of the function LED(water outlet) will blink slowly(bright for 2 seconds, dark for 3 seconds) at the same time.

2. The product is turned off and uncharged(standby state), the temperature LED blinks red quickly last for 60 seconds, which means the electric quantity is lower than 30%.

3. The product is turned off and charging, the temperature LED indicates electric quantity as follows:  
Red blinks quickly(<30%); Orange is lit(30%~95%); Blue is lit(>95%).

## CARE AND MAINTENANCE

### Clear the Filter

The filters can protect the faucet, but it may get obstructed and reduce water flow after a long time of use.

If this happens, turn off the water supply, uninstall the shower column.

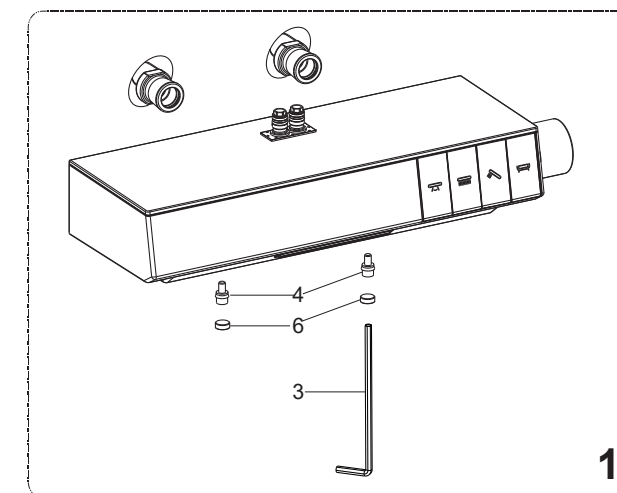

1. Take out the plugs(6). Unscrew two screws(4) with 5mm hex wrench(3) to uninstall the faucet.

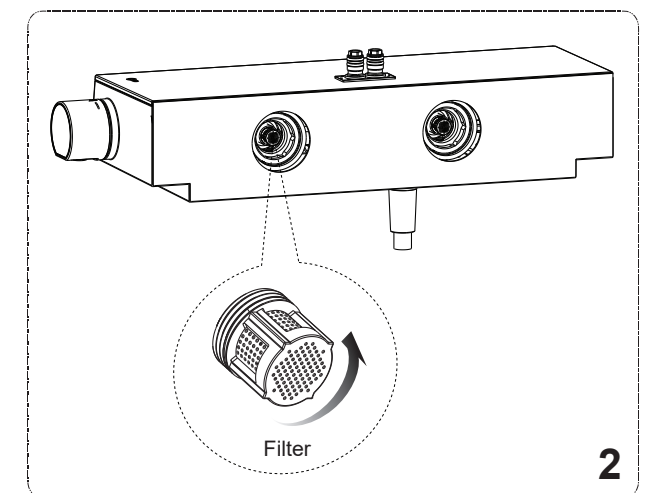

2. Rotate counter-clockwise 90° to take out the filters. Clean the filters by soaking them in warm vinegar. Reinstall them in turn.

### Clear the Thermostatic Cartridge

Very hard water can obstruct the filters on the thermostatic cartridge and reduce the flow of water.

Please clean the cartridge as follows:

Shut off the water supply of the faucet and turn on the water flow valve, then proceed to remove the cartridge. The cartridge is sensitive part, please be careful.

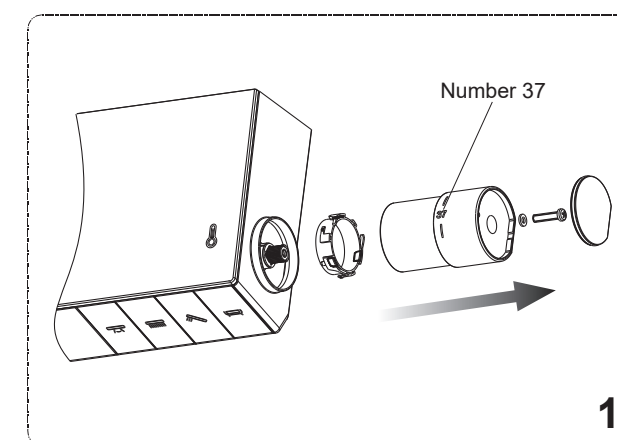

1. Before your action, make sure the number 37 on the temperature handle is upward vertically(It could not be turned counter-clockwise if not pushing the button). Remove the handle kit.

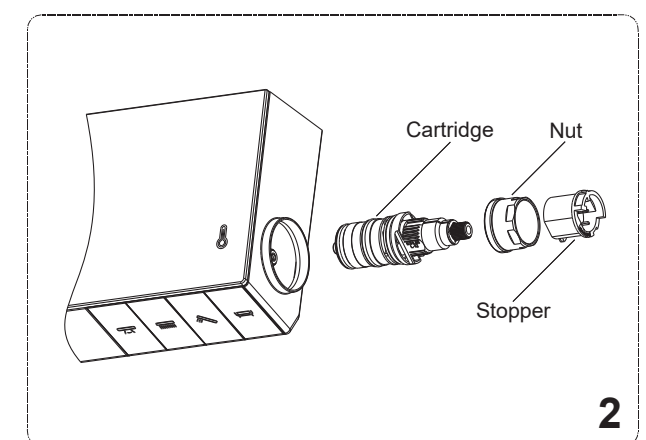

2. Unscrew the nut and stopper. Remove the cartridge cautiously. Clean the thermostatic cartridge by soaking it in warm vinegar.

## CHARGE LITHIUM BATTERY

**NOTES:** 1) Lithium battery may be no electricity for the first time, charge it before use.  
2) If the product is not used or used in low water pressure environment for a long time, it is necessary to charge the lithium battery at least once every six months to avoid over discharge to a low voltage condition.  
3) Do not charge battery in the use of the product.  
4) Put the rubber plug back to protect the charging port after completing charging.

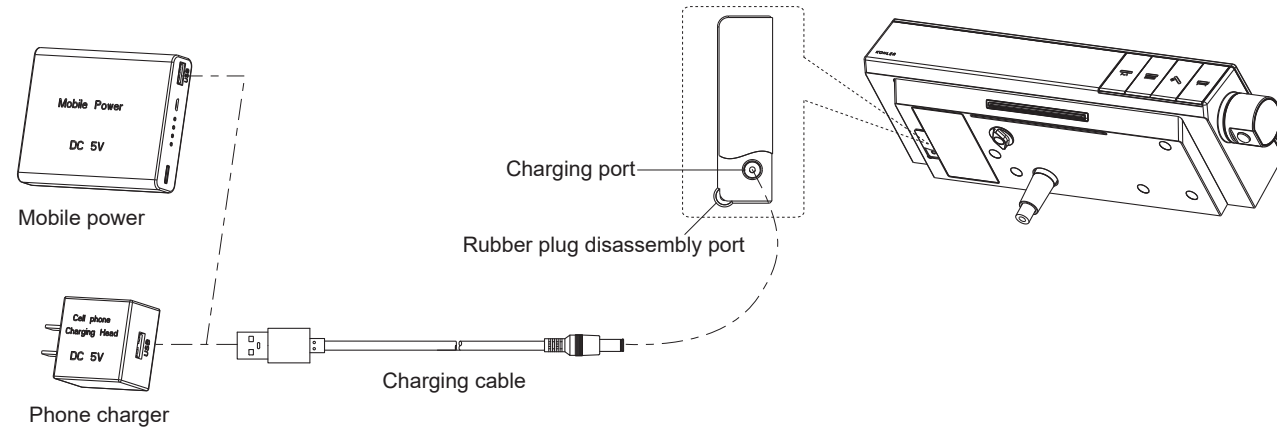

Connect the charging port(visible by opening the rubber plug) with 5V DC power supply(such as mobile power or phone charger) via charging cable.

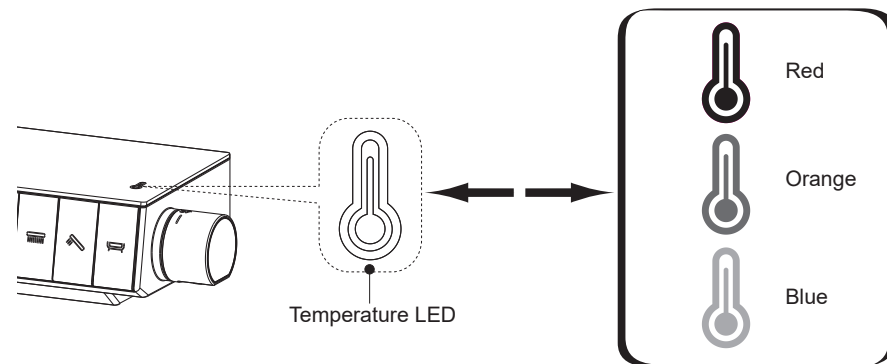

Temperature LED indicates the electric quantity as follows.

Red blinks quickly(<30%);  
Orange is lit(30%~95%);  
Blue is lit(>95%).

## OPERATION INSTRUCTIONS FOR KOHLER-BEITOU INTELLIGENCE SHOWER SYSTEM BLUETOOTH APP(ONLY FOR CLOUD VERSION)

### Bluetooth App remote control

Demand conditions: 1) You need a Bluetooth 4.0(or above) mobile terminal.  
2) The distance between mobile terminal and product should be within 10m.



### Bluetooth App Installation and Connection

1. Scan QR code in the electrostatic label or installation instructions(page 1) to download Bluetooth App.
2. Bluetooth pairing.
  - 1) Enter App. Turn on Bluetooth. Click the icon in the lower end to search device.
  - 2) Click the name of the product(such as K-26250T).
  - 3) Click [立即配对]. Press both buttons S1 and S2 last for 3 seconds, both buttons S1 and S2 will blink for 5 seconds and send Bluetooth pairing instruction. Finish pairing.

**NOTE:** If fails to pair, you could repeat above operation several times or disconnect and reconnect the power supply(refer to page 9).

3. After successful connection, click and enter control page to operate product.
4. Slide the icon ④ to the left. Click [忽略设备] to disconnect the Bluetooth.

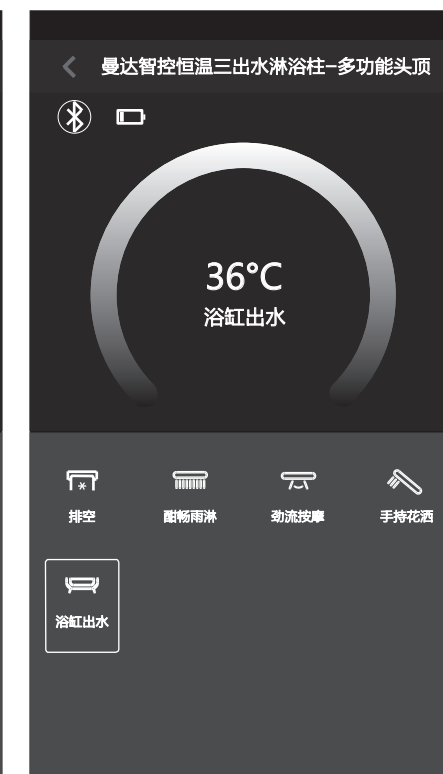

### Bluetooth App Operation Instructions

1. Empty cold water. Click icon [排空], the icon [排空] lights up and catalyst rain flows. The catalyst rain function LED and temperature LED will be lit. Meanwhile, App will indicate the water temperature. It will be transferred to handshower, and turned off after 5 seconds when the water temperature is at 37°C. If water flows last for 5 minutes and the water temperature is still below 37°C, the product will be turned off automatically.

2. The function icons between App and product are one-to-one correspondence, and their operations are the same. When click any icon, it will light up and the selected water will be turned on. App will indicate current water temperature. The corresponding function LED and temperature LED on the product light up. When the battery quantity is lower than 30%, the warning icon ④ will be lit.

KOHLER KONNECT QUICK START GUIDE(ONLY FOR CLOUD VERSION)

Quick Wireless Connection

Connect Kohler IoT device to power supply, make sure it is under normal status.

Kohler IoT device supports App control/set up. Please scan QR code below or visit Kohler website to understand more about latest Kohler intelligent kitchen and bath experiences.

SMART GATEWAY CONNECTION

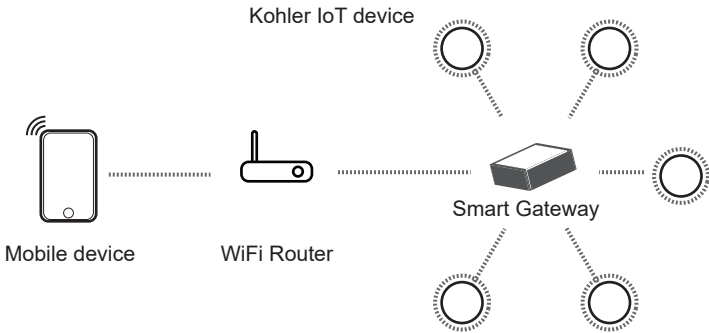

Turn on Kohler App, setup Kohler account and then login. Click [Add Device] on [Devices] page, check [Of course] on [Have you got a Smart Gateway?] page and then follow App instruction, add your Kohler IoT device.

Mobile device is capable to connect with Kohler IoT devices via WiFi or mobile network.



Scan QR Code to download  
Android or iOS App  
(Only for Cloud Version)

In order to learn more about Kohler IoT product function. Please visit: [www.kohler.com.cn](http://www.kohler.com.cn)

INSTALL AND REPLACE LITHIUM BATTERY

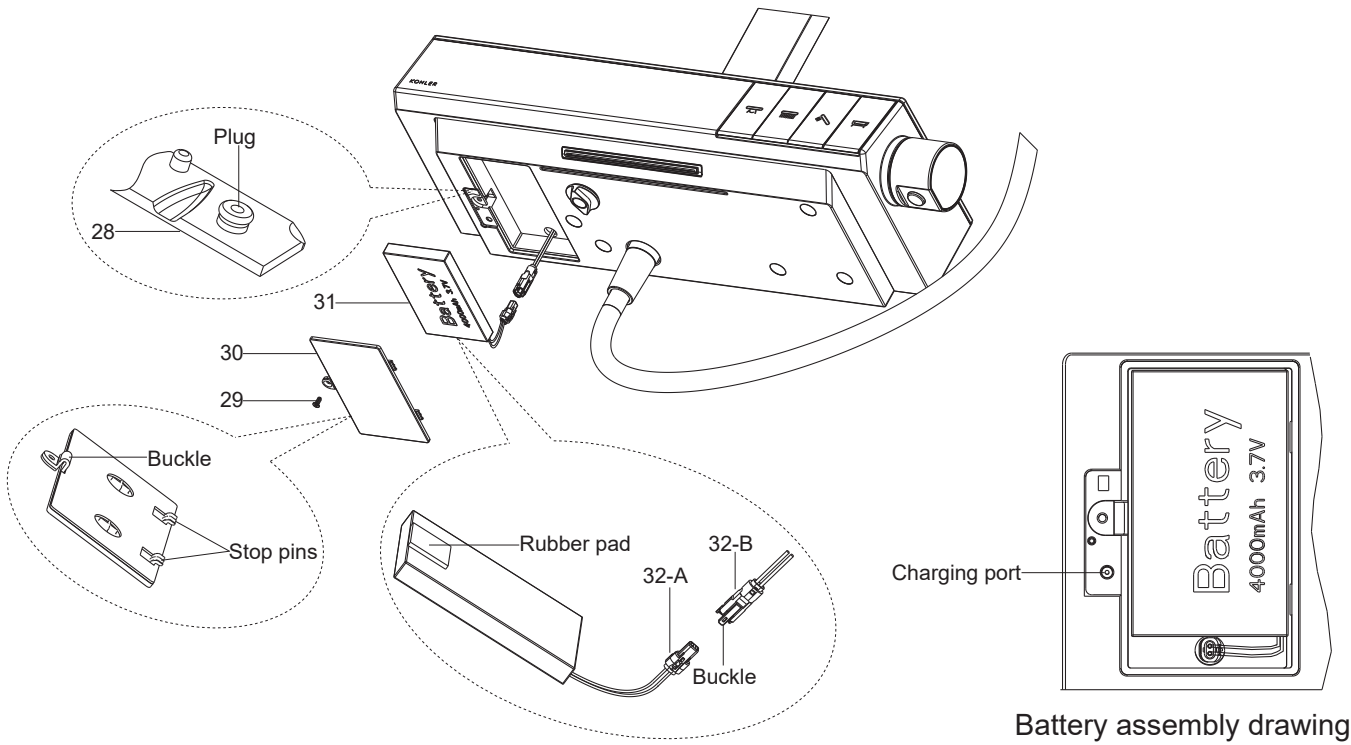

1. Open the rubber plug(28).
2. Disassemble the screw(29) with a screwdriver. Take out the battery cover(30). **NOTE:** Avoid the battery dropping out.
3. Take out the battery(31). Open the buckle of the connector(32-B) carefully in order to disconnect the connectors. **NOTE:** Take out the battery carefully and avoid pulling vigorously.
4. Replace with new battery. Connect the connector(32-A) and (32-B). **NOTE:** The groove in each connector should line up with each other. Ensure they are in place. Avoid wetting the battery.
5. Push the connectors into the cable hole. Make sure the rubber pad of the battery pad is facing upward and bonded to the bottom of the battery cabin(Please tear off the protection paper of the rubber pad **for the first battery installation**). Install the battery according to "Battery assembly drawing"(Ensure the battery cable is all in the battery cabin).
6. Charging the lithium battery(refer to the charge procedure in page 10) until the temperature LED shows blue. **NOTE:** If the temperature LED is not lit, connect the battery again.
7. Align two stop pins of the battery cover with two holes in the battery cabin. Press the buckle of the battery cover firmly. Install the battery cover(30) and tighten the screw(29).
8. Install the rubber plug(28). Insert the plug into the charging port. Press back the rubber plug.