

45407T 滑动花洒支架（直接进水型）

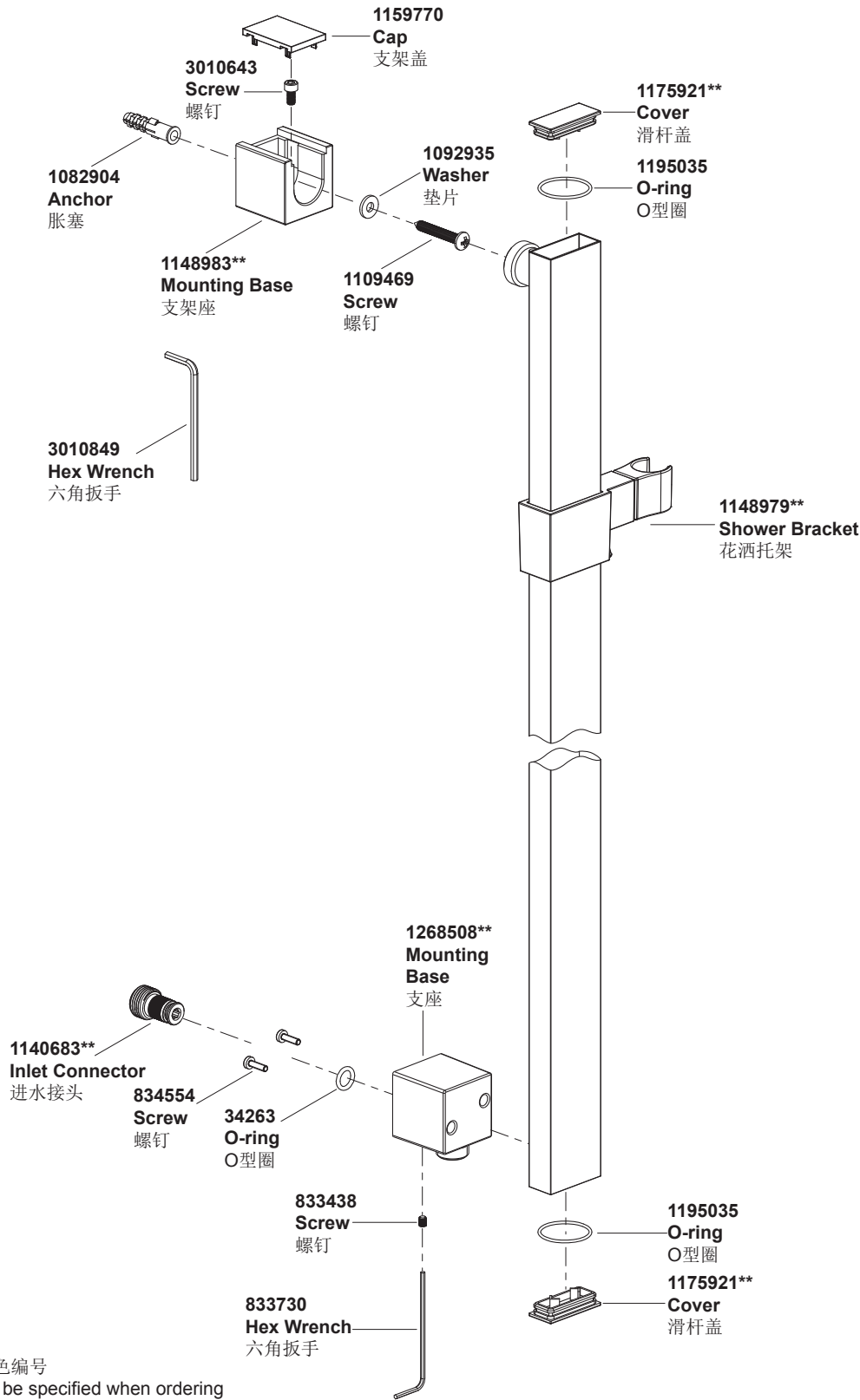

**订购时请说明颜色编号
**Color code must be specified when ordering

45407T 滑动花洒支架（直接进水型）

安装之前

所有的资料是按最新出版的产品资料编写而成。科勒公司保留任何时候不经通知即可改变产品特性、包装或产品可供类型的权利。

说明书包括重要的安装、保养及清洁方面的内容，请把这些资料交给用户阅读。

注意事项：

- 1.一定要先彻底冲洗供水管以清除管道中的杂质。
- 2.遵守当地管路安装条例。
- 3.切断主供水源。
- 4.本产品需和手持花洒及龙头(单独购买)一起使用。

BEFORE YOU BEGIN

All information is based on the latest product information available at the time of publication. Kohler Co. reserves the right to make changes in product characteristics, packaging, or availability at any time without notice.

Please leave these instructions for the consumer. They contain important information.

NOTES:

1. Flush the water supply pipes thoroughly to remove debris.
2. Observe all local plumbing and building codes.
3. Shut off the main water supply.
4. The product must be installed in conjunction with a handspray and faucet (purchased separately).

安装尺寸

ROUGH-IN DIMENSIONS

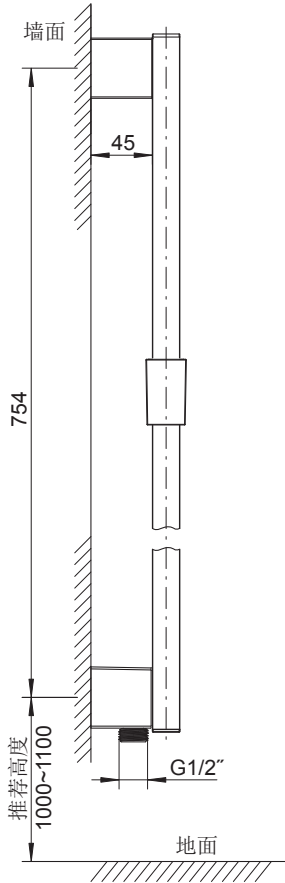

安装步骤

如何安装滑动花洒支架

为了使安装顺利，在墙面适当高度预装G1/2”内螺纹管道配件(1)。**注意:**管道配件要垂直并且不能突出装修好的墙面，但低于墙面不能超过5mm。使用6mm六角扳手安装进水接头(2)。

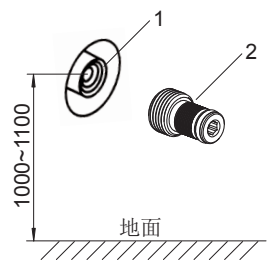

试装整组滑杆，使支架座(3)紧贴墙面放置，用铅笔在墙面上标记墙支架座的轮廓，将支架座上的安装孔(4)标记出来。

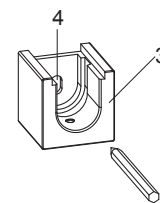

根据胀塞(5)的直径，在标记的地方钻孔，将胀塞装入孔中。然后用垫片(6)和螺钉(7)将支架座(3)固定于墙上，确保支架座开口向上并与墙面上的轮廓重合。

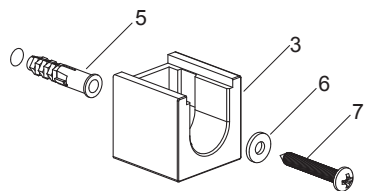

将滑杆组件(8)从上方安装到支架座和进水接头上。用六角扳手(10)锁紧固定螺钉(9)。

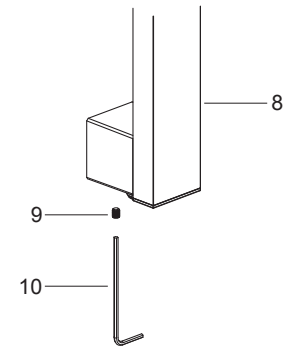

将支架座与滑杆组件用螺钉(11)连接，用六角扳手(12)锁紧以固定滑杆组件，扣上支架盖(13)。

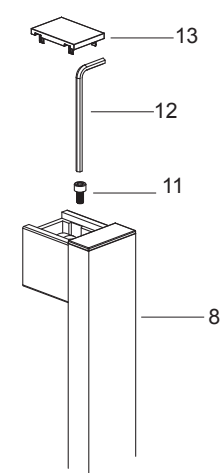

INSTALLATION

How To Install The Slide Bar

To perform installation, install G1/2” female supply fitting(1) at the proper position on the finished wall. **Note:** The supply fitting should be not beyond and below the finished wall less than 5mm. It is vertical to the finished wall. Install inlet connector(2) with 6mm hex wrench.

Rehearse the whole slide bar installation, keep the mounting base(3) against the finished wall. Mark the outline of the bottom of the mounting base with a pencil on the wall. Mark the hole(4) of the mounting base on the wall with a pencil.

Drill hole according to diameter of the anchor(5), press the anchor into the hole. Secure the mounting base(3) to the finished wall by the washer(6) and screw(7), and make sure the slot of the mounting base upwards, and the bottom of the mounting base coincides with the outline on the wall.

Slide the slide bar kit(8) onto the mounting base and the inlet connector. Install the screw(9) with hex wrench(10).

Connect the slide bar kit and the mounting base with the screw(11), tighten the screw by hex wrench(12). Install the bracket cover(13).

安装结果检查

确定所有衔接螺母都已锁紧。开启主水源，检查是否有漏水。如有漏水，修理之。

按住手持花洒托架(15)上的按钮(14)上下滑动，可调节托架位置。

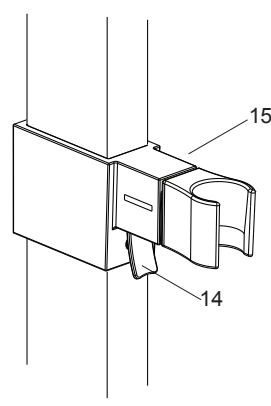

INSTALLATION CHECKOUT

Ensure that all coupling nuts are tightened. Turn on the main water supply, and check for leaks. Repair as needed.

The height of handshower holder(15) can be adjusted and sliding up and down by pressing the knob(14).

清洗说明

适用于所有加工处理过的表面：以中性肥皂温水清洗镀层表面，再以干净的软布彻底擦干整个表面。许多清洁剂，比如氨水、去污粉及洁厕灵等，会对电镀表面造成伤害而不宜使用。

有磨损性的清洁用具或清洁剂也不可使用于科勒牌的水龙头及其配件上。

CLEANING INSTRUCTIONS

All Finishes: Clean the finish with mild soap and warm water. Wipe entire surface completely dry with clean soft cloth. Many cleaners may contain chemicals, such as ammonia, chlorine, toilet cleaner etc. which could adversely affect the finish and are not recommended for cleaning.

Do not use abrasive cleaners or solvents on Kohler faucets and fittings.