

98275T-CL Ceiling-mount 14" Rainhead With Katalyst Air-Induction Technology

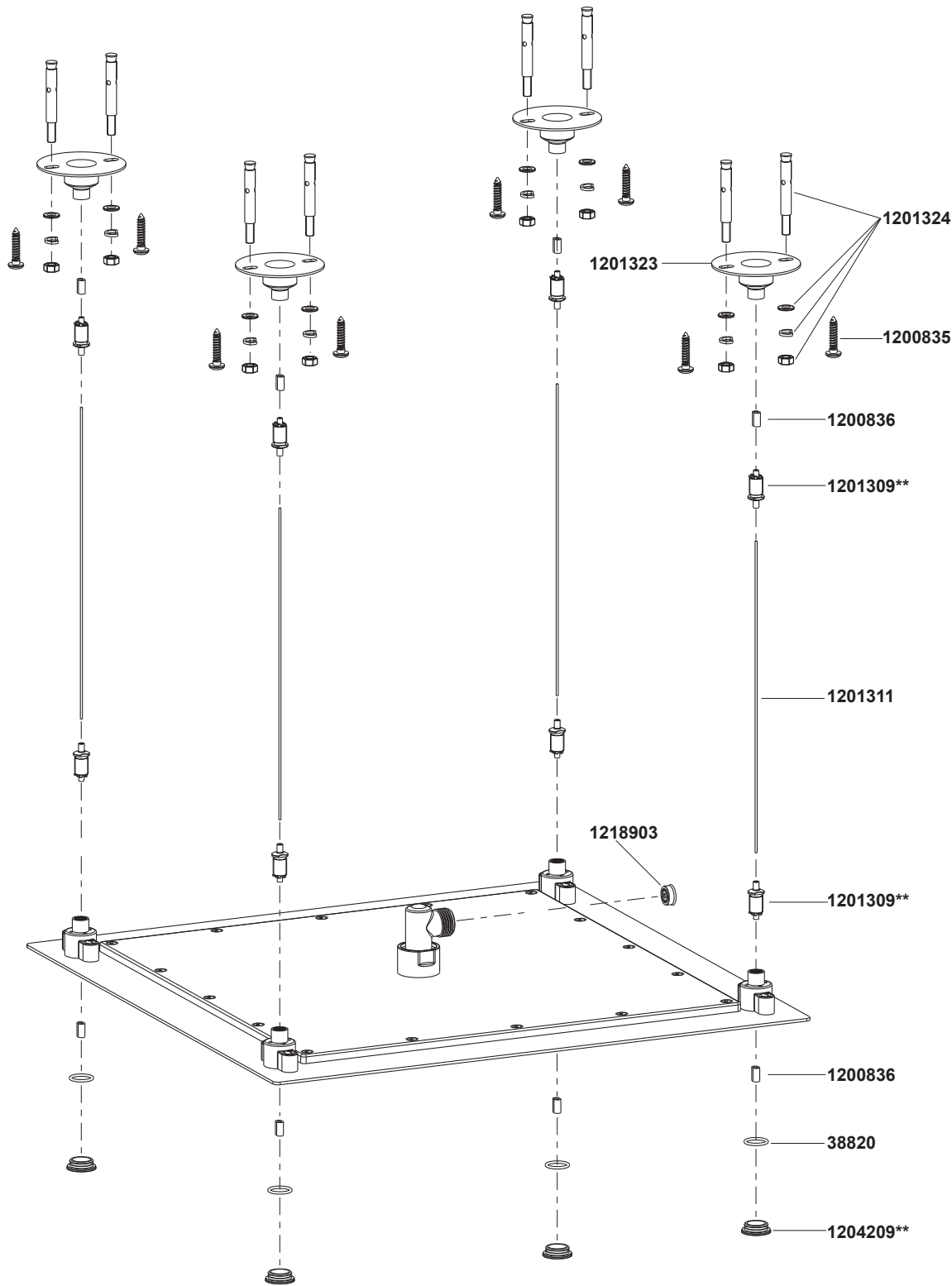

**Color code must be specified when ordering

98275T-CL Ceiling-mount 14" Rainhead With Katalyst Air-Induction Technology

BEFORE YOU BEGIN

All information is based on the latest product information available at the time of publication. Kohler Co. reserves the right to make changes in product characteristics, packaging, or availability at any time without notice.

Please leave these instructions for the consumer. They contain important information.

NOTES:

- 1. Flush the water supply pipes thoroughly to remove debris.
- 2. Recommended working pressure: 2 to 5 bar.
- 3. The highest working pressure for spray is 0.5MPa(5bar). If it exceeds 0.5MPa(5bar), a pressure reducer is needed. The highest water and environment temperature is 60°C. Please keep handspray, shower head and the shower arm away from heater, or it may become damaged and cause injury to the user.

ROUGH-IN DIMENSIONS

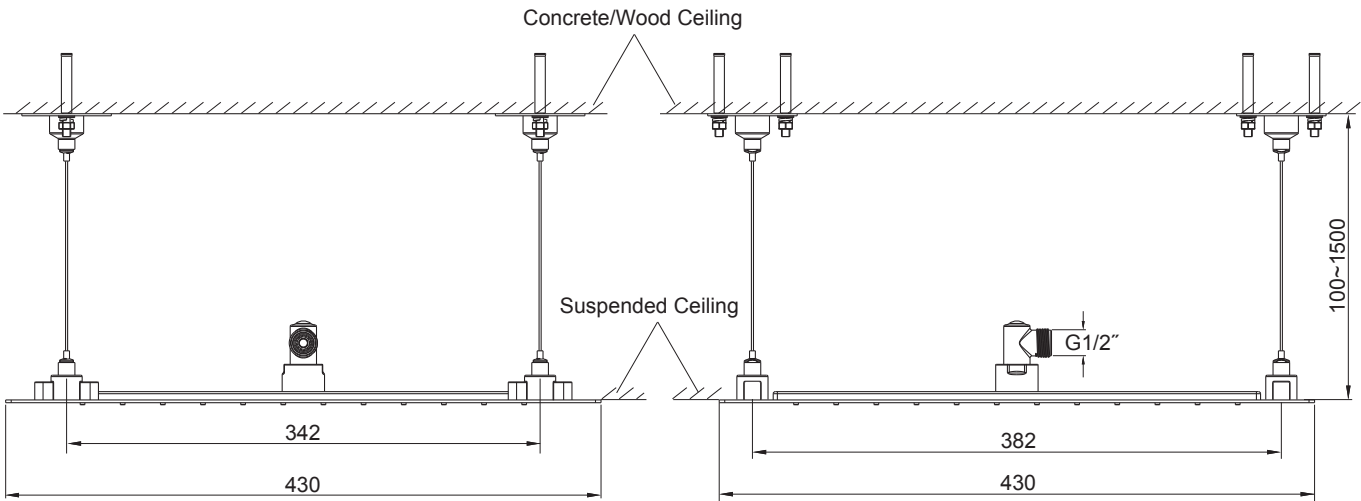

INSTALLATION

How to install the rainhead

Select a suitable location avoiding the buried cables and pipes on the concrete ceiling or wood ceiling to install the rainhead. Reserve the proper space in the suspended ceiling to install the rainhead.

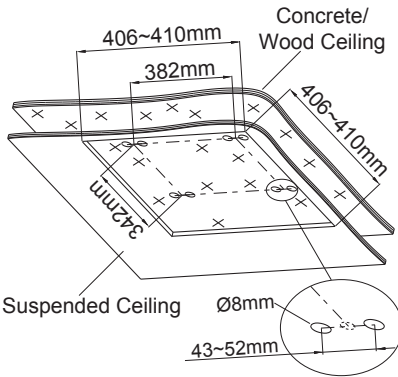

Make sure the end(3) of the stainless wire(1) is in the fix base(2) before install as shown to the right.

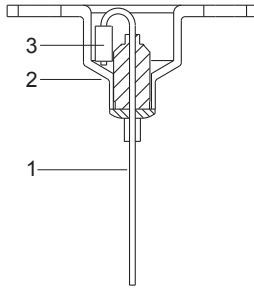

For concrete ceiling, drill eight holes(Ø8mm) at the proper position in the concrete ceiling according to the marked dimensions and expansion screw's(4) diameter. Hammer expansion screws into the holes(Ø8mm). Secure the fix bases(2), the washers(5) and the locking gaskets(6) on the concrete ceiling with the nuts(7).

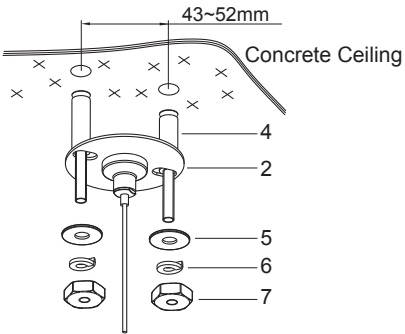

For wood ceiling, install the screws(8) at the proper position in the ceiling according to the marked dimensions.

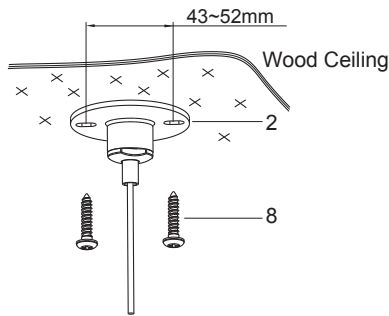

Flush the water supply pipes thoroughly for about one minute to remove debris.

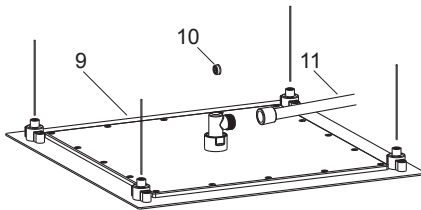

Before install the rainhead(9), install regulator(10) as the figure shown if needed. Connect the hose(11, not provided) and rainhead.

Insert the other end of the stainless wire(1) into the tubes(14) respectively. One hand drag the stainless wire, another hand push the rainhead upwards, make sure the rainhead against the suspended ceiling. Insert the spare wire into the clip(12), and insert the stainless wire into the hole(13) as shown in the right. Press the cap(15) with O-ring.

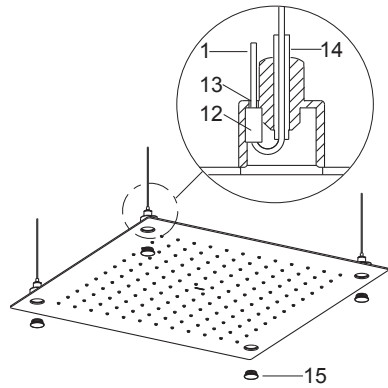

Apply silicon sealant around the rainhead to fix the rainhead if needed.

How to disassemble the rainhead

Remove the silicon sealant by tool if silicon sealant applied. Unpack the caps(15), pull out the end of stainless wire(1) from the hole(13) of nut kits. Remove the clips. Hold the rainhead, pull down the tubes(14) of the nut kit until it is stick. Keep a certain distance between the rainhead and suspended ceiling. Unscrew the rainhead from the hose. Remove the rainhead.

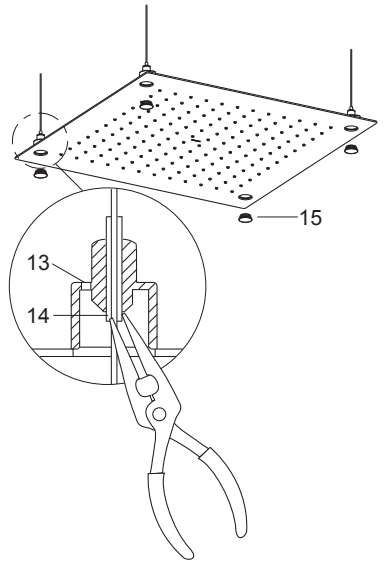

INSTALLATION CHECKOUT

Ensure that all joint are locking. Ensure that the handle is in the off position.

Turn on the main water supply and drain, and check for leaks. Repair as needed.

CLEANING INSTRUCTIONS

All Finishes: Clean the finish with mild soap and warm water. Wipe entire surface completely dry with clean soft cloth. Many cleaners may contain chemicals, such as ammonia, chlorine, toilet cleaner etc, which could adversely affect the finish and are not recommended for cleaning.

Do not use abrasive cleaners or solvents on Kohler faucets and fittings.