

## 99866T-9 Recessed Thermostatic 3 Way Trim

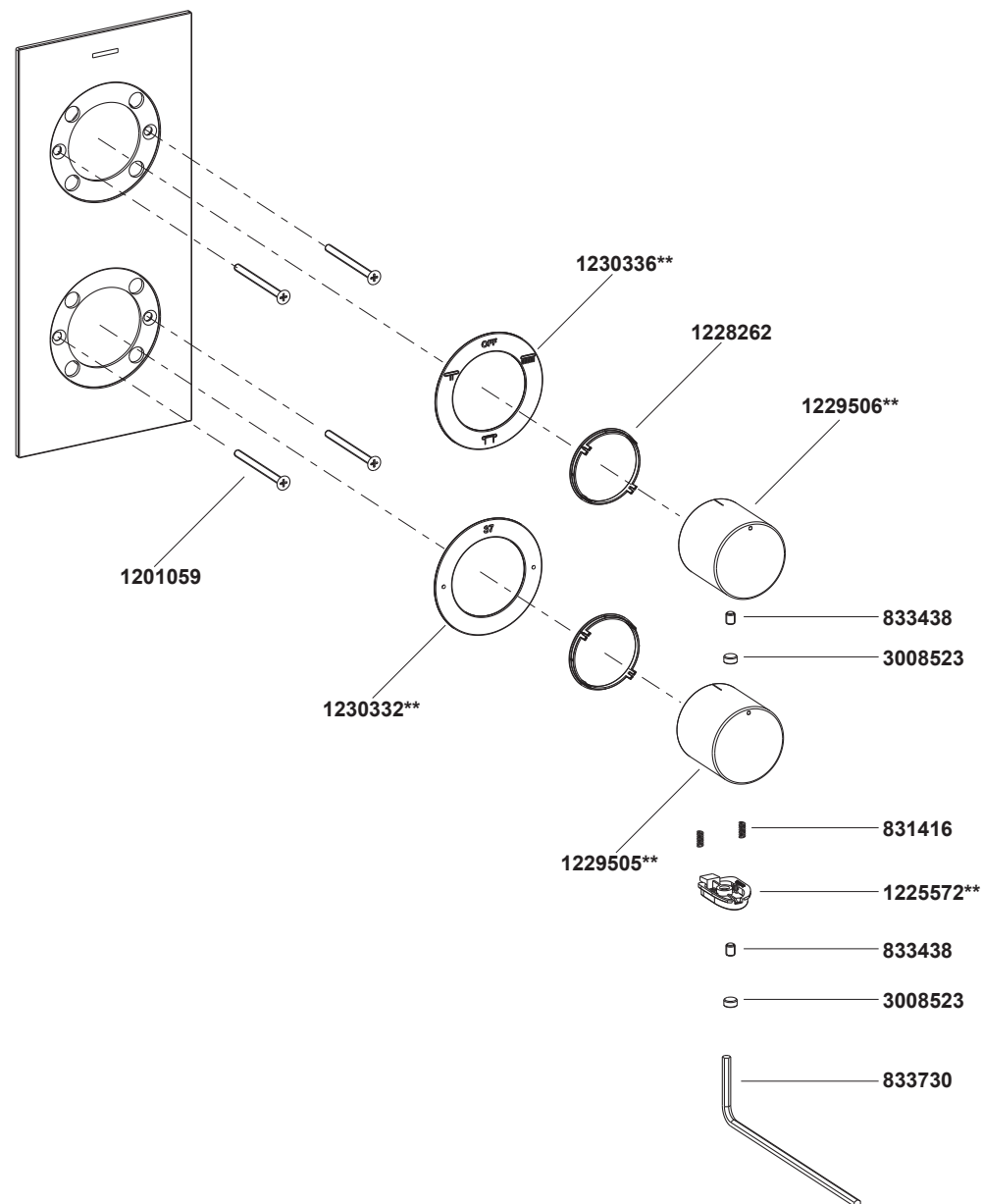

**\*\*Color code must be specified when ordering.**

**99865T-9** Recessed Thermostatic 2 Way Trim  
**99866T-9** Recessed Thermostatic 3 Way Trim

## BEFORE YOU BEGIN

All information is based on the latest product information available at the time of publication. Kohler Co. reserves the right to make changes in product characteristics, packaging, or availability at any time without notice.

Please leave these instructions for the consumer. They contain important information.

**NOTES:**

1. Do not remove the plastic guard from the valve body until instructed to.
2. Install valve 99869T according to the rough-in dimensions of 99865T-9, install valve 99870T according to the rough-in dimensions of 99866T-9.

## OPERATION INSTRUCTION

The temperature is set by slowly turning the temperature handle at underside. For safety reasons, there is a stop that limits temperature to 37°C. To get a higher temperature, continue turning the temperature handle.

Water flow is set by turning the top diverter handle. When the mark on handle aligns with the mark 'OFF' on faceplate, water flow is blocked.

## ROUGH-IN DIMENSIONS

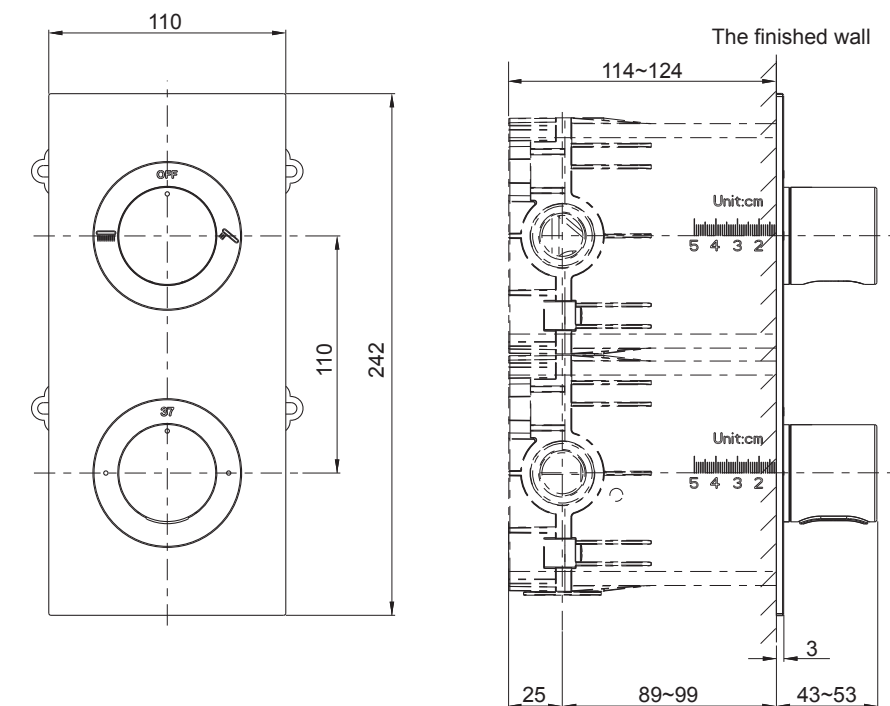

99865T-9

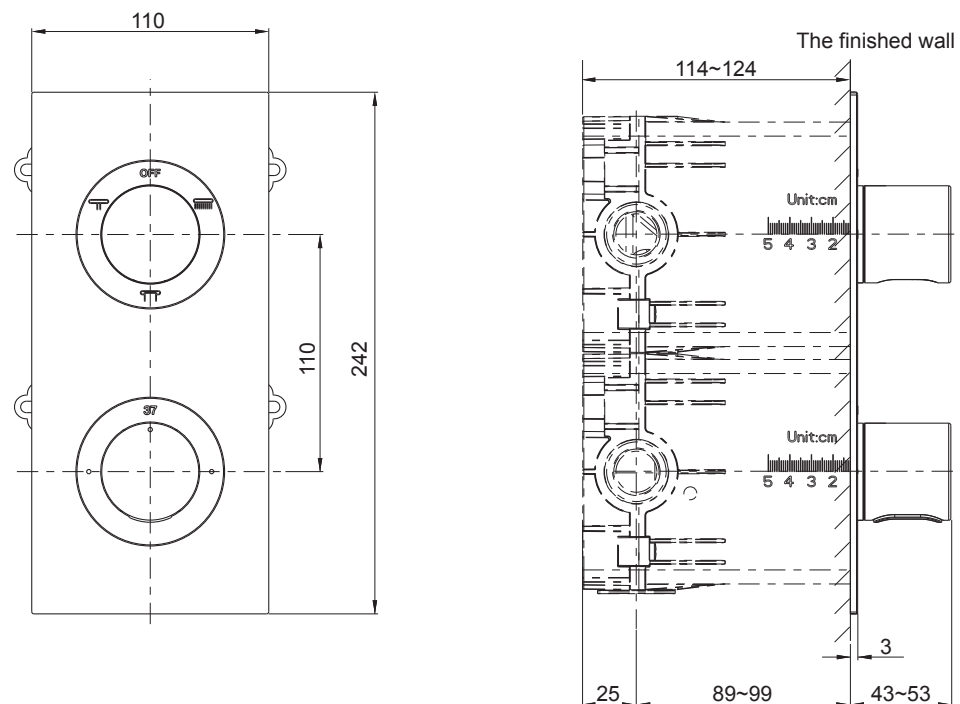

99866T-9

## PIPELINE ARRANGEMENT

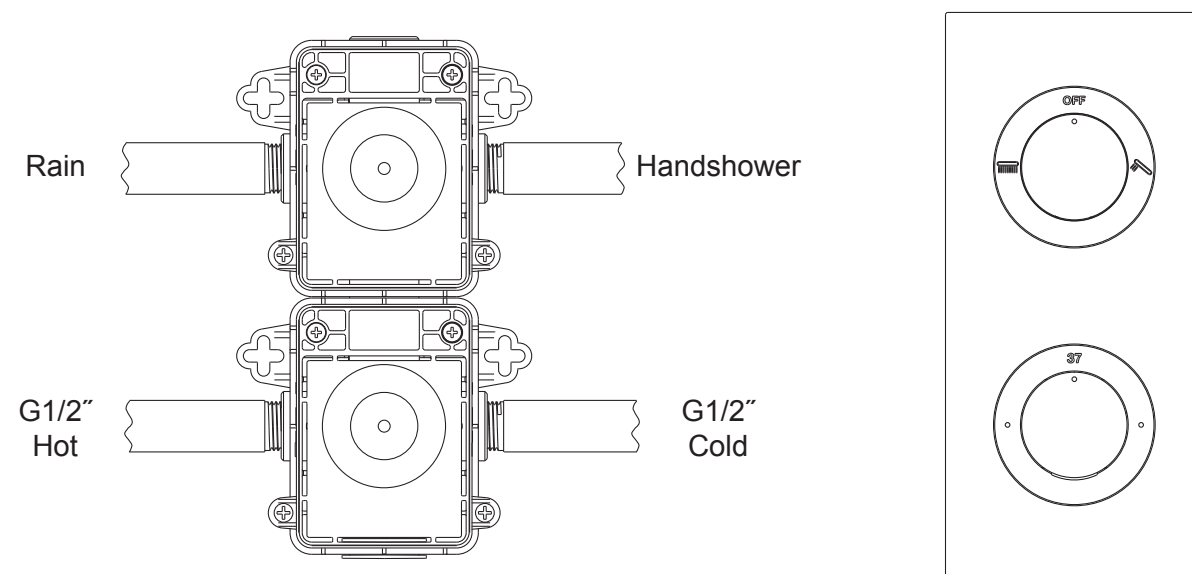

99865T-9(Method 1) Pipeline Arrangement

## 99865T-9 Recessed Thermostatic 2 Way Trim

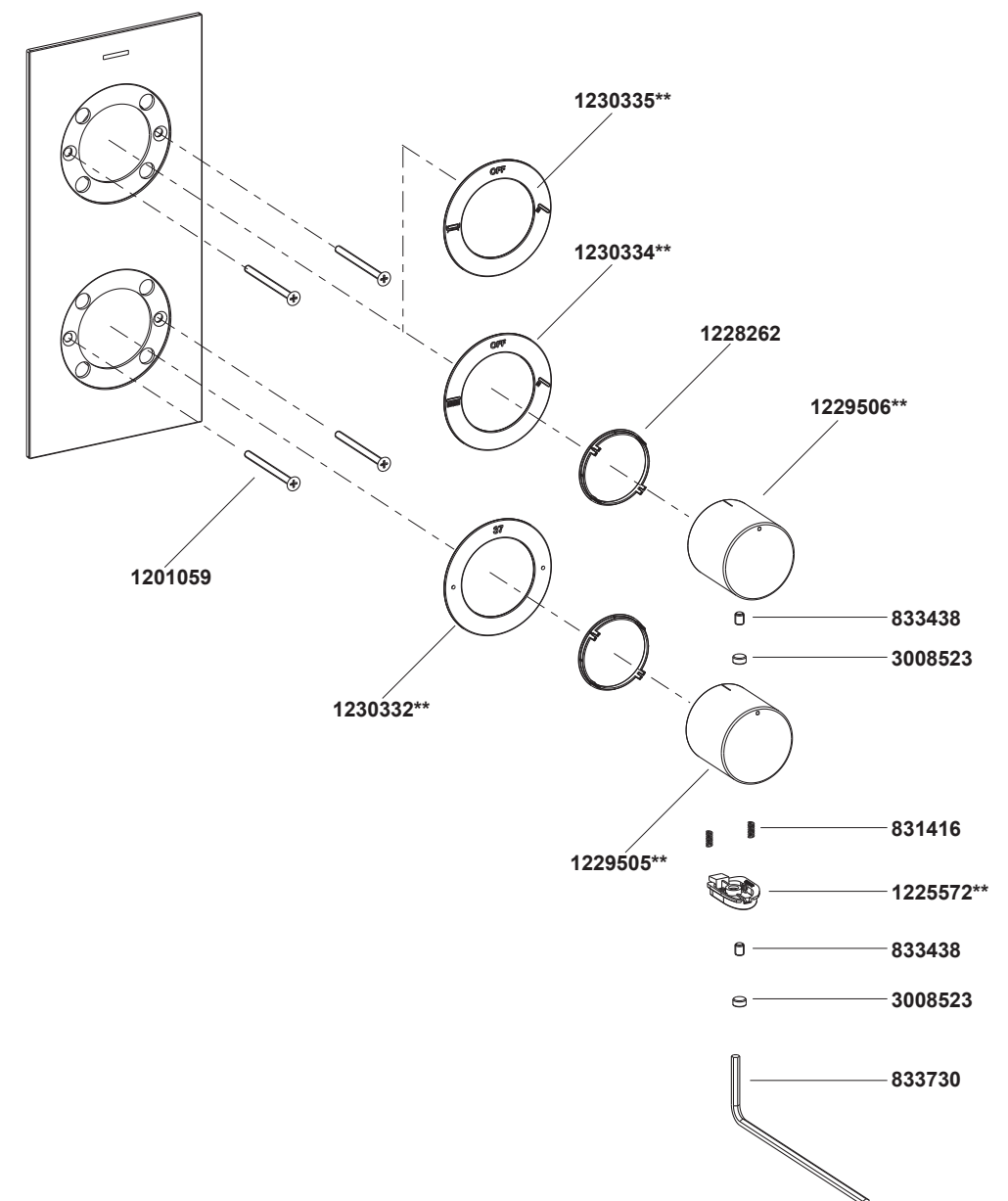

\*\*Color code must be specified when ordering.

## CARE AND MAINTENANCE

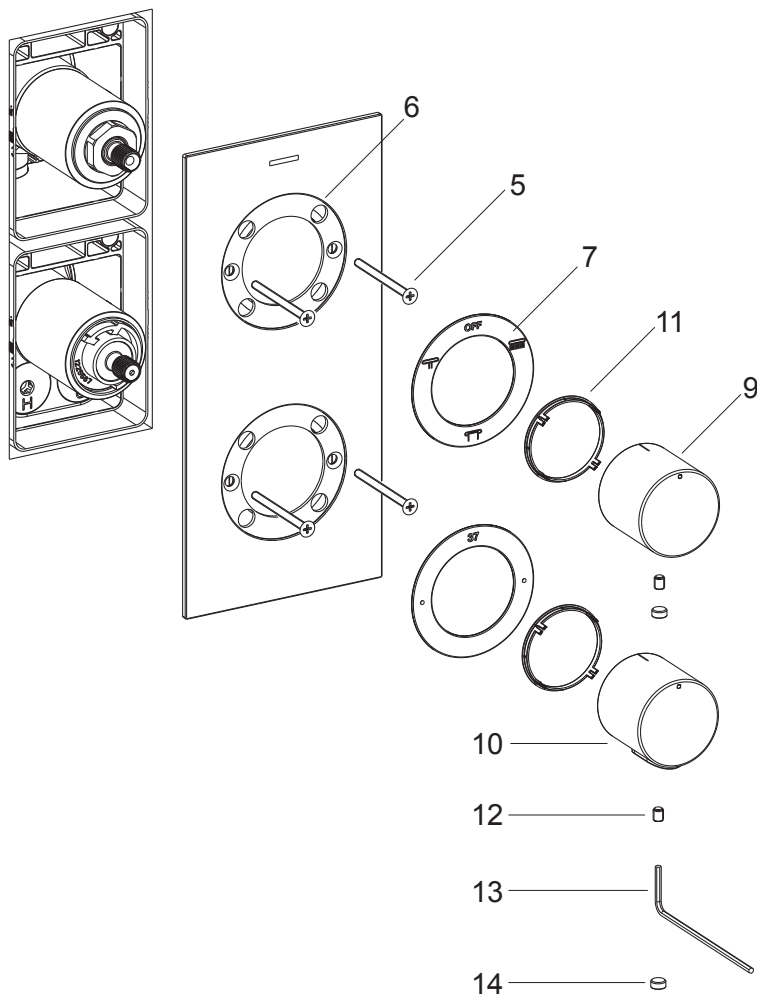

### Clean Filters and Thermostatic Cartridge

Very hard water can obstruct the filters of insert assy and thermostatic cartridge, reduce the flow of water. Please clean the cartridge as follows:

Shut off the water supplies of the faucet, ensure the flow valve closed. The cartridge is critical part, please be careful.

Make sure the mark of the handle(10) align to the number 37, the marks of the handles(9) align with 'OFF'.

**NOTE:** Do not turn the cartridge when reinstall it.

Remove the plug buttons(14), unscrew the setscrews(12) by hex wrench. Remove the handle kits(9,10) and washers(11). Remove the icon rings(7). Unscrew the screws(5), remove the panel(6).

Clean the filters for thermostatic valve and filters according to installation instruction of 99869T & 99870T.

After cleaning, reinstall them as before.

## CLEANING INSTRUCTIONS

All Finishes: Clean the finish with mild soap and warm water. Wipe entire surface completely dry with clean soft cloth. Many cleaners may contain chemicals, such as ammonia, chlorine, toilet cleaner etc, which could adversely affect the finish and are not recommended for cleaning.

Do not use abrasive cleaners or solvents on Kohler faucets and fittings.

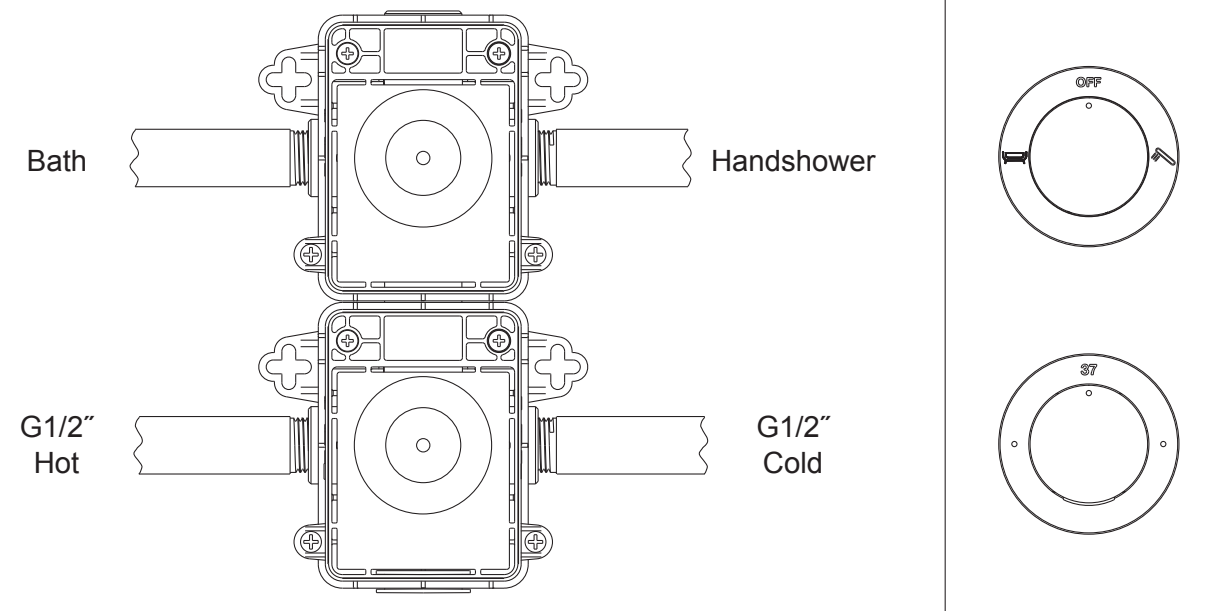

**99865T-9(Method 2) Pipeline Arrangement**

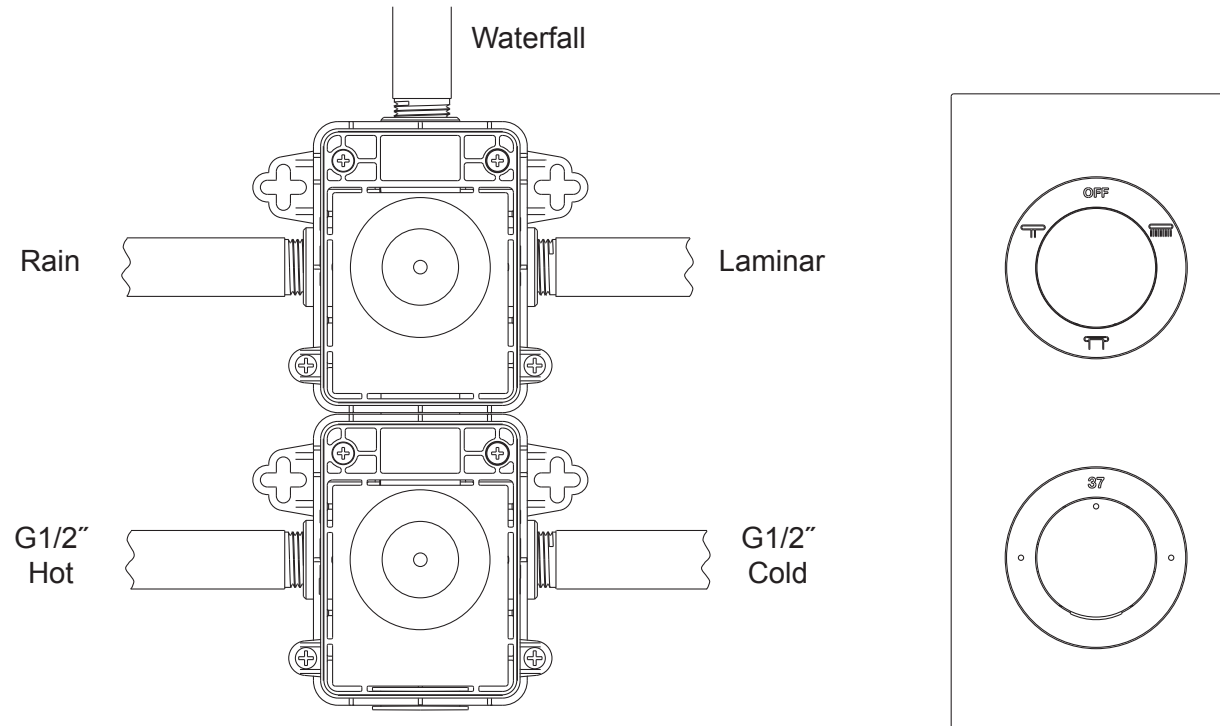

**99866T-9 Pipeline Arrangement**

## INSTALLATION

**NOTE:** Install valve 99869T according to the rough-in dimensions of 99865T-9, install valve 99870T according to the rough-in dimensions of 99866T-9.

When the finished wall is completed, apply silicon sealant to the gap between the guard and the finished wall.

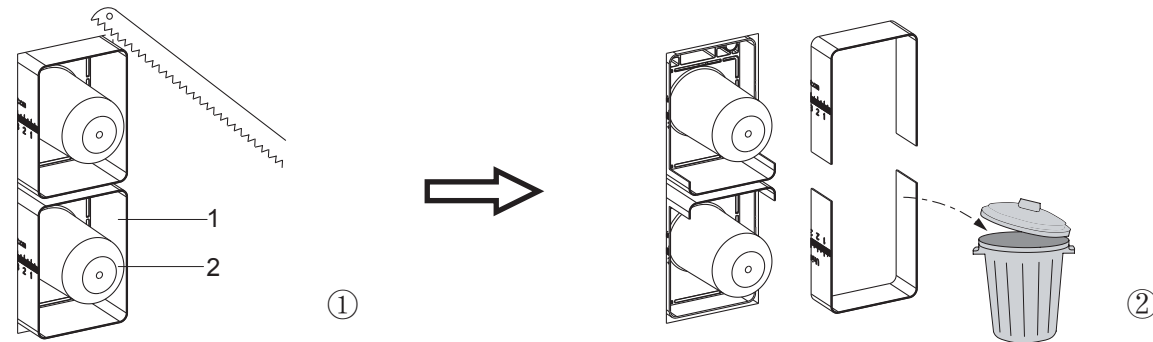

Cut the protrudent part from the side to the middle of the plastic guard(1) out of the finished wall. **NOTE:** Don't damage the valve guard(2).

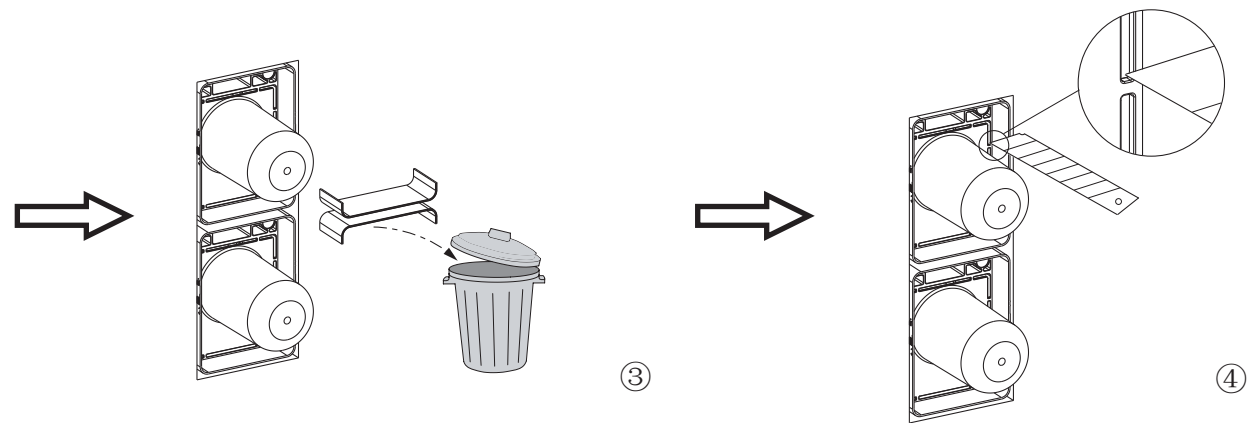

Cut the rest of the plastic guard.

Carve the valve guard joint by utility knife.

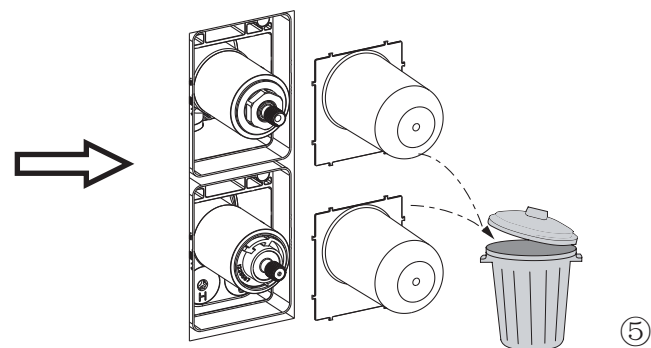

Remove the guard. Shut off the water supplies.

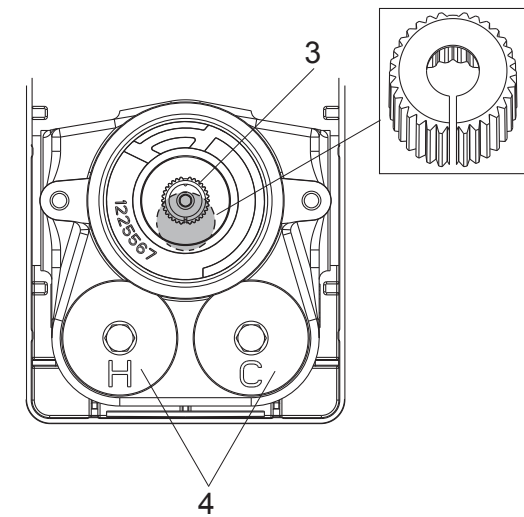

**NOTE:** Don't turn the cartridge spindle during the installation. Ensure that the notch of adapter(3) is downward.

If the hot and cold water supplies are misplaced, to ensure the product to work properly, installer must exchange the position of the hot and cold insert assy(4).

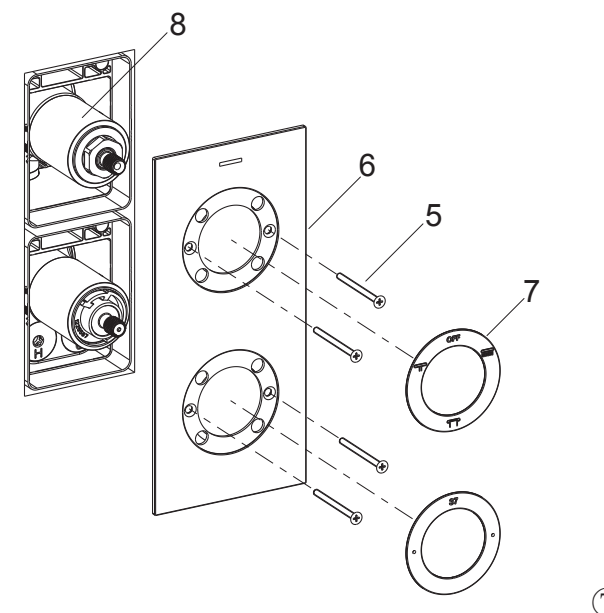

Before install the panel(6), take off the magnetic icon rings(7) from the panel.

To avoid scratch the escutcheons(8), gently place the panel against the finished wall.

Secure it with screws(5). **NOTE:** Don't overtighten to distort the panel.

Choose and put the suitable magnetic icon rings(7) in the corresponding position according to the waterway connection.

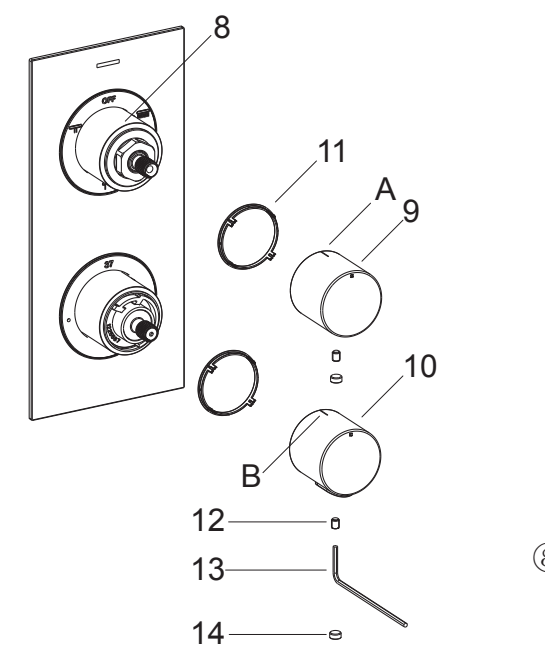

Install the handle kits(9,10) with washers(11) to the valves. Make sure the mark B of the handle(10) align to the number 37, the marks A of the handles(9) align to mark "OFF".

Tighten the setscrews in place with a hex wrench. Make sure the handle kits are tight against the escutcheons(8). Press plug buttons(14) into the holes.