

77276T-L    Multi-function Ceiling Mount Shower Head
BEFORE YOU BEGIN
<p>All information is based on the latest product information available at the time of publication. Kohler Co. reserves the right to make changes in product characteristics, packaging, or availability at any time without notice.</p> <p>Please leave these instructions for the consumer. They contain important information.</p> <p><b>NOTES:</b></p> <p>1. The product must be installed and maintained by professional installers.</p> <p>2. Flush the water supply pipes thoroughly to remove debris.</p> <p>3. Recommended working pressure: 0.2 to 0.5MPa(2 to 5 bar).</p> <p>4. The highest working pressure for shower is 0.5MPa(5bar). If it exceeds 0.5MPa(5bar), a pressure reducer is needed. The highest water and environment temperature is 60°C. Please keep handspray, shower head and the shower arm away from heater, or it may become damaged and cause injury to the user.</p>
STANDARD APPLICABLE
Special model meets or exceeds the following at date of manufacture: TIS
ROUGH-IN DIMENSIONS
<div><p>Concrete/ Wood Ceiling</p><p>Suspended Ceiling</p><p>G1/2"</p><p>G1/2"</p><p>G1/2"</p><p>200~1200</p><p>536</p><p>370</p><p>370</p><p>600</p><p>800</p></div> <p>77276T-L</p>

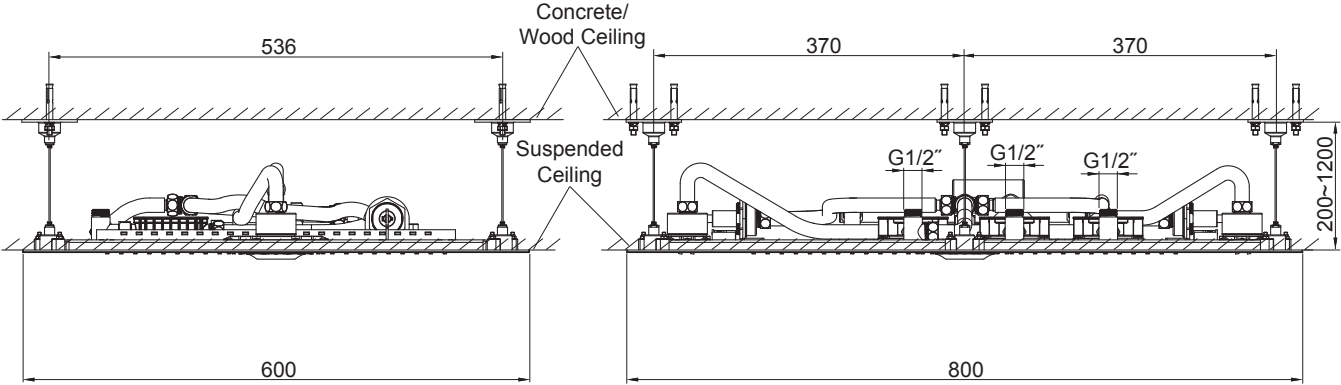
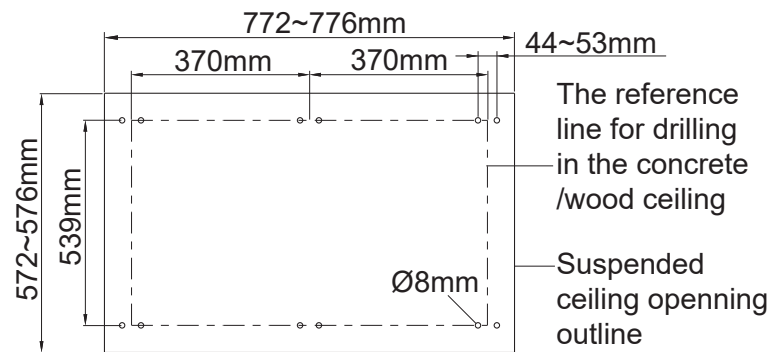

### How to Install the Shower Head

Select a suitable location avoiding the buried cables and pipes on the concrete ceiling or wood ceiling to install the shower head. Reserve the proper space in the suspended ceiling to install the shower head.

①

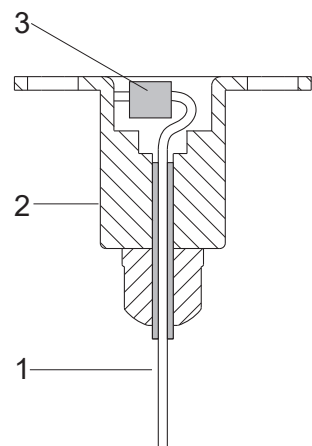

Make sure the end(3) of the stainless steel wire(1) is in the fixing base(2) before installation as shown in the figure.

②

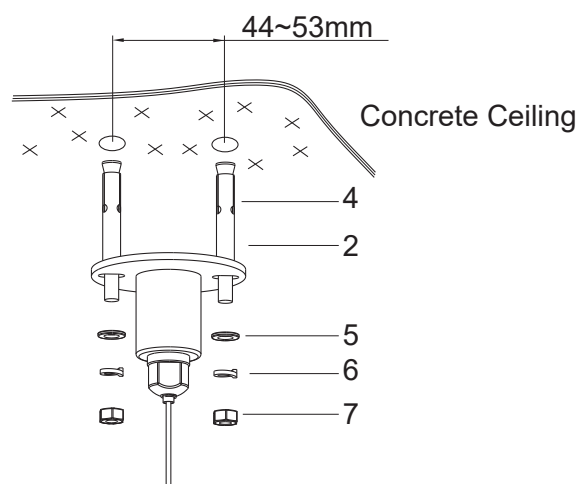

For concrete ceiling, drill 12 holes(Ø8mm) at the proper position in the concrete ceiling according to the marked dimensions and expansion screw's(4) diameter.

Hammer expansion screws into the holes(Ø8mm). Secure the fixing bases(2), the washers(5) and the locking gaskets(6) on the concrete ceiling with the nuts(7).

③

### 77276T-L Multi-function Ceiling Mount Shower Head

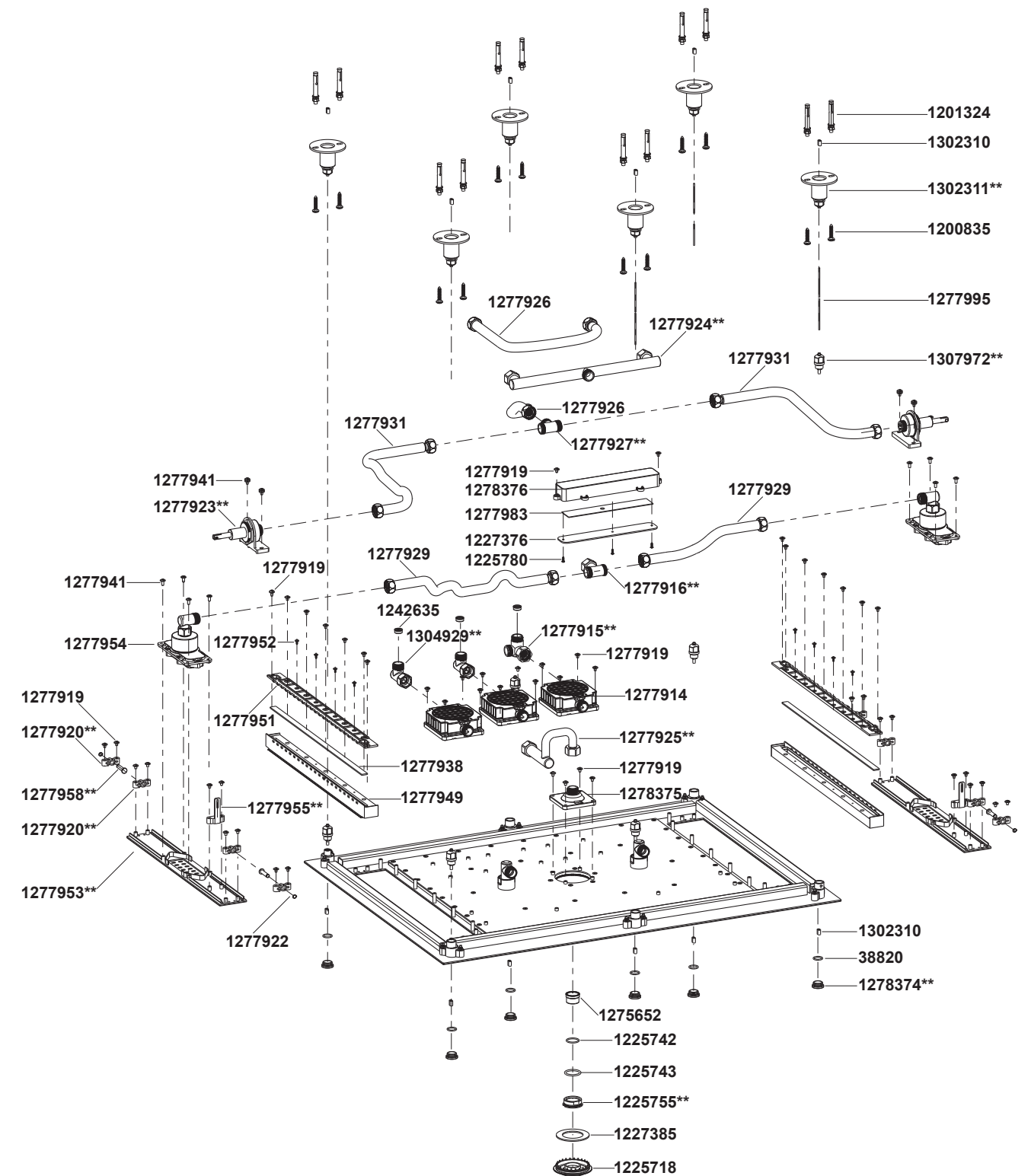

\*\*Color code must be specified when ordering.

**NOTE:** For all Asia pacific regions (excluding China) add SP (SPxxxxxxx\*\*) in front of the part number when ordering.

Statistics of Contents of Toxic or Hazardous Substances or Elements

Part name	Toxic or Hazardous Substance or Elements					
	Lead (Pb)	Mercury (Hg)	Cadmium (Cd)	Hexavalent Chromium (Cr(VI))	Polybrominated biphenyls (PBB)	Polybrominated Diphenyl Ethers (PBDE)
Water Outlet Assy.	×	○	○	○	○	○
Shell Assy.	×	○	○	○	○	○
Connection Assy.	×	○	○	○	○	○
Lighting Assy.	×	○	○	○	○	○
Mounting Assy.	×	○	○	○	○	○
Water Inlet Assy.	×	○	○	○	○	○

○: Indicates that the substance in the material composition is below the high limits of the current requirements in GB/T 26572.  
×: Indicates that at least one of the homogeneous substance in the material composition is below the high limits of the current requirements in GB/T 26572.  
Note: the information provided is based on the supplier data and Kohler inspection results. The product is designed not to hurt the environment. Under current technology, all hazardous materials have been used in the smallest amounts possible. Kohler will strive to reduce the use of these hazardous materials used in this product.

 The product “service life for environment protection” is 10 years; Kohler Company will specify product service life based on product characteristics. The product “service life for environment protection” is only effective when the product is used as described in the product specification.

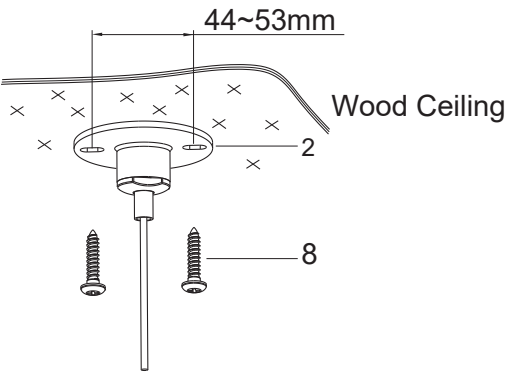

For wood ceiling, install each fixing base(2) along with a stainless steel wire with two screws(8) at the proper position in the ceiling according to the marked dimensions.

④

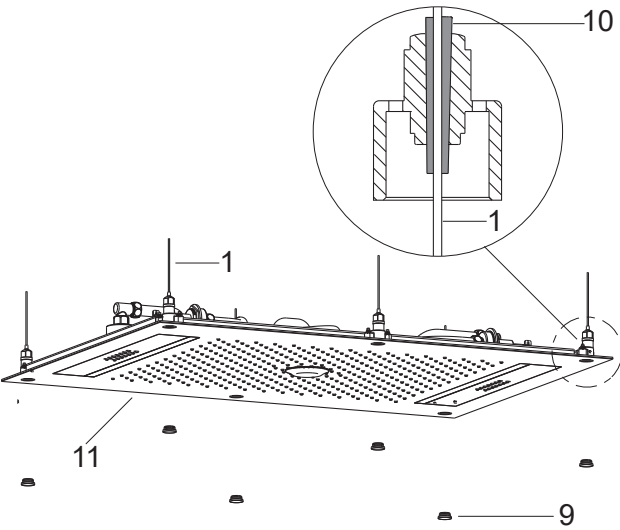

Flush the water supply pipes thoroughly for about one minute to remove debris. Gently pry the caps(9) from the shower head with a tool.

Insert the other end of the stainless steel wire(1) into the tubes(10) respectively. Push the shower head(11) upward with one hand to a suitable location for the easiest connection of the hose by dragging the stainless steel wire with another hand.

⑤

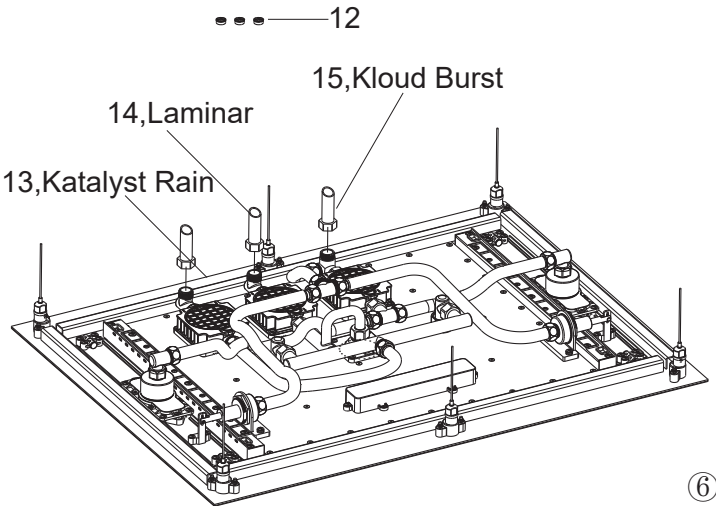

If needed, install the regulator(12) as shown before connecting the hose.

Connect the hoses to the joints(13, 14 & 15). The joint(13) is for Katalyst Rain; the joint(14) is for Laminar; the joint(15) is for Kloud Burst.

⑥

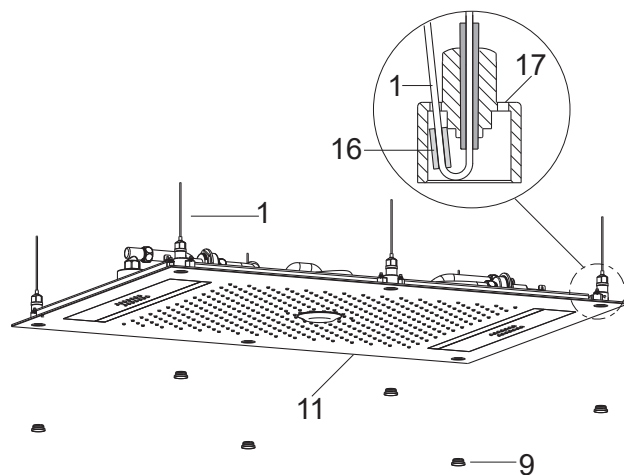

After connecting the hoses, push the shower head(11) upward by dragging the stainless steel wires, until the shower head presses against the suspended ceiling and all stainless steel wires are stretched tight. Make each wire sleeved with a clip(16) go through the hole(17) to hide the exposed length of it. Press the cap (9) along with an O-ring into each corner hole on the shower head. **NOTE:** Pull all stainless steel wires at the same time, and make sure the shower head is moved up horizontally. To avoid the stainless steel wires being cut by shower and cause danger.

Fill any gaps with silicon sealant around the shower head if needed.

### How to Remove the Shower Head

Remove the silicon sealant with a tool if needed. Gently pry the caps(9) from the shower head with a tool.

Pull out the end of stainless wire(1) from the hole(17) of nut kits. Remove the clips.

**WARNING:** Risk of personal injury or product damage. If the shower unit is not securely held in place during the dismounting, the product may fall causing personal injury. Firmly holding the shower head, drag down the six tubes(10) as shown till a stop and hold it. Meanwhile, make the shower head slide down to a suitable position. Disconnect the hoses from the shower head. Remove the whole shower head. **NOTE:** Make sure the whole shower head is removed horizontally, to avoid the stainless steel wires being cut by shower and cause danger.

### How to Replace the PCB

Remove the shower head.

Unscrew the four screws(18) with a 2.5mm hex wrench. Unscrew the three screws(19) with a Phillips screwdriver.

Remove the cap(20). Take out the PCB(21) from the box(22). Disconnect the terminals. Replace the PCB.

Connect the corresponding terminals in turn. Reinstall the parts.

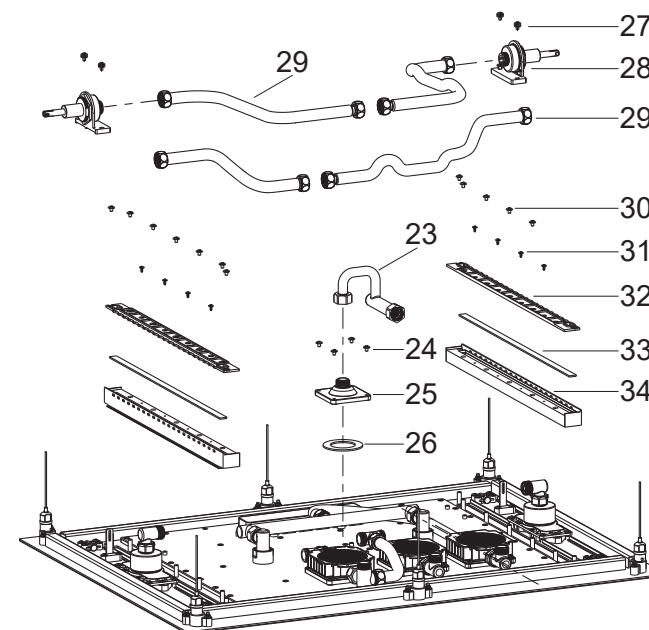
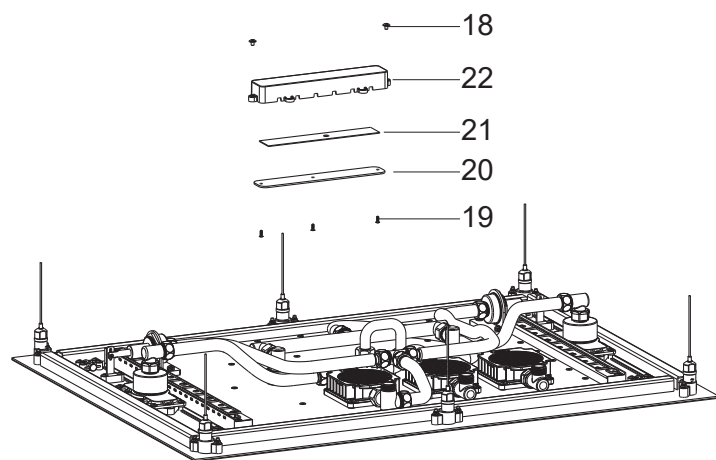

### How to Replace the LED Light

Remove the shower head.

Disconnect the terminals of the LED light.

Disconnect the U-tube(23) by hand. Remove the label. Unscrew the screws(24) with a hex wrench and remove the Laminar spray assy(25). Replace the LED lighting board(26). Reinstall the parts. Connect the corresponding terminals in turn.

Disconnect the hose(29). Remove the screws(27) and engine assemblies(28). Unscrew the screws(30) and the screws(31). Take out the lamp boxes(34), open the caps(32), replace the LED lighting boards(33). Reinstall the parts. Connect the corresponding terminals in turn.

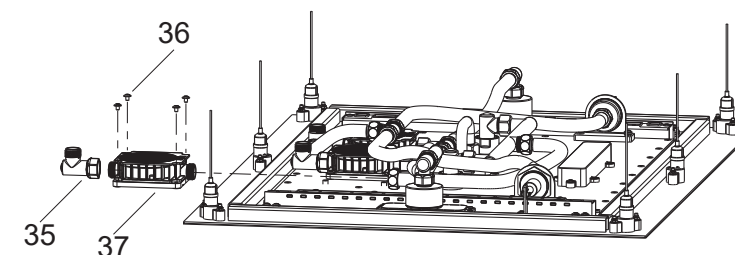

### How to Replace the Generator Assy

Remove the shower head.

Disconnect the terminals of the generator assy(37).

Remove the elbow(35) with a wrench. Unscrew the four screws(36) in the generator assy with a 2.5mm hex wrench. Take out the generator assy. Replace the generator assy. Reinstall the parts. Connect the corresponding terminals.

## INSTALLATION CHECKOUT

Ensure that all joints are fastened. Ensure that the panel knob is at the closed position.

Turn on the main water supply and drain, and check for leaks. Repair as needed.

Turn the panel knob to open position to make sure the LED is lighted and flicker free under recommended water pressure.

## CLEANING INSTRUCTIONS

All Finishes: Clean the finish with mild soap and warm water. Wipe entire surface completely dry with clean soft cloth. Many cleaners may contain chemicals, such as ammonia, chlorine, toilet cleaner etc, which could adversely affect the finish and are not recommended for cleaning.

Do not use abrasive cleaners or solvents on Kohler faucets and fittings.