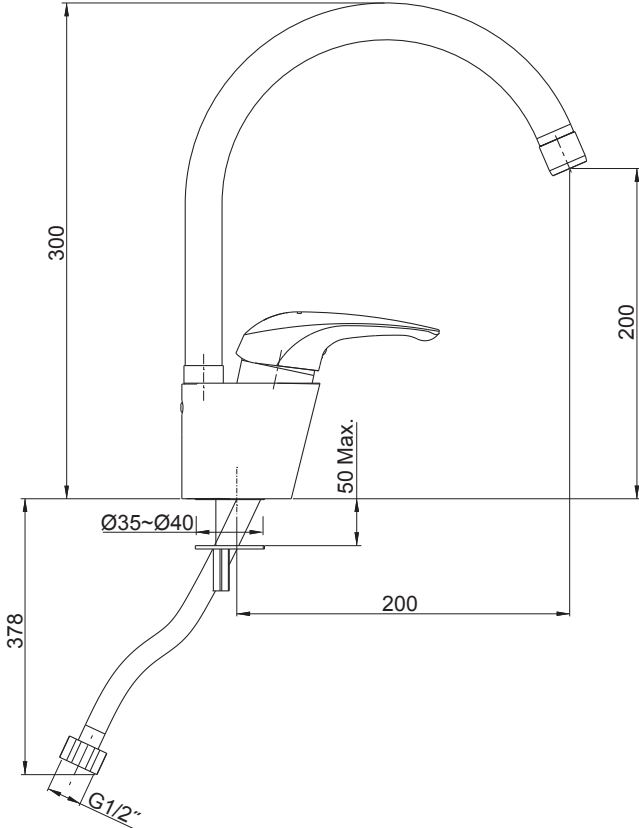

<div>8608T-B1 Single Lever Kitchen Faucet</div> <div>8608T-B3 Single Lever Kitchen Faucet</div>
<div>BEFORE YOU BEGIN</div> <div>All information is based on the latest product information available at the time of publication. Kohler Co. reserves the right to make changes in product characteristics, packaging, or availability at any time without notice.</div> <div>Please leave these instructions for the consumer. They contain important information.</div> <div>NOTES:</div> <div><div>1. Flush the water supply pipes thoroughly to remove debris.</div><div>2. For new installations, assemble the faucet to sink before installing.</div></div>
<div>HANDLE OPERATION</div> <div>Lift the handle gently. Turn clockwise for hot water, counter-clockwise for cold water.</div>
<div>ROUGH-IN DIMENSIONS</div> <div></div>

INSTALLATION

How To Install The Faucet

Insert the the spout kit(1) into the outlet hole. Tighten the screw(2) by hex wrench(3).

If needed to take off the hoses to repair, reinstall and tighten them by hand.

Install flexible supply hoses(4) and mounting studs(5) into the faucet body base(6).

Slide the washer(7) over the flexible hoses and mounting studs, and into the groove on the bottom of the faucet body.

Insert the flexible hoses(4) into the sink hole. Position the faucet. From underside of the sink, fit the brackets(8) on the threaded studs, and secure the faucet with the nuts(9).

If the sink is not installed, install it at this time. Be sure to follow all instructions packed with the sink.

Attach the hoses to water supplies. When facing the faucet, the left hose connects to hot water.

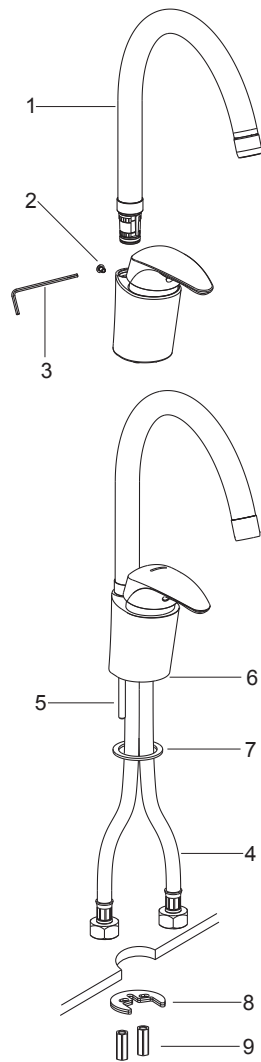

INSTALLATION CHECKOUT

Ensure that all coupling nuts are tight.

Ensure that the lever handle is in the off position.

Turn on the main water supply and drain, and check for leaks. Repair as needed.

Remove the aerator(10). Run hot and cold water through faucet for about one minute to remove any debris. Check for leaks. Repair as needed. Remove any debris from the aerator. Shut off the faucet. Reinstall the aerator.

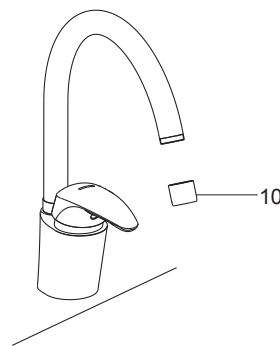

CLEANING INSTRUCTIONS

All Finishes: Clean the finish with mild soap and warm water. Wipe entire surface completely dry with clean soft cloth. Many cleaners may contain chemicals, such as ammonia, chlorine, toilet cleaner etc, which could adversely affect the finish and are not recommended for cleaning.

Do not use abrasive cleaners or solvents on Kohler faucets and fittings.

"LEAD FREE" is marked on the back of the faucet signifying its compliance with the United States AB1953

KOHLER®
SERVICE PARTS

CABRIOLE

8608T-B1 Single Lever Kitchen Faucet
8608T-B3 Single Lever Kitchen Faucet

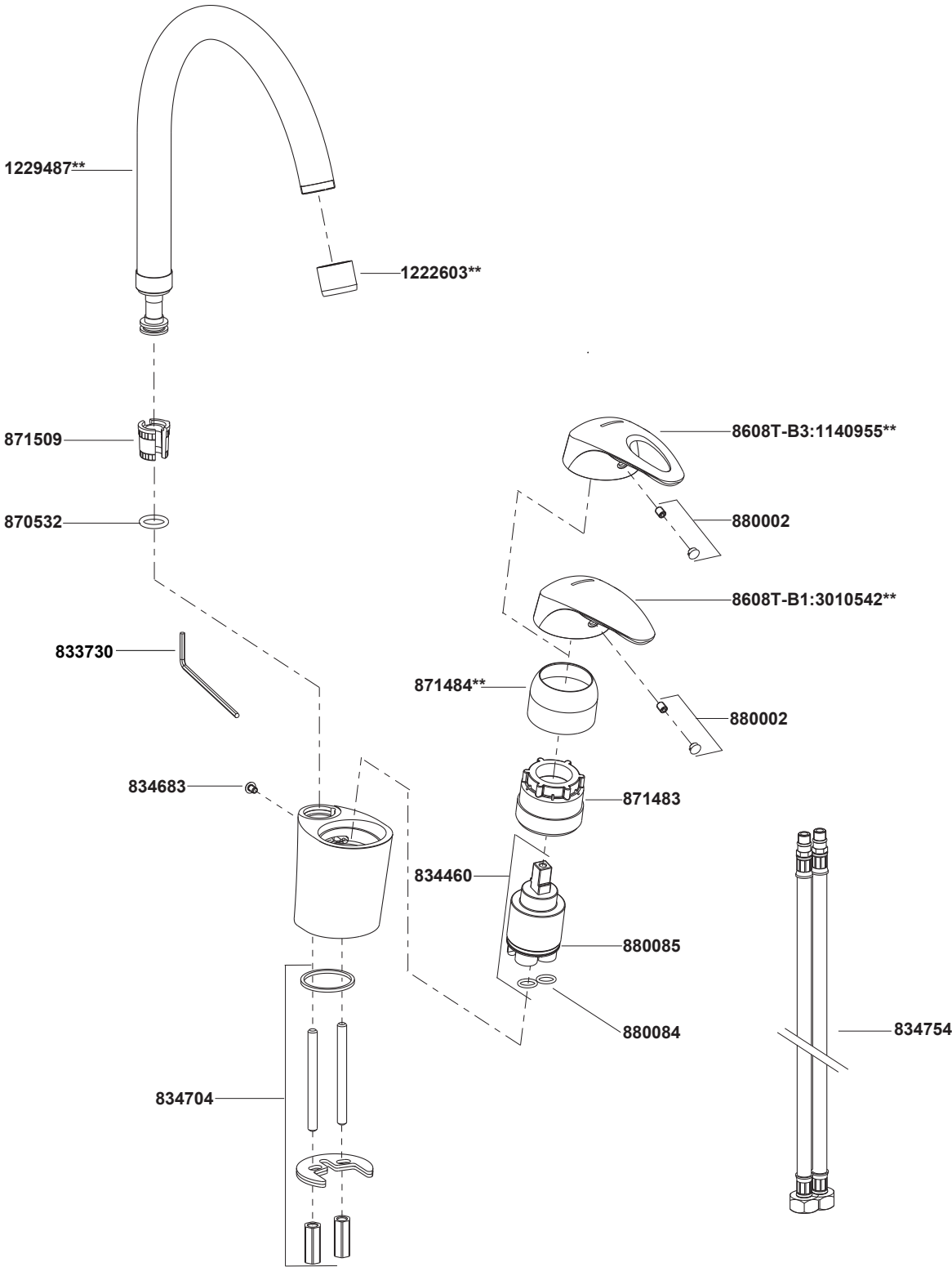

**Color code must be specified when ordering