

8691T-B Single Lever Kitchen Faucet With Pull-Out Spray

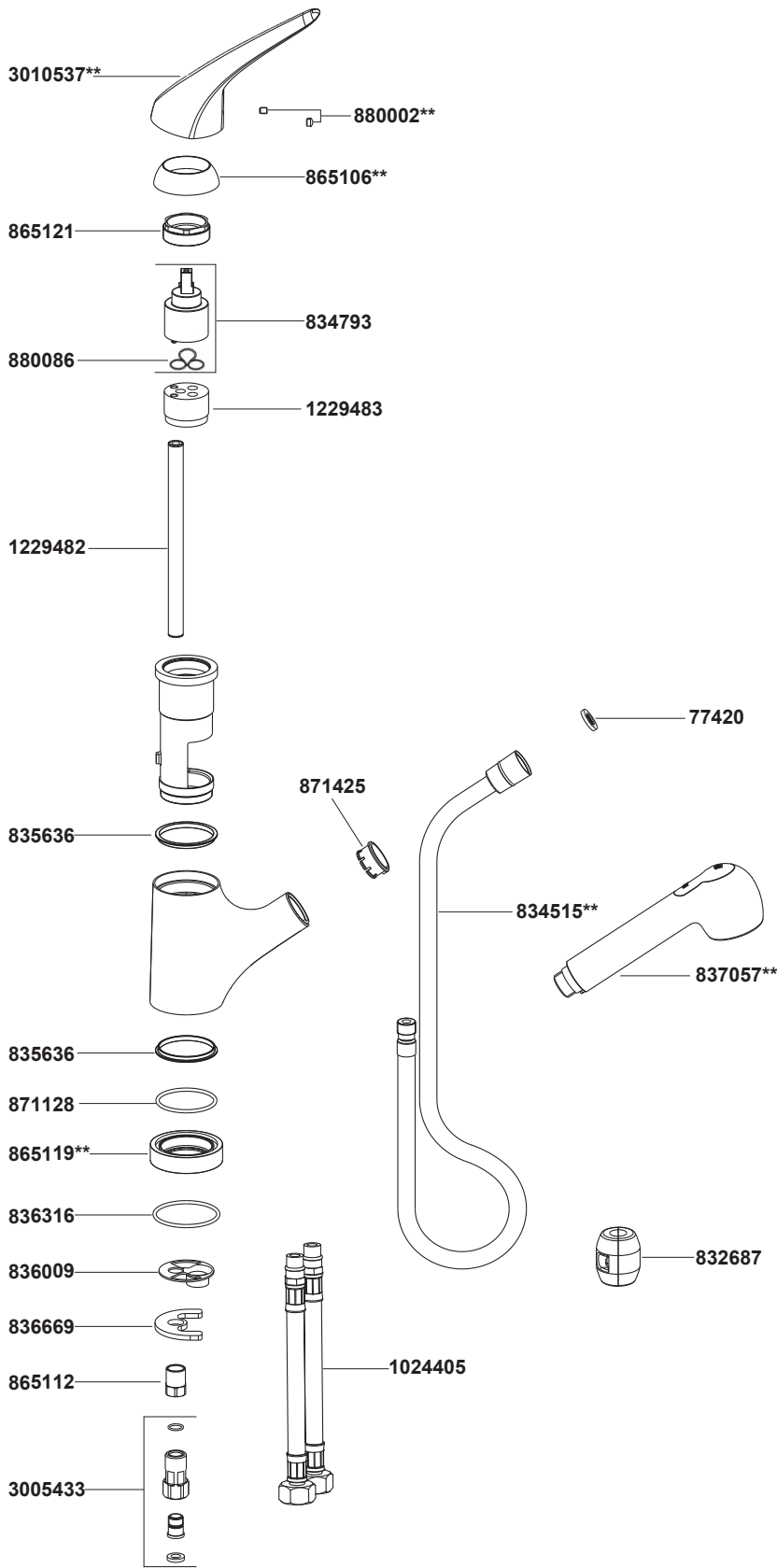

**Color code must be specified when ordering

8691T-B Single Lever Kitchen Faucet With Pull-Out Spray

BEFORE YOU BEGIN

All information is based on the latest product information available at the time of publication. Kohler Co. reserves the right to make changes in product characteristics, packaging, or availability at any time without notice.

Please leave these instructions for the consumer. They contain important information.

NOTES:

1. Flush the water supply pipes thoroughly to remove debris.
2. For new installations, assemble the faucet to sink before installing.
3. The highest working pressure for handspray & shower head is 0.5MPa(5bar). If it exceeds 0.5MPa(5bar), a pressure reducer is needed. The highest water and environment temperature is 60°C. Please keep handspray, shower head and the shower arm away from heater, or it may become damaged and cause injury to the user.

HANDLE OPERATION

Lift the handle gently. Turn clockwise for hot water, turn counter-clockwise for cold water.

ROUGH-IN DIMENSIONS

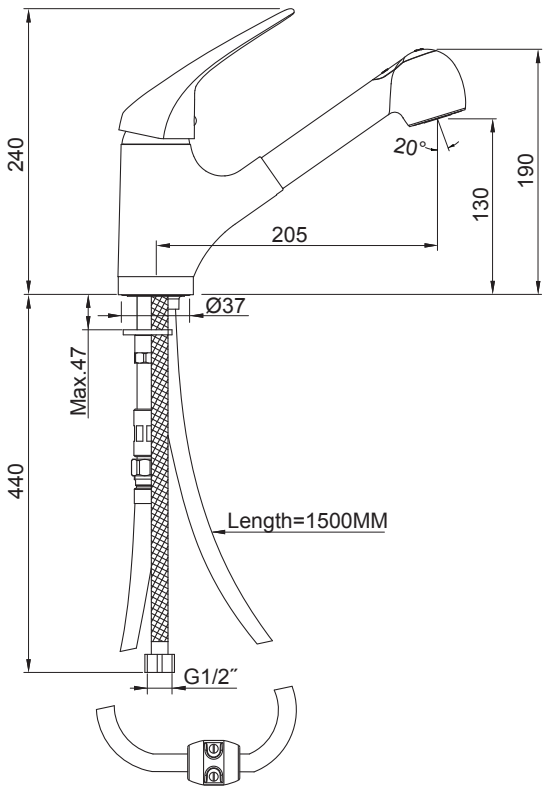

INSTALLATION

How To Install The Faucet

Slide the O-ring(2) and the guide(3) into the groove of the body. Put the hoses into the mounting hole of the sink. Let the bottom of the body against the deck.

From underside of the sink, place the washer(4), bracket(5) and nut(6) onto the mounting stud(1). Position the faucet so that mounting stud is toward the back and the two hoses is symmetrical. Tighten the nut to secure faucet to sink.

Attach the hoses to water supplies. When facing the front of the faucet, the left hose is hot water, the right is cold water.

Put the filter washer(7) into the connector(8) and thread it to the shank (1). Lock the hose connector(9). Do not over tighten it.

Put the weight(10) onto the hose. Adjust the weight. The distance from the faucet base to the weight will be 600~650mm. Tighten the screws to fixup the weight.

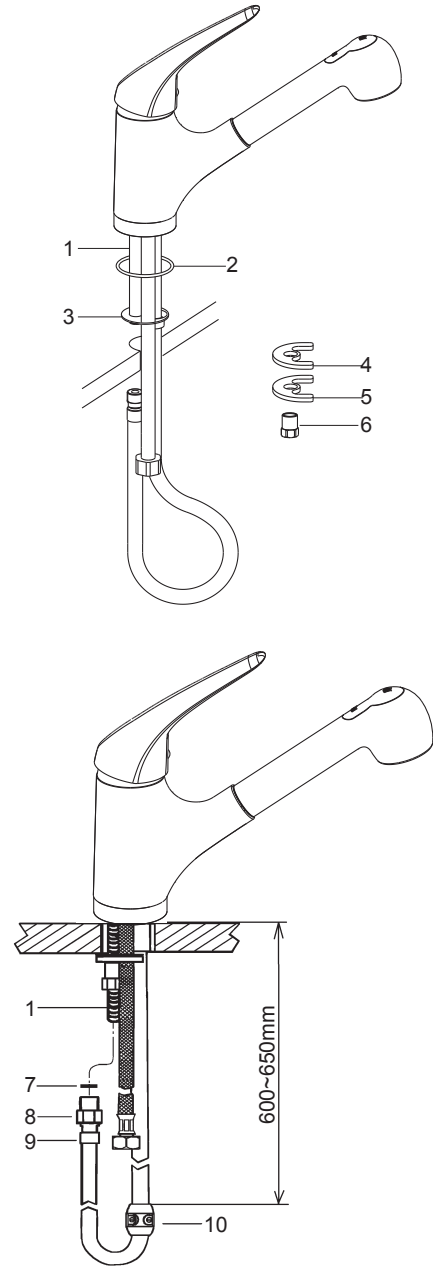

How To Use Spray

Press the button(H), (G) for two diffeent forms of water flow, as figure(a), (b) shown. The minimum water pressure is 0.03MPa(0.3bar).

If you want to use the handspray by hand, take the handspray and pull out the hose.

NOTE: Please pull it gently and do not draw out the spray hose too long, or you may damage the hose, connector and loosen the lead weight.

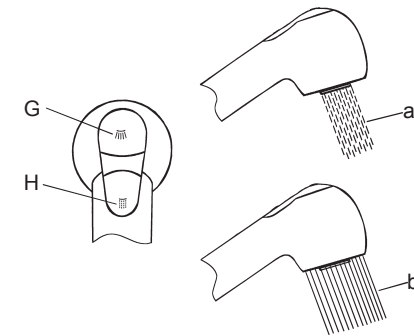

INSTALLATION CHECKOUT

Ensure all coupling nuts are tight. Ensure the lever handle is in the off position. Turn on the main water supply and drain, and check for leaks. Repair as needed.

Remove the handspray(12), filter washer(13) and aerator(11). Run hot and cold water for about one minute to remove any debris. Remove any debris from the filter washer and aerator. Shut off the faucet. Reinstall the filter washer, aerator and handspray.

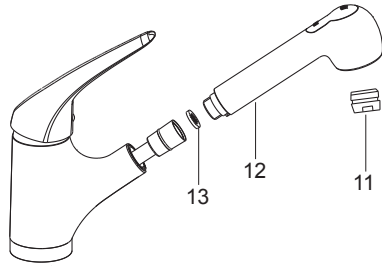

CLEANING INSTRUCTIONS

All Finishes: Clean the finish with mild soap and warm water. Wipe entire surface completely dry with clean soft cloth. Many cleaners may contain chemicals, such as ammonia, chlorine, toilet cleaner etc, which could adversely affect the finish and are not recommended for cleaning.

Do not use abrasive cleaners or solvents on Kohler faucets and fittings.

"LEAD FREE" is marked on the back of the faucet signifying its compliance with the United States AB1953