

15704T 花洒臂	
安装之前	BEFORE YOU BEGIN
<p>所有的资料是按最新出版的产品资料编写而成。科勒公司保留任何时候不经通知即可改变产品特性、包装或产品可供类型的权利。</p> <p>说明书包括重要的安装、保养及清洁方面的内容，请把这些资料交给用户阅读。</p> <p>注意事项：</p> <p>1. 一定要先彻底冲洗供水管以清除管道中的杂质。</p> <p>2. 切断供水管路。</p> <p>3. 遵守所有当地安装及建筑条例。</p> <p>4. 花洒臂最大承重1KG。</p> <p>5. 花洒臂所接花洒最大直径不超过10"。</p> <p>6. 花洒臂最高工作温度及环境温度：60℃。请特别注意花洒同花洒连接的臂管须远离浴霸，否则可能损坏本产品，甚至对使用者造成伤害。</p>	<p>All information is based on the latest product information available at the time of publication. Kohler Co. reserves the right to make changes in product characteristics, packaging, or availability at any time without notice.</p> <p>Please leave these instructions for the consumer. They contain important information.</p> <p>NOTES:</p> <p>1. Flush the water supply pipes thoroughly to remove debris.</p> <p>2. Shut off the water supplies to the fitting.</p> <p>3. Observe all local plumbing and building codes.</p> <p>4. Shower arm holds 1KG maximum.</p> <p>5. The shower head on the shower arm should not exceed Ø10".</p> <p>6. The highest water and environment temperature is 60°C. Please keep shower head and the shower arm away from heater, or it may become damaged and cause injury to the user.</p>
安装尺寸	ROUGH-IN DIMENSIONS

安装说明	INSTALLATION
<p>在G1/2"接管(1, 客户自备)两端螺纹上缠绕足以密封的密封胶带或涂合适的密封膏。安装G1/2"接管, 接管露出墙外9~13mm。</p> <p>打开水源, 冲水约一分钟, 以清除杂质。</p> <p>将装饰罩(2)旋到花洒臂组件(3)上。用带状扳手将花洒臂组件拧到G1/2"接管上, 调整花洒臂到合适位置拧紧。</p>	<p>Apply tape or sealant to the G1/2" nipple(1, not provided) threads. Install the G1/2" nipple and make it extend 9~13mm beyond the finished wall.</p> <p>Flush water supplies through the shower arm for about one minute to remove debris.</p> <p>Screw the escutcheon(2) onto the shower arm kit(3). Thread the shower arm kit to the G1/2" nipple. Adjust the shower arm to the appropriate position, tighten it by strap wrench.</p>
<p>使用一段时间后, 如发现花洒臂有自降的倾向, 可以通过旋紧螺母(5)来紧固。方法如下: 用手把压盖(4)取下, 用产品中配带的扳手(6)顺时针紧固螺母(5)。然后再把压盖装好。</p>	<p>If found the arm dropped after a long time, you can tighten it by the screws (5). Remove the plugs(4) by hand. Tighten the screws(5) clockwise by the wrench(6) provided. Reinstall the plugs.</p>
安装结果检查	INSTALLATION CHECKOUT
<p>检查并确保所有衔接处都已拧紧。打开主水源, 检查并修理有漏水的接口。</p>	<p>Ensure that all coupling nuts are tight. Turn on the main water supply, and check for leaks. Repair as need.</p>
清洗说明	CLEANING INSTRUCTIONS
<p>适用于所有加工处理过的表面: 以中性肥皂水清洗镀层表面, 再以干净的软布彻底擦干整个表面, 许多清洁剂, 比如氨水、去污粉及洁厕灵等, 会对电镀表面造成伤害, 切忌使用。</p> <p>有磨损性的清洁用具或清洁剂也不可使用于科勒牌的水龙头及其配件上。</p>	<p>All Finishes: Clean the finish with a mild soap and warm water. Wipe entire surface completely dry with clean soft cloth. Many cleaners may contain chemicals, such as ammonia, chlorine, toilet cleaner etc. which could adversely affect the finish and are not recommended for cleaning.</p> <p>Do not use abrasive cleaners or solvents on Kohler faucets and fittings.</p>

KOHLER®

SERVICE PARTS

零件图

360°随心转

FLIPSIDE

Articulating Shower Arm

15704T 花洒臂

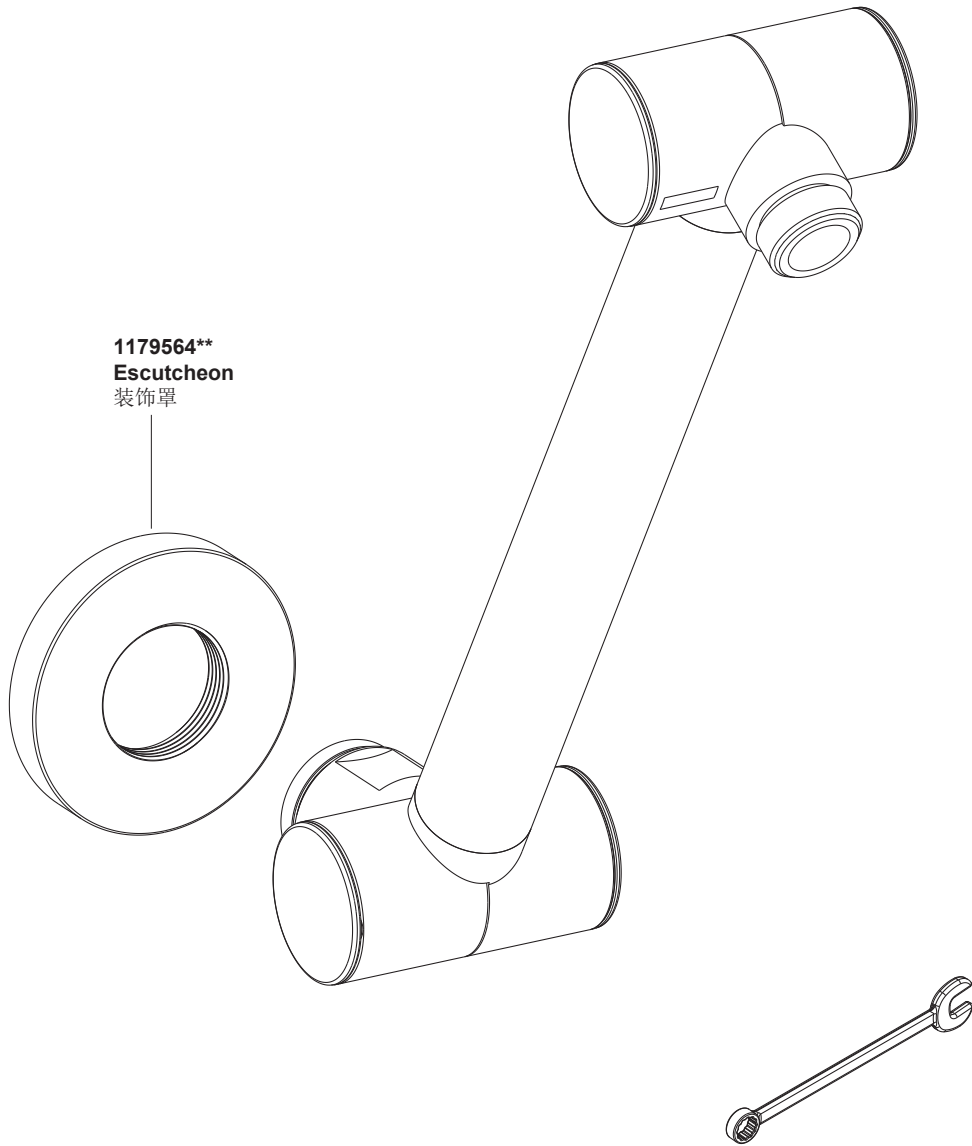

**订购时请说明颜色编号
**Color code must be specified when ordering