

15596T 多功能手持花洒及滑动花洒支架和软管

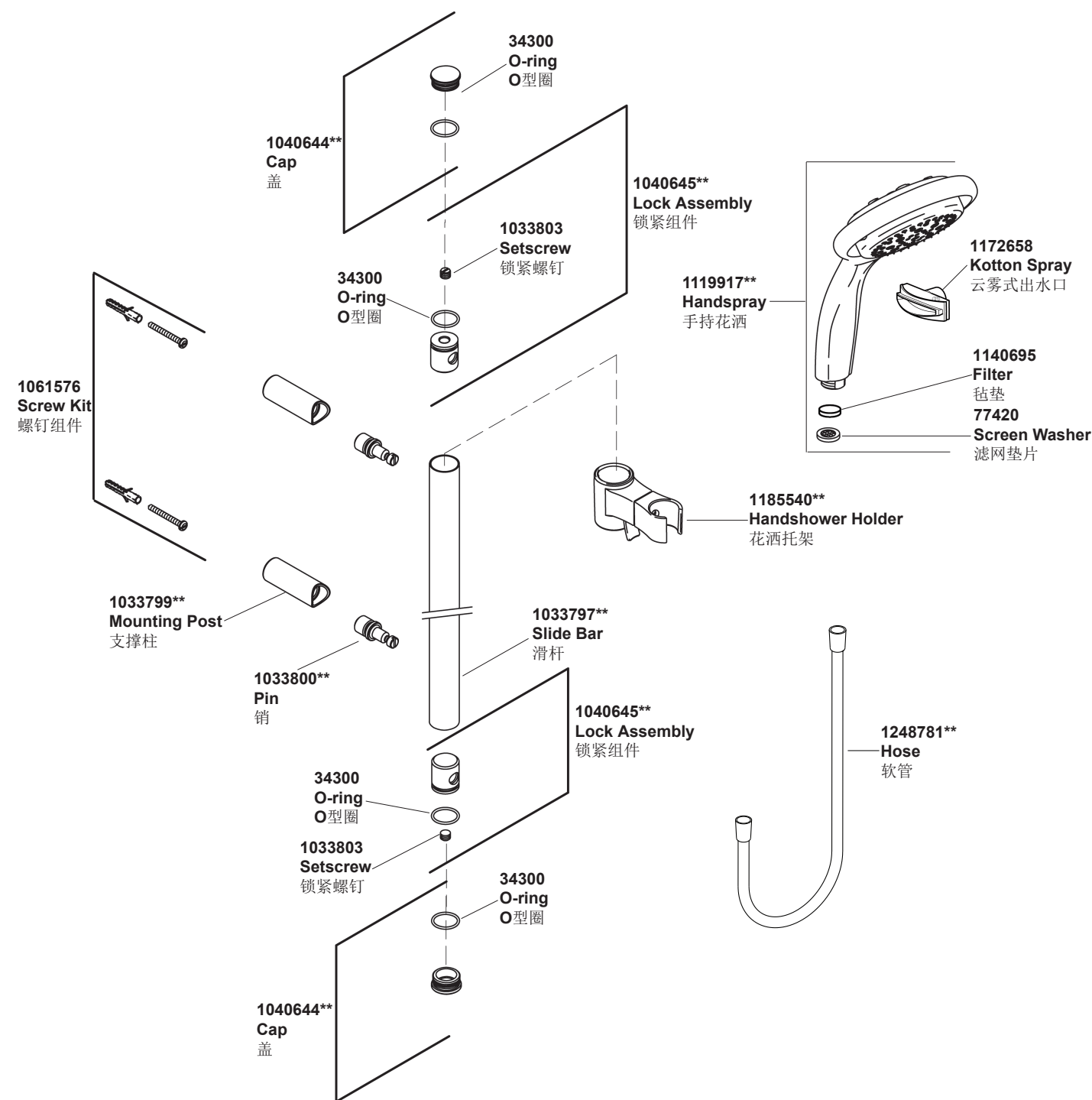

**订购时请说明颜色编号
**Color code must be specified when ordering

15596T 多功能手持花洒及滑动花洒支架和软管

安装之前

所有的资料是按最新出版的产品资料编写而成。科勒公司保留任何时候不经通知即可改变产品特性、包装或产品可供类型的权利。

说明书包括重要的安装、保养及清洁方面的内容，请把这些资料交给用户阅读。

注意事项：

- 1.一定要先彻底冲洗供水管以清除管道中的杂质。
- 2.花洒最高工作压力：0.5MPa(5bar)。水压超过0.5MPa(5bar)须安装减压阀。花洒最高工作温度及环境温度：60°C。请特别注意花洒同花洒连接的臂管须远离浴霸，否则可能损坏花洒及其密封件，甚至对使用者造成伤害。
- 3.手持花洒限流器不可以取出，否则将损坏花洒。

BEFORE YOU BEGIN

All information is based on the latest product information available at the time of publication. Kohler Co. reserves the right to make changes in product characteristics, packaging, or availability at any time without notice. Please leave these instructions for the consumer. They contain important information.

NOTES:

1. Flush the water supply pipes thoroughly to remove debris.
2. The highest working pressure for handspray is 0.5MPa(5 bar). If it exceeds 0.5MPa(5 bar), a pressure reducer is needed. The highest water and environment temperature is 60°C. Please keep handspray, shower head and the shower arm away from heater, or it may become damaged and cause injury to the user.
3. Don't remove the regulator, or will damage the handspray.

安装尺寸

ROUGH-IN DIMENSIONS

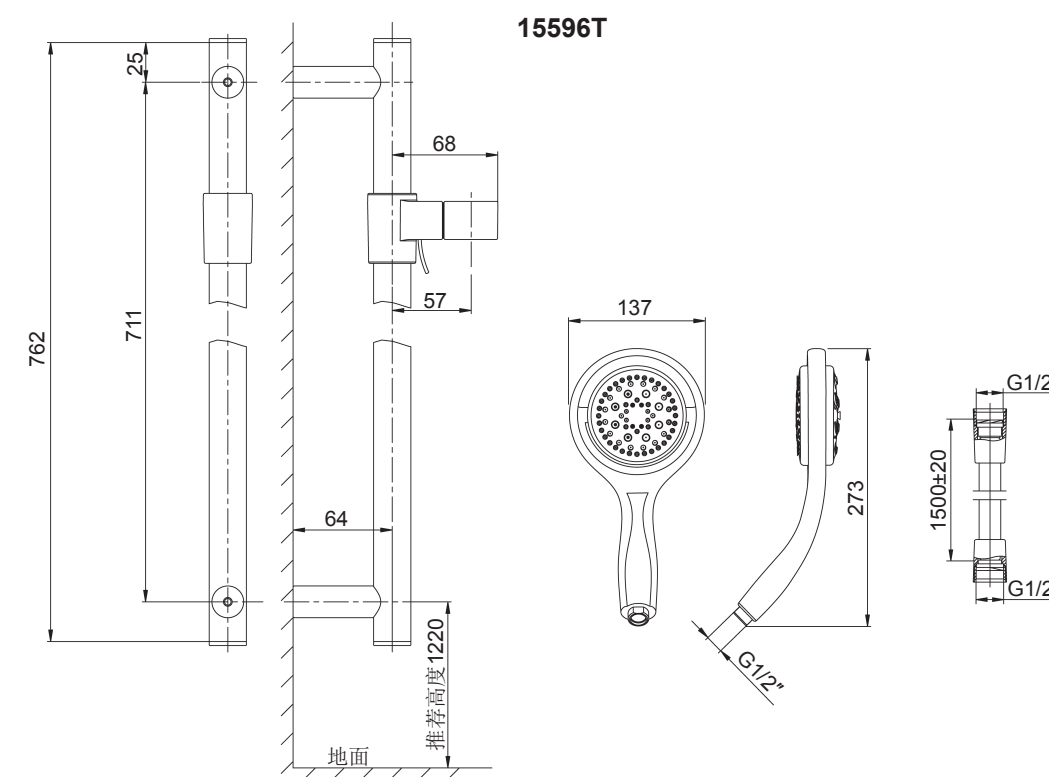

安装步骤

如何安装滑动花洒支架

根据安装尺寸和胀塞(1)直径在墙面适当高度钻两个孔，距离711mm。将胀塞分别塞入孔中，用自攻螺钉(3)安装支撑柱(2)。将滑杆(4)靠在支撑柱上，调整支撑柱使弧形缺口紧贴滑杆。拿走滑杆，锁紧螺钉固定支撑柱。

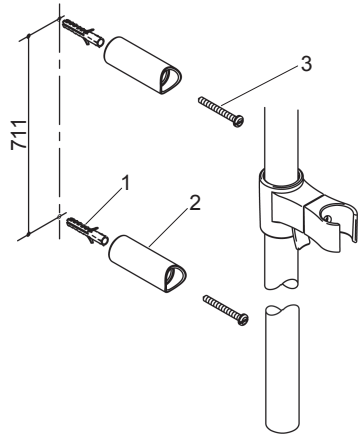

将销(8)旋入支撑柱，用一字螺丝刀锁紧。

将锁紧组件(5)的孔与滑杆(4)的孔对齐装入。如需要，用螺丝刀调节滑杆两端锁紧件的位置。

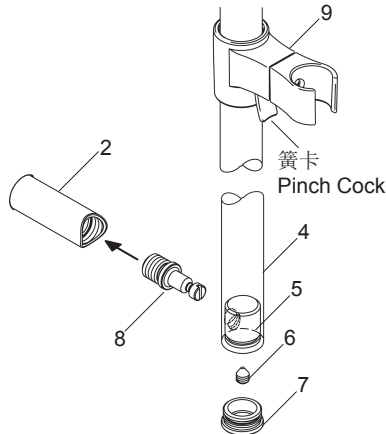

将销与锁紧组件及滑杆的孔对齐。轻轻推滑杆，将销插入滑杆以及锁紧组件，直到滑杆与支撑柱贴紧。锁紧锁紧组件上的紧定螺钉(6)的固定滑杆。

注意：花洒托架(9)锥孔大端朝上。

将盖(7)扣到滑杆两端。

按住花洒托架的簧片上下滑动，可调节托架位置。

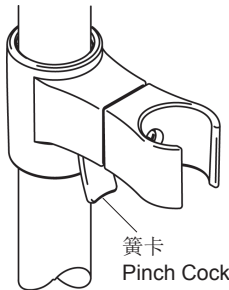

如何安装手持花洒

手持花洒(10)的限流器不可取出。将毡垫(11)放入手持花洒内，将手持花洒旋紧到软管(12)上，软管另一端连接水源。

把花洒挂在花洒托架(9)上。

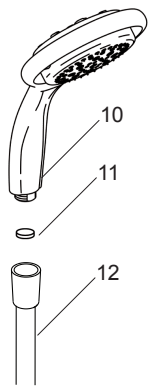

INSTALLATION

How to Install the Slide Bar

Drill holes according to the rough-in dimensions and diameter of the anchors(1) at the proper position on the finished wall, distance 711mm. Press the anchors into the holes. Connect the mounting posts(2) by the self-tapping screws(3). Hold the slide bar(4) up against the posts. Adjust the posts until the slide bar fits snug against the curved cutout of the posts. Take away the slide bar. Tighten the screws to secure the posts.

Thread the pins(8) into the mounting posts. Tighten with a flat-blade screwdriver.

Line up the holes in the lock assemblies(5) with the holes in the slide bar(4). If needed, use a screwdriver to adjust the position of the locks at each end of the slide bar.

Align the pins with the holes in the slide bar and lock assemblies. Gently press the slide bar against the posts, inserting the pins, until the slide bar fits snug against the posts. Secure the slide bar by tightening the setscrew(6) of lock assemblies.

NOTE: The large side of inner taper for handshower holder(9) faces up.

Press the caps(7) onto each end of the slide bar.

The height of handshower holder can be adjusted by pressing the pinch cock and sliding up and down.

How to Install the Handspray

Don't remove the regulator of handspray(10). Put the filter(11) into the handspray, screw the handspray to the shower hose(12). Connect another end of shower hose to the water supply.

Hang the handspray on the handspray holder(9).

操作说明

旋转手持花洒头部可以获得不同水流方式，见右图。

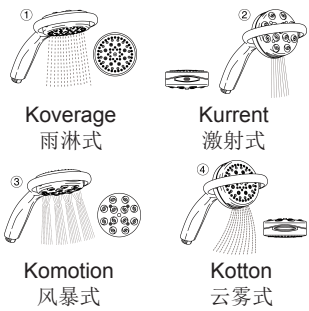

OPERATION INSTRUCTION

Rotate the head of the handspray to change the spray patterns as shown.

如何清除喷孔水垢，杂质

喷孔杂质或结垢会导致水流变形，流量变小。打开水源，用力按压或摩擦橡胶喷孔，去除杂质或水垢。

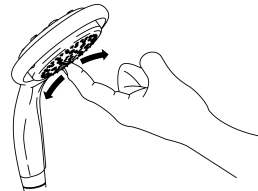

How to Clean the Nozzles

The debris or mineral build-up may cause the flow stream to become distorted or reduce the flowrate. To remove the debris or mineral build-up, run water through the handspray, firmly press or rub your finger back and forth across the rubber nozzles.

如何清洗滤网垫片

拆下手持花洒(10)。先将滤网垫片(13)和毡垫(11)从手持花洒中依次取出。用热醋清洗滤网垫片上的滤网，清洗滤网垫片和毡垫。重新将毡垫和滤网垫片装入手持花洒。重新装回手持花洒。

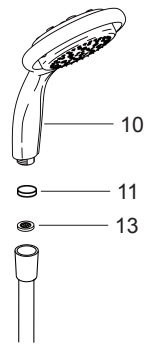

如何清洗云雾式出水口

用带尖工具把白色塞扣拨下。

用2.5mm六角扳手(客户自备)把四个螺钉拆下。

将上下盖拆下后，即可拆下云雾式出水口。用白醋浸泡30分钟后即可清除污垢。

注意：确保O型圈的位置正确。

按顺序装回所有零件。

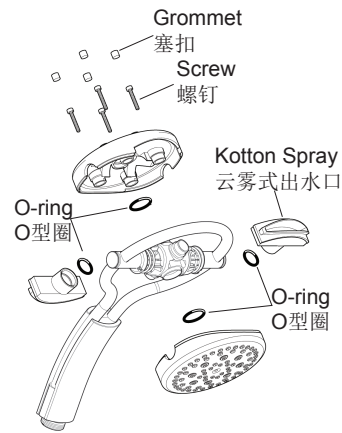

How to Clean the Screen Washer

Remove the handspray(10). Take out the screen washer(13) and the filter(11) from the handspray. Clean the filters of the screen washer by soaking them in warm vinegar. Clean the screen washer and filter. Reinstall the filter and screen washer into the handspray. Reinstall the handspray.

How to Clean the Kotton Spray

Use a suitable tool to remove the four grommets.

Using the 2.5mm hexagon wrench(not supplied), remove the four screws.

Separate the sprayplate assembly into its individual components.

Clean the kotton spray by soaking them in warm vinegar for 30 minutes.

NOTE: Make sure that the o-rings are located correctly.

Reassemble the components in reverse order.

清理说明

适用于所有加工处理过的表面：以中性肥皂水清洗镀层表面，再以干净的软布彻底擦干整个表面，许多清洁剂，比如氨水、去污粉及洁厕灵等，会对电镀表面造成伤害，切忌使用。

有磨损性的清洁用具或清洁剂也不可使用于科勒牌的水龙头及其配件上。

CLEANING INSTRUCTIONS

All Finishes: Clean the finish with mild soap and warm water. Wipe entire surface completely dry with clean soft cloth. Many cleaners may contain chemicals, such as ammonia, chlorine, toilet cleaner etc. which could adversely affect the finish and are not recommended for cleaning.

Do not use abrasive cleaners or solvents on Kohler faucets and fittings.