

BEFORE YOU BEGIN

HOW TO USE THESE INSTRUCTIONS

Please read these instructions carefully to familiarize yourself with the required tools, materials, and installation sequences. Follow the sections that pertain to your particular installation. This will aid you in avoiding the unnecessary expense associated with improper installation. In addition to proper installation, read all operating and safety instructions.

All information in these instructions is based on the latest product information available at the time of publication. Kohler Co. reserves the right to make changes in product characteristics, packaging, or availability at any time without notice.

These instructions contain important care, cleaning, and warranty information - please leave instructions for the consumer.

NOTES

- Seat post holes on 5-1/2" centers.
- Water depth from rim is 6-3/4".
- 1-3/4" passageway.
- Ensure that the new toilet has the correct roughing-in dimension. The K-3420 and K-3421 have a 12" roughing-in dimension. **See Fig. #1.**
- Be very careful while working with vitreous china products. Vitreous china can break and chip if you overtighten bolts and nuts or carelessly handle the product.
- Carefully inspect new fixture for any sign of damage.
- Observe all local plumbing and building codes.
- Shut off hot and cold water supplies.
- For new construction, refer to the dimensions in Fig. #1 and Fig. #4 for locating the shut-off valve.
- Fixture dimensions are nominal and conform to tolerances by ANSI Standards (A112.19.2).



WARNING: Risk of external leakage. The fill valve nut has been factory-tightened to design specifications. If re-tightening is required, wrench tighten one turn past finger tight.

ORDERING INFORMATION

Wellworth™ Lite™ Toilet (elongated) K-3420
Wellworth™ Lite™ Toilet (round front) K-3421

Bowl K-4236/K-4237
Tank K-4512

When specified:

3/8" supply K-7638
Floor bolts (pr.) 21401
Recommended elongated seat K-4652
Recommended round front seat K-4662

TOOLS AND MATERIALS REQUIRED

- 10" adjustable wrench
- 12" pipe wrench
- Metal file (file cut)
- Tape measure
- Tubing cutter
- Level
- Hacksaw
- Putty knife
- Screwdriver
- Toilet gasket (wax seal)
- Toilet T-bolts (2), 5/16" diameter
- Toilet supply shut-off valve, 3/8" recommended

(If existing toilet does not have a shut-off valve below the tank, install shut-off valve before installing new toilet. **See Page 3.**)

ROUGHING-IN

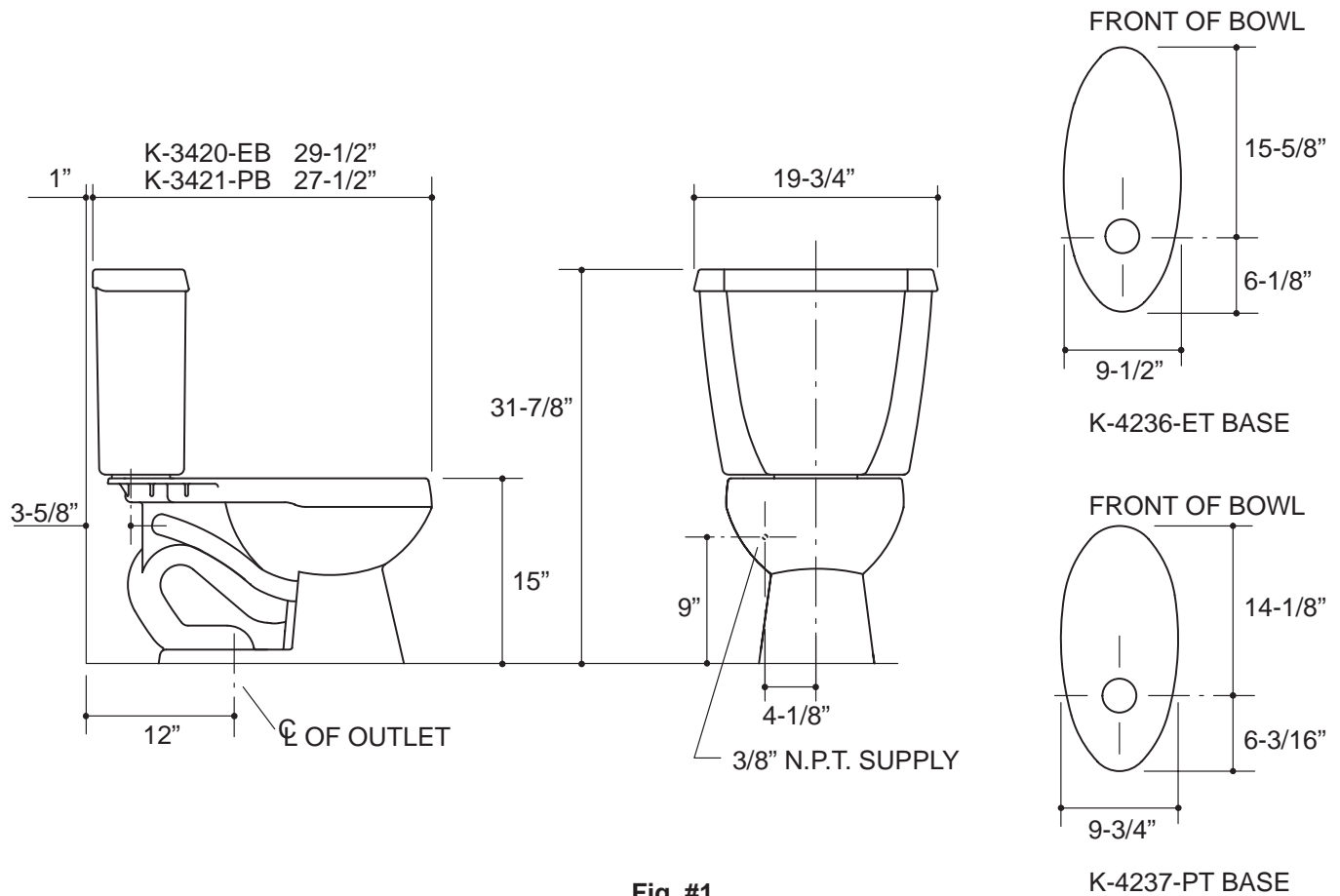

INSTALLATION

TO REMOVE EXISTING TOILET

Turn off water supply. Flush the toilet and sponge out remaining water from tank and bowl. Disconnect supply valve and remove old tank and bowl.

Remove old gasket from the floor and closet flange with a putty knife. Remove old T-bolts and discard.

NOTICE: If a new toilet is not installed immediately, temporarily stuff a rag in the closet flange.

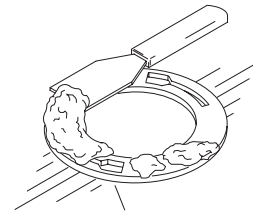

Closet Flange

Fig. #2

Install new 5/16" diameter T-bolts.

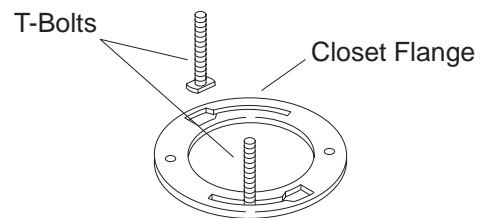

Fig. #3

TO INSTALL NEW SUPPLY SHUT-OFF VALVE

Install toilet supply shut-off valve so it is 9" above floorline and 4-1/8" to the left of the centerline of the closet flange.

Centerline of supply shut-off outlet should extend 4" from finished wall. Install the supply shut-off valve with outlet vertical.

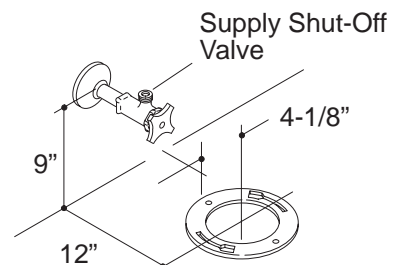

Fig. #4

TO INSTALL NEW TOILET

Place new toilet upside down on padding. Firmly place gasket on toilet outlet.

NOTE: If using gasket with integral plastic sleeve, make sure the gasket is positioned facing away from the toilet.

Remove rag from closet flange before setting toilet.

Carefully align and lower toilet over the closet flange and bolts.

CAUTION: Do not lift or rock toilet after placement; a new gasket must be reapplied if you break the watertight seal.

Apply full body weight to toilet rim to set seal.

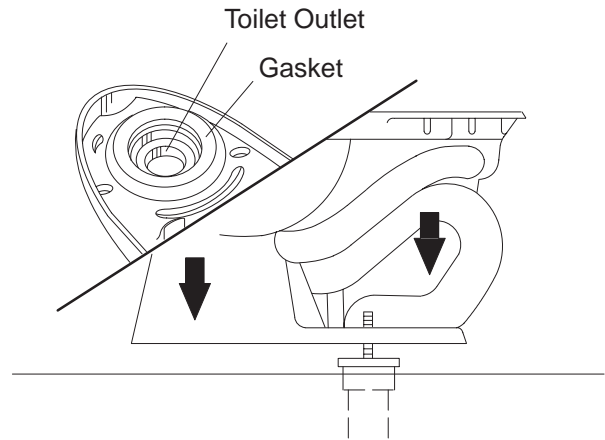

Fig. #5

Assemble bolt cap bases, washers, and nuts on exposed T-bolts. Hand-tighten nuts, then tighten additional 1/2-turn with wrench.

CAUTION: Overtightening may cause breakage or chipping.

If T-bolts extend more than 1/4" from top of nut, cut off excess. Wipe away any residue. Install bolt caps.

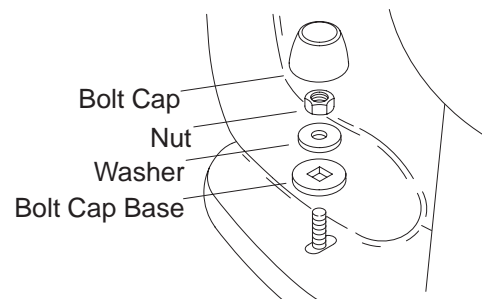

Fig. #6

TO INSTALL NEW TANK

Make sure the three tank bolts extend fully through the holes in the gasket. Set the tank onto the bowl using the bolts as a guide. Center the gasket on the inlet of the bowl. Assemble the washers and brass hex nuts onto the bolts.

CAUTION: Overtightening may cause breakage or chipping.

Alternately tighten the three brass hex nuts so that the top of the tank is level with the top of the bowl and a watertight seal is obtained.

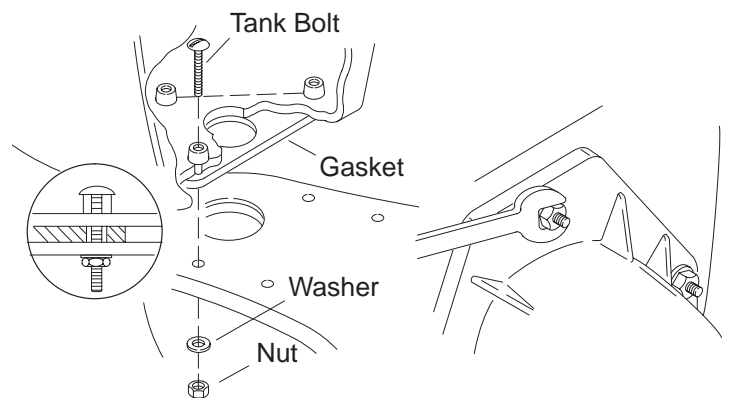

Fig. #7

TO CONNECT WATER SUPPLY

NOTICE: Read carefully before performing this step.

For supply installation, refer to instructions packed with shut-off valve. Carefully bend tubing to fit.

Cut tubing end 1/4" longer than distance between shut-off valve and supply shank. Remove any burrs from inside of tube.

Slip coupling nut, compression nut, and ferrule onto tubing. Insert tubing into shut-off valve and supply shank, positioning seal washer (supplied) or compression washer (not supplied) as shown. Hand-tighten coupling nut and then tighten compression nut.

⚠ WARNING: Risk of external leakage. The fill valve nut has been factory-tightened to design specifications. If re-tightening is required, wrench tighten one turn past finger tight.

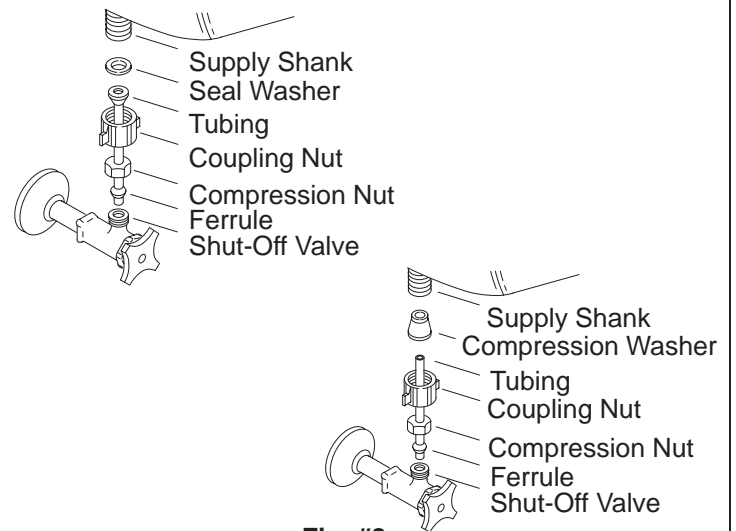

Fig. #8

Turn shut-off valve on and check for leaks. If connections are squarely assembled, a slight retightening of the nuts will stop any leaks.

If toilet is leaking in between the tank and bowl, carefully retighten the three tank bolts evenly. Check all bowl and tank connections for leaks for several days.

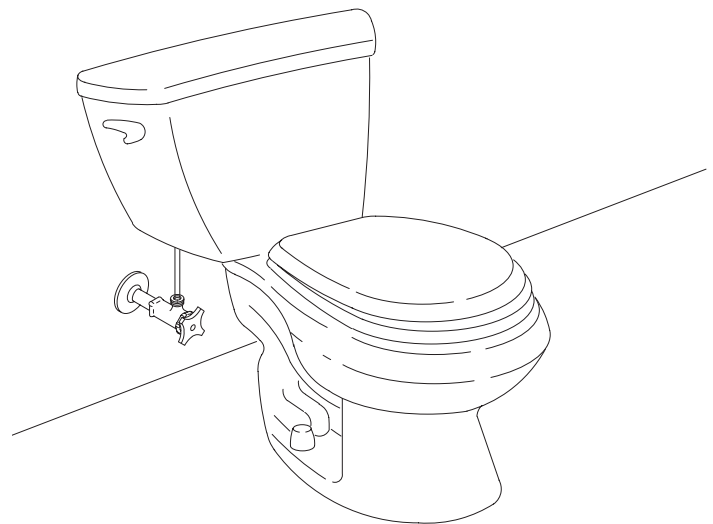

Fig. #9

Hold float under water for a few seconds to fill ballast. Adjust float by sliding it up or down on float rod until water level is at the marked water line on the flush valve overflow.

Check all connections for leaks for several days.

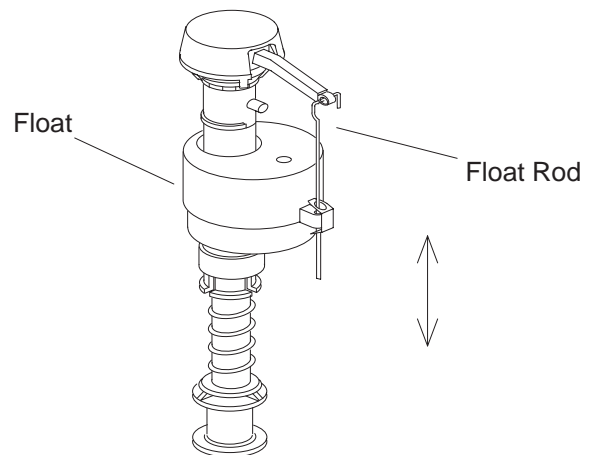

Fig. #10

TROUBLESHOOTING CHART

SYMPTOMS	PROBABLE CAUSES	CORRECTIVE ACTION
1. Float valve turns on/off by itself without toilet being flushed.	<p>A. Refill tube pushed too far down in overflow pipe.</p> <p>B. No slack in flapper chain assembly, holding flapper off seat.</p> <p>C. Flush valve flapper ball worn, dirty or misaligned with flush valve seat; or seat corroded so flapper will not seal.</p>	<p>A. Attach refill tube to overflow pipe above the water line.</p> <p>B. Adjust flapper chain assembly for proper slack.</p> <p>C. Inspect, clean and, if necessary, replace flapper ball and/or seat.</p>
2. Float valve continues to run, allowing water to enter tank.	<p>A. Foreign particles lodged under the float valve seal (located under float valve cap).</p> <p>B. Float valve seal (located under float valve cap) may be cracked or split.</p>	<p>A. Shut off water supply; remove float valve cap assembly by rotating 1/8 turn counterclockwise. Cover uncapped lower valve unit with an inverted cup (holding it to prevent overspray), and turn water on and off a few times. Clean float valve seal surface (located under float valve cap). Replace float valve cap assembly by engaging lugs and rotating 1/8 turn clockwise. Turn water on. Install filter in supply line to prevent recurring problems.</p> <p>B. Replace seal.</p>
3. Incorrect water level height.	<p>A. Valve float cup does not contain enough water to provide required ballast.</p>	<p>A. During fill cycle, hold float under water a few seconds to allow it to fill with water ballast. See Page 5.</p>
4. Long or noisy tank fill cycle.	<p>A. Plugged valve inlet or supply line.</p>	<p>A. Perform Corrective Action 2.A.</p>
5. Poor flush.	<p>A. Trapway or rim holes are obstructed.</p> <p>B. Soil pipe or vent is obstructed.</p> <p>C. Low water level in bowl due to refill tube being plugged or out of overflow tube.</p> <p>D. Supply shut-off valve not fully open.</p>	<p>A. Unclog trapway; clean rim holes.</p> <p>B. Clear obstruction from soil pipe or vent.</p> <p>C. Clean or straighten refill tube; attach refill tube to overflow tube.</p> <p>D. Open supply shut-off valve.</p>
6. Toilet overflows.	<p>A. Toilet trapway is obstructed.</p> <p>B. Soil pipe or vent is obstructed.</p>	<p>A. Use plunger to unclog.</p> <p>B. Clear obstruction from soil pipe or vent pipe.</p>
7. Toilet does not activate.	<p>A. Chain is not connected to lift rod or flush valve.</p>	<p>A. Reconnect the chain.</p>

IMPORTANT CONSUMER INFORMATION

CONSUMER RESPONSIBILITIES

If you live in a hard water area, you should make certain that the holes in the rim are kept clean for proper bowl flushing. Toilet bowl cleaners should be used at least once a week. Use a long-handled brush to clean the rim holes and to clean as far into the trap as possible to prevent mineral deposits from forming.

Most toilet bowl cleansers are not harmful to the vitreous china surface of the toilet bowl. Please follow the bowl cleanser manufacturer's instructions carefully.

Do not use abrasive cleaners or solvents.



WARNING: Do not use in-tank cleansers. Products containing chlorine (calcium hypochlorite) can seriously damage fittings in the tank. This damage can cause leakage and property damage.

Kohler Company shall not be responsible or liable for any damage to these tank fittings caused by the use of cleansers containing chlorine (calcium hypochlorite).

REQUESTING SERVICE

Please take a moment to familiarize yourself with the Kohler Warranty, its benefits, and limitations. Kohler Co. and its distributors support you with one of the largest Service Networks of its type. Here's what you need to do if you require service:

FIRST: Contact the dealer or contractor who sold and installed the product. They should be able to solve any problems you may have.

SECOND: If your dealer or contractor cannot solve the problem, they will contact or supply you with the name of the local Kohler Distributor and the:

 KOHLER TECHNICAL SPECIALIST

THIRD: If you are unable to obtain warranty service through either your contractor or Kohler Co. distributor, please write us directly at Kohler Co., Attn: Customer Service Department, 444 Highland Drive, Kohler, WI 53044 U.S.A.

FOURTH: Include all pertinent information regarding your claim, including a complete description of the product, model numbers, colors, finishes, and the date the product was installed. Include a description of the problem, and a photocopy of your invoice for the products involved. Also give us the name of the contractor and distributor.

LIMITED ONE-YEAR WARRANTY

Kohler plumbing fixtures and fittings are warranted free of manufacturing defects.

Kohler Co. will, at its election repair, replace, or make appropriate adjustment where Kohler Co. inspection discloses any such defects occurring in normal usage within one year after installation. Kohler Co. is not responsible for installation costs.

To obtain warranty service, contact Kohler Co. either through your Dealer or Plumbing Contractor or by writing Kohler Co., Attn: Customer Service Department, 444 Highland Drive, Kohler, WI 53044 U.S.A., or by calling **1-800-4-KOHLER** from within the U.S.A.

Implied warranties, including that of merchantability and fitness for a particular purpose, are expressly limited in duration to the duration of this warranty. To the extent permitted by law, Kohler Co. disclaims all implied warranties including merchantability and fitness for a particular purpose. Kohler Co. disclaims any liability for special, incidental, or consequential damages.

Some states do not allow limitations on how long an implied warranty lasts or the exclusion or limitation of incidental or consequential damages, so this limitation and exclusion may not apply to you. This warranty gives you specific legal rights. You may also have rights which vary from state to state.

This is our exclusive written warranty.

KOHLER CO., KOHLER, WISCONSIN 53044

