

FEATURES

- 17 gauge brass construction
- Above- or through-the-floor installation options
- Adjustable trip lever pop-up drain
- 2" connection
- Brass tailpiece

CODES/STANDARDS APPLICABLE

Specified model meets or exceeds the following:

- ASME/ANSI A112.18.1M
- IAPMO/UPC

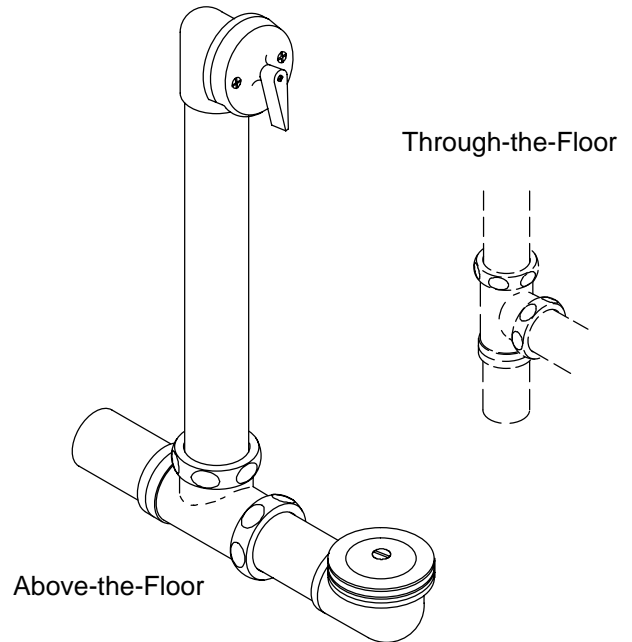

COLORS/FINISHES

- CP Polished Chrome
- PB Polished Brass
- Other Refer to Faucets Price Book for additional finishes

SPECIFIED MODEL:

Model	Description	
K-7150	For Carmont™ Bath	<input type="checkbox"/> CP

PRODUCT SPECIFICATION:

Bath drain shall be of brass construction. Drain shall include an adjustable trip lever pop-up drain with 2" connection and brass tailpiece. Drain shall feature above- or through-the-floor installation options. K-7150 is intended for Carmont installations. Drain shall be Kohler Model K-_____.

CLEARPASS

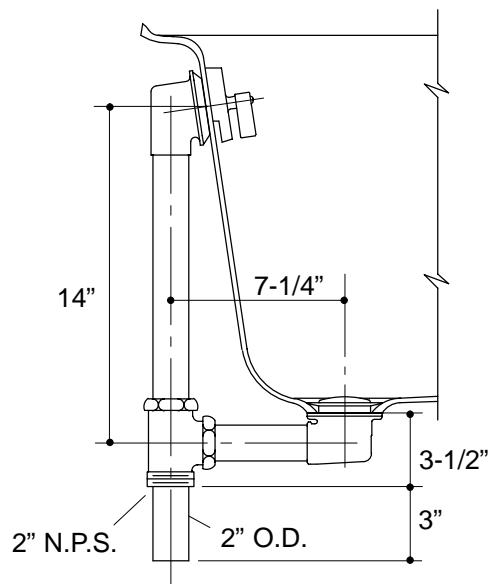

K-7150

PRODUCT DIAGRAM