

37398T-4 挂墙式浴缸花洒龙头

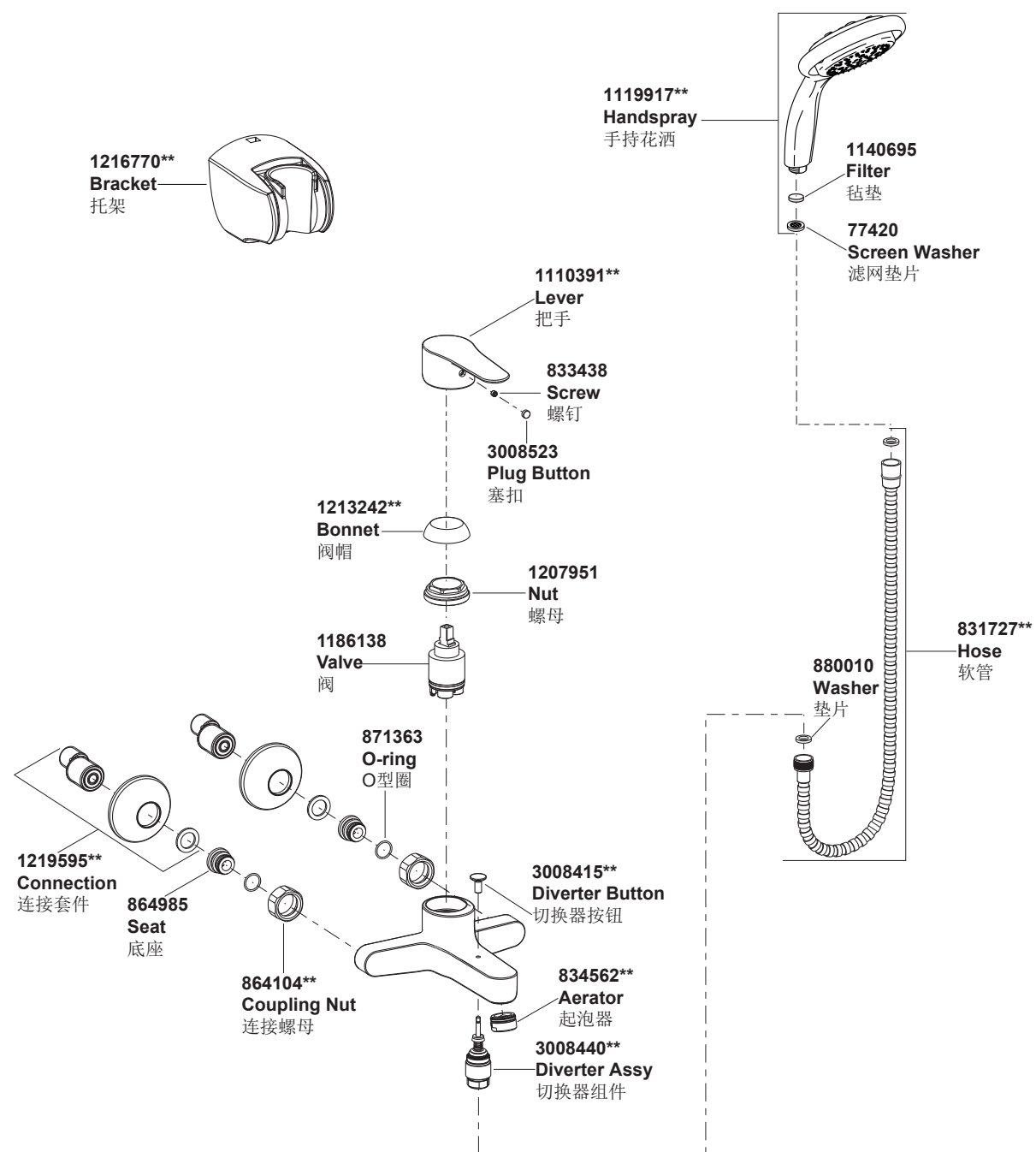

\*\*订购时请说明颜色编号

\*\*Color code must be specified when ordering

37398T-4 挂墙式浴缸花洒龙头

安装之前

所有的资料是按最新出版的产品资料编写而成。科勒公司保留任何时候不经通知即可改变产品特性、包装或产品可供类型的权利。

说明书包括重要的安装、保养及清洁方面的内容，请把这些资料交给用户阅读。

注意事项：

1. 一定要先彻底冲洗供水管以清除管道中的杂质。
2. 切换器正常工作的最小压力为0.05MPa(0.5bar)。
3. 花洒最高工作压力：0.5MPa(5bar)。水压超过0.5MPa(5bar)须安装减压阀。花洒最高工作温度及环境温度：60°C。请特别注意花洒同花洒连接的臂管须远离浴霸，否则可能损坏花洒及其密封件，甚至对使用者造成伤害。
4. 手持花洒限流器不能取出，否则可能损坏花洒。

BEFORE YOU BEGIN

All information is based on the latest product information available at the time of publication. Kohler Co. reserves the right to make changes in product characteristics, packaging, or availability at any time without notice. Please leave these instructions for the consumer. They contain important information.

NOTES:

1. Flush the water supply pipes thoroughly to remove debris.
2. The minimum inlet water pressure for the diverter is 0.05MPa(0.5bar).
3. The highest working pressure for handspray is 0.5MPa(5bar). If it exceeds 0.5MPa(5bar), a pressure reducer is needed. The highest water and environment temperature is 60°C. Please keep handspray, shower head and the shower arm away from heater, or it may become damaged and cause injury to the user.
4. Don't remove the regulator, or maybe damage the handspray.

安装尺寸

ROUGH-IN DIMENSIONS

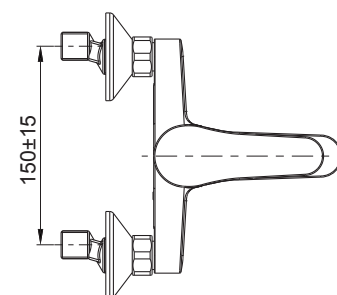
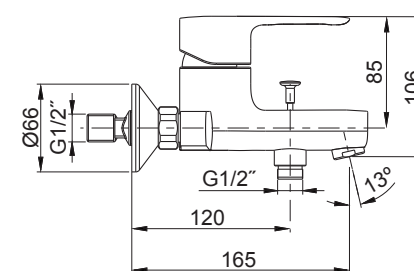

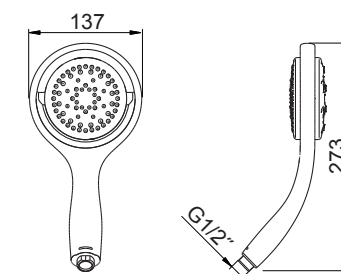
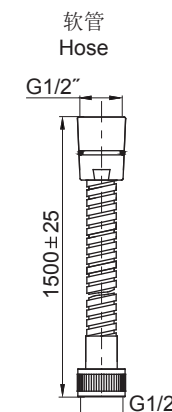

37398T-4

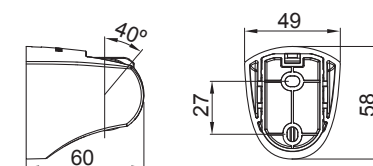

手持花洒  
Handspray

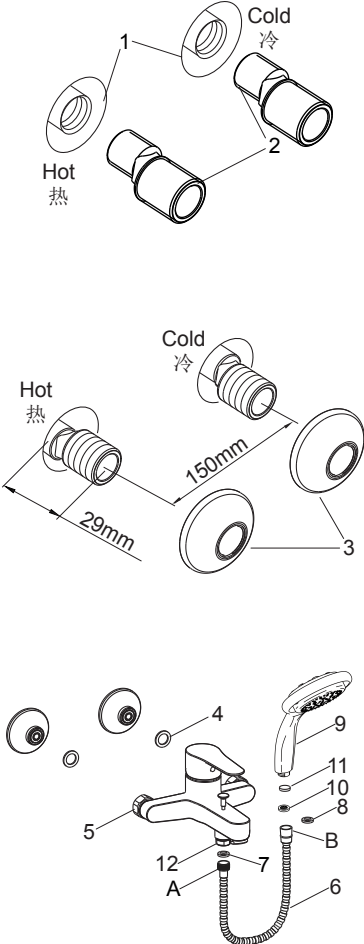
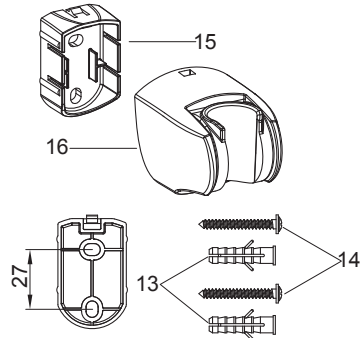

托架  
Bracket

<div>安装步骤</div> <div>如何安装水龙头</div> <p>为使安装顺利，G1/2”内螺纹管道配件(1)应已安装好。预留150mm的间距，并保持水平。管道配件要垂直并不能凸出装修好的墙面。热供水管装在左边。</p> <p>在两个接头(2)涂上螺纹密封胶或缠绕足以密封的密封胶带，旋入冷热水管中。</p> <p>调节两个接头，使其中心距离为150mm并保持同一水平，凸出墙面29mm。将装饰盖(3)旋入接头，紧贴墙壁。</p> <p>将垫片(4)放入水龙头螺母(5)，将螺母旋到接头上。用带状扳手或用软布垫在普通扳手和螺母之间，锁紧螺母。</p> <p>将软管(6)上的一个滤网垫片(7)装入软管的A端，另一个滤网垫片(8)备用。将手持花洒(9)的滤网垫片(10)装入软管(6)的B端，毡垫(11)装入手持花洒。然后将A端与出水口(12)连接，B端与手持花洒进水口连接。</p> <div></div>	
<div>INSTALLATION</div> <div>How To Install The Faucet</div> <p>To perform installation, installer must provide G1/2” female supply fittings(1), spaced 150mm apart and horizontally. The supply fittings should be vertical and not beyond the finished wall. Hot supply pipe must be located on the left.</p> <p>Install the two offset connectors(2) into the hot and cold supply pipes. Use appropriate thread sealants or thread tape on pipe threads.</p> <p>Adjust the center-to-center distance between the connectors to 150mm and horizontally. They should extend 29mm beyond the finished wall. Thread the escutcheons(3) onto the connectors until they are against the finished wall.</p> <p>Put the washers(4) into the nuts(5), thread the nuts to connectors. Tighten the nuts with strap wrench or soft cloth between product and regular wrench.</p> <p>Put one screen washer(7) of the hose(6) into end A, and the other is a reserve screen washer(8). Put the screen washer(10) of the handspray(9) into end B of the hose(6) and put the filter(11) into the handspray. Then end A connect to the faucet outlet(12), end B connect to the handspray inlet.</p>	
<div>如何安装托架</div> <p>在墙面选一合适的位置来安装托架。根据孔距在墙面标记钻孔的位置，依据胀塞(13)直径打孔，安装胀塞。</p> <p>旋紧螺钉(14)使底座(15，平面朝上)固定紧贴墙壁。将托架(16)扣在底座上，使凸台嵌入豁口。</p> <div></div>	
<div>How To Install The Bracket</div> <p>Determine a suitable location on the finished wall to install the bracket. Mark bracket base mounting hole locations on the wall according to the dimension. Drill two holes on the finished wall, the holes should match the anchors(13). Install the anchors.</p> <p>Tighten screws(14) to secure bracket base(15, flat side upward). Put the bracket(16) onto the bracket base and lock by stopper.</p>	
<div>使用说明</div> <p>将手柄轻轻提起，顺时针旋转为热水，逆时针旋转为冷水，浴缸出水口出水；将切换器轻轻提起，顺时针旋转切换器，花洒出水；关闭龙头，逆时针旋转切换器到停止位置。</p> <p>旋转手持花洒头部，如图所示可获得不同水流方式。</p> <div></div>	
<div>OPERATING INSTRUCTION</div> <p>Lift the handle gently, turn clockwise for hot water, counter-clockwise for cold water, bath spout works; lift the diverter gently, turn clockwise for shower; shut off the faucet, turn counter-clockwise until it stops.</p> <p>Rotate the head of the handspray to change the spray patterns as shown.</p>	

<div>如何清洗喷孔水垢，杂质</div> <p>喷孔结垢或堵塞会导致水流变形，流量变小。打开水源，用力按压或摩擦橡胶喷孔，去除水垢或杂质。</p> <div></div>	
<div>如何清洗滤网垫片</div> <p>拆下手持花洒(9)。将滤网垫片(10)和毡垫(11)从手持花洒中依次取出。用热醋清洗滤网垫片上的滤网。清洗滤网垫片和毡垫。重新将毡垫和滤网垫片装入手持花洒。重新装回手持花洒。</p> <div></div>	
<div>How To Clean the Nozzles</div> <p>The furriness or debris may cause the flow stream to become distorted or reduce the flowrate. To clean up the furriness or debris, run water through the handspray, firmly press or rub your finger back and forth across the rubber nozzles.</p> <div>How To Clean the Screen Washer</div> <p>Remove the handspray(9). Take out the screen washer(10) and the filter(11) from the handspray. Clean the filters of the screen washer by soaking them in warm vinegar. Clean the screen washer and filter. Reinstall the filter and screen washer into the handspray. Reinstall the handspray.</p> <div>How To Clean the Kotton Spray</div> <p>Use a suitable tool to remove the four grommets. Using the 2.5mm hexagon wrench(not supplied), remove the four screws. Separate the sprayplate assembly into its individual components.</p> <p>Clean the kotton spray by soaking them in warm vinegar for 30 minutes.</p> <p><b>NOTE:</b> Make sure that the o-rings are located correctly.</p> <p>Reassemble the components in reverse order.</p>	
<div>如何清洗云雾式出水口</div> <p>用带尖工具把白色塞扣拨下。用2.5mm六角扳手(客户自备)把四个螺钉拆下。将上下盖拆下后，即可拆下云雾式出水口。</p> <p>用白醋浸泡30分钟后即可清除污垢。</p> <p><b>注意：</b> 确保O型圈的位置正确。</p> <p>按顺序装回所有零件。</p>	
<div>安装结果检查</div> <p>检查并确保所有的衔接处都已拧紧，确保手柄在关的位置。</p> <p>打开排水系统和主要供水源，检查并修理有漏水的接口。</p> <p>将起泡器(17)和手持花洒拆下，打开水龙头的冷热水，让水流出约一分钟以清除杂质。检查渗漏，冲洗起泡器，关闭水龙头，重新装回起泡器和手持花洒。</p> <div></div>	
<div>INSTALLATION CHECKOUT</div> <p>Ensure that all connections are tight. Ensure that the handle is in the off position.</p> <p>Turn on the drain and main water supply, and check for leaks. Repair as needed.</p> <p>Remove the aerator(17) and handspray. Turn on the faucet. Run hot and cold water through the spout for about one minute to remove any debris. Check for leaks. Remove any debris from the aerator. Shut off the faucet. Reinstall the aerator and the handspray.</p>	
<div>清洗说明</div> <p>适用于所有加工处理过的表面：以中性肥皂水清洗镀层表面，再以干净的软布彻底擦干整个表面，许多清洁剂，比如氨水、去污粉及洁厕灵等，会对电镀表面造成伤害，切忌使用。</p> <p>有磨损性的清洁用具或清洁剂也不可使用于科勒牌的水龙头及其配件上。</p>	
<div>CLEANING INSTRUCTIONS</div> <p>All Finishes: Clean the finish with mild soap and warm water. Wipe entire surface completely dry with clean soft cloth. Many cleaners may contain chemicals, such as ammonia, chlorine, toilet cleaner etc. which could adversely affect the finish and are not recommended for cleaning.</p> <p>Do not use abrasive cleaners or solvents on Kohler faucets and fittings.</p>	