

Features

- High-quality metal construction for durability and reliability
- Allows for directed water flow
- Patented K-joint installation ensures consistent trim appearance
- Required rough-in sold separately

Required Products/Accessories

P29513-00 Transfer Valve

or

P29514-00 Transfer Valve, Eco

Recommended Products/Accessories

P32708-JST Thermostatic Trim, Zebra Jasper Cross Handle

P32710-JST 002™ Volume Control Trim, Zebra Jasper

P34135-00 Round Contemporary Showerhead with Arm

P21513-00 Air-Induction Large Contemporary Rain Showerhead

P24843-00 Wand Dual-Function Handshower with Hose



ADA

CSA B651

OBC

Codes/Standards

ASME A112.18.1/CSA B125.1

ADA

ICC/ANSI A117.1

CSA B651

OBC





IAPMO Certification

KALLISTA® Five-Year Limited Warranty

See website for detailed warranty information.

Available Colors/Finishes

Color tiles intended for reference only.

Color	Code	Description
	CP	Polished Chrome
	BL	Matte Black
	BAF	Brushed French Gold
	SN	Polished Nickel
	BN	Brushed Nickel

KALLISTA®

002™ by KALLISTA
002™ Transfer Trim, Zebra Jasper
P32709-JST

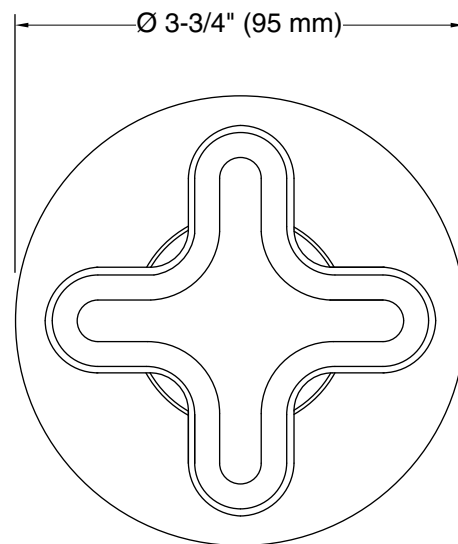
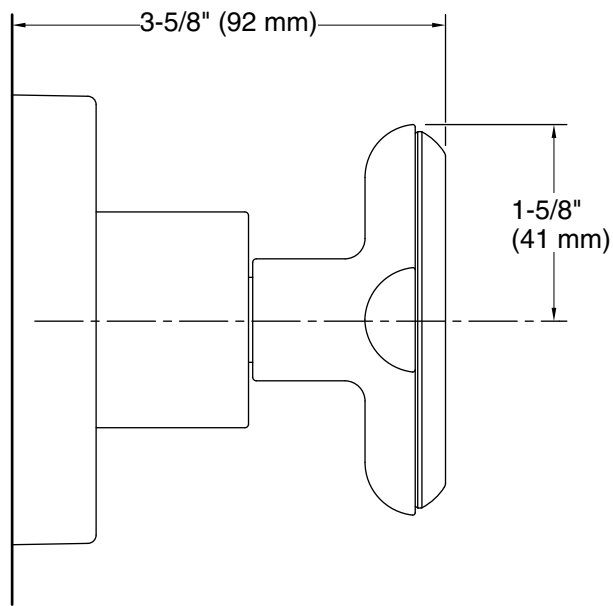

Technical Information

All product dimensions are nominal.

Drain included: No

Notes

Install this product according to the installation guide.

ADA, OBC, CSA B651 compliant when installed to the specific requirements of these regulations.