

SCREW TYPE TERMINALS FOR EXTERNAL POWER CONNECTION			
SWITCH RATING (AMPS)	RANGE OF AL-CU WIRE SIZES		
	CONTACTOR (PER PHASE)	NEUTRAL	GROUND
400	(2) #6-250 KCMIL	(3) #4-600 KCMIL OR (6) 1/0-250 KCMIL	(3) #6-3/0 AWG

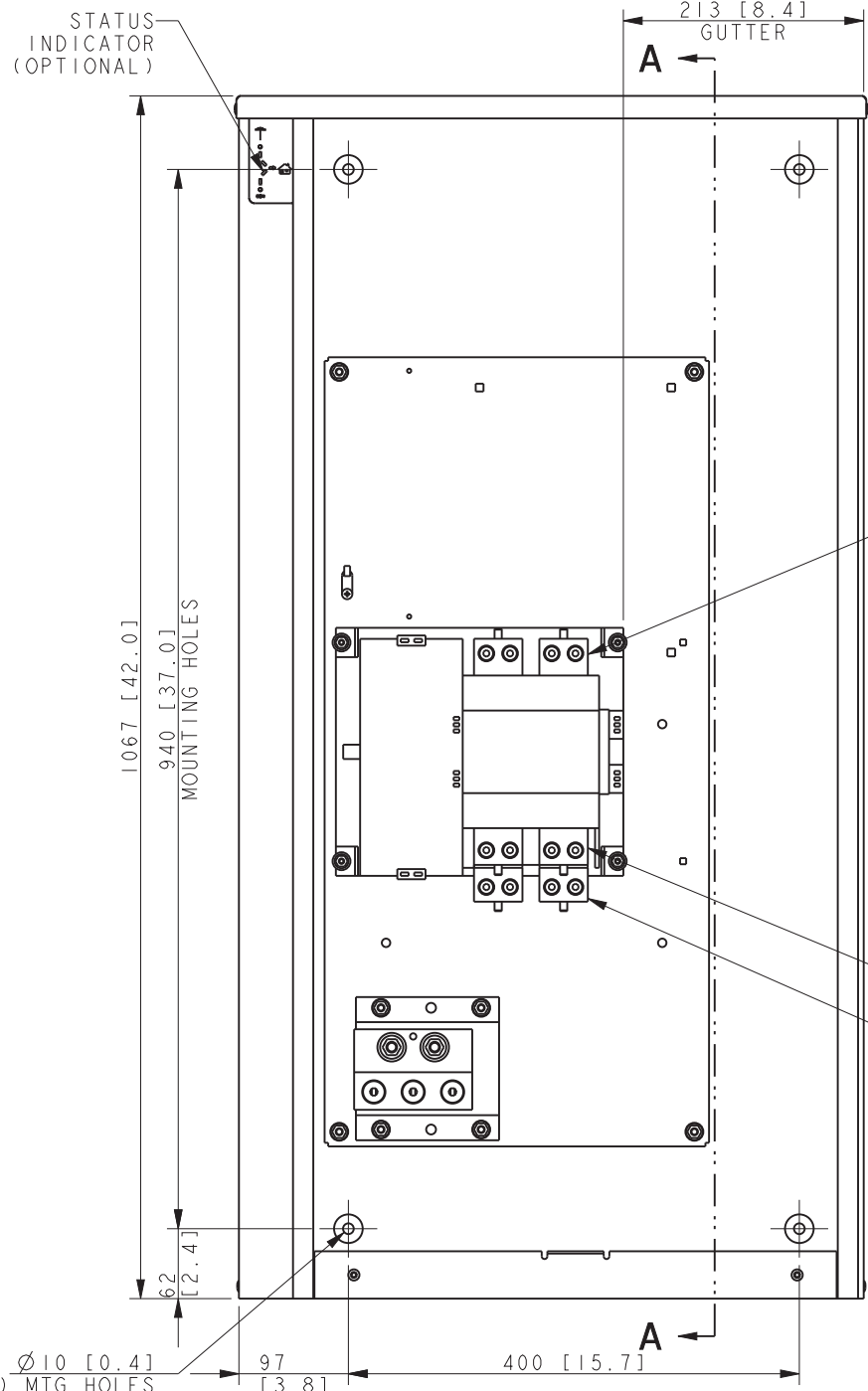

PCB, ATS
INTERFACE
(OPTIONAL
LOAD SHED
BOARD SHOWN)

NORMAL

MANUAL
TRIP
LEVER

EMERGENCY

LOAD

GROUND

NEUTRAL

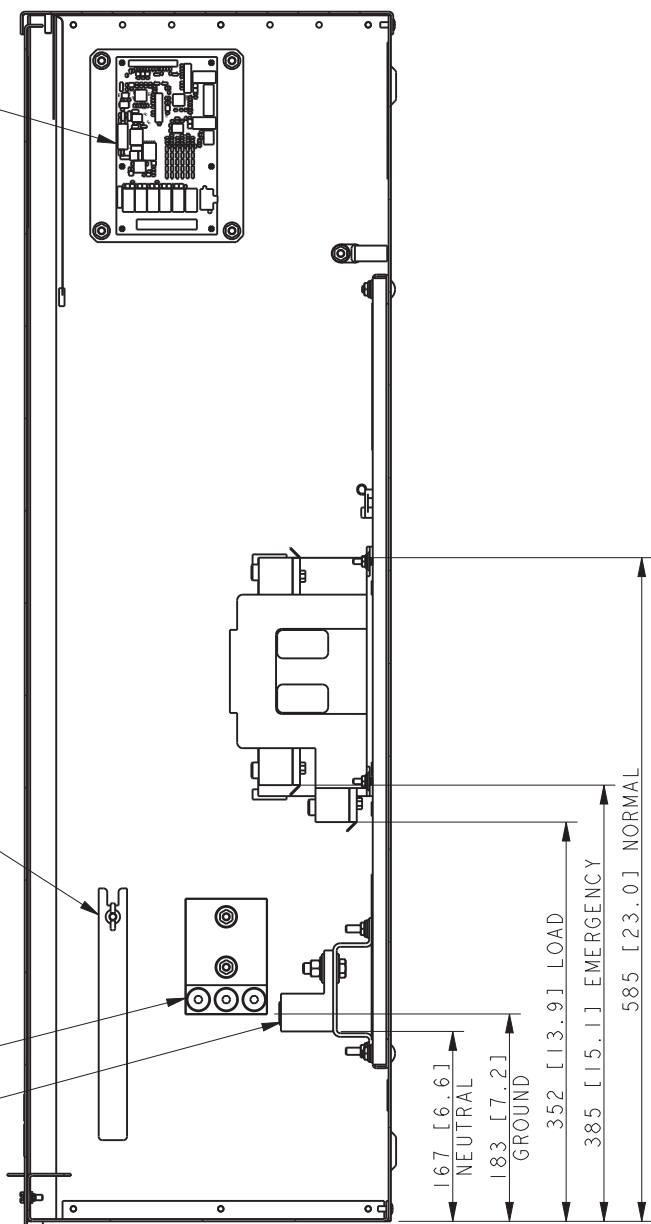

SECTION A-A

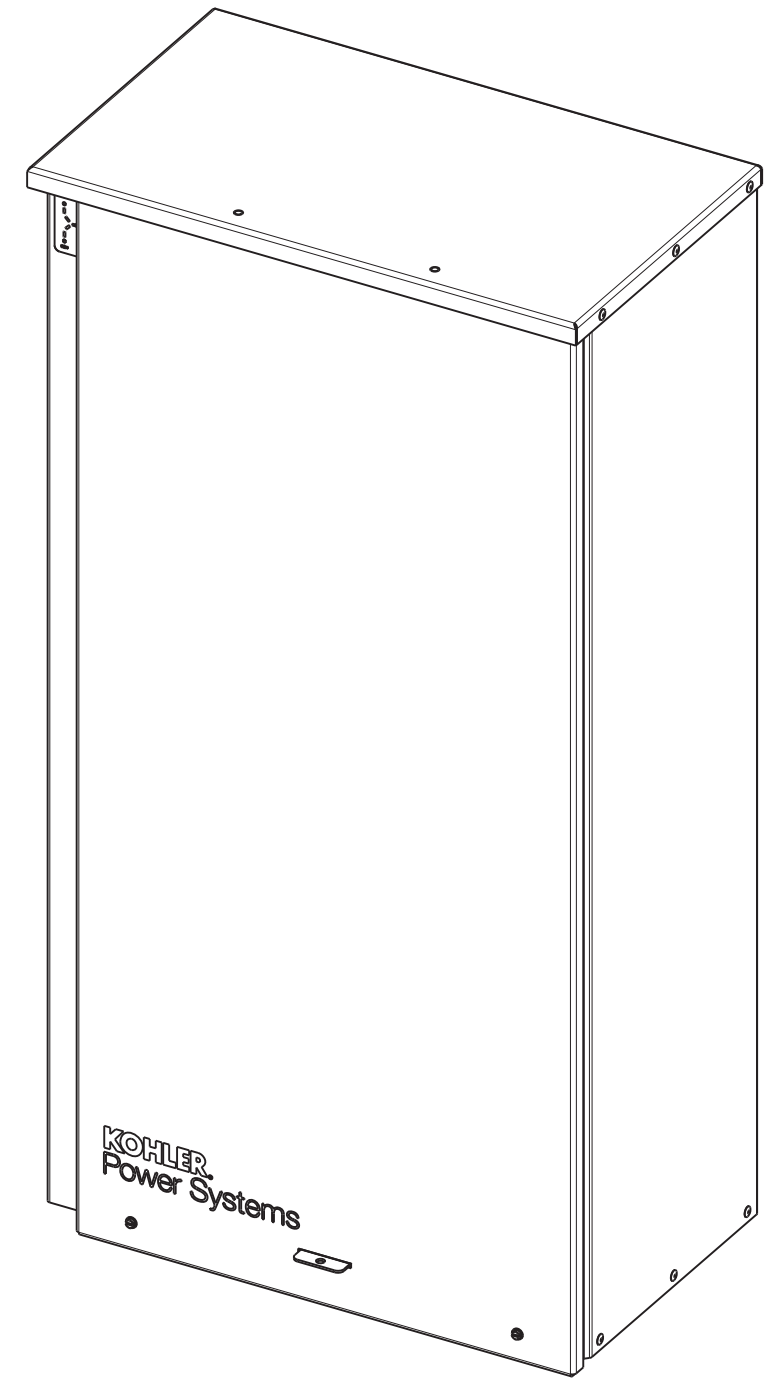

DIMENSION IN [] ARE INCHES.

FINISH: ANSI 49 GRAY

REFER TO OPERATOR'S MANUAL PRIOR TO INSTALLATION AND OPERATION OF UNIT.

APPROXIMATE WEIGHT 55 Kg (120 LBS.)

400A CONTACTOR
(COVER REMOVED TO SHOW DETAIL)

400A
MODEL RXT
TYPE 3R ENCLOSURE

REV	DATE	ON COMPOSITE DWGS. SEE PART NO. FOR REVISION LEVEL	BY
-	4-3-14	NEW DRAWING [CT88602]	BTW

UNLESS OTHERWISE SPECIFIED -
1) DIMENSIONS ARE IN MILLIMETERS
2) TOLERANCES ARE:
X.XX ± 0.25
X.X ± 1.0
X ± 1.5
ANGLES ± 0° 30' MAX.
THIRD ANGLE PROJECTION

APPROVALS	DATE	SURFACE FINISH
DRAWN BTW	4-3-14	MAX.
CHECKED BTW	4-3-14	
APPROVED MTL	4-3-14	

KOHLER CO.	METRIC	PRO-E
POWER SYSTEMS, KOHLER, WI 53044 U.S.A.		
THIS DRAWING IN DESIGN AND DETAIL IS KOHLER CO. PROPERTY AND MUST NOT BE USED EXCEPT IN CONNECTION WITH KOHLER CO. WORK. ALL RIGHTS OF DESIGN OR INVENTION ARE RESERVED.		
TITLE DIMENSION PRINT 400A, SINGLE PHASE		
SCALE 0.30	CAD NO.	SHEET 1 of 1
DWG NO. ADV-8691		D