

CONTACT DETAIL -



IN



Kohler India Corporation Pvt. Ltd.
6th Floor. Office Block, Ambiance Island, NH-8
Gurgaon - 122002, Haryana, India



Customer Care No : 1800 103 2244
(Toll Free) & +91-124-4319685 / 86
Customer Care Email : indiacustomercare@kohler.com
www.kohler.co.in

- | | |
|-----------------------------------|--|
| 37345IN-** - SINGLE ROBE HOOK | 9123IN-** - 24" DOUBLE TOWEL BAR |
| 37346IN-** - DOUBLE ROBE HOOK | 37351IN-** - TOILET TISSUE HOLDER WITH COVER |
| 37347IN-** - 24" TOWEL BAR | 9124IN-** - TOWEL RING |
| 37348IN-** - SOAP DISH | |
| 37350IN-** - TOILET TISSUE HOLDER | |

BEFORE YOU BEGIN

All information is based on the latest product information available at the time of publication. Kohler Co. reserves the right to make changes in product characteristic, packaging or availability at any time without notice. Please leave these instructions for the consumer. They contain important information.

NOTE:

These products should be located and mounted to a wall, While it is possible to mount them to any surface, a stud or concrete. Mounted product will yield the best results.

DANGER: (Risk of personal injury)

These products are not designed or intended for use as a grab bar or support bar. Do not install any of these products in any area where they are likely to be used inadvertently as a grab bar or support bar.

ROUGH-IN DIMENSIONS

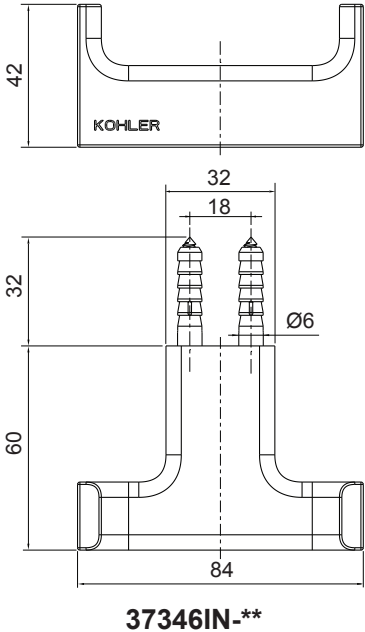
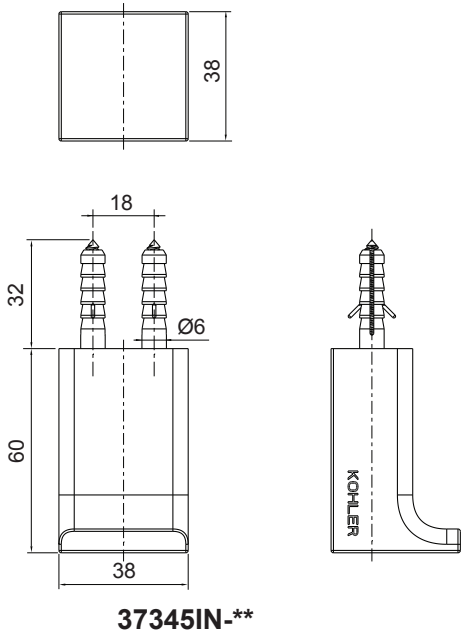

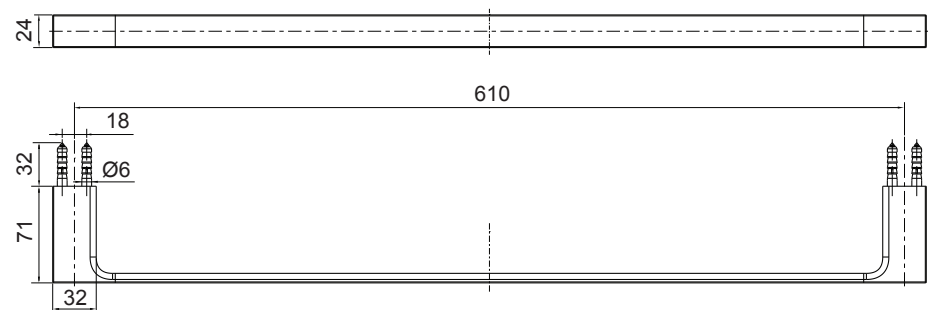

37347IN-**

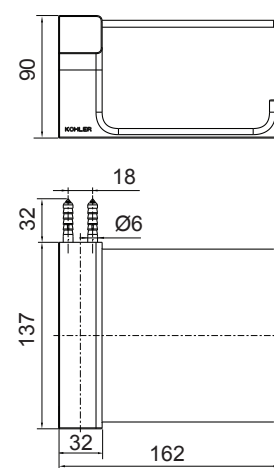

37351IN-**

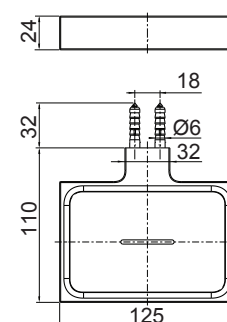

37348IN-**

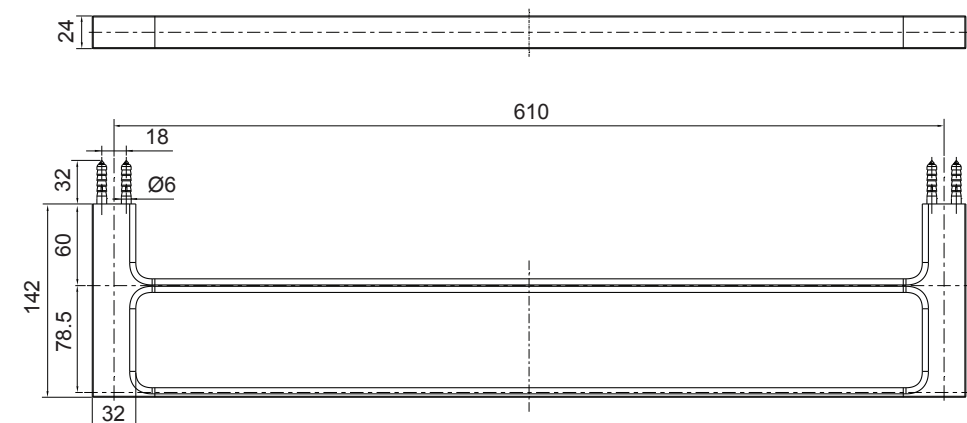

9123IN-**

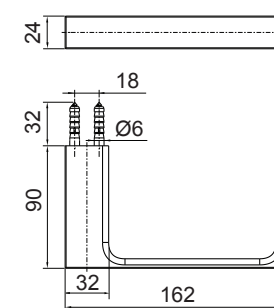

37350IN-**

KOHLER®

ACCESSORY SERVICE PARTS

STRAYT

Accessories

37347IN-**
9123IN-**

24" TOWEL BAR
24" DOUBLE TOWEL BAR

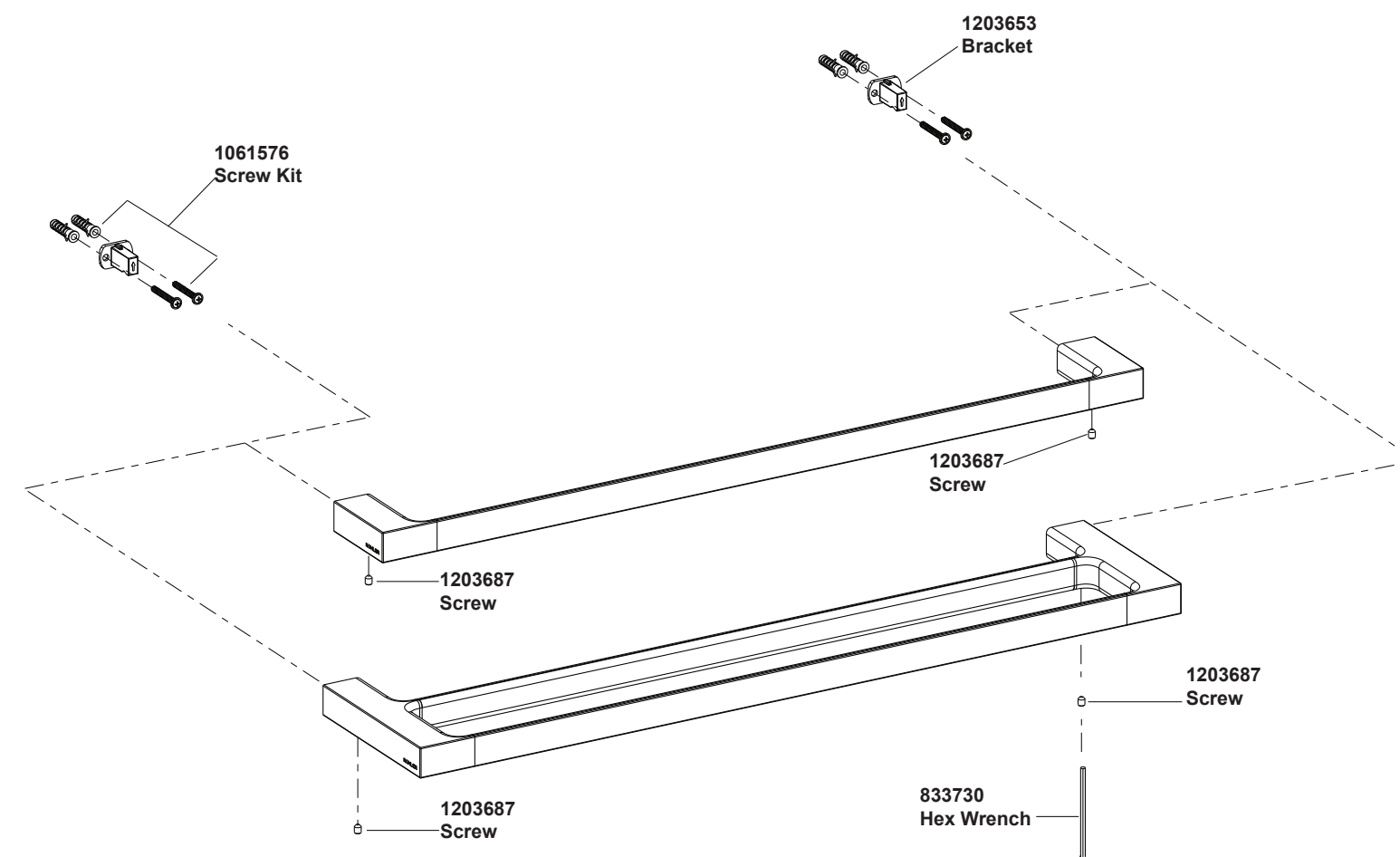

**Color code must be specified when ordering

37345IN-**	SINGLE ROBE HOOK
37350IN-**	TOILET TISSUE HOLDER
37348IN-**	SOAP DISH
37351IN-**	TOILET TISSUE HOLDER WITH COVER
9124IN-**	TOWEL RING
37346IN-**	DOUBLE ROBE HOOK

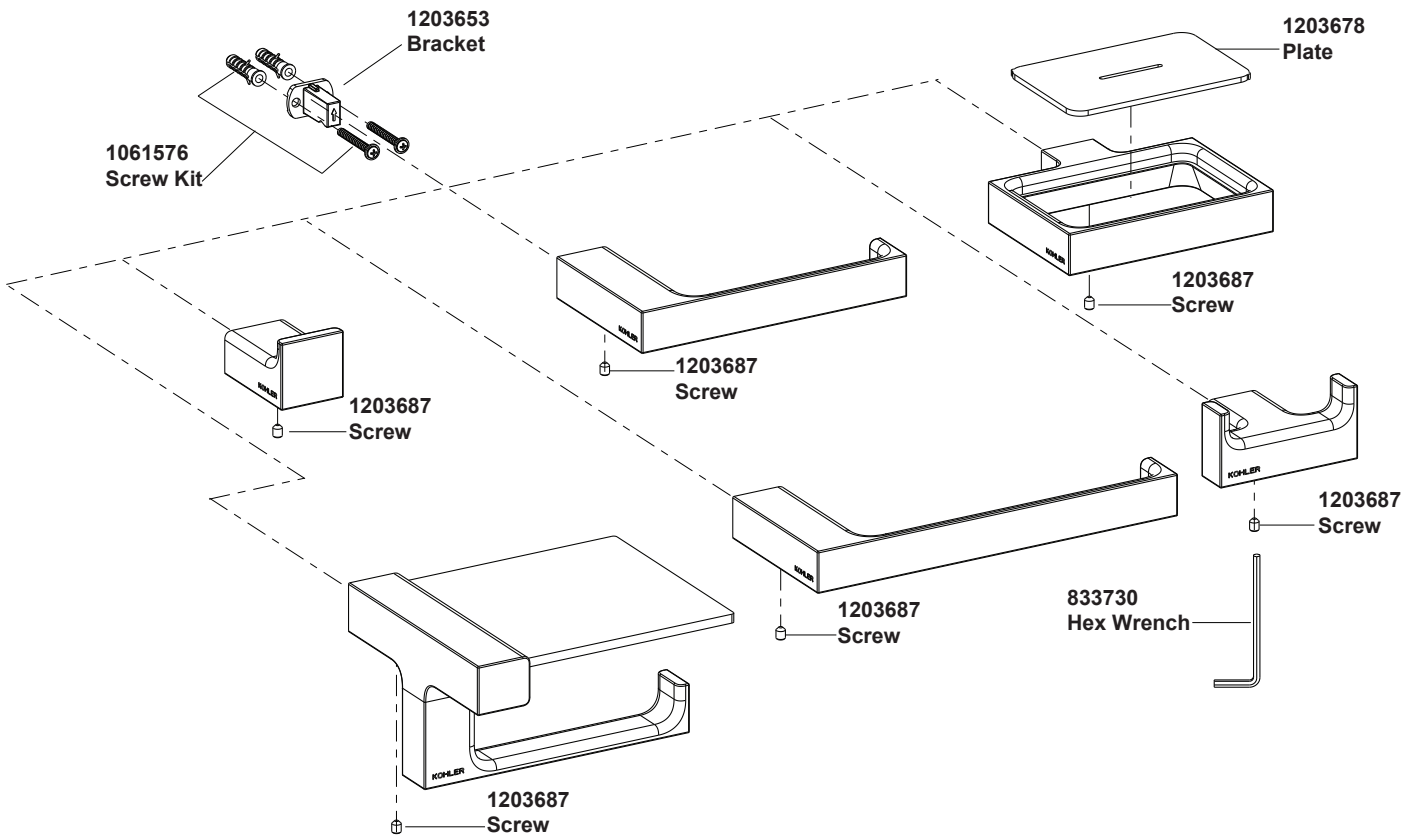

**Color code must be specified when ordering

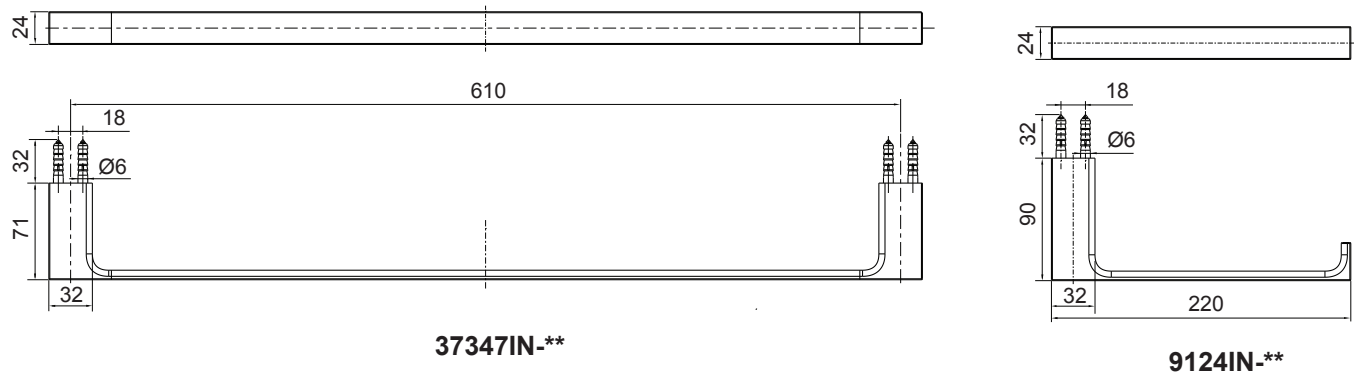

INSTALLATION

How To Install the Bracket
Only For 37347IN / 9123IN

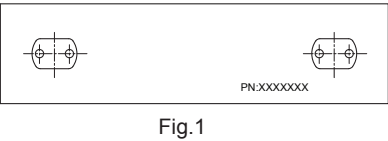

As Fig.1 shown, Select a location on the vertical wall to stick the template, Ensure the template is horizontal & Drill Holes in the finished wall as required.

Only For 37345IN / 37346IN / 37348IN / 37350IN / 37351IN / 9124IN

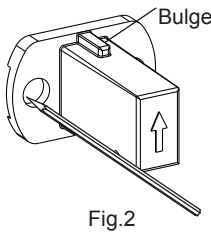

Select a location on the vertical wall to install the bracket. As shown in Fig 2. Mark anchor (1) mounting hole locations on wall as shown, Ensure two screw holes are horizontal. Drill holes in the finished wall as required.

For All Products

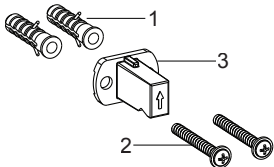

Press the anchors (1) into the holes, secure the brackets (3) with the self tapping screws (2). Make sure the bulge on the bracket upwards.

How To Install the Single Robe Hook

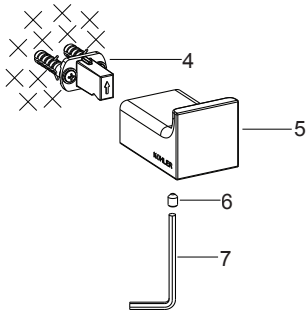

Slide the single robe hook (5) onto the bracket (4). Orient the screw hole of the hook downwards. Tighten the screw (6) with the hex wrench (7) to secure the single robe hook.

How To Install the Double Robe Hook

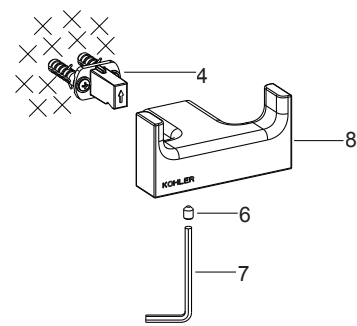

Slide the double robe hook(8) onto the bracket (4). Orient the screw hole of the hook onwards. Tighten the screw (6) with the hex wrench (7) to secure the double robe hook.

How To Install the Towel Bar

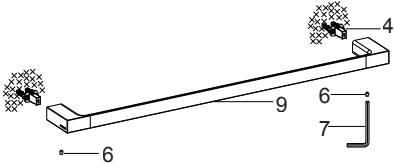

Slide the extension of the towel bar kit (9) onto the bracket (4). Orient the screw hole of the extension downwards. Tighten the screw (6) with the hex wrench (7) to secure the towel bar kit.

How To Install the Soap Dish

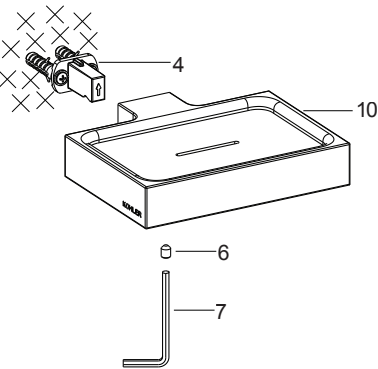

Slide the soap dish (10) onto the bracket (4). Orient the screw hole of the soap dish downwards. Tighten the screw (6) with the hex wrench (7) to secure the soap dish.

How To Install the Toilet Tissue Holder

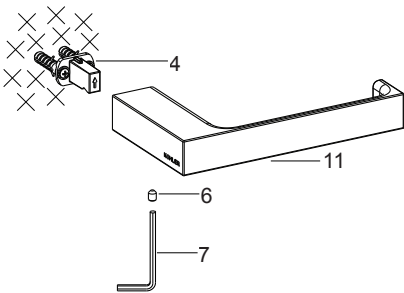

Slide the toilet tissue holder (11) onto the bracket (4). Orient the screw hole of the holder downwards. Tighten the screw (6) with the hex wrench (7) to secure the toilet tissue holder.

How To Install the Covered Toilet Tissue Holder

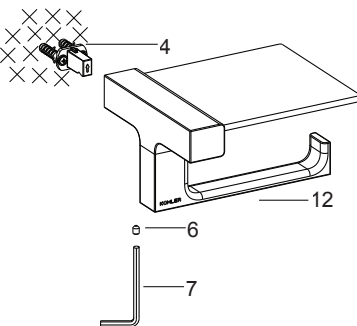

Slide the covered toilet tissue holder (12) onto the bracket (4). Orient the screw hole of the holder downwards. Tighten the screw (6) with the hex wrench (7) to secure the toilet tissue holder.

How To Install the Double Towel Bar

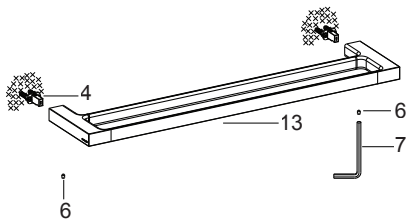

Slide the extension of the double towel bar kit (13) onto the bracket (4). Orient the screw hole of the extension downwards. Tighten the screw (6) with the hex wrench (7) to secure the double towel bar kit.

How To Install the Towel Ring

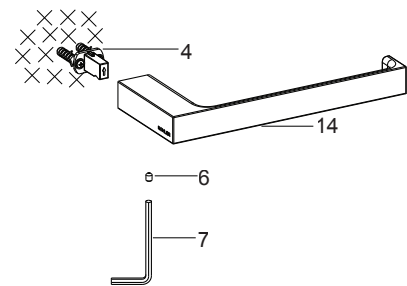

Slide the towel ring(14) onto the bracket (4). Orient the screw hole of the towel ring downwards. Tighten the screw (6) with the hex wrench (7) to secure the towel ring.

INSTALLATION CHECKOUT

Ensure that all connections are tightened.

CLEANING INSTRUCTION

