

14406 8" Widespread Lavatory Faucet  
 14408 8" Widespread Tall Lavatory Faucet

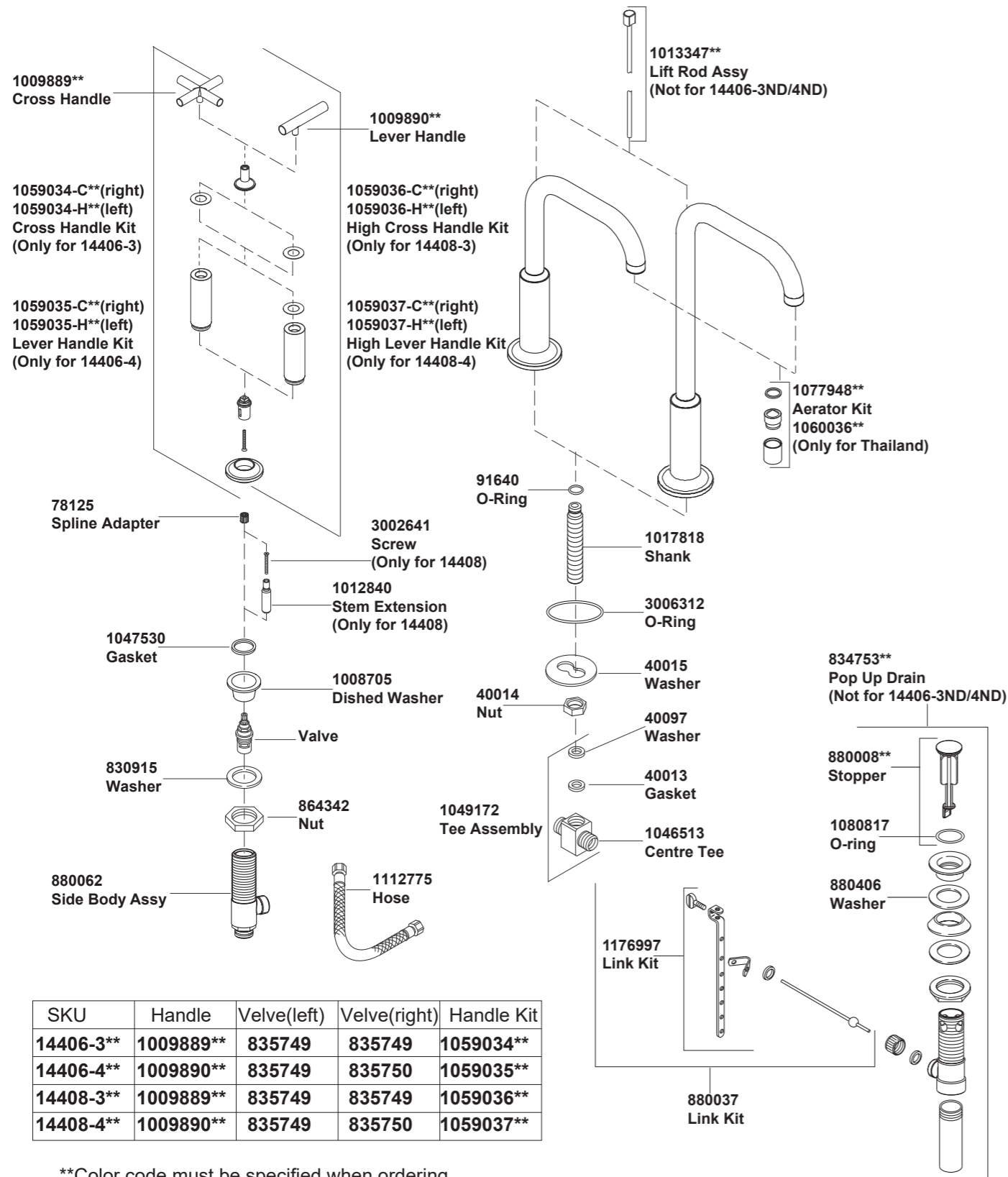

SKU	Handle	Velve(left)	Velve(right)	Handle Kit
14406-3**	1009889**	835749	835749	1059034**
14406-4**	1009890**	835749	835750	1059035**
14408-3**	1009889**	835749	835749	1059036**
14408-4**	1009890**	835749	835750	1059037**

\*\*Color code must be specified when ordering

14406 8" Widespread Lavatory Faucet  
 14408 8" Widespread Tall Lavatory Faucet

## BEFORE YOU BEGIN

All information is based on the latest product information available at the time of publication. Kohler Co. reserves the right to make changes in product characteristics, packaging, or availability at any time without notice.

Please leave these instructions for the consumer. They contain important information.

## NOTES:

1. Flush the water supply pipes thoroughly to remove debris.
2. Inspect the supply tubing for damage. Replace as necessary.
3. Observe local plumbing codes.
4. If possible, install this faucet before installing the lavatory.

## HANDLE OPERATION

Left handle opens with one-quarter turn counter clockwise. Right handle opens with one-quarter turn clockwise (Lever Handle).

Left handle opens with one-quarter turn clockwise. Right handle opens with one-quarter turn counter clockwise (Corss Handle).

## ROUGH-IN DIMENSIONS

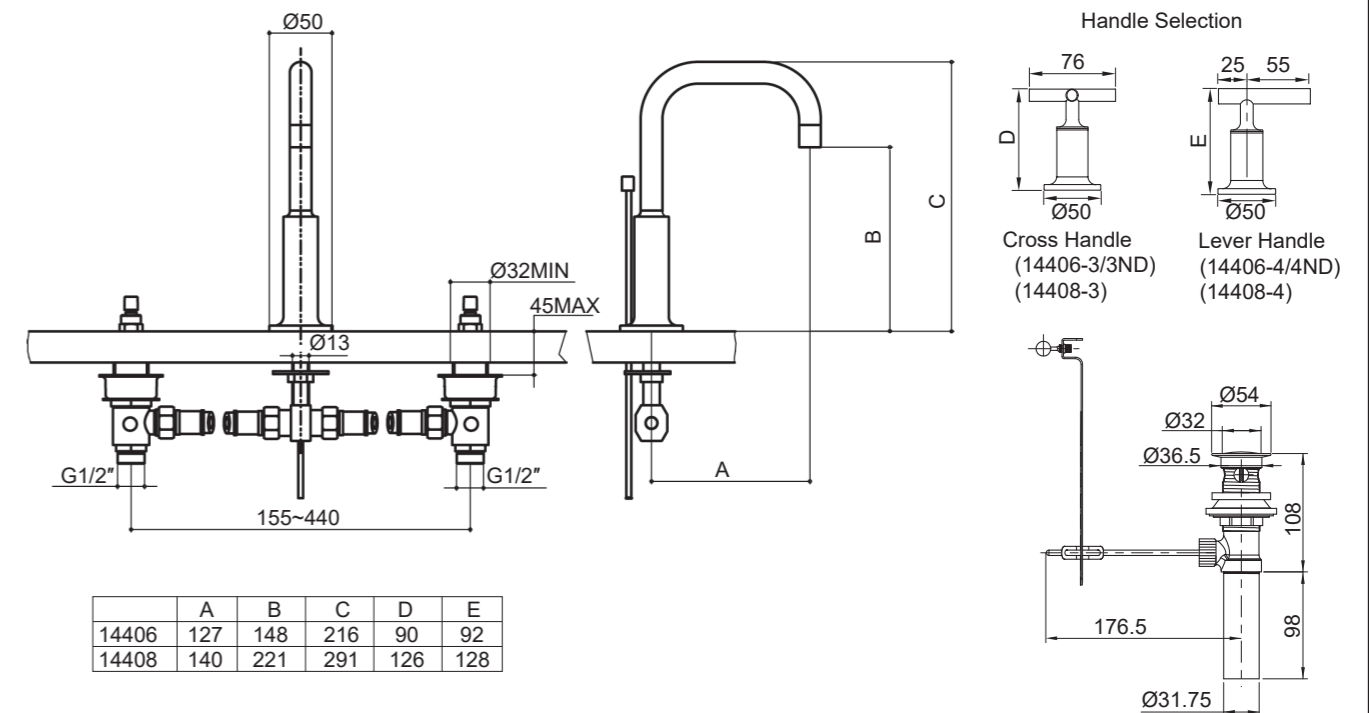

## INSTALLATION

### How to Install the Spout

Remove and retain the parts from the spout kit(1) according to the following order: nut(3) and metal washer(2).

Install the O-ring(7) to the bottom of the spout through the shank.

Fit the spout to the center hole of lavatory. Install the metal washer and nut. Adjust the position of the spout and securely tighten nut.

Thread the supply tee(6) with plastic gasket(5) and rubber washer(4) to the spout shank, tighten by hand.

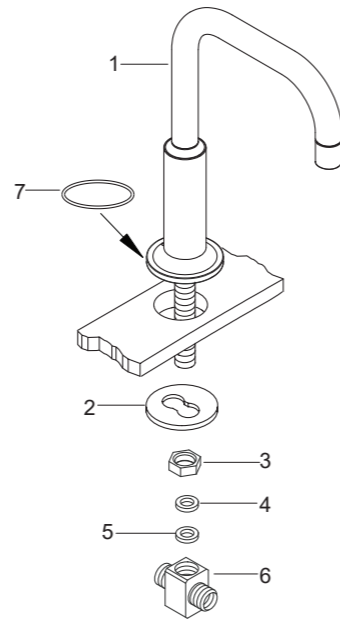

### How to Install the Valve Bodies, the Handles and the Hoses

Remove the handle kit(8) from the side body(9). Install the sticker washer(10) into the groove on the bottom of the escutcheon(13).

Put the washers into the ends of the hose(14). Connect the side bodies and supply tee(6) with hoses as shown in the figure.

**NOTE:** The hoses(14) should only be used here.

Insert the side body with dished washer (17), washer(11)and nut(12) through mounting holes from bottom of the lavatory(For 14406T-4 and 14408T-4, the side body with red mark on the left when facing the front of the faucet). Press the spline adapter(15) onto the valve stem(16).

Reinstall and tighten the handle kit(The handle with the red washer on the left when facing the front of the faucet). Tighten the nut(12).

The configuration shown is the correct position of the handles in the closed position.

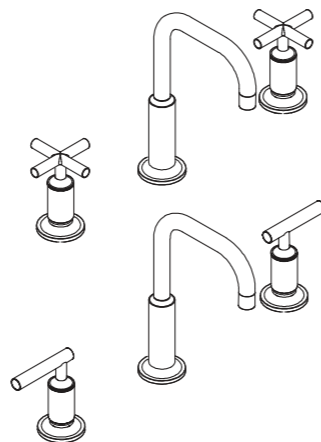
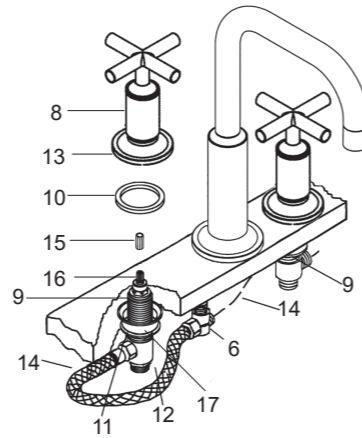

### How to Install the Drain

Remove the stopper(18), flange(20) and washer(21) from the drain body(23). Take off the tailpiece(25). Apply thread tape to the tailpiece and install the tailpiece to drain body. Insert the drain body kit into the lavatory from underside, and make sure the drain lever hole(22) facing to the back of the lavatory. Screw the flange with washer into the drain body. Tighten the locknut(24) by hand from underside of the lavatory.

**NOTE:** If needed, apply a ring of plumbers putty around the underside of the drain flange(20), instead of using washer(21).

Place the stopper(18) into the drain body aligning the flat side of stopper hole(19) with the drain lever hole.

Remove the retaining nut(29). Fit the plastic washer(27) and retaining nut onto the ball lever(28). Insert the ball lever assembly into the drain lever hole and through the stopper hole. Tighten the retaining nut.

Be sure that the ball lever(28) points to the back of the lavatory, tighten the locknut(24) on the drain body by wrench.

**NOTE:** Do not reposition the drain if plumbers putty applied after the locknut is tightened, or you may break the putty seal. Wipe away excess plumbers putty.

Insert lift rod(30) to the hole at the rear of the body(33). Assemble the thumb screw(31) to the link(32), and link onto the ball lever(28) with "V"-clip (26). Slide the lift rod(30) into the hole in link. Push the ball lever down into the open position, and adjust the lift rod. Tighten the thumb screw(31).

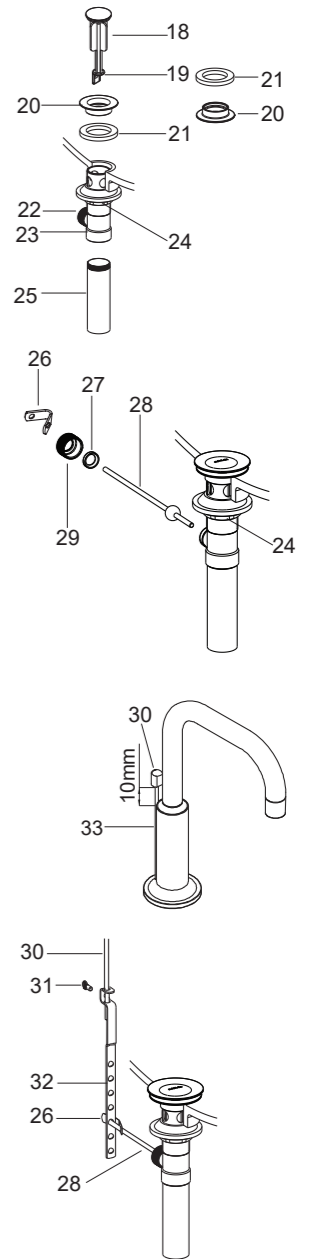

## INSTALLATION CHECKOUT

Ensure that all connections are tight. Remove the aerator(34).

Open the drain. Turn on the main supply and check for leaks. Open both hot and cold valves and run water through the spout to remove any debris. Turn the valve off. Reinstall the aerator.

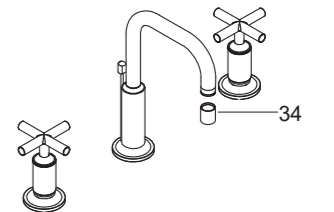

## CLEANING INSTRUCTIONS

All Finishes: Clean the finish with mild soap and warm water. Wipe entire surface completely dry with clean soft cloth. Many cleaners may contain chemicals, such as ammonia, chlorine, toilet cleaner etc, which could adversely affect the finish and are not recommended for cleaning.

Do not use abrasive cleaners or solvents on Kohler faucets and fittings.