



**Thoreau®**  
Under-mount Bathroom Sink  
**K-2907-8U**

**Features**

- Under-mount.
- Oval basin.
- With overflow.
- Can accommodate single-hole center-mount or widespread faucet.
- 8-inch centers.
- 18-1/4" (464 mm) x 11" (279 mm)

**Material**

- KOHLER® enameled cast iron.

**Recommended Accessories**

K-8998 P-Trap

**Components**

Additional included component/s: 1193643 Basin Clamps.



**ADA** **CSA B651** **OBC**

**Codes/Standards**

ASME A112.19.1/CSA B45.2

ADA

ICC/ANSI A117.1

CSA B651

OBC



**Lifetime Limited Warranty for  
KOHLER® Cast Iron Components**

See website for detailed warranty information.

**Available Color/Finishes**

*Color tiles intended for reference only.*

**Color Code Description**

	0	White
	96	Biscuit
	47	Almond

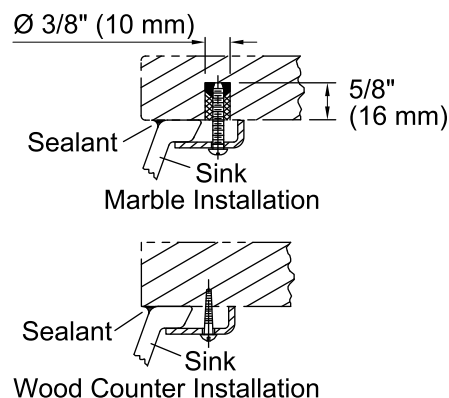
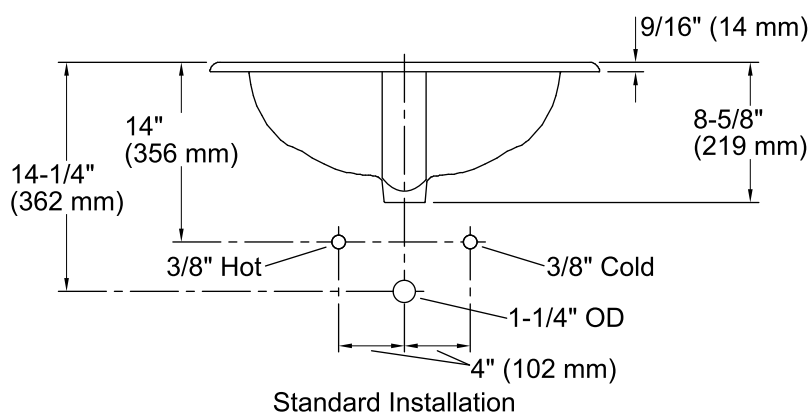
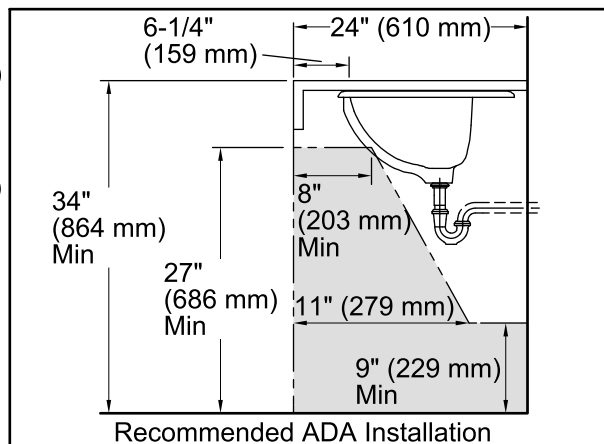
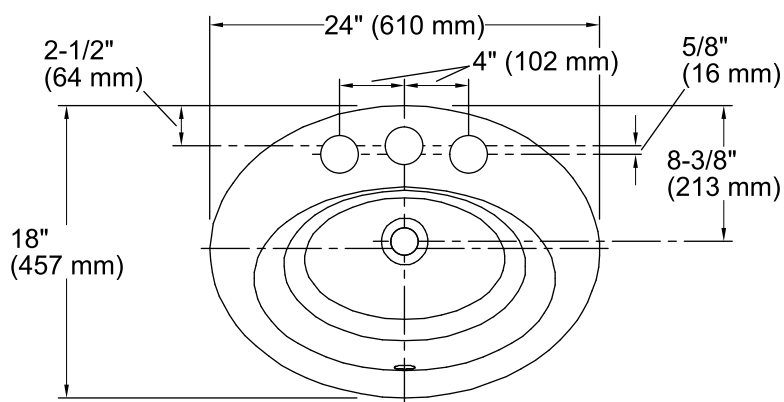

## Technical Information

All product dimensions are nominal.

Bowl configuration: Single

Installation: Under-mount

Bowl area: Length: 18-1/4" (464 mm)  
Width: 11" (279 mm)  
Water depth: 4-3/4" (121 mm)

Number of deck holes: 3

Faucet hole(s): 2-3/8" (60 mm)

Drain hole: 1-3/4" (44 mm)

Template: 114635-7, required, included

## Notes

Install this product according to the installation instructions.

ADA, OBC, CSA B651 compliant when installed to the specific requirements of these regulations.