

# Homeowners Guide

## 用户手册

C3 Toilet Seat with Bidet Functionality

C3清舒宝智能座便盖

K-18751TW-0

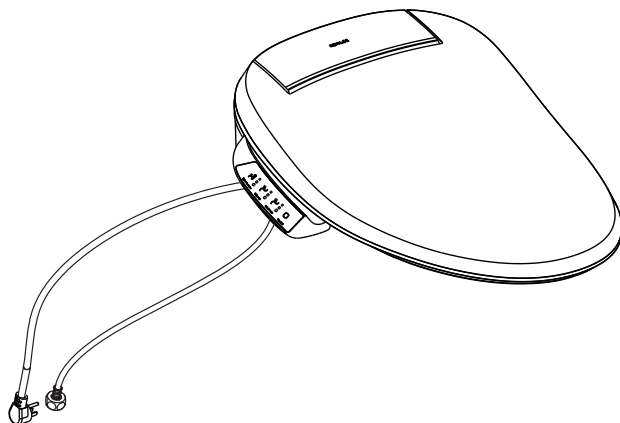

科勒（中国）投资有限公司  
中国上海市闸北区江场三路158号 邮编：200436  
制造商：上海科勒电子科技有限公司  
中国上海市宝山区丰翔路1955号 邮编：200444

繁體頁碼 2-17  
English page 18-33

**KOHLER**®

1293590-T01-A

# 目錄

|                 |    |
|-----------------|----|
| 安全注意事項.....     | 3  |
| 規格.....         | 5  |
| 謝謝您選擇科勒公司.....  | 6  |
| 控制面板.....       | 6  |
| 使用方法.....       | 7  |
| 初次使用前準備.....    | 8  |
| 功能測試.....       | 9  |
| 維護和清洗.....      | 10 |
| 清洗噴嘴.....       | 11 |
| 移除座便蓋.....      | 12 |
| 清洗過濾網.....      | 13 |
| 長期放置不用時的維護..... | 14 |
| 疑難解答.....       | 15 |
| 維修配件圖.....      | 17 |

# 安全注意事項

## 保存这些说明



警告：触电、火灾或人身伤害的危险。本产品必须安全接地。只能连接到专用的110V~，60Hz，15A带接地故障断路器或接地漏電保護器的電路中。



警告：觸電或產品損傷的危險。不要把產品浸入水中。

**重要！** 產品損傷的危險。不要安裝在水可能濺到的地方。

**重要！** 產品損傷的危險。不要把產品安裝在過分潮濕的地方，在這種地方，水汽可能凝聚在產品表面。請始終保持使用環境有足夠的通風。以防止電子元件的損壞。

**重要！** 產品損壞或財產損失的危險。硬推、硬拉水管接頭可能造成水滲漏。

**重要！** 產品損壞的危險。不要在噴嘴上施加過大的力。否則產品可能損壞。

**重要！** 產品損壞的危險。在一些水可能在水管中結冰的地方。要做好水管保溫的安排。任何留在產品裡的水在冬天儲存時都可能結冰。在重新安裝或使用前請保證產品暖至室溫。

**重要！** 產品損壞的危險。在安裝工作完成之前不要接通電源。這可能導致產品故障。

注意：溫暖的氣候時。熱保護器在存儲或運輸過程中可能失靈。導致產品不工作。在重新安裝或使用前請保證產品冷至室溫 產品冷至室溫。

當使用電器產品時，尤其當兒童在場時，應該遵守基本的安全防範，包括如下：

危險-降低觸電的危險：

- 不要把此產品放置在可能掉落或可能被拉入浴缸及水槽的地方。
- 不要把產品放置在容易受水或其它液體侵蝕的地方。
- 不要觸及掉進水的產品，請立刻關閉家裡入戶電源開關。

警告-避免低溫灼傷、觸電、火災或人身損傷。

- 當兒童、老年人、殘疾人，以及身體、感知、智力能力缺陷或經驗和嘗試缺乏的人使用或靠近此產品時，近距離的監護是必需的。 兒童不應該被允許使用或接觸此產品，不要讓兒童獨自呆在安裝有此產品的房間，兒童不應玩耍器具。

- 僅按照手冊中所描述的方式使用本產品，不要使用科勒不推薦的附件只有專業。
- 使用時請勿倚靠在蓋板上，以免損壞產品。
- 如果有一下情況請不要使用本產品：電源線、插頭及產品有損壞；產品不能正常工作；產品掉入水中。
- 根據安裝說明正確地安裝本產品。
- 只有專業人士可以修理此產品。不要試圖自己維修此產品。否則保修無效。
- 使電源線遠離加熱表面。
- 不要把任何物品掉入或插入管路和開孔處。
- 不要在戶外或者微粒噴霧設備正在被使用的地方使用本產品。也不要給氧的地方使用本產品。
- 在通電之前必須按照說明書中的要求接地。
- 防止將水淋到電源插頭上。
- 請避免長時間讓裸露的皮膚接觸加熱座圈。以免低溫灼傷。
- 需要有資質的維修人員維修紫外線殺菌裝置。
- 如果電源線損壞。為了避免危險。必須由製造商、其維修部或類似部門的專業人員更換。
- 必須使用隨器具附帶的新軟管元件，舊軟管元件不能重複使用。

## 規格

|       |             |                        |                        |
|-------|-------------|------------------------|------------------------|
| 供水水壓  |             | 0.07MPa (動壓) - 0.74MPa |                        |
| 規格    |             | 110V ~, 60Hz           |                        |
| 額定功率* |             | 1200W                  |                        |
| 外形尺寸  |             | 530mm×430mm×120mm      |                        |
| 產品重量  |             | 約 4.25Kg               |                        |
| 使用環境  |             | 1-40 °C                |                        |
| 清洗    | 出水量         | 臀部沖洗                   | 約0.30-0.65L/min        |
|       |             | 女性沖洗                   | 約0.30-0.65L/min        |
|       | 額定加熱功率      |                        | 1150W                  |
|       | 清洗水溫調節      |                        | 關, 1-3檔 (室溫, 約31-39°C) |
|       | 沖洗時間 (單次最長) |                        | 約5分鐘                   |
|       | 噴管數量        |                        | 1個                     |
|       | 安全裝置        | 水溫過熱保護                 | 溫度保險絲、過熱斷路器            |
| 逆流防止  |             | 單向閥                    |                        |
| 舒適    | 上蓋          | 緩降                     |                        |
|       | 座圈          | 緩降                     |                        |
| 衛生    | 噴嘴自清洗       |                        | 有                      |
|       | 快速拆除本體      |                        | 推動釋放鍵                  |
|       | 抗菌材料*       |                        | 座圈、蓋板                  |
|       | UV燈*        |                        | 有                      |
| 其它功能  | 控制面板        |                        | 按鍵位於本體側面               |
|       | 落座感應        |                        | 機械式位於座圈右側轉軸            |

\* 功率值在以下條件測試：動壓0.2MPa, 進水溫度15°C。

\* 抗菌：含銀離子的座圈、蓋板長期抗細菌，抑制產品表面的細菌生長，並不代表防霉等附帶效果。抗菌率大於99% (依據 GB21551.1-2008、GB21551.2-2010抗細菌性能試驗方法進行試驗)。

\* UV除菌 (是指UV燈產生紫外線除菌)：在UV工作周期內除細菌，減少噴嘴表面的細菌生長，並不代表防霉等附帶效果。除菌率大於99% (在UV的壹個工作周期後測得)。

## 謝謝您選擇科勒公司

謝謝您選擇科勒。科勒技術提供了可靠性能和優雅生活的結合，滿足了您未來幾年的需求。科勒產品的美觀和可靠性將滿足您最挑剔的眼光。我們為我們科勒的產品感到非常地自豪，相信您也會。

請花幾分鐘閱讀壹下這本用戶手冊，特別注意維護和清洗說明。

這本說明書中所有的信息基於最新公開的產品信息。在科勒，我們壹貫堅持改善我們產品的質量。我們保留在任何時候不通知的情況下改變產品特性，包裝或實用性的權利。

## 控制面板

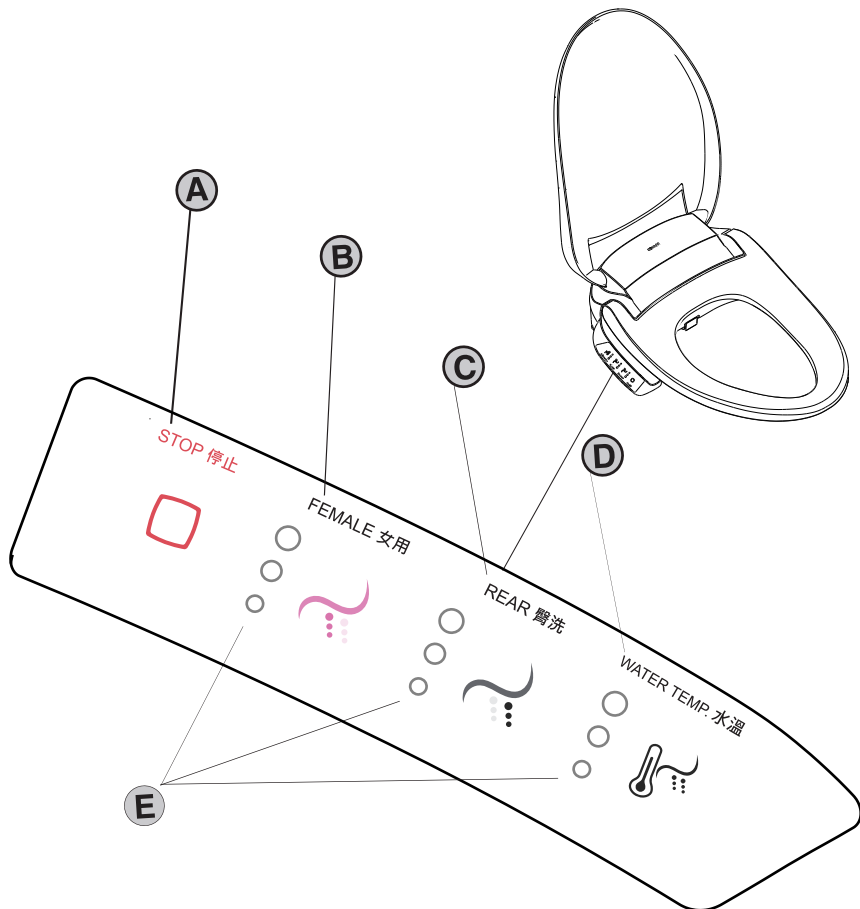

# 使用方法

## □ A - 停止

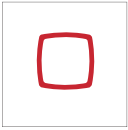

在沖洗開啟時，按此鍵可停止沖洗功能。

## □ B - 女用



落座時，按女性鍵，啟動女性沖洗（女性專用），並顯示現在的沖洗強度。

在開啟女性功能的狀態下，繼續按女性鍵可改變沖洗強度，強度按小檔、中檔、大檔、中檔循環變化。

連續沖洗約5分鐘後，自動停止。

## □ C - 臀洗



落座時，按臀洗鍵，啟動臀部沖洗，並顯示現在的沖洗強度。

在開啟臀洗功能的狀態下，繼續按臀洗鍵可改變沖洗強度，強度按小檔、中檔、大檔、中檔循環變化。

連續沖洗約5分鐘後，自動停止。

本機附帶寬幅清潔功能，如想使用寬幅清潔，請在啟動臀部沖洗后長按臀洗鍵+停止鍵2秒。

## □ D - 水溫



按水溫鍵可設置沖洗水的溫度，每次按鍵，按關、低檔、中檔、高檔、中檔循環。設置沖洗水溫，並切換點亮水溫參數指示燈。

如果是處於關閉狀態，指示燈不亮。

## □ E - 檔位說明

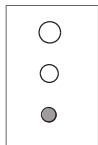

低檔  
小燈亮

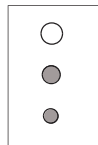

中檔  
小燈和中燈  
同時亮

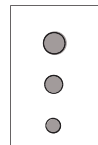

高檔  
小燈、中燈和  
大燈同時亮



## 初次使用前準備

- 按安裝說明書接上進水軟管，打開止水閥，插上電源。
- 把電源線插上電源插座，座便蓋發出短蜂鳴1次，噴管伸縮1次，側鍵盤上背光燈閃爍，直至初始化結束。
- 初始化過程中，可聽到電機轉動聲和流水聲，均屬正常。
- 初次使用時為出廠設置狀態：
  - 女用：水溫：關
    - 水流強度：中檔
  
  - 臀洗：
    - 水流強度：中檔





## 功能測試

- 用塑料布包裹在座圈上，防止測試時水從座便器中噴出。
- 座圈設計為落座感應模式。為了激活座圈達到測試的目的，首先面對座便器。然後用手按住座圈右邊離前端大約1/2處，聽到座圈右邊轉軸處發出“咯塔”壹聲（重力感應）。

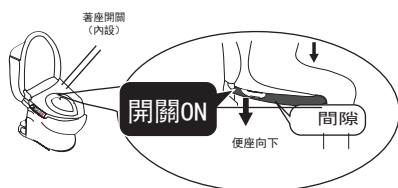

- 坐得不深的話，有可能沒有接通著座開關。



### 須知

- 體重輕的兒童在使用時，接通著座開關會比較難。
- 因為便座是上下移動的構造，所以便座緩沖墊和便器間設計有間隙。
- 繼續參照“控制面板”和“使用方法”部分來測試座便蓋的不同功能。

## 維護和清洗

為了達到最好的效果，在維護您的科勒產品時記住下列幾條：

**重要！** 不要用水直接沖洗座便蓋。

- 測試 - 首先用清洗液在座便蓋不顯眼的地方測試，如果確認清洗液不會對座便蓋外表造成損壞然後再應用於整個表面。
- 不要讓清潔劑浸泡 - 不要讓清潔劑浸泡產品。
- 避免表面粗糙的材料 - 使用柔軟、潮濕的海綿或棉質布，不要用表面粗糙的材料來清洗表面，諸如刷子、沖刷墊等。
- 擦洗 - 加上清潔劑後，立即用濕布擦洗表面，擦除噴到表面的清潔劑和臟物。

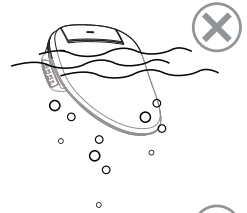

### 清洗座圈

- 在氣霧罐中避免有研磨的清潔劑和消毒劑。



維護提示：用洗滌劑和水的混合液體或任何列為可用於座圈清潔的產品清洗座圈，用柔軟濕潤的海綿或者布。用軟毛巾擦幹，在空氣中讓座圈自然乾燥。

- 不允許帶腐蝕的化學品或化妝品（諸如指甲油或須後水）和座圈接觸，避免破壞表面。

注意：不遵守這些清洗說明可能使科勒的保修義務無效。



注意：清洗程序的成功取決於諸如水的硬度和溫度，使用成分的精確數量，清洗規則的改變和被清洗產品的狀態等因素。因為這些因素會有變化，科勒不能保證所提到的規則的有效性。

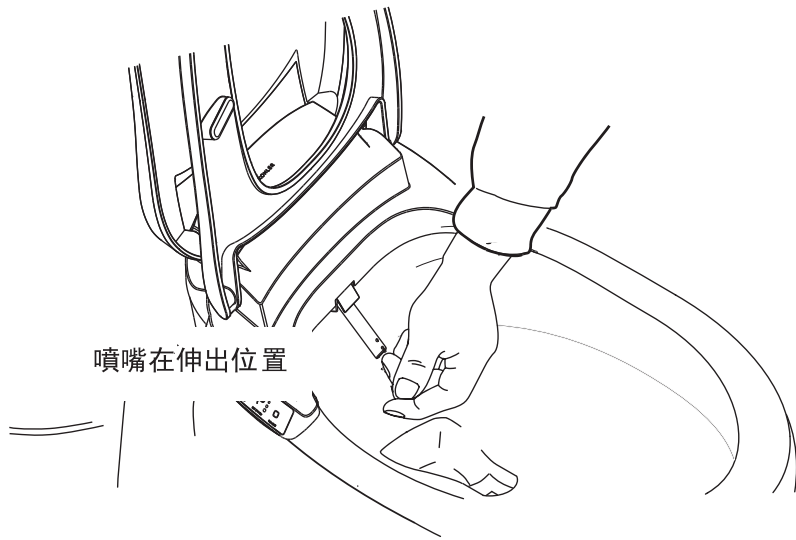

## 清洗噴嘴

注意：當座便蓋處於離座狀態的時候，噴嘴才能伸出以便清洗。

- 翻開上蓋和座圈。
- 長按女用或臀洗鍵，待噴管完全伸出後，用軟鬃毛刷清洗噴嘴。
- 噴嘴清洗完畢後，長按女用或臀洗鍵，噴管縮回，或等待噴管自動縮回。

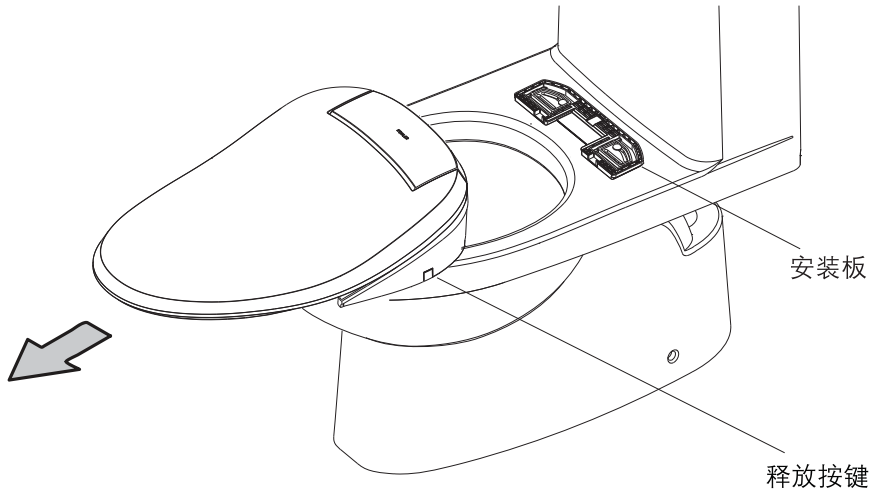

## 移除座便蓋

- 關閉供水閥。
- 開啟座便器沖洗功能減輕供水管壓力。
- 拔掉座便蓋電源插頭。
- 斷開供水管和三通的連接。
- 按釋放按鍵（見圖示）。
- 向前移動座便蓋，使座便蓋和安裝板分離。

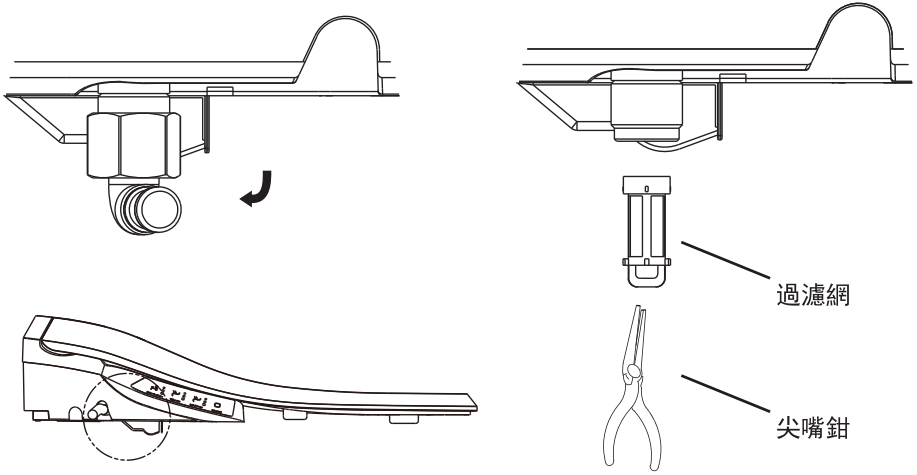

## 清洗過濾網

重要！产品损坏的危險。小心不要造成接头损坏。

當發現沖洗水量變小或出現不出水現象，請及時清洗或更換濾網。

- 關閉供水閥。
- 按釋放按鍵，向前移動座便蓋，使座便蓋與安裝板分離。
- 將供水管旋轉出底座。
- 按釋放按鍵，向前移動座便蓋，使座便蓋與安裝板分離。
- 用尖嘴鉗小心的將過濾網從產品的進水口移出（見圖示）。
- 用軟鬃毛刷清洗過濾網。
- 重新裝好過濾網。
- 小心對正螺紋，重新裝好座便蓋的供水管。
- 為防泄漏，請檢查所有的連接，並做必要調整。
- 開啟供水閥門。

## 長期放置不用時的維護

- 當準備長期不使用智慧座便蓋時, 請拔掉電源, 關閉角閥, 拆除進水軟管, 將進水軟管內的水排空。
- 長期不用再次使用時, 請務必多進行幾次沖洗, 確保內部管路清洗乾淨。

## 疑難解答

這份疑難解答只提供普通幫助。科勒授權的服務代表能解決相關的電氣問題。保修服務方面的問題，請聯系妳的經銷商或批發商。

### 壹般功能

| 現象         | 可能原因  | 建議措施  |
|------------|---|---|
| 1. 機器不工作。  | A. 停電。<br>B. 未接上電源線。<br>C. 源線漏電插頭保護開關未復位。<br>D. 座圈未能感應到使用者。<br>E. 熱保護器開啟自動保護。<br>F. 以上措施都不見效。 | A. 等到电力恢复。<br>B. 将插头插在插座上。<br>C. 按下插头上的复位按钮。<br>D. 深深地坐到座圈上。<br>E. 将产品在室温环境下静置一段时间。<br>F. 联系科勒服务代表。 |
| 2. 噴管不能出水。 | A. 座圈未能感應到使用者。<br>B. 供水故障。<br>C. 過濾網阻塞。<br>D. 以上措施都不見效。                                       | A. 深深地坐到座圈上。<br>B. 关闭电源, 排除供水故障, 重新通电。<br>C. 查看”清洗过滤网”部分。<br>D. 联系科勒服务代表。                           |

### 清潔功能

| 現象                  | 可能原因                                  | 建議措施                                       |
|---------------------|---------------------------------------|--|
| 3. 沖洗水壓小。           | A. 過濾網阻塞。<br>B. 供水水壓不足。               | A. 查看“清洗過濾網”部分。<br>B. 提高水壓到產品要求的水壓範圍。      |
| 4. 完成清洗前水就停止從噴嘴中噴出。 | A. 連續沖洗5分鐘，沖洗功能自動停止。<br>B. 圈未能感應到使用者。 | A. 如需要，請再次按下沖洗按鍵。<br>B. 在“功能測試”部分查看激活座圈信息。 |

| 疑難解答 (續)                 |                         |               |
|--------------------------|-------------------------|---------------|
| 5. 沖洗時有水從噴嘴旁邊的孔中流出。      | A. 產品內部防止水壓過高的保護。       | A. 正常現象。      |
| 6. 落座時，有水從噴嘴處流出。         | A. 在使用前自動排放噴管內部的殘留水。    | A. 正常現象。      |
| 座圈緩降                     |                         |               |
| 現象                       | 可能原因                    | 建議措施          |
| 7. 座圈和蓋板的關閉速度在夏季和冬季有所不同。 | A. 因室內溫度變化。             | A. 正常現象。      |
| 落座感應器                    |                         |               |
| 現象                       | 可能原因                    | 建議措施          |
| 8. 離座狀態下，按下沖洗按鍵，沖洗功能啟用。  | A. 落座感應器被重物壓住。          | A. 移除座圈上方的重物。 |
| 9. 即使坐著，清洗功能也不起作用。       | A. 當前的坐姿，落座感應器不能檢測到使用者。 | A. 變換坐的姿勢。    |
| 其他                       |                         |               |
| 現象                       | 可能原因                    | 建議措施          |
| 10. 產品松動。                | A. 固定產品的安裝板的螺絲松動。       | A. 擰緊安裝板螺絲。   |
|                          |                         |               |



維修零件圖  
K-18751TW-0

1240759-SP  
安裝螺絲附件包



1102014-SP  
線夾附件包

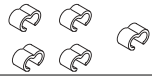

1085189-SP  
進水附件包



1085187-SP  
三通



1084962-SP  
進水閥爐網



1273701-SP  
進水閥

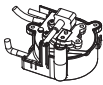

1279672-SP  
加熱器組件 (120V)



1265005-SP-  
電源線固定蓋



1278531-SP  
UV燈噴組件管

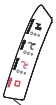

1292039-SP  
側鍵盤貼膜



1262060-SP  
側鍵盤電路板模塊組件 (220V)

1268893-SP  
電源線 (120V)

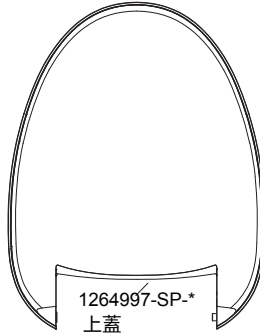
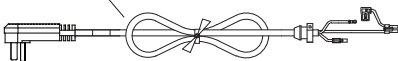

1264997-SP-  
上蓋

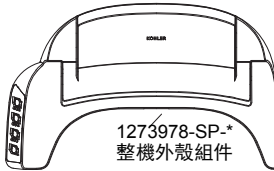

1273978-SP-  
整機外殼組件

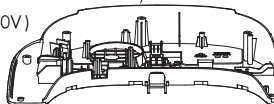

1273977-SP-  
整機底座組件

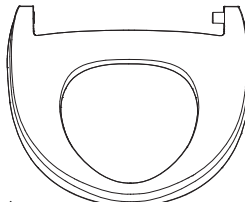

1273982-SP-  
座圈組件

1276260-SP  
密封圈



1268852-SP  
上蓋阻尼聯軸套



1273980-SP  
安裝板組件

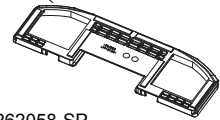

1273985-SP  
上蓋阻尼組件

1262058-SP  
控制板模塊組件 (220V)



1267440-SP  
電源板模塊組件 (120V)

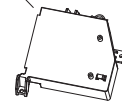

1265002-SP-  
安裝板鎖扣



1268809-SP  
逆變器組件

1233532-SP-  
暖風門



1273986-SP  
座圈阻尼組件



1265276-SP  
落座傳感器支架



1273979-SP  
落座傳感器組件

1266095-SP  
座圈緩衝墊 (前)



1266096-SP  
座圈緩衝墊 (后)

# Table of Contents

CAUTIONS AND WARNINGS..... 19

Specifications..... 21

Thank You For Choosing Kohler Company..... 22

Keypad and Panel Diagram..... 22

Operation ..... 23

Preparation before the First Use..... 24

Test the Functions..... 25

Care and Cleaning..... 26

Clean the Spray Wangs..... 27

Remove the Seat..... 28

Clean the Filter ..... 29

Maintanance in Case of Long-term Idle Status..... 30

Troubleshooting..... 31

Service Parts..... 33

# CAUTIONS AND WARNINGS

## Save this instruction



**Warning:** Risk of electric shock, fire or personal injury. This product must be installed safely. Connect only to dedicated 110V~, 60Hz, 15A circuit protected by Ground-Fault Circuit-Interrupters (GFCI's) or Earth-Leakage Circuit-Breakers (ELCB's).



**Warning:** Risk of electric shock or product damage. Do not immerse the product into water.

**Important!** Risk of product damage. Do not install at a place where it may be splashed by water.

**Important!** Risk of product damage. Do not install the product at a place with excessive humidity, where moisture may condense at the surface of the product. Please maintain that the usage environment is under adequate ventilation, so as to prevent damage to electronic components.

**Important!** Risk of product damage or property loss. Water leakage may happen if the water pipe connector is pulled or pushed with excessive force.

**Important!** Risk of product damage. The product may be damaged if the nozzle is applied with excessive force.

**Important!** Risk of product damage. The part of the pipe where water may be frozen should be protected by thermal insulation. Any water left in the product may be frozen during the winter season. Please keep the product in room temperature before reinstallation or usage.

**Important!** Risk of product damage. The power shall not be connected before the work is finished. Otherwise it may lead to product failure.

**Attention:** The thermal protector may be out of order during storage or transportation in warm climate which can lead to product failure. Please ensure the product cools to room temperature before reinstallation or usage.

When an electrical product is used, especially when children are near, the following basic safety precautions shall be abided by:

### **Danger-Reduce risk of electric shock:**

- Do not place or store this appliance where it can fall or be pulled into a bath or sink.
- Do not place in or drop into water or other liquid.
- Do not reach for a product that has fallen into water. Unplug immediately.

**WARNING - To reduce the risk of low grade burns, electric shock, fire or injury to persons:**

- Children, elders or those with disabilities from their body, sensitivity or mental disabilities should not use or get close to this product unless under close tutelage. Children are forbidden to use or touch this product. Do not leave children alone in a room with such product.
- For those children and the elderly who are unable to adjust the temperature, they should ask for help to adjust seat temp, water temp and wind temp of toilet cover to proper gears.
- Use this appliance only for its intended purpose as described in the manual. Do not use attachments not recommended by Kohler Co.
- Do not lean on cover when use this appliance to prevent product from damage.
- Never operate this appliance if it has a damaged cord or plug, if it is not working properly, if it has been dropped into water.
- Install this product properly by following the installation procedure.
- This product shall be repaired by professionals only. The warranty will become invalid if you try to repair this product by yourself.
- Keep power line far from heated surface.
- Do not drop or insert any substance to pipeline or the opening.
- Do not use this product outdoor or in a place where a particle mist spray device is used, neither at a place of provisions.
- The installation should be subject to the instructions before the power is connected.
- Water should not be poured into the power plug.
- Exposed skin should not make contact with heating seat for too long a time to prevent low temperature burning.
- UV sterilization devices should be installed and maintained by qualified servicemen.
- In case the power line is damaged; to avoid danger, product should be replaced by the manufacturer or the professionals from its maintenance department or similar departments, to avoid the occurrence of danger.
- Please use the water supply hose accompanying with new machine. The old hose assembly shall not be used again.

# SPECIFICATION

|                           |                              |                                |  |
|---------------------------|------------------------------|--------------------------------|--|
| Water supply pressure     |                              | 0.07MPa (dynamic) - 0.74MPa    |  |
| Specification             |                              | 110VAC ~, 60Hz                 |  |
| Rated power*              |                              | 1200W                          |  |
| Rough dimension dimension |                              | 530mm × 430mm × 120mm          |  |
| Weight of product         |                              | About 4.25Kg                   |  |
| Ambient environment       |                              | 1-40 °C                        |  |
| Cleaning                  | Amount of water              | Rear wash                      | About 0.30-0.65L/min                         |
|                           |                              | Female wash                    | About 0.30-0.65L/min                         |
|                           | Rated heating power          |                                | 1150W  |
|                           | Spray water temp adjustment  |                                | OFF, 1-3 gears (ambient temp about 35-39°C)  |
|                           | Single spray duration (Max.) |                                | About 5 min                                  |
|                           | Wand quantity                |                                | 1 piece                                      |
|                           | Safety device                | Water temp overheat protection | Thermal fuse, overheating breaker            |
| Back-flow prevention      |                              | Check valve                    |  |
| Comfort                   | Cover                        | Buffering                      |  |
|                           | Seat                         | Buffering                      |  |
| Sanitary                  | Wand self-cleaning           |                                | Yes  |
|                           | Quick-release body           |                                | Push release button                          |
|                           | Anti-microbial material *    |                                | Seat and cover                               |
|                           | UV light *                   |                                | Yes  |
| Other function            | Control board                |                                | Push button on sideboard                     |
|                           | Seat-on sensor               |                                | Located on right shaft for mechanical styles |

- \* Power value shall be checked under the following condition: dynamic pressure 0.2Mpa, inlet water temp 15°C.
- \* Antibacterial: ring and lid contains long term anti-bacteria silver ions which will inhibit bacteria growth on surface, this does not represent the mildew and other incidental effects. The antibacterial rate is more than 90% (test per GB21551.1-2008, GB21551.2-2010 antibacterial performance test requirements).
- \* UV sterilization (refers to the ultraviolet sterilization generated by UV lamp); during UV working period, eliminate bacteria, reduce bacteria growth on nozzle surface, this does not represent the mildew and other incidental effects. The antibacterial rate is more than 99% (measured after an UV work cycle).

# Thank You for Choosing Kohler Company

Thank you for choosing Kohler. Kohler craftsmanship offers you a rare combination of proven performance and graceful sophistication that will satisfy you for years to come. The dependability and beauty of your Kohler product will surpass your highest expectations. We're very proud of our products here at Kohler and we know you will be too.

Please take a few minutes to study this Homeowners Guide. Pay special attention to the care and cleaning instructions.

All information in this manual is based upon the latest product information available at the time of publication. At Kohler, we constantly strive to improve the quality of our products. We reserve the right to make changes in product characteristics, packaging, or availability at any time without notice.

## CONTROL PANEL

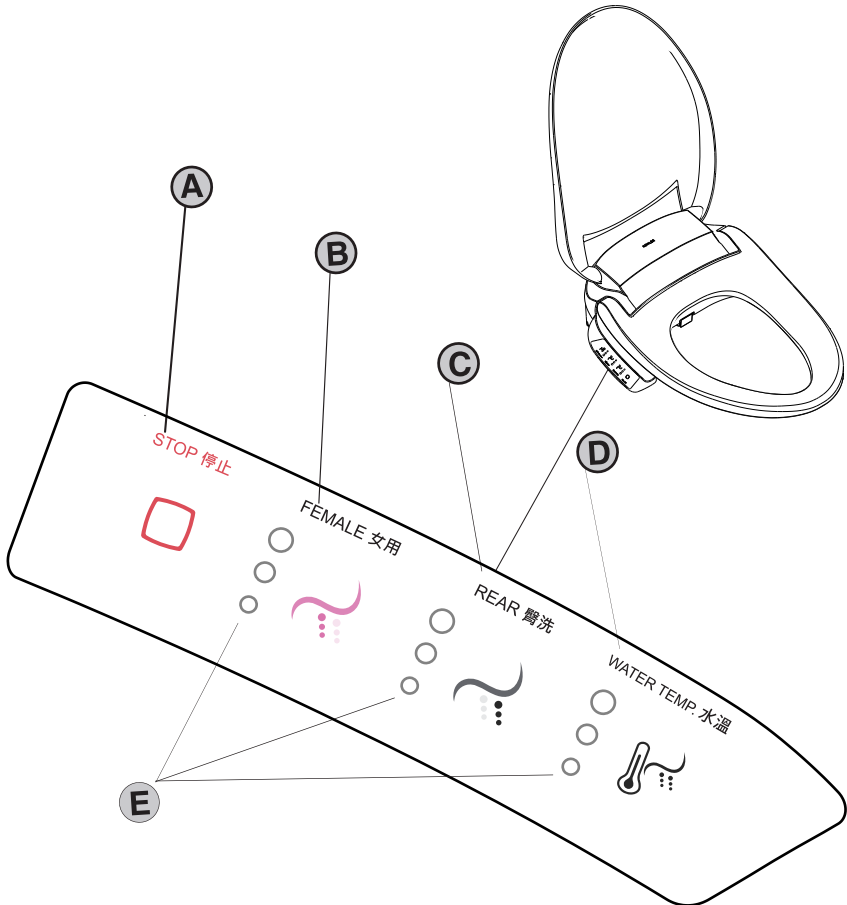

# Operation

## □ A - STOP

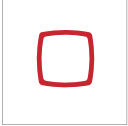

When WASH function is ON, press button to terminate WASH function.

## □ B - Female wash



Press female wash when user seat on, activate female wash (female only) and display current wash strength.

Continue press female wash to exchange spray strength when female wash function is ON. The strength shall circulate per "min dial, mid dial, max dial, mid dial" sequence.

Auto stop after continuous washing for 5min.

## □ C - Rear wash



Press rear wash when user seat on. Activate rear wash and display current wash strength.

Continue press rear wash to exchange spray strength when rear wash function is ON. The strength shall circulate per "min dial, mid dial, max dial, mid dial" sequence.

Auto stop after continuous washing for 5min.

The Bidet is equipped with wide oscillate function. If you want to use wide oscillate function, please hold REAR + STOP button both for 2s after REAR wash is activated.

## □ D - Water temp



Press WATER TEMP button to set spray water temperature per OFF, low, mid, high, mid circulation when press button each time.

Set water temp and switch water temp parameter indicator ON.

If it is under OFF status, LED indicator is OFF.

## □ E - Dial indication

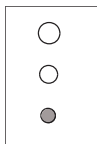

**Low**  
Small light  
ON

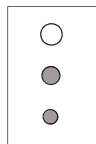

**Mid**  
Small light ON  
Mid light ON



**High**  
Small, mid &  
big lights all  
ON







## TEST THE FUNCTIONS

- Wrap toilet seat with plastic sheet to prevent water splash from the toilet during testing.
- The seat is activated by user sitting. To activate the seat controls for testing purpose, facing the toilet first, then hold seat from right front edge about 1/2 position by hand, hear the seat on right side of the rotating shaft generate one “click” (gravity induction).

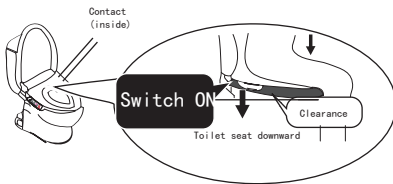

- The contact might not be activated if customer does not sit all way in.



Note:

- It is difficult to activate contact for light weight children.
- There's clearance between seat bumper to toilet due to moveable structure design.
- Proceed to the “Control Panel” and “Operation” selection to test the various seat functions.

# CARE AND CLEAN

**For best results, keep the following in mind when caring for your KOHLER products.**

**IMPORTANT! Do not immerse product in water.**

- **TEST** – Always test your cleaning solution on an inconspicuous area before applying to the entire surface.
- **DO NOT IMMERSE WITH DETERGENT** – do not immerse product with detergent.
- **AVOID ABRASIVE MATERIAL** – use a soft dampened sponge or cloth. Never use an abrasive material such as a brush or scouring pad to clean surface.
- **CLEAN** – Wipe away any cleaner immediately after cleaner application. Wipe away and dry any overspray that lands on nearby surface.

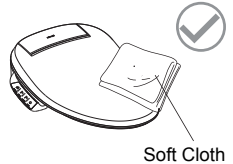
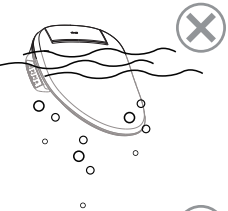

## CLEAN SEAT

- Do not use abrasive detergent and sterilizing aerosol spray products

Caring indication: use detergent and water mixture or any other detergent listed for seat cleaning products to clean seat; use a soft, dampened sponge or cloth. Wipe away and dry with soft towel, natural dryer seat in the air.

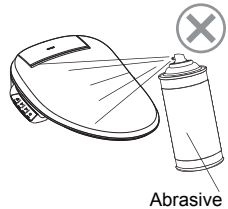

- No corrosive chemical products or cosmetics (such as nail polish or aftershave solution) allowed contacting with seat to avoid surface damage.

**NOTE:** disobey these cleaning instructions could void the Kohler warranty.



**NOTE:** cleaning process success shall be determined by water hardness and temperature, accurate component quantity, cleaning specification modification

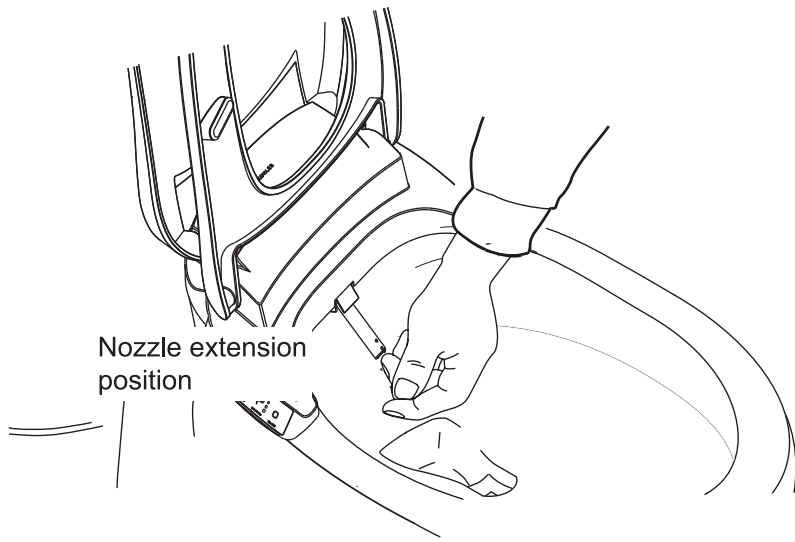

## CLEAN THE SPRAY WANDS

Note: The spray wands can only be extended for cleaning when the set is unseated.

- Raise the cover and seat.
- Hold "female wash or rear wash" button, clean the spray wand with a soft-bristled brush after wand extended completely.
- Hold "female wash or rear wash" button after nozzle cleansing; wand retracts or wait for wand to auto retract.

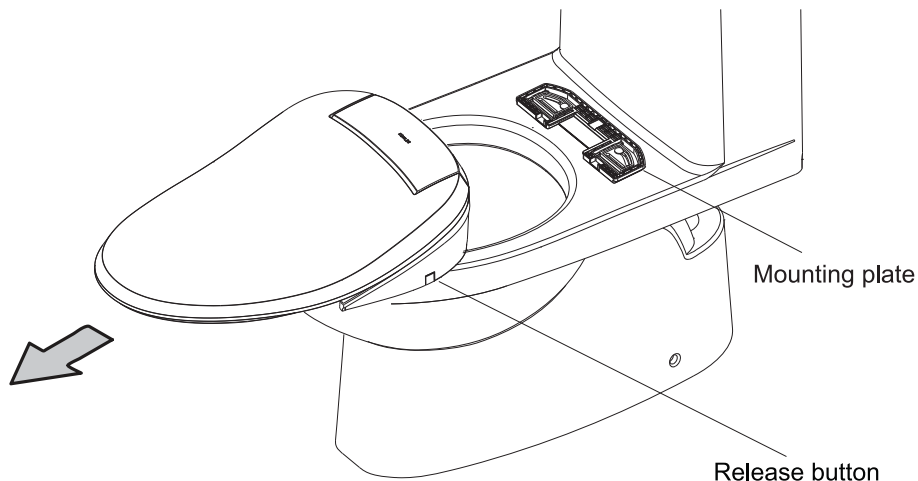

## REMOVE THE SEAT

- Turn off the water supply.
- Flush the toilet to relieve any pressure from the water supply hose.
- Unplug the seat from the electrical outlet.
- Disconnect the water supply hose from the T-valve.
- Push in the release button.
- Slide the seat forward to disengage the seat from the mounting plate.

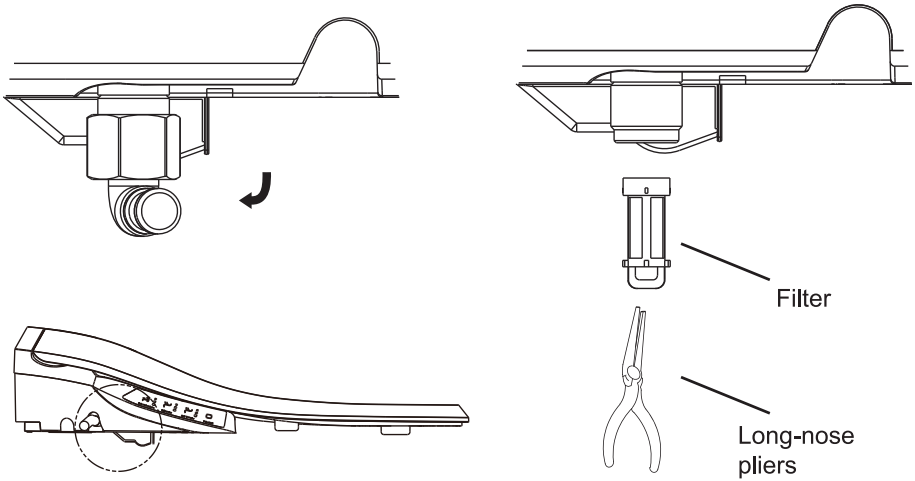

## CLEAN THE FILTER

**IMPORTANT! Risk of product damage.** Please service carefully to avoid any connector damage.

Please clean the screen timely while the water volume is reduced or not water comes out

- Turn off the water supply.
- Press “RELEASE” button, slide the seat forward to disengage the seat from the mounting plate.
- Disconnect the water supply hose from the seat.
- Dismantle seat cover water supply hose.
- Remove filter from product water inlet by long-nose pliers (as shown).
- Clean the filter with a soft-bristled brush.
- Reinstall the filter.
- Align threads; reinstall seat cover water supply hose.
- Check all connections for leaks and make any adjustment as needed.
- Turn on the water supply.

## MAINTENANCE IN CASE OF LONG-TERM IDLE STATUS

- When the bidet seat will be idle for a long term, please disconnect the power plug, and turn off the tee valve, detach the water inlet pipe and make sure the water inside the inlet pipe is drained completely.
- Before use after long term idle condition, make sure to wash it for several times and the inner pipelines are clean.

# TROUBLESHOOTING

This troubleshooting guide is for general aid only. A Kohler Authorized Service Representative should correct any electrical problems. For warranty service, contact your dealer or wholesale distributor.

## General Functions

| Symptoms  | Probable Causes   | Recommended Action  |
|---|---|---|
| 1. Function are not working.                          | <p>A. Power failure occurred.</p> <p>B. The power cord is disconnected.</p> <p>C. Ground-Fault Circuit Interrupt (GFCI) may be tripped.</p> <p>D. User does not enter detecting zone.</p> <p>E. Thermal protector auto protection activated.</p> <p>F. None of the above actions correct the symptom.</p> | <p>A. Wait until the power is restored.</p> <p>B. Insert the power cord into an electrical outlet.</p> <p>C. Reset the GFCI and locate the problem.</p> <p>D. Contact seat detecting zone.</p> <p>E. Place product within ambient temperature for some time.</p> <p>F. Contact a Kohler Service Representative.</p> |
| 2. Water does not spray out of spray wands or nozzle. | <p>A. Seat does not detect user.</p> <p>B. Water supply stop closed.</p> <p>C. Water supply screen clogged.</p> <p>D. None of the above actions correct the symptom.</p>  | <p>A. Contact seat detecting zone.</p> <p>B. Turn off power supply, eliminate water supply failure, reload power.</p> <p>C. Refer to "CLEAN THE SCREEN" section.</p> <p>D. Contact a Kohler Service Representative.</p>   |

## Cleansing Functions

|   |  |  |
|---|--|--|
| 3. The water pressure is low.                                       | <p>A. The screen is clogged.</p> <p>B. Insufficient water supply pressure.</p>                                       | <p>A. Refer to "CLEAN THE SCREEN" section.</p> <p>B. Raise water pressure to product required water pressure range.</p>            |
| 4. Water stops flowing from the spray wand before finish cleansing. | <p>A. Spray function auto stop after 5min continuous spray.</p> <p>B. The seat sensor is not detecting the user.</p> | <p>A. When necessary, press CLEAN button again.</p> <p>B. Refer to activating the seat information in "FUNCTION TEST" section.</p> |

## TROUBLESHOOTING (cont.)

### Cleansing Functions

| Symptoms                                 | Probable Causes  | Recommended Action    |
|--|--|-----------------------|
| 5. Dripping water from side wand hole.   | A. Product internal high water pressure protection.                                    | A. Normal phenomenon. |
| 6. Dripping water from wand when sit on. | A. Auto discharge internal residual water within wand when nobody use for a long time. | A. Normal phenomenon. |

### Slow Close Cover

| Symptoms  | Probable                           | Recommended Action    |
|---|------------------------------------|-----------------------|
| 7. The speed of the seat and cover closure varies in summer and winter. | A. Due to room temperature change. | A. Normal phenomenon. |

### Seat Sensor

| Symptoms  | Probable  | Recommended Action                                |
|---|---|---|
| 8. Clean function operate when press the CLEAN button while seat is unseated. | A. The seat sensor is covered by an heavy object.                                       | A. Remove heavy object from the seat sensor area. |
| 9. Even sit on, CLEAN function does not work.                                 | A. The seat sensor might not be able to detect you depending on the way you're sitting. | A. Change the way you sit.                        |

### Others

| Symptoms            | Probable   | Recommended Action                           |
|---------------------|--|--|
| 10. The seat moves. | A. The bolts for the mounting plate that secure the main unit are loose. | A. Tighten the bolts for the mounting plate. |



# Service Parts K-18751TW-0

