

Operational Principle

The health secrets of Exhale+ Shower Filter are hidden in its filter element. Its main components are KDF55 and VC.

KDF55 is a filtration material imported from the United States. It removes chlorine, heavy metals from water. KDF water filtration media utilize the principle of electrochemical oxidation reduction, commonly known as the redox process, to eliminate a vast number of water contaminants.

VC filter material is food-graded material. It removes free chlorine from water efficiently. Effectively protect health of skin and hair of consumer.

NOTES

- 1 Observe local plumbing codes.
- 2 Flush the water supply pipes thoroughly to remove debris.
- 3 Before using filtered water for the first time, run water with the handle wide open to remove debris in pipes and the filter, until the water is clear and clean.
- 4 For proper performance of the filter, the water pressure should be between 0.1MPa(1 bar) and 0.8MPa(8 bar). The water temperature should be between 3°C and 60°C. The ambient temperature should be between 0°C and 49°C.
- 5 Water purification capacity is 30,000L.
- 6 To ensure water purification efficiency, the filter should be replaced periodically. Generally, the filter replacement cycle is every 6 months.
- 7 If the filter is unused for a long time, rinse the filter completely to ensure the water quality.
- 8 If hose is not long enough, we prepared a 75cm smooth hose for your convenience(Sku no: 1271217-CP). You could buy it in Kohler Tmall store.

OPERATION INSTRUCTION

How to Install the Filter

- 1 Unscrew the cap(1) from filter. Pull out the cap(2) from filter. Unscrew the filter cap(3), adjust the timer(4), align the month on the timer with the mark(5) as shown.
(NOTE: The number indicates the month that the filter needs to be replaced.)

Align the orange mark in the filter with the orange mark in the filter cap. Push the filter cap upwards while turning it about 60 degrees, until it clicks.

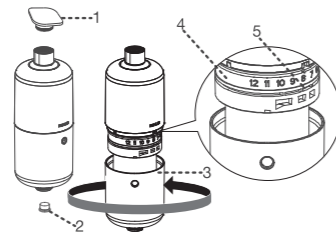

- 2 Unscrew the hose(6) from the faucet. Flush water supply thoroughly to remove debris. Shut off the faucet.

Connect the filter kit(7) to the faucet connector(8) and tighten with a wrench. Attach the hose to the filter bottom. Put the screen washer(9) into the hose, and install the regulator(10) into the handspray(11). Connect the handspray and hose.

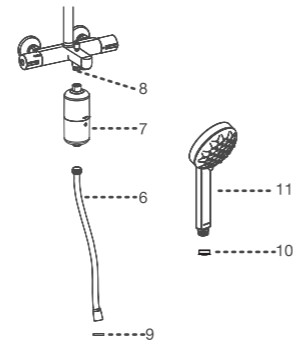

How to Replace the Filter

- 3 Turn off the faucet, turn the filter cap about 60 degrees and remove the filter cap and filter.



- 4 Unscrew the protection cap(12) & (13) from new filter. Replace the filter when needed. Insert a new filter, and discard the used one. Adjust the number on the timer(4), and reinstall it as step 1. (Note: The installation direction of the filter is shown in the figure.)

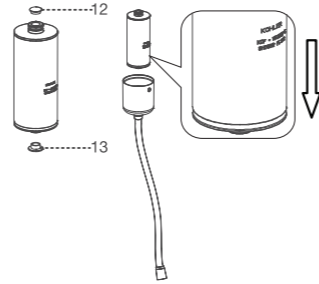

CLEANING INSTRUCTIONS

All Finishes:

Clean the finish with mild soap and warm water. Wipe the entire surface completely dry with clean, soft cloth. Many cleaners such as ammonia, chlorine and toilet cleaners may contain chemicals which could adversely affect the finish and are not recommended for cleaning this product.

Do not use abrasive cleaners or solvents on Kohler faucets and fittings.

工作原理

随心雨林浴净化器的健康秘密藏在它的滤芯里，它的主要成分是KDF55以及VC。

KDF55*可以去除水中的重金属离子，当自来水遇到了KDF55*，就会发生一系列电化学反应，把这些本来溶解在水里的重金属离子变成不溶于水的成分，然后阻隔在滤料表面。此外，将水中的氧化氯（俗称余氯）氧化还原成对人体无害的离子。

KDF55*：获得美国国家卫生基金会（NSF）认证，可以有效去除水中余氯。

VC滤材，食品级原材料，高效去除水中游离氯，有效保护用户的皮肤和毛发健康。

! 注意事项

- 1 遵守当地管路安装条例。
- 2 一定要先彻底冲洗供水管以清除管道中的杂质。
- 3 对于首次使用过滤水，建议您将水流开到最大程度，用大流量的水来清洗管道和净化器，直至水变得清澈干净。
- 4 为了确保设备正常运转，建议进水压力0.1MPa（1 bar）~0.8MPa（8 bar），温度3°C~60°C 环境温度 0°C~49°C。
- 5 净化器的净水处理量为 30000L。
- 6 滤芯更换周期：6个月。要定期更换滤芯，以确保水处理的效果。
- 7 如果长期搁置不用，当恢复使用时，要充分用水冲洗。
- 8 如果您家中的软管不够长，我们为您准备了一根75cm的防缠绕软管（产品型号：1271217-CP）。您可以到科勒天猫旗舰店购买。

安装步骤

如何安装净化器

- 1 将保护盖（1）从净化器上端旋下来，将保护盖（2）从净化器下端拔出来，将净化器盖（3）拧下，调整数字计时环（4），使要调整的数字对齐净化器上的橙色标识（5）。
(注意：数字表示要更换滤芯的月份。)

将净化器上的橙色标识对准净化器盖顶端面的橙色标识，并把净化器盖往上推，同时旋转约60°，直到“咔”一声。

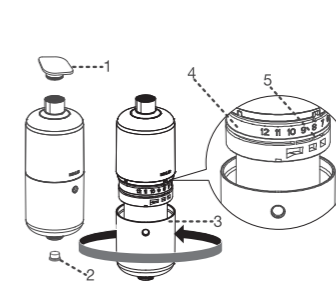

- 2 将软管（6）从龙头接头上拧下来。打开龙头约一分钟冲洗掉杂质，关闭龙头。
将净化器组件（7）连接到接头（8）上，并拧紧。再将软管连接到净化器底部。将垫片（9）放到软管内，限流器（10）放到花洒（11）内，连接花洒和软管。

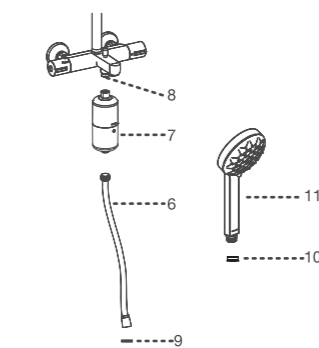

如何更换滤芯

- 3 当滤芯需要更换时，关闭龙头，将净化器盖旋转约60°，向下拔出净化器盖和滤芯。

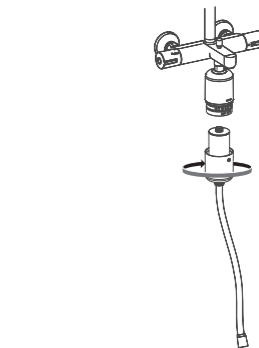

- 4 把新滤芯的保护盖（12）和（13）分别从滤芯两端拔出。拔出滤芯，更换新的滤芯。再按步骤1中的方法调整数字计时环（4）然后装回净化器（注意：滤芯安装方向如图所示）。

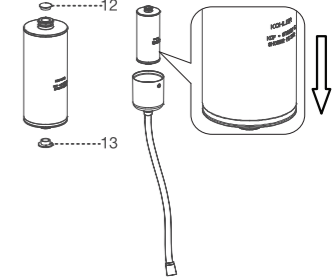

清洗说明

适用于所有加工处理过的表面：

以中性肥皂水清洗镀层表面，再以干净软布彻底擦干整个表面，许多清洁剂，比如氨水、去污粉及洁厕灵等，会对电镀表面造成伤害，切忌使用。

有磨损性的清洁用具或清洁剂也不可适用于科勒牌的水龙头及其配件上。

KOHLER

维C净化，一触倾心

我们尽可能地还原水的纯净，再度升级淋浴时的水质净化和美容物质添加方案，科勒EXHALE+随心雨*淋浴净化器，有效去除水中的杂质、余氯*、重金属*，为肌肤和秀发带来细腻呵护。并增加维生素C，抗氧化并唤醒肌肤活力。让您体验纯净沐浴的清新健康之美。

PURE BLISS

We updated Exhale+ Shower Filter from just KDF to KDF + VC. Water is filtered from KDF and VC powder helping remove even more chlorine for a more healthy and beautiful feeling.

安装尺寸 ROUGH-IN DIMENSIONS

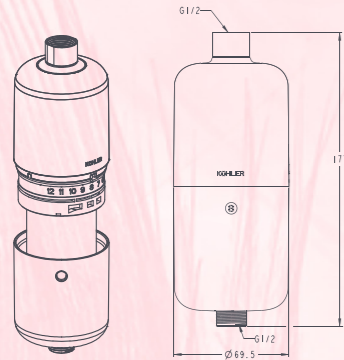

余氯*：采用滤料KDF55，获得美国国家卫生基金会 (NSF) 认证，可以有效去除水中余氯。

重金属*：采用滤料KDF55，获得美国国家卫生基金会 (NSF) 认证，可去除水中铅、汞等可溶性重金属离子。

设计灵感

我们中的大多数都在追寻极致之美、健康的本源和自信之力。感受水的纯净，并让它带你远离尘世喧嚣。随心雨*淋浴净化器延续其一脉相承的设计理念，却更着力于赋予使用者优雅精致的观感。趋于柔和的线条和外观让人感受到冬日暖阳般的和煦，如清风拂面般怡然，令人心生向往。

DESIGN STORY

We desire to be more beautiful, healthier, confident. Feel the clear water and escape with cleaner water. Exhale+ Shower Filter is a continuation of the its original version. It tries to give people a more elegant feeling. Softer curvature for a more approachable and caring aesthetic.

有效净化
纯净清新



PURIFIED WATER
PROTECTS YOUR
DELICATE SKIN
AND HAIR



缓释维生素C，唤醒肌肤活力。

内含KDF55能有效净化水质，去除水中杂质、余氯、重金属，让淋浴回归自然。

Delay released vitamin C, brings out the vitality and energy of skin.

The Exhale+ Shower Filter transforms your water into the nature's clearest water by removing impure materials such as heavy metals, rust, silt and chlorine.

精致小巧
优雅简约

SLIM AND
COMPACT
ELEGANT
DESIGN



适配科勒淋浴龙头

Works with most
Kohler shower products

契合您的家居风格

Goes with every
bathroom décor

贴心提醒
随心易用

INTUITIVE
REMINDER
SIMPLE
AND EASY

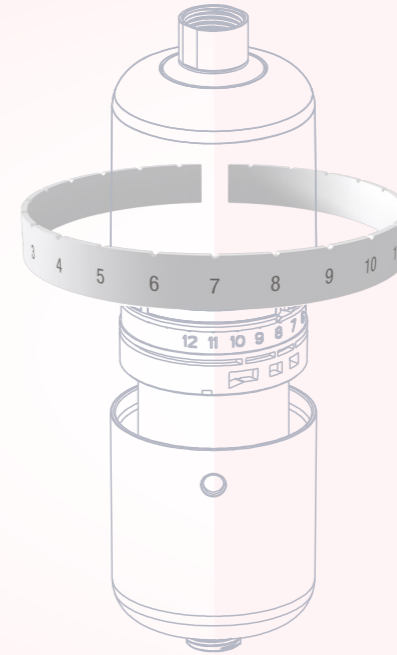

贴心直观的提醒设计，便捷记录滤芯安装使用时间，帮助及时更换。

The 12 numbers represent the 12 months of a year. You can set the start or end month number to record the filter lifetime.

广泛兼容科勒淋浴产品，安装简易，无需额外工具，即装即用，更换滤芯也同样便捷。

The simple and elegant design matches most Kohler shower products. The filter is easy to install and replace filter without any tool and ready to use immediately after installation.

有效净化，纯净清新
缓释维C，焕亮肌肤
精致小巧，优雅简约
贴心提醒，随心易用

**Purified water
Delay released Vitamin C
Elegant and compact design
Intuitive reminders**

KOHLER®



科勒 exhale⁺

随心雨⁺淋浴净化器
EXHALE⁺ SHOWER FILTER

exhale⁺
随心雨⁺淋浴净化器
R21812T-CP EXHALE⁺ SHOWER FILTER

安装说明书

安装之前

所有的资料是按最新发布的产品资料编写而成。科勒公司保留任何时候不经通知即可改变产品特性、包装或产品可供类型的权利。

说明书包括重要的安装、保养及清洁方面的内容，请把这些资料交给用户阅读。

INSTALLATION INSTRUCTIONS

BEFORE YOU BEGIN

All information is based on the latest product information available at the time of publication. Kohler Co. reserves the right to make changes in product characteristics, packaging, or availability at any time without notice.

Please leave these instructions for the consumer. They contain important information.