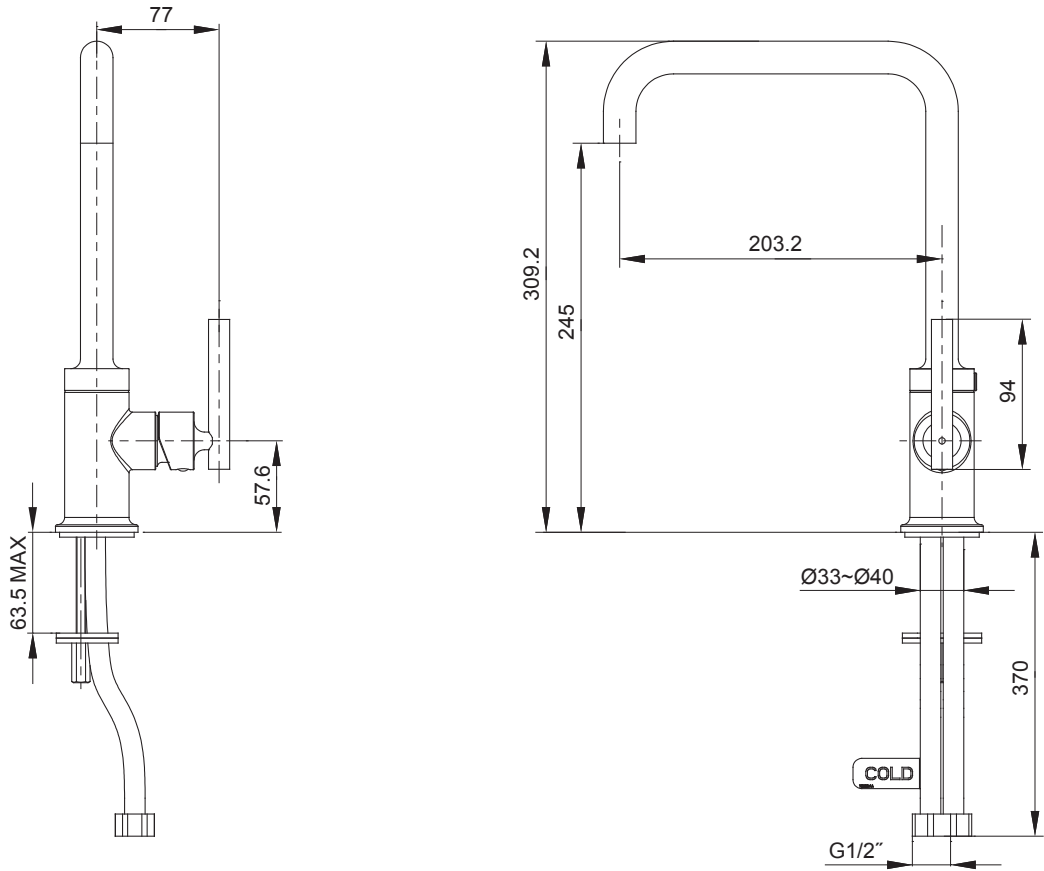

7507T-B4 Single Hole Kitchen Faucet
BEFORE YOU BEGIN
<p>All information is based on the latest product information available at the time of publication. Kohler Co. reserves the right to make changes in product characteristics, packaging, or availability at any time without notice.</p> <p>Please leave these instructions for the consumer. They contain important information.</p> <p>NOTES:</p> <p>1. Flush the water supply pipes thoroughly to remove debris.</p> <p>2. If possible, install this faucet before installing sink.</p>
HANDLE OPERATION
Lift the handle gently. Turn clockwise for cold water; turn counter-clockwise for hot water.
ROUGH-IN DIMENSIONS

INSTALLATION

How to Install the Faucet

Install the mounting stud(1) into the faucet body base(2). Stick the washer(3) under the body assembly. Insert the flexible supply hoses(4) into the sink.

From underside of the sink, place the washer(5) (rubber washer is on the top) and the nut(6) onto mounting stud. Position the faucet so that the handle is on the right side. Tighten nut to secure faucet to the sink.

Attach the hoses to water supplies. When facing the faucet, the hose in front connects to hot water, the back hose with 'COLD' label connects to cold water.

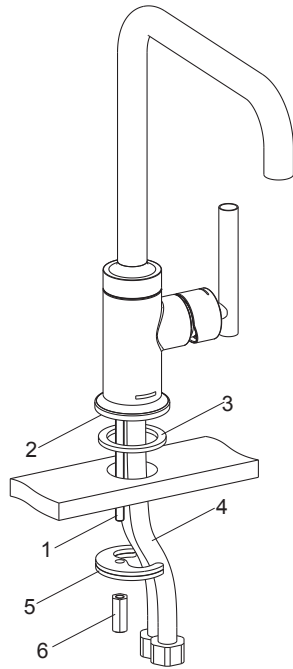

INSTALLATION CHECKOUT

Ensure that all connections are tightened and the handle is in the off position.

Open the drain. Turn on main water supply and check for leaks. Repair as required.

Remove the aerator(8) with the key(7). Turn the faucet handle on. Run hot and cold water through the spout for about one minute to remove any debris. Remove debris from the aerator. Shut off the faucet and reinstall the aerator.

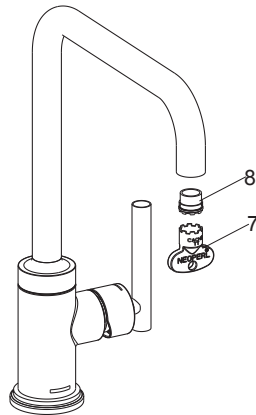

CLEANING INSTALLATIONS

All Finishes: Clean the finish with mild soap and warm water. Wipe entire surface completely dry with clean soft cloth. Many cleaners may contain chemicals, such as ammonia, chlorine, toilet cleaner etc, which could adversely affect the finish and are not recommended for cleaning.

Do not use abrasive cleaners or solvents on Kohler faucets and fittings.

"LEAD FREE" is marked on the back of the faucet signifying its compliance with the United States AB1953

7507T-B4 Single Hole Kitchen Faucet

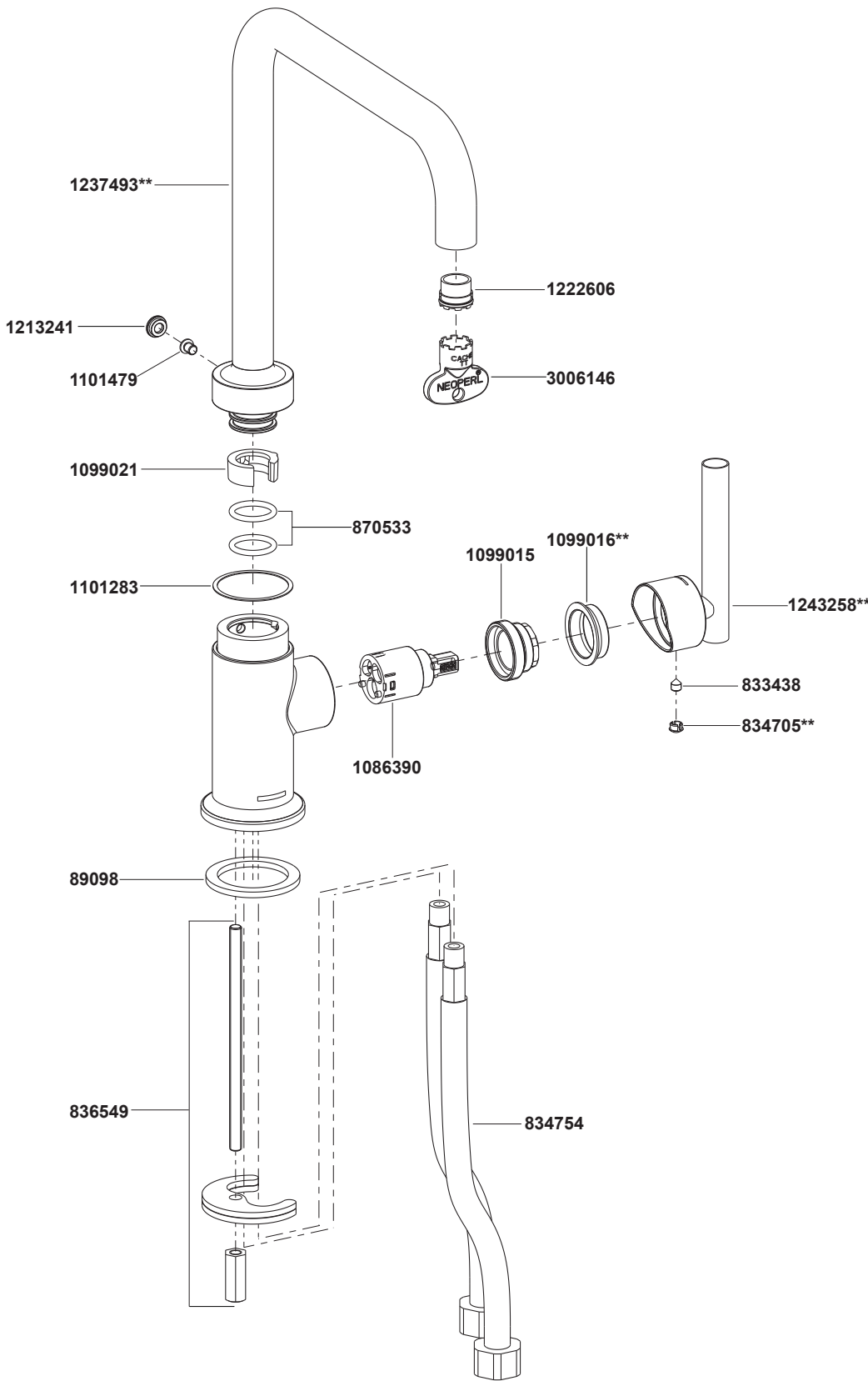

**Color code must be specified when ordering