

99175T-4 Pull-out Kitchen Faucet
<div>BEFORE YOU BEGIN</div> <div>All information is based on the latest product information available at the time of publication. Kohler Co. reserves the right to make changes in product characteristics, packaging, or availability at any time without notice.</div> <div>Please leave these instructions for the consumer. They contain important information.</div> <div>NOTE:<div>1. Flush the water supply pipes thoroughly to remove debris.</div><div>2. For new installations, assemble the faucet to sink before installing.</div><div>3. The highest working pressure for handspray & shower head is 0.5MPa(5 bar). If it exceeds 0.5MPa(5 bar), a pressure reducer is needed. The highest water and environment temperature is 60 °C. Please keep handspray, shower head and the shower arm away from heater, or it may become damaged and cause injury to the user.</div></div>
<div>HANDLE OPERATION</div> <div>Open the handle gently. Turn clockwise for cold water, turn counter clockwise for hot water.</div>
<div>ROUGH-IN DIMENSIONS</div> <div><p>The technical drawing illustrates the rough-in dimensions for the Kohler Aleo 99175T-4 pull-out kitchen faucet. It includes two views: a front view on the left and a side view on the right. The front view shows the faucet's base with a mounting hole diameter of Ø46 and a mounting hole spacing of Ø35~Ø40. The base height is 114, and the spout height is 156. The spout diameter is Ø25, and the spout offset is 88. The base width is 64. The side view shows the faucet's profile with a total height of 743. The spout height is 257, and the spout offset is 221. The spout diameter is Ø25, and the spout offset is 123. The spout angle is 5°. The base width is 235. The base height is 63 Max. The base connection is G1/2".</p></div>

INSTALLATION

Slide the washer(1) into the groove of the body(2) through the shank(3). Put the faucet body kit into the mounting hole of the sink. Let the bottom of the body against the deck.

Screw two screws(4) into the threaded ring(5). From underside of the sink, place and tighten the washer(6), the metal washer(7) and threaded ring with two screws onto the shank. Position the faucet so that the handle is on the right side. Tighten two screws to secure faucet to sink.

Connect the hoses(9) with the two shorter copper pipes(8). The hose which connects copper pipe with “COLD” label is for cold water. Attach the hoses(9) to water supplies.

Put the brass weight(10) and clip(12) onto the hose assembly(11). Connect the hose assembly(11) and copper pipe(14) with connector(13). Adjust and position the brass weight and clip. **Note:** Don't over distort the hoses. Please avoid the wrong installation for the brass weight and clip as below.

Try to pull out the spray, check whether it can go back to its original position smoothly or not. If not, position the brass weight again.

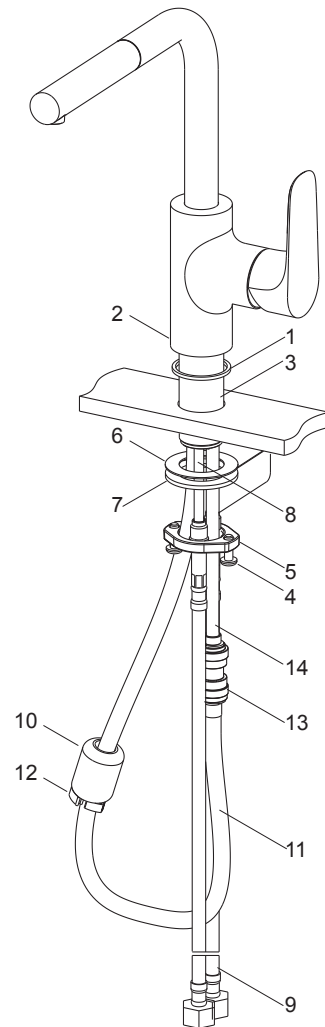
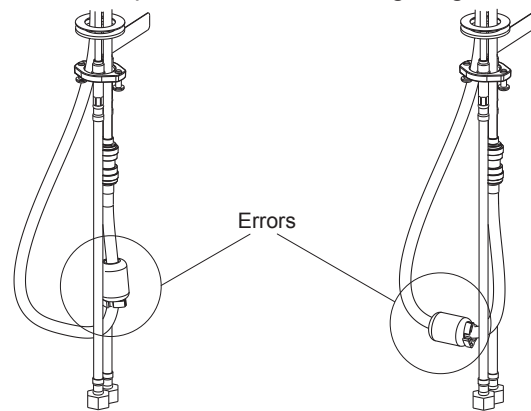

INSTALLATION CHECKOUT

Ensure that all coupling nuts are tight. Ensure that the lever handle is in the off position. Turn on the main water supply and drain, and check for leaks. Repair as needed.

Remove the aerator(15). Turn on the faucet, run hot and cold water for about one minute to remove any debris. Remove any debris from the aerator. Shut off the faucet. Reinstall the aerator.

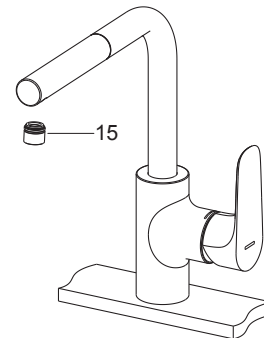

CLEANING INSTRUCTIONS

All Finishes: Clean the finish with mild soap and warm water. Wipe entire surface completely dry with clean soft cloth. Many cleaners may contain chemicals, such as ammonia, chlorine, toilet cleaner etc, which could adversely affect the finish and are not recommended for cleaning.

Do not use abrasive cleaners or solvents on Kohler faucets and fittings.

"LEAD FREE" is marked on the back of the faucet signifying its compliance with the United States AB1953

KOHLER®
SERVICE PARTS

ALEO

99175T-4 Pull-out Kitchen Faucet

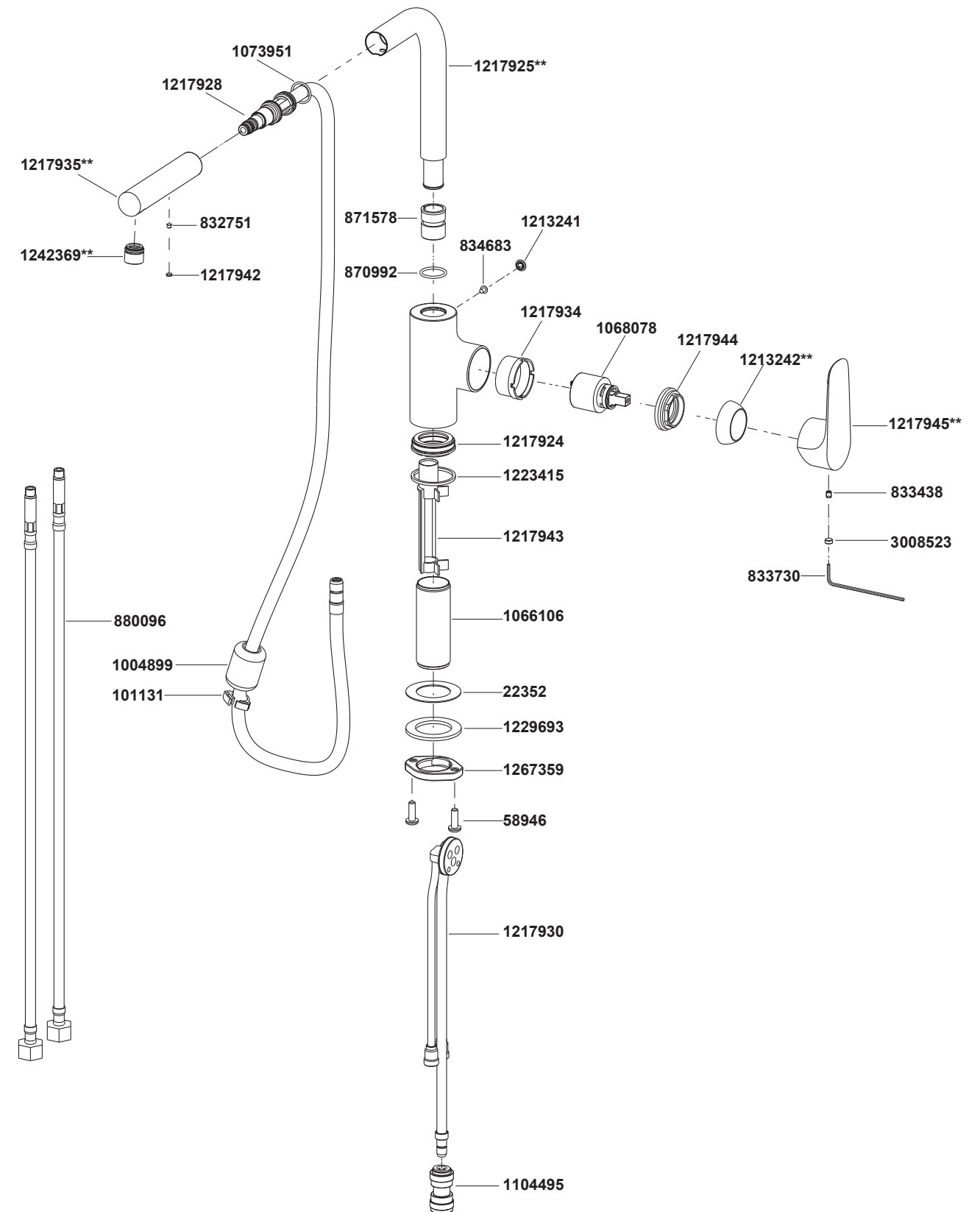

****Color code must be specified when ordering**