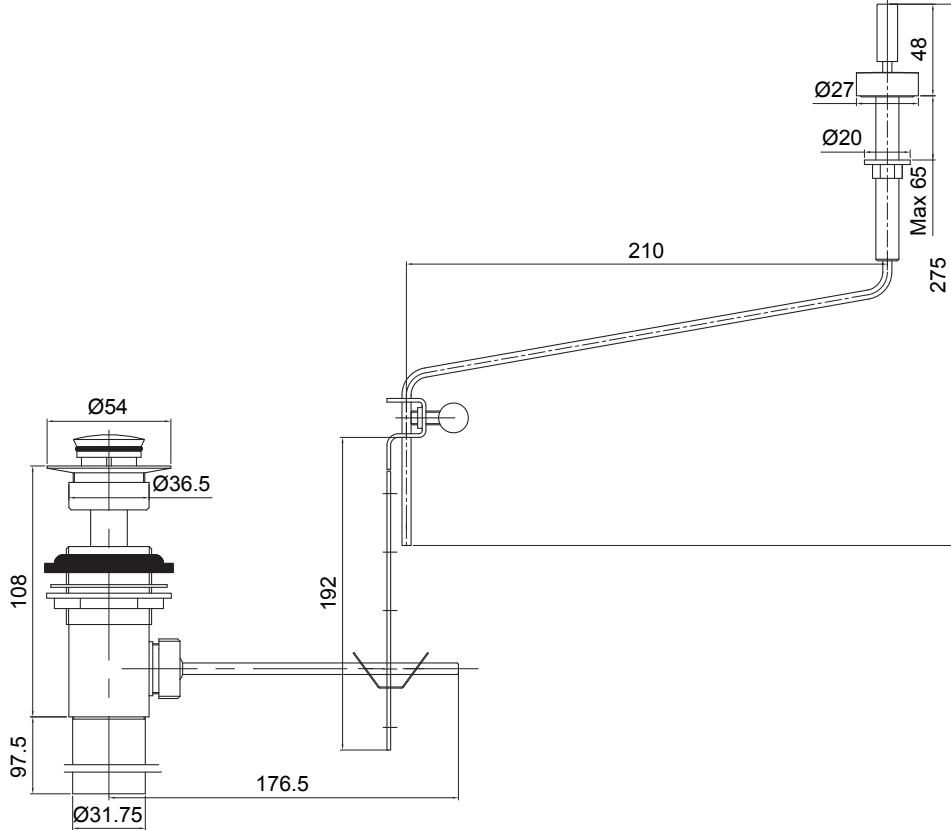

KOHLER®

INSTALLATION INSTRUCTIONS

安装说明书

Deck-Mount Pop-Up Drain

11679T 台面式提拉落水	
安装之前	BEFORE YOU BEGIN
<p>所有的资料是按最新出版的产品资料编写而成。科勒公司保留任何时候不经通知即可改变产品特性、包装或产品可供类型的权利。</p> <p>说明书包括重要的安装、保养及清洁方面的内容，请把这些资料交给用户阅读。</p> <p><b>注意事项：</b></p> <ol style="list-style-type: none"><li>1. 遵守当地管路安装条例。</li><li>2. 关闭主供水源。</li><li>3. 尽可能在安装面盆之前安装水龙头。</li></ol>	<p>All information is based on the latest product information available at the time of publication. Kohler Co. reserves the right to make changes in product characteristics, packaging, or availability at any time without notice.</p> <p>Please leave these instructions for the consumer. They contain important information.</p> <p><b>NOTES:</b></p> <ol style="list-style-type: none"><li>1. Observe local plumbing codes.</li><li>2. Shut off the main water supply.</li><li>3. If possible, install this drain before installing the lavatory.</li></ol>
使用说明	HANDLE OPERATION
按压提拉头，打开排水。	Press the button to open the drain.
安装尺寸	ROUGH-IN DIMENSIONS
 <p>The technical drawing illustrates the Deck-Mount Pop-Up Drain from two perspectives: a top view and a side view. The top view shows a circular drain with a central button. Key dimensions include a top diameter of Ø54, a button diameter of Ø36.5, and a base diameter of Ø31.75. The height from the base to the top of the button is 108. The side view shows the drain's profile, with a total height of 192 and a base width of 176.5. A side view of the drain pipe shows a horizontal section of 210, a vertical section of 275, and a maximum depth of 65. The pipe has a diameter of Ø20 and a top diameter of Ø27. A final dimension of 48 is shown at the very top of the pipe assembly.</p>	

安装步骤

将螺母(1)和垫片(2)从提拉杆组件(3)上拆下。将O型圈(4)嵌入装饰盖(5)底部凹槽，然后将提拉杆组件插入面盆安装孔中。从台面下方重新装回垫片和螺母，但不拧紧螺母。

将止水塞(6)、法兰盘(7)及垫片(8)从排水本体(9)上取下，在法兰盘底面套上垫片。将尾管(10)从排水本体上取下。在尾管螺纹处缠绕足以密封的密封胶带或涂合适的密封胶，将排水本体装回。把排水本体带垫圈(11)、钢垫(12)及锁紧螺母(13)从面盆下方插入，排水杆洞口(14)朝后方。

**注意：**如果需要，可直接在排水器法兰盘(7)底面沿周围涂一圈密封油灰，而不使用垫片(8)。

把排水器法兰盘旋入排水本体中。从下方用手拧紧锁紧螺母。把止水塞放入排水本体中，调整以使止水塞末端孔(15)靠近并对正排水杆的洞口。

将固定螺母(16)取下，把塑料垫圈(17)及固定螺母装在球杆(18)上，再把球杆组件插入排水杆的洞口中并穿过止水塞，拧紧固定螺母。

确保球杆指向面盆后方，并拧紧排水本体上的锁紧螺母，去除多余油灰。

**注意：**在锁紧螺母拧紧后，不可调整排水本体的位置，否则会破坏油灰密封。

用“V”形夹(19)将联杆(20)连接到球杆组件上，将提拉杆(21)插入联杆孔，使装饰盖(5)紧贴台面，提拉头(22)紧贴限位器(23)。

将球杆下推到排水器全开的位置。拧紧手捻螺丝(24)。拧紧螺母(1)。取下限位器并丢掉。

INSTALLATION

Take off the nut(1) and the washer(2) from the lift rod kit(3). Put the o-ring(4) into the groove on the bottom of the escutcheon(5). Insert the lift rod kit into the installing hole of lavatory. Reinstall the washer and the nut, but don't tighten the nut.

Take off the stopper(6), drain flange(7) and washer(8) from drain body(9). Slide washer onto the underside of the drain flange. Take off the tailpiece(10) from the drain body. Supply enough tape or sealant to tailpiece thread. Reinstall the tailpiece. With the gasket(11), steel washer(12) and locknut(13) on the drain body, insert it into the bidet from underside with the drain lever hole(14) facing the rear.

**NOTE:** If needed apply a ring of plumbers putty around the underside of the drain flange(7), instead of using washer(8).

Thread the drain flange onto the drain body. Tighten the locknut by hand from the underside. Place stopper into drain body aligning the flat side of stopper hole(15) with the drain lever hole.

Remove the retaining nut(16). Fit the plastic washer(17) and retaining nut onto the ball lever(18). Insert the ball lever assembly into the drain lever hole and through the stopper hole. Tighten the retaining nut.

Be sure that the ball lever rod points to the back of the bidet, tighten the locknut on the drain body. Remove any excess putty.

**NOTE:** Do not reposition the drain after the locknut is tightened, or you may break the putty seal.

Connect the link(20) onto ball lever rodwith "V"-clip(19). Insert the lift rod (21) into the link of the drain. Keep the escutcheon(5) against the lavatory panel, and the lift knob(22) against the stopper(23).

Push the ball lever rod down to the open position. Tighten thumb screw (24). Tighten the nut(1). Remove and discard the stopper.

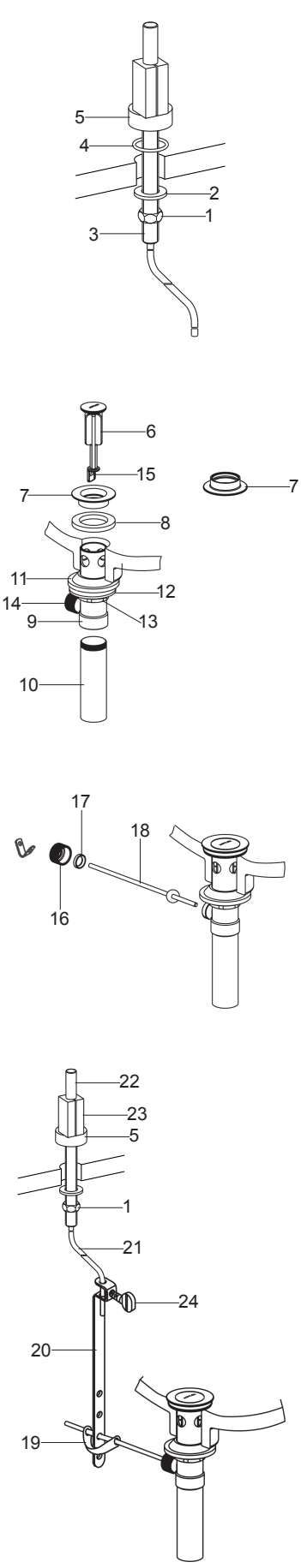

清洗说明

适用于所有加工处理过的表面：以中性肥皂水清洗镀层表面，再以干净的软布彻底擦干整个表面，许多清洁剂，比如氨水、去污粉及洁厕灵等，会对电镀表面造成伤害，切忌使用。

有磨损性的清洁用具或清洁剂也不可使用于科勒牌的水龙头及其配件上。

CLEANING INSTRUCTIONS

All Finishes: Clean the finish with mild soap and warm water. Wipe entire surface completely dry with clean soft cloth. Many cleaners may contain chemicals, such as ammonia, chlorine, toilet cleaner etc, which could adversely affect the finish and are not recommended for cleaning.

Do not use abrasive cleaners or solvents on Kohler faucets and fittings.

零件图

SERVICE PARTS

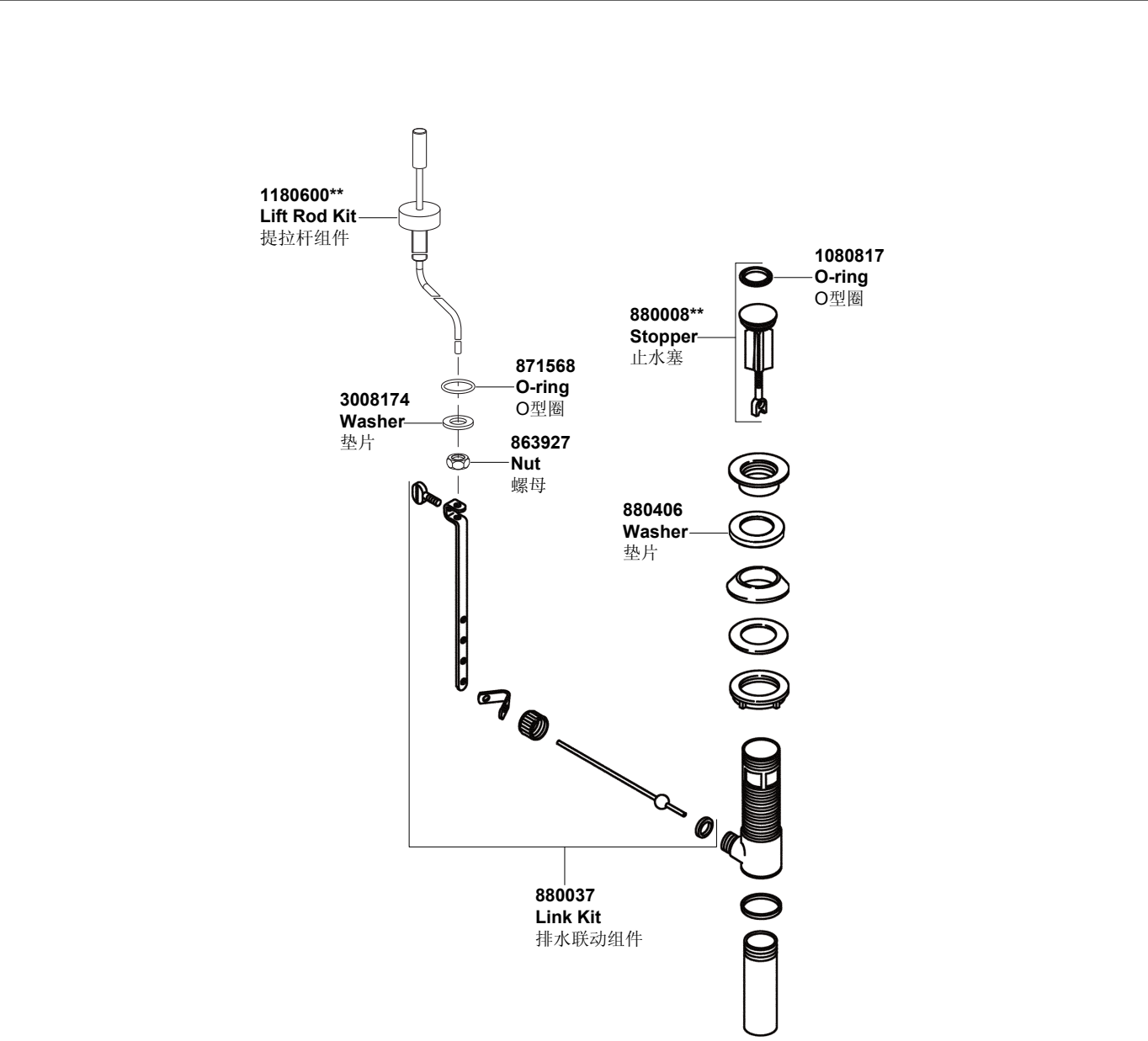

\*\*订购时请说明颜色编号  
\*\*Color code must be specified when ordering