

FEATURES

- Solid metal construction for durability and reliability
- Easy installation and bulb maintenance
- Night Light
- Complements Kallista Transitional Collections

CODES/STANDARDS APPLICABLE

Specified model meets or exceeds the following:

- ANSI/UL 1598
- CAS-C22.2 No. 250.0

P34026

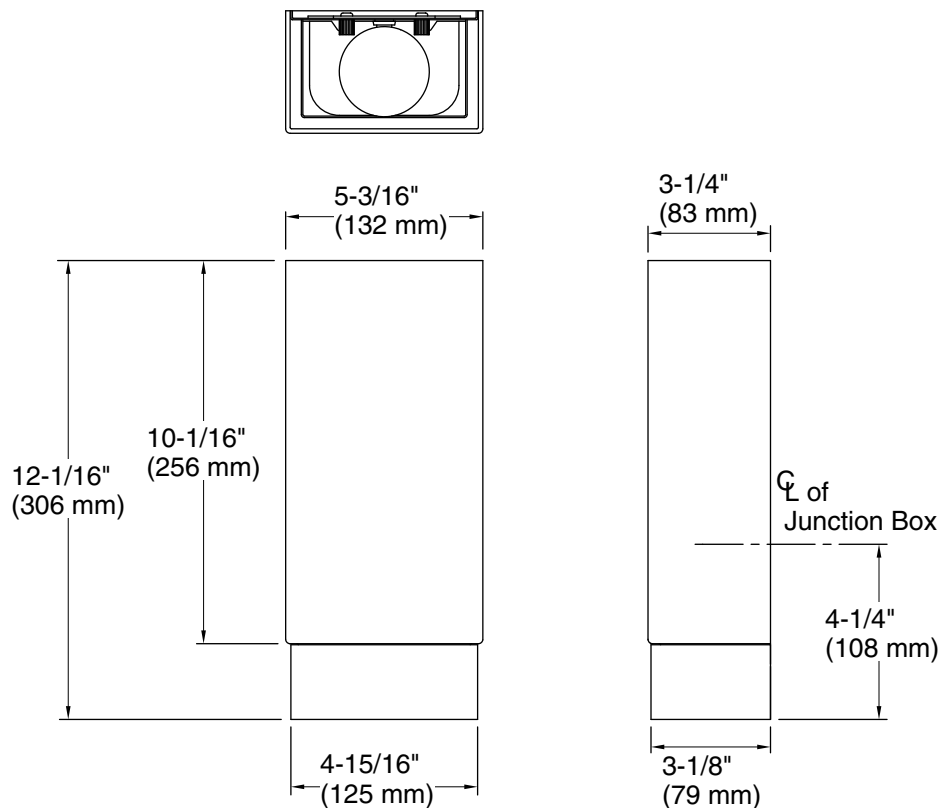

ELECTRICAL NOTES

Use 4" (102 mm) x 2-1/8" (54 mm) rectangular electrical box for installation.
Recommended bulb: T10 (60 Watt Max)

SPECIFIED MODEL

| Model | Description | Finishes | |
|-----------|---------------------|---------------------------------------------|-------------------------------------------|
| P34026-00 | Transitional Sconce | <input type="checkbox"/> CP Polished Chrome | <input type="checkbox"/> AD Nickel Silver |

We reserve the right to make revisions without notice in the design of products or in packaging unless this right has specifically been waived at the time the order is accepted.