

KALLISTA®

Deck-Mounted Bath Set with Diverter

INSTALLATION INSTRUCTIONS

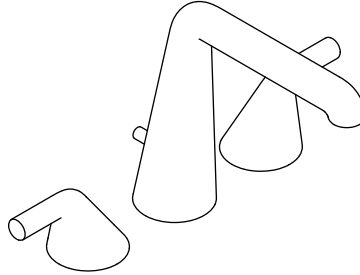

P24803

INSTALLATION INSTRUCTIONS

THANK YOU FOR CHOOSING KALLISTA

We appreciate your commitment to KALLISTA quality products. Please take a moment to review this manual before you install your KALLISTA product. If you encounter any installation or performance problems, please do not hesitate to contact us at the phone number listed at the bottom of the page.

BEFORE YOU BEGIN

- Observe all local plumbing and building codes.
- Shut off the water supply.
- Install the required valve P19304-00-NA prior to installing the product. Refer to the installation instructions packed with the valve.
- Complete the finished deck material before installing the bath faucet trim.
- KALLISTA reserves the right to make revisions in the design of products without notice, as specified in the Price Book.

TOOLS AND MATERIALS

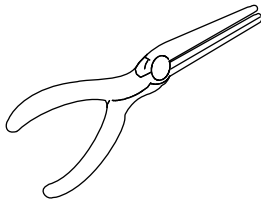

Pliers

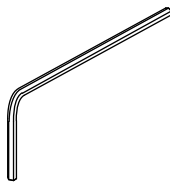

5/32" Hex Wrench

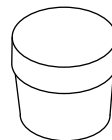

Plumbers Putty

Plus:
• Rags

INSTALLATION INSTRUCTIONS

1. REMOVE THE GUARD AND THE PLUG

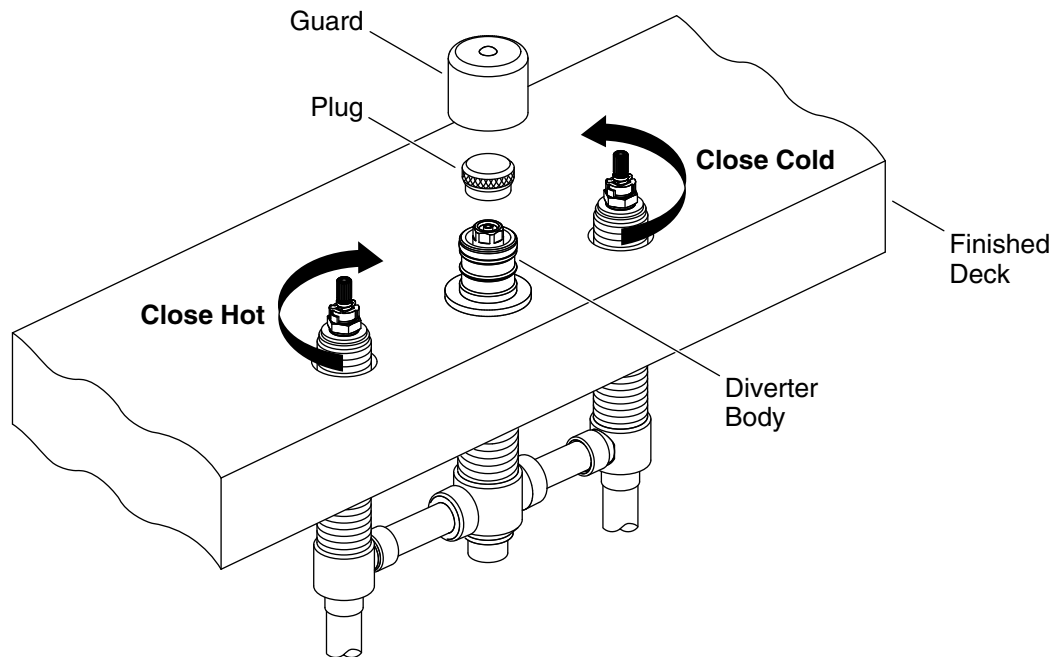

CAUTION: Risk of personal injury. Water lines may be pressurized. Do not lean over the pipe plug when turning or removing the pipe plug.

- Make sure the valves are closed (cold - fully counterclockwise; hot - fully clockwise).
- Remove and discard the guard.

NOTICE: Water may spray from the diverter body when the plug is removed.

- Wrap a rag around the plug to prevent water spray.
- Carefully remove and discard the plug.

INSTALLATION INSTRUCTIONS

2. INSTALL THE SPOUT

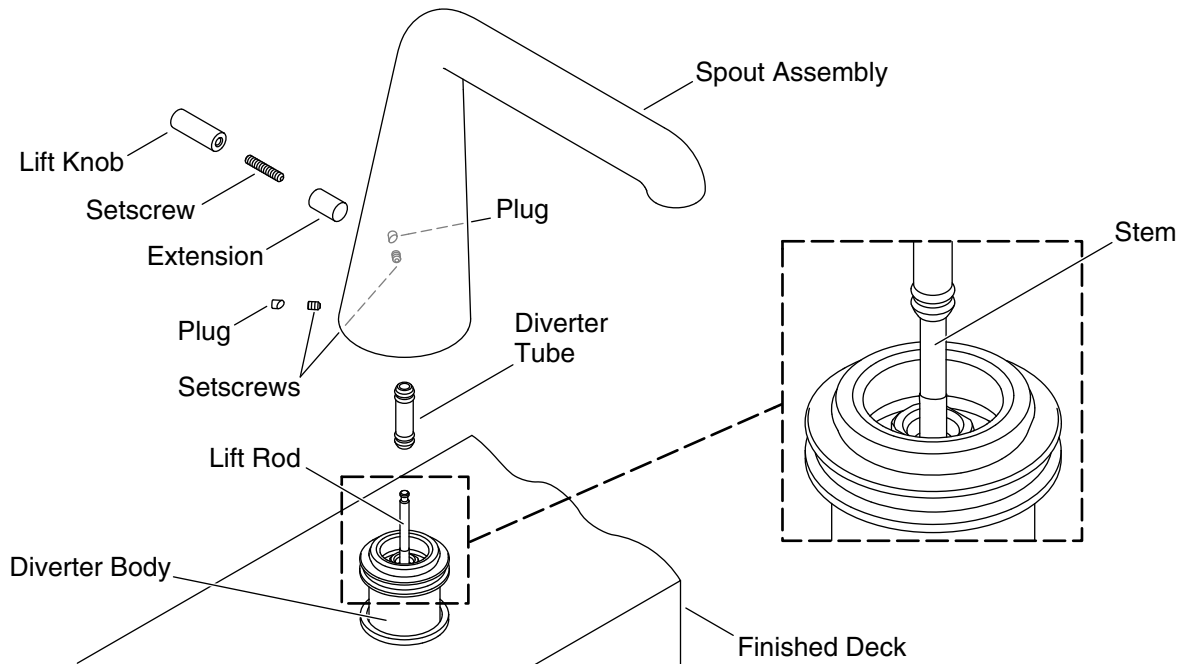

NOTICE: To avoid damage to the o-rings, keep them clean and free of debris.

- Lift up and hold the stem of the diverter body with a pair of pliers, then fully insert the lift rod.
- Install the diverter tube over the lift rod and into the diverter body.
- Loosen the setscrews on the spout assembly until they are clear of the inside wall of the spout.
- Apply a ring of plumbers putty or other suitable sealant around the underside of the spout base.
- Position the spout over the diverter tube, then carefully press down until the spout contacts the finished deck.
- Rotate the spout until it is aligned to face straight forward.
- Retighten the setscrews.
- Push the plugs into place over the setscrews.
- Install the lift knob extension over the diverter tube on the back side of the spout.
- Thread the setscrew into the lift knob extension until tight.
- Thread the lift knob onto the setscrew. Tighten until the knob is flush with the extension.
- Remove any excess plumbers putty or sealant.

INSTALLATION INSTRUCTIONS

3. INSTALL THE HANDLES

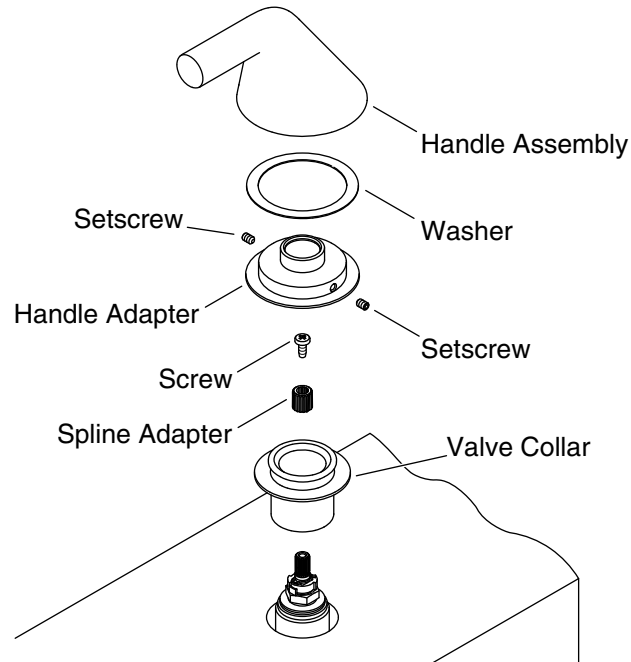

NOTE: The lever handles should be perpendicular with the spout when in the closed position.

- Install the valve collar over the valve and into the finished deck.
- Place a spline adapter onto the valve. Make sure the valve is in the "OFF" position.
- Place the handle assembly over the spline adapter, and check the alignment. Remove and reposition the handle if necessary, until it is perpendicular with the spout.
- Remove the handle assembly and securely tighten the spline adapter with the screw.
- Apply a bead of plumbers putty or other suitable sealant around the bottom of the handle adapter.
- Place the handle adapter over the valve assembly.
- Secure the handle adapter by tightening the two setscrews.
- Place the washer onto the handle adapter.
- Install the handle assembly over the spline and check alignment. Press the handle assembly into place.
- Remove any excess plumbers putty or sealant.

INSTALLATION INSTRUCTIONS

4. COMPLETE THE INSTALLATION

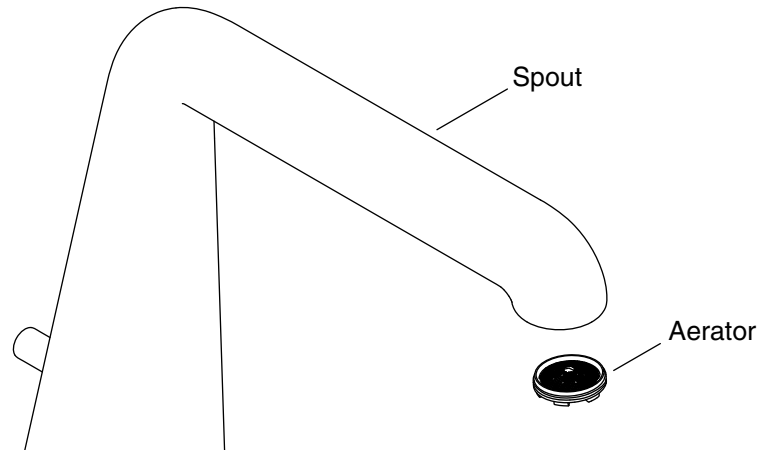

- Ensure that both handles are turned off (cold = counterclockwise, hot = clockwise).
- Make sure that all connections are tight.
- Remove the aerator.
- Turn on the water supply and check for leaks.
- Turn on the hot and cold valves and run water through the spout to remove debris. Check for leaks.
- Confirm proper diverter operation.
- Turn the handles to the "OFF" position and then back to the "ON" position. Verify that the water flow is diverted back to the spout.
- Turn the handles to the "OFF" position.
- Remove any debris from the aerator.
- Reinstall the aerator.